

SEE SHEET NO. C8

(EXISTING CLV HOUSING AUTHORITY)

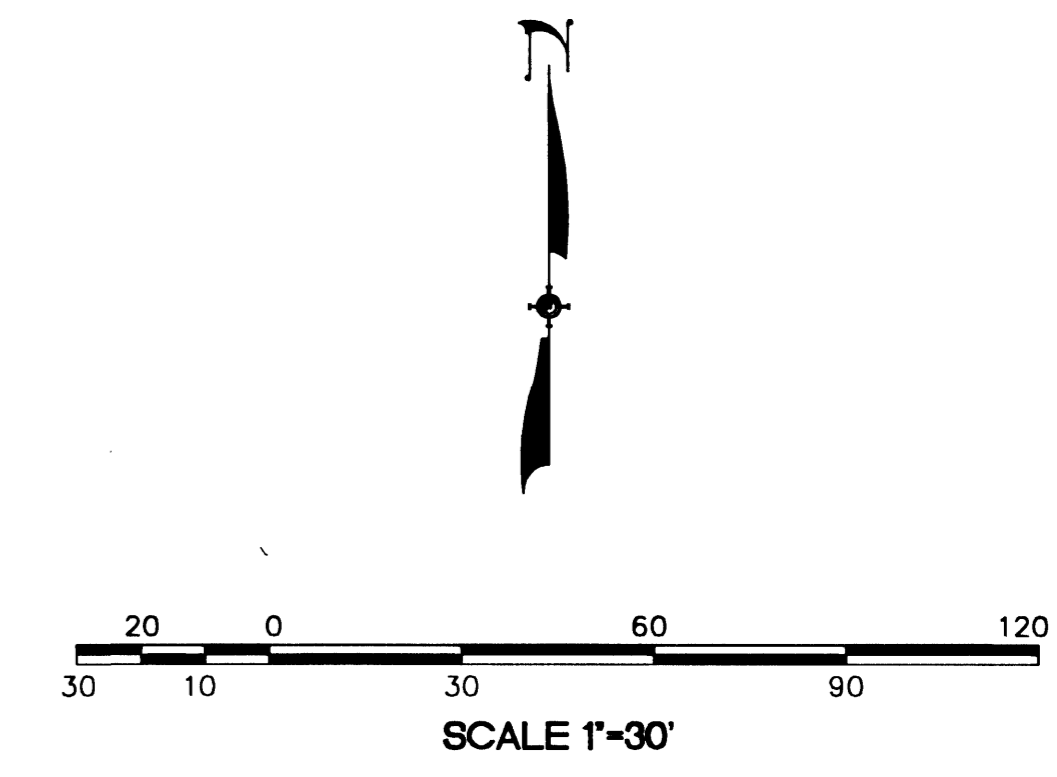

LEGAL DESCRIPTION
 APN 139-26-201-018 3.31 ACRES
 A CERTAIN TRACT OR PARCEL OF LAND LYING AND BEING SITUATE IN THE CITY OF LAS VEGAS, COUNTY OF CLARK, STATE OF NEVADA, AND BEING A PORTION OF THE SOUTHEAST QUARTER (SE 1/4) OF THE NORTHWEST QUARTER (NW 1/4) OF SECTION 26, TOWNSHIP 20 SOUTH, RANGE 61 EAST, M.D.B.

BASIS OF BEARING
 N 89° 55'06" E, BEING THE SOUTHLINE OF THE NW 1/4 OF SECTION 26 TOWNSHIP 20 SOUTH, RANGE 61 EAST, AND THE CENTERLINE OF WASHINGTON AVE, AS SHOWN ON FILE 72 PAGE 17 OF PARCEL MAPS ON FILE IN THE OFFICE OF THE CLARK COUNTY RECORDER.

BENCHMARK
 BM# 2LV01-26N6
 RIVET & PLATE IN TOP OF CURB, NE RETURN BRUCE AVE. AND SEARLES AVE. (568.8833 METERS)
 (NAVD 88)
 (1866.41 FEET)

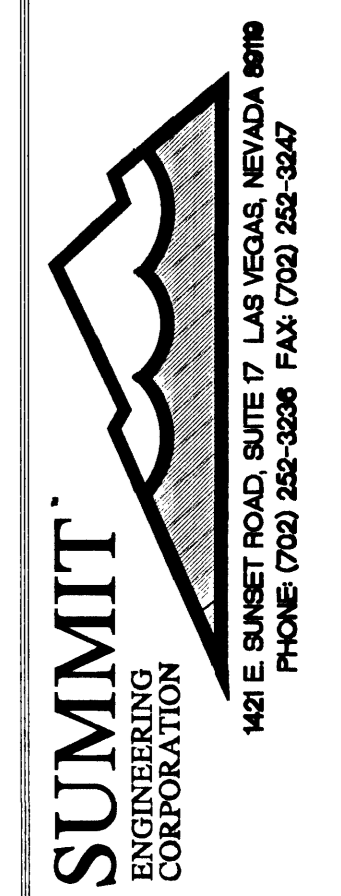

DEVELOPER:
 SUNBELT COMMUNICATIONS
 1608 E. GRAGSON AVE.
 LAS VEGAS, NV 89101
 PHONE: (702) 657-3142 FAX: (702) 642-3093

DESIGNED: A.P.H.
 CHECKED: A.J.H.
 SCALE: HOR. 1"=30'
 VER. 1"=3'
 DATE: 05/03/02
 FILE NO. 72292

SUNBELT STORAGE
PLAN AND PROFILE
GRAGSON AVENUE
 LAS VEGAS CLARK COUNTY NEVADA

REV.	DATE	DESCRIPTION	BY	APP'D
1	8/15/02	REVISE SEWER MAIN	APH	ME

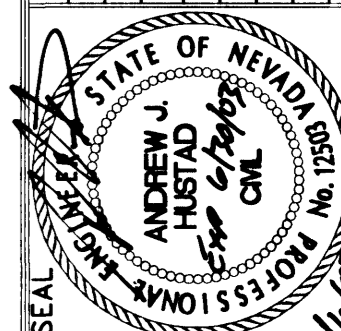

SHEET
C7
 7 OF 8 SHEETS
 DRAWING NO.
5447

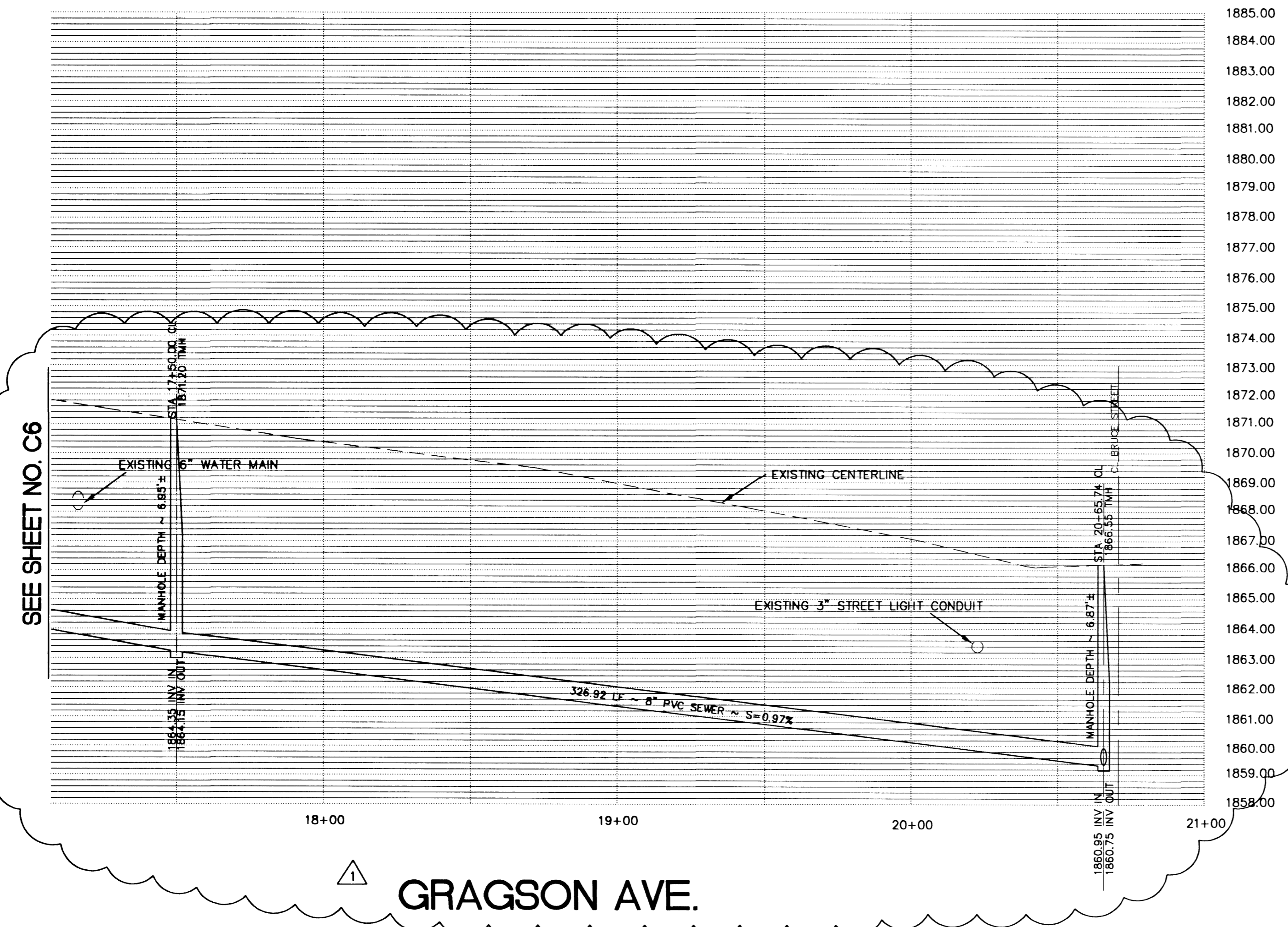

WATER NOTES

1. 1" TAP TO BE INSTALLED BY LVWD
2. INSTALL 1" WATER METER PER UDS STD PLATE 1-C
3. INSTALL 3/4" MAIN WATER LINE TO BUILDING
4. INSTALL 12"x12"x6" MECH. TAPPING SLEEVE AND 6" TAPPING SLEEVE
5. 6" FIRE LINE AWWA C-900 CLASS 150
6. INSTALL 6" DOUBLE CHECK DETECTOR ASSEMBLY PER UDACS PLATE 20 B
7. 10'X35' LVWD EASEMENT

QUANTITIES

	PRIVATE	PUBLIC
0 LF	1 EA	
0 EA	1 EA	
35 LF	11 LF	
0 EA	1 EA	
35 LF	0 EA	
0 EA	1 EA	
0 EA	0 EA	

SEWER NOTES

1. INSTALL 8" PVC SEWER MAIN
2. INSTALL 48" SANITARY MANHOLE PER CCSD DWG NO. SD-1
3. INSTALL 6" PVC SEWER LINE
4. INSTALL 6" CLEAN OUT
5. INSTALL 8" WYE
6. EXISTING 4" SEWER LATERAL
7. CRUSH AND FILL EXISTING SEPTIC TANK PER HEALTH DISTRICT REQUIREMENTS
8. CAP AND CONCRETE EXISTING 4" SEWER
9. SAWCUT LINE
10. REMOVE AND REPLACE 3" ASPHALT AND BACKFILL TRENCH PER STD DWG NO. 503
11. REMOVE AND REPLACE 4" ASPHALT AND BACKFILL TRENCH PER STD DWG NO. 504
12. REMOVE AND RECONSTRUCT ONE (1) SECTION OF CROSS GUTTER FROM CENTER LINE TO CONTROL JOINT PER DWG # 228
13. INSTALL 8" CLASS 900 SEWER MAIN

QUANTITIES

	PRIVATE	PUBLIC
N/A	1,210.00 LF	
N/A	6 EA	
145 LF	N/A	
2 EA	N/A	
N/A	2 EA	
137.52 LF	N/A	
-	1 EA	
-	1 EA	
-	-	918 SY
-	-	209 SY
-	-	25 SY
-	-	30 LF

UTILITY NOTE

UTILITY LOCATIONS SHOWN HEREON ARE APPROXIMATE ONLY. IT SHALL BE THE CONTRACTOR'S RESPONSIBILITY TO DETERMINE THE EXACT HORIZONTAL AND VERTICAL LOCATION OF ALL EXISTING UNDERGROUND UTILITIES PRIOR TO COMMENCING CONSTRUCTION. NO REPRESENTATION IS MADE THAT ALL EXISTING UTILITIES ARE SHOWN HEREON. THE ENGINEER ASSUMES NO RESPONSIBILITY FOR UTILITIES NOT SHOWN OR UTILITIES NOT SHOWN IN THEIR PROPER LOCATION.

Avoid cutting underground utility lines. It's costly.
before Call you Dig
 1-800-227-2600
 UNDERGROUND SERVICE (USA)

AVOID HITTING OVERHEAD POWER LINES. IT'S COSTLY.
CALL BEFORE YOU DIG OVERHEAD
 CALL 1-702-593-6111