

GENERAL NOTES

1. ALL CONSTRUCTION AND MATERIALS SHALL BE IN ACCORDANCE WITH THE "UNIFORM STANDARD SPECIFICATIONS FOR PUBLIC WORKS CONSTRUCTION OFF-SITE IMPROVEMENTS, CLARK COUNTY AREA NEVADA", LATEST EDITION; THE "UNIFORM STANDARD SPECIFICATIONS FOR PUBLIC WORKS CONSTRUCTION, CITY OF LAS VEGAS"; ANY OTHER APPLICABLE APPROVED STANDARDS ISSUED BY THE CONTROLLING AGENCY; THE UNIFORM BUILDING CODE; AND ALL LOCAL CITY CODES AND ORDINANCES APPLICABLE.
2. THE EXISTENCE AND LOCATION OF ANY UNDERGROUND UTILITY PIPES OR STRUCTURES SHOWN ON THESE PLANS ARE OBTAINED BY A SEARCH OF THE AVAILABLE RECORDS. THE CONTRACTOR IS REQUIRED TO TAKE PRECAUTIONARY MEASURES TO PROTECT THE UTILITY LINES SHOWN AND ANY OTHER LINES NOT OF RECORD OR NOT SHOWN ON THESE DRAWINGS. EXISTING UTILITIES ARE LOCATED ON PLANS ONLY FOR THE CONVENIENCE OF THE CONTRACTOR. EXISTING UTILITY SERVICE LATERALS ARE NOT SHOWN ON THE PLANS.
3. THE CONTRACTOR SHALL TAKE ALL PRECAUTIONARY MEASURES NECESSARY TO PROTECT EXISTING IMPROVEMENTS WHICH ARE TO REMAIN IN PLACE, FROM DAMAGE, AND ALL SUCH IMPROVEMENTS OR STRUCTURES DAMAGED BY THE CONTRACTOR'S OPERATIONS SHALL BE REPAIRED OR RECONSTRUCTED SATISFACTORY TO THE OWNER AT THE EXPENSE OF THE CONTRACTOR.
4. THE CONTRACTOR SHALL NOT BACKFILL ANY TRENCHES IN WHICH WATERLINES HAVE BEEN UNCOVERED UNTIL THE WATERLINES HAVE BEEN INSPECTED BY THE LAS VEGAS VALLEY WATER DISTRICT. THE WATER DISTRICT SHALL BE NOTIFIED 48 HOURS IN ADVANCE OF CONSTRUCTION IN THE VICINITY OF WATER LINES.
5. ALL CONSTRUCTION SHALL BE AS SHOWN ON THESE PLANS. ANY ALTERATIONS SHALL HAVE THE PRIOR WRITTEN APPROVAL OF THE CITY ENGINEER.
6. TYPE V CONCRETE SHALL BE USED IN ALL OFF-SITE CONCRETE WORK. CONCRETE TO BE DESIGNED FOR A 3.5 SACK MIX WITH A MAXIMUM WATER/CEMENT RATIO OF 0.45 (OR AS DESIGNED BY THE SOILS ENGINEER). MIX DESIGN TO BE APPROVED BY THE QUALITY CONTROL DIVISION PRIOR TO USE ON THE PROJECT.
7. THE CONTRACTOR SHALL, AT HIS OWN EXPENSE, LOCATE ALL OVERHEAD INTERFERENCES WHICH MAY AFFECT HIS OPERATION DURING CONSTRUCTION AND SHALL TAKE ALL NECESSARY PRECAUTIONS TO AVOID DAMAGE TO SAME. THE CONTRACTOR SHALL USE EXTREME CAUTION WHEN WORKING NEAR OVERHEAD OR UNDERGROUND POWER AND/OR TELEPHONE FACILITIES SO AS TO SAFELY PROTECT ALL PERSONNEL AND EQUIPMENT, AND SHALL BE RESPONSIBLE FOR ALL COSTS AND LIABILITY IN CONNECTION THEREWITH.
8. PERMITS ARE REQUIRED FOR ANY WORK IN THE PUBLIC RIGHT-OF-WAY. THE CONTRACTOR SHALL SECURE ALL PERMITS AND INSPECTIONS REQUIRED FOR THIS CONSTRUCTION.
9. EXPANSION JOINTS REQUIRED, MAXIMUM EVERY 300' IN EXTRUDED TYPE CURB.
10. AC PAVEMENT TO BE 1" ABOVE LIP OF ALL GUTTERS & VALLEY GUTTER AFTER COMPACTION.
11. APPLY FOG SEAL ONLY AFTER ALL CORRECTIONS & ADJUSTMENTS HAVE BEEN MADE.
12. CURB & GUTTER WITH A GRADE OR LESS THAN FOUR PERCENT SHALL BE CONSTRUCTED BY FORMING. EACH JOINT SHALL BE CHECKED FOR CURVE PRIOR TO CONSTRUCTION, AND WATER TESTED AS SOON AS POSSIBLE AFTER CONSTRUCTION.
13. WHEELCHAIR RAMPS SHALL BE CONSTRUCTED IN EACH QUADRANT OF AN INTERSECTION PER STANDARD DRAWING UO2A. EXACT LOCATION OF RAMPS MAY BE ADJUSTED IN THE FIELD BY A CITY INSPECTOR.
14. CONTRACTOR SHALL PROVIDE ALL NECESSARY HORIZONTAL AND VERTICAL TRANSITIONS BETWEEN NEW CONSTRUCTION AND EXISTING SURFACES TO PROVIDE FOR PROPER DRAINAGE AND FOR ACCESS AND EGRESS TO SAID CONSTRUCTION. EXTENT OF TRANSITIONS TO BE DETERMINED BY THE CITY ENGINEER AND AS SHOWN ON PLANS.
15. ALL GRADING WORK SHALL CONFORM TO THE SOILS REPORT AS PREPARED BY THE SOILS ENGINEER OR PER THESE PLANS.
16. EXACT LOCATION OF ALL SANCUOT LINES MAY BE DETERMINED IN THE FIELD BY A CITY OF LAS VEGAS INSPECTOR IF LOCATION ON PLANS IS NOT CLEARLY SHOWN, OR EXISTING PAVED CONDITION REQUIRES RELOCATION.
17. THE CONTRACTOR SHALL TAKE ALL PRECAUTIONS NECESSARY TO PROTECT EXISTING PERMANENT SURVEY MONUMENTS. ALL MONUMENTS DISTURBED SHALL BE REPLACED AND ADJUSTED PER AVAILABLE RECORDS IN ACCORD WITH N.E.S. STATUTE NO. 625-550.
18. CONSTRUCTION SURVEY:
GRADES ARE GIVEN FROM TOP OF STAKES OR NAILS. THE CONTRACTORS ARE CAUTIONED TO OBSERVE THE FOLLOWING RULES IN USING THE GRADE STAKES GIVEN BY THIS OFFICE: THREE (3) CONSECUTIVE POINTS THAT ARE SHOWN TO BE ON THE SAME GATE OR SLOPE MUST BE USED IN ORDER THAT ANY VARIATION OUT OF A PERFECT STRAIGHT GRADE MAY BE DETECTED IN CASE ANY SUCH DISCREPANCY IS FOUND, THE SAME MUST BE REPORTED. OTHERWISE THIS OFFICE WILL NOT BE RESPONSIBLE FOR ANY ERROR IN THE GRADE OF THE FINISHED WORK.

SEWER NOTES

1. ALL SANITARY SEWER INSTALLATIONS SHALL CONFORM TO THE STANDARD DETAILS AND SPECIFICATIONS OF THE CITY OF LAS VEGAS, AND SHALL ALSO CONFORM TO THE UNIFORM STANDARD SPECIFICATIONS FOR PUBLIC WORKS CONSTRUCTION OFF-SITE IMPROVEMENTS, CLARK COUNTY AREA, LATEST EDITION, UNLESS OTHERWISE NOTED.
2. UNISEL "S" OR "C" IN CURBS WHERE SEWER OR GAS LATERALS PASS UNDER THE CURB.
3. POLYVINYL CHLORIDE (PVC) SEWER PIPE SHALL MEET ASTM D-3035, SDR 35 SPECIFICATIONS, AND INSTALLED WITH SAND BEDDING AND BACKFILL OF TYPE II GRAVEL.
4. ALL MANHOLES IN PAVED STREETS 40' R/W AND LARGER SHALL HAVE CONCRETE COLLARS.
5. TEE SADDLES SHALL BE USED TO CONNECT SEWER LATERALS TO EXISTING MAIN LINES UP TO 12" DIA. SIZE. CONNECTIONS TO 15" OR LARGER MAINS SHALL REQUIRE SPECIAL PROTECTORS.
6. A SEWER MAIN CROSSING OVER A WATER MAIN OR LESS THAN 18" UNDER A WATER MAIN MUST BE REINFORCED CONCRETE ENCASED PIPE FOR A DISTANCE NOT LESS THAN 10' TO EACH SIDE OF THE CENTERLINE OF THE WATER MAIN.

STREET LIGHTING NOTE

1. ALL STREET LIGHT INSTALLATIONS SHALL CONFORM TO THE STANDARD DETAILS AND SPECIFICATIONS OF THE CITY OF LAS VEGAS, AND SHALL ALSO CONFORM TO THE UNIFORM STANDARD SPECIFICATIONS FOR PUBLIC WORKS CONSTRUCTION OFF-SITE IMPROVEMENTS, CLARK COUNTY AREA, LATEST EDITION, UNLESS OTHERWISE NOTED.

STREET NOTES

1. A.C. PAVEMENT TO BE 1/2" ABOVE LIP OF GUTTER AFTER COMPACTION.
2. SUBGRADE FOR TYPE I UNDER CURB AND GUTTER AND UNDER A.C. TO BE CONTINUOUS.
3. FOG SEAL TO BE APPLIED AFTER FINAL CORRECTIONS AND ADJUSTMENTS HAVE BEEN MADE.
4. THE MAXIMUM GRADE BREAK OCCURRING IN THE CROSS SECTION SHALL BE 2% AND SHALL FALL BETWEEN A DRIVING LANE AND A PARKING LANE.
5. NATIVE MATERIAL MAY BE USED IN LIEU OF TYPE I WHEN PROCESSED FOR APPROVAL IN ACCORDANCE WITH CITY OF LAS VEGAS STATEMENT OF POLICY DATED 7/25/84.

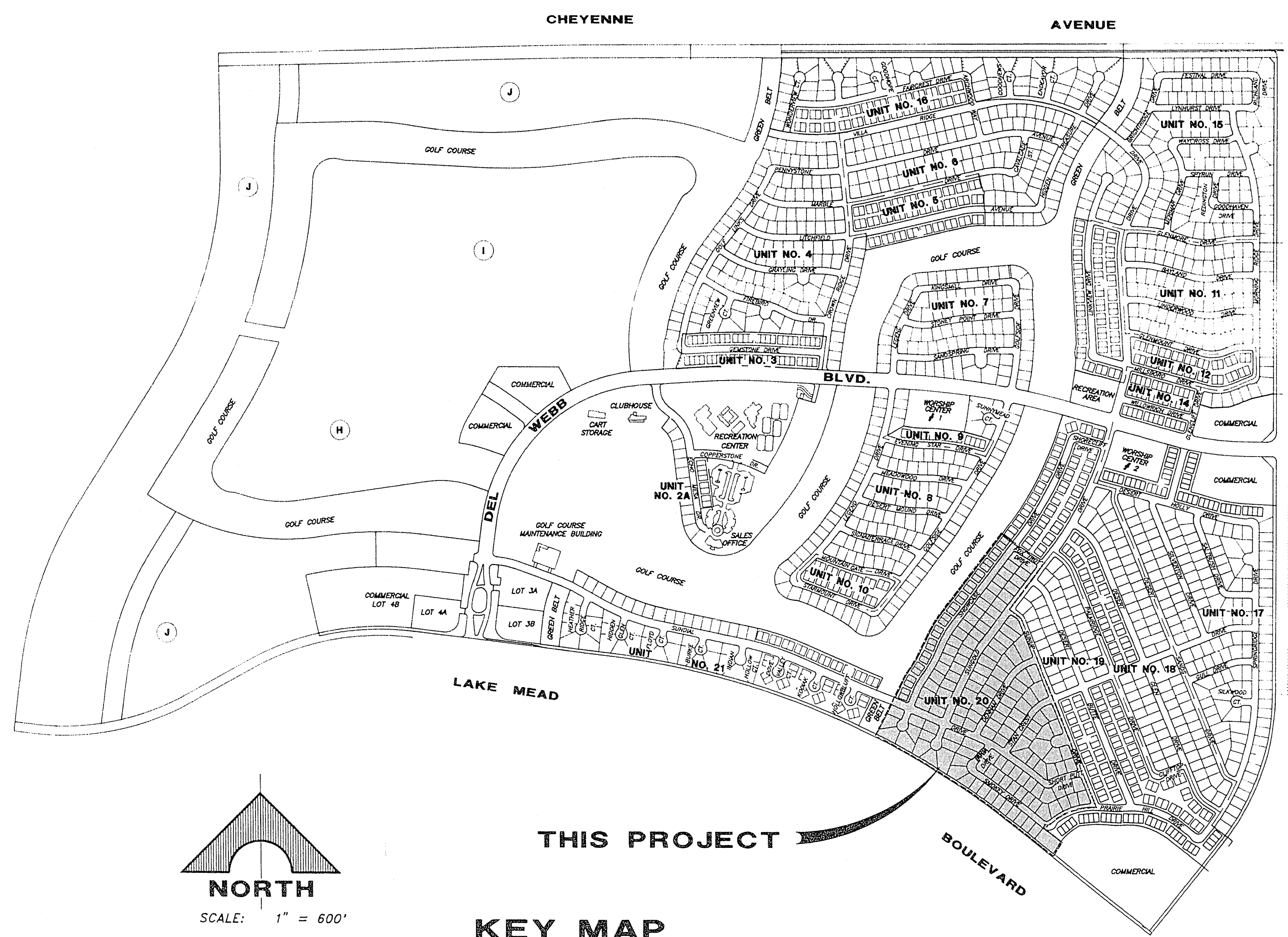

Del Webb's Sun City Summerlin

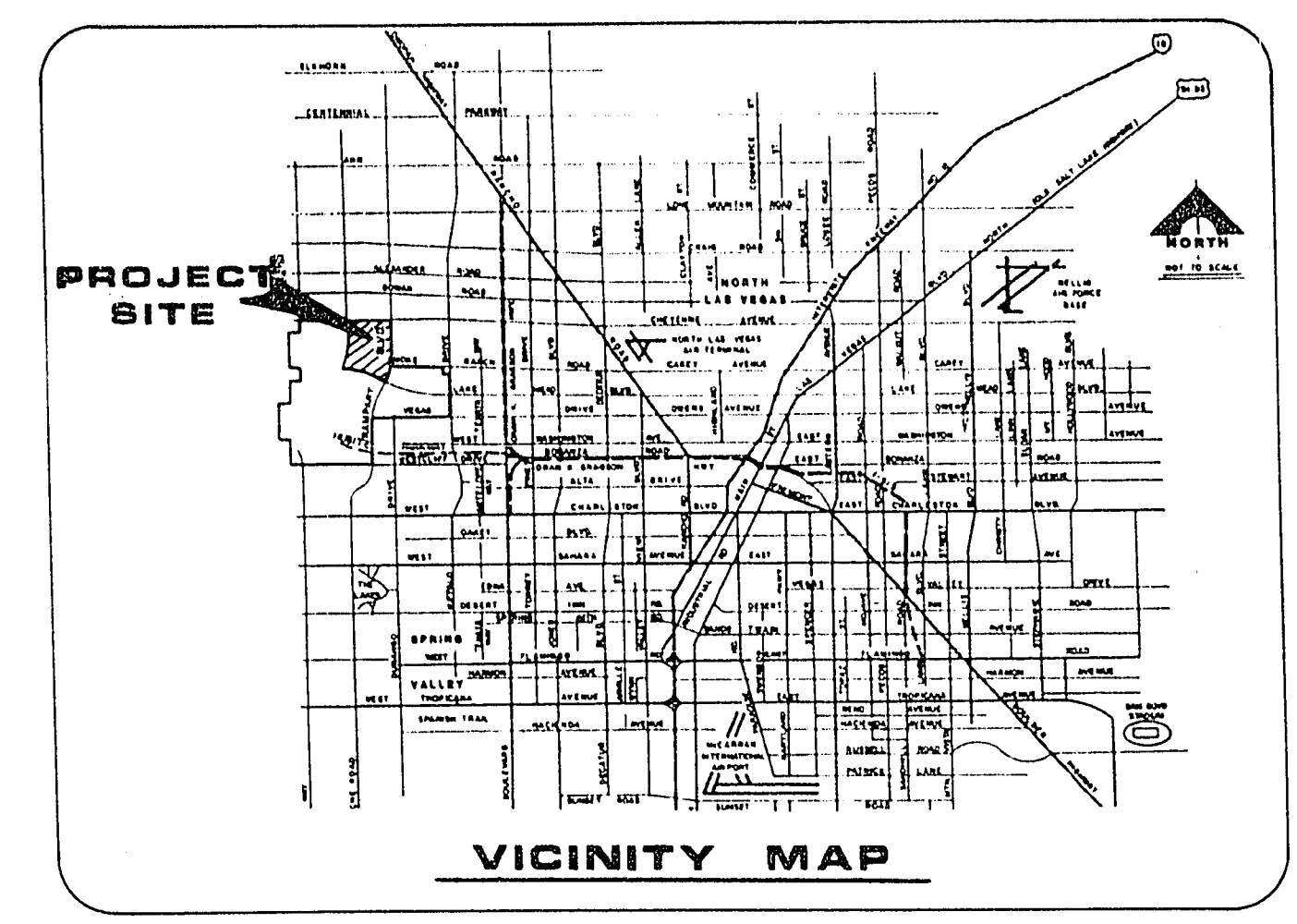

INDEX OF DRAWING

NO.	TITLE
1	TITLE SHEET
2	GENERAL NOTES & MISCELLANEOUS
3	ESTIMATE OF QUANTITIES
4	UTILITY PLAN I
5	UTILITY PLAN II
6	UTILITY PLAN III
7	UTILITY PLAN IV
8	SHOWCASE DRIVE
9	SHOWCASE DRIVE
10	SUNGOLD DRIVE
11	DENHAM DRIVE
12	STANCREST DRIVE & SUNUP DRIVE
13	SUNDIAL DRIVE
14	SUNDIAL DRIVE & SHORT PUTT DRIVE
15	SMOKEY DRIVE & BOCA DRIVE
16	GRADING PLAN I
17	GRADING PLAN II
18	GRADING PLAN III
19	GRADING PLAN IV
20	GRADING DETAILS

APPROVALS

[Signature]
CLV ENGINEER

2-13-20
DATE

Avoid cutting underground utility lines. If you do:

Call before you Dig.

1-800-227-2600
UNDERGROUND SERVICE (USA)

BENCHMARK

CLV BENCHMARK: TOP OF CURB AT END OF CURB, WEST SIDE OF DURANGO DRIVE, 250' SOUTH OF WESTCLIFF BOULEVARD. ELEVATION: 2610.16

PROJECT BENCHMARK: BRASS CAP IN TOP OF 6" DIA. CONCRETE CYLINDER 490' WEST OF DEL WEBB BLVD. AT FUTURE B ST. N. 532105.5031 E. 584121.2223 ELEV. 2599.855

DESCRIPTION

REV. DATE

6218 R.E. NO. DATE

RECEIVED

MICHAEL D. ROSS

G.C. WALLACE, INC.
Engineering/Architecture

DEL E. WEBB COMMUNITIES, INC.
SUN CITY SUMMERLIN UNIT NO. 20

GENERAL NOTES & MISCELLANEOUS

SHEET

2

OF 20 SHEETS

JOB NO. 701.079