

430+20.22 - TOWN CENTER DRIVE
LATERAL PROFILE SCALE: HORIZ. 1" = 20'
 VERT. 1" = 4' 3
14

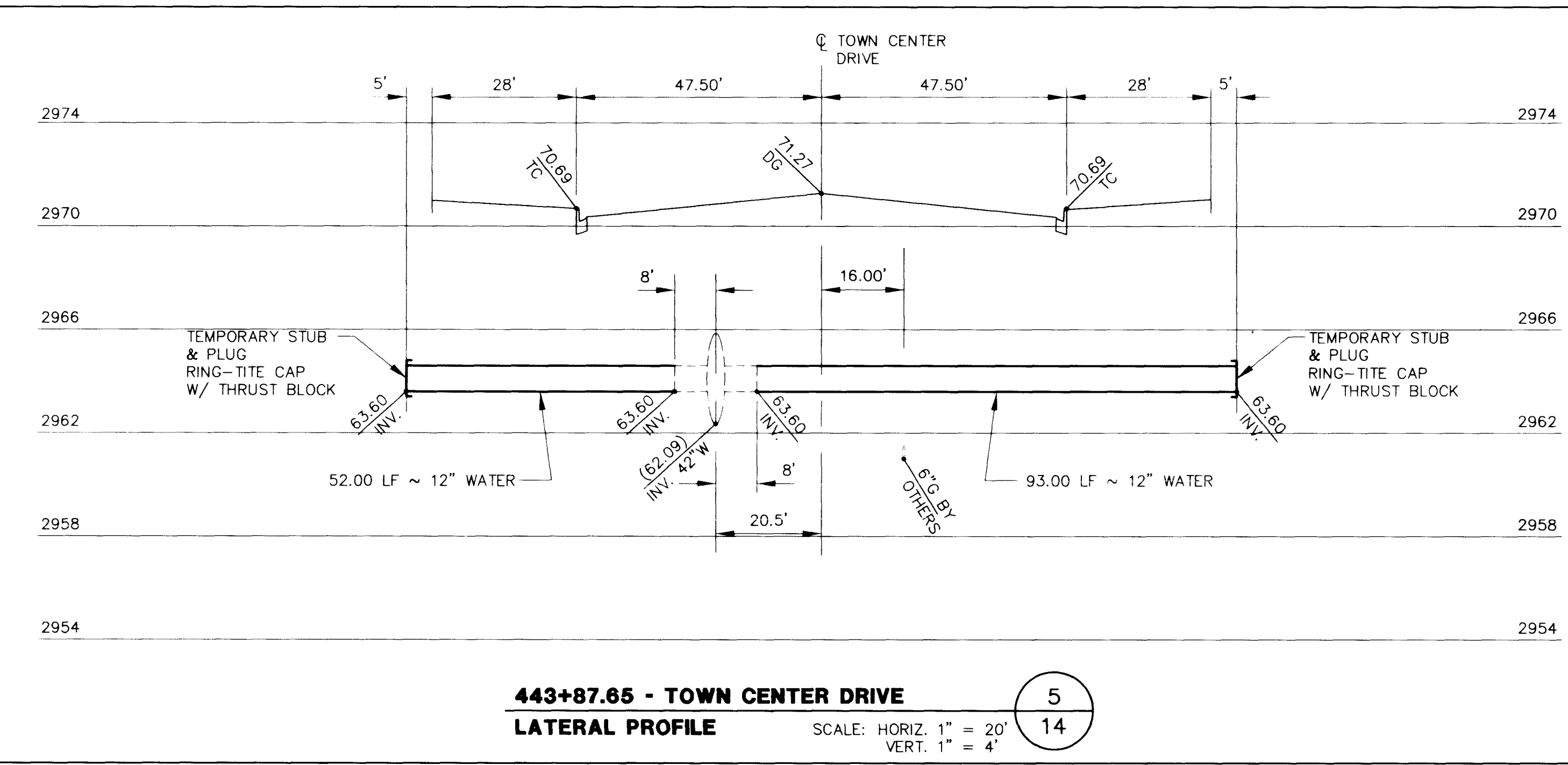

443+87.65 - TOWN CENTER DRIVE
LATERAL PROFILE SCALE: HORIZ. 1" = 20'
 VERT. 1" = 4' 5
14

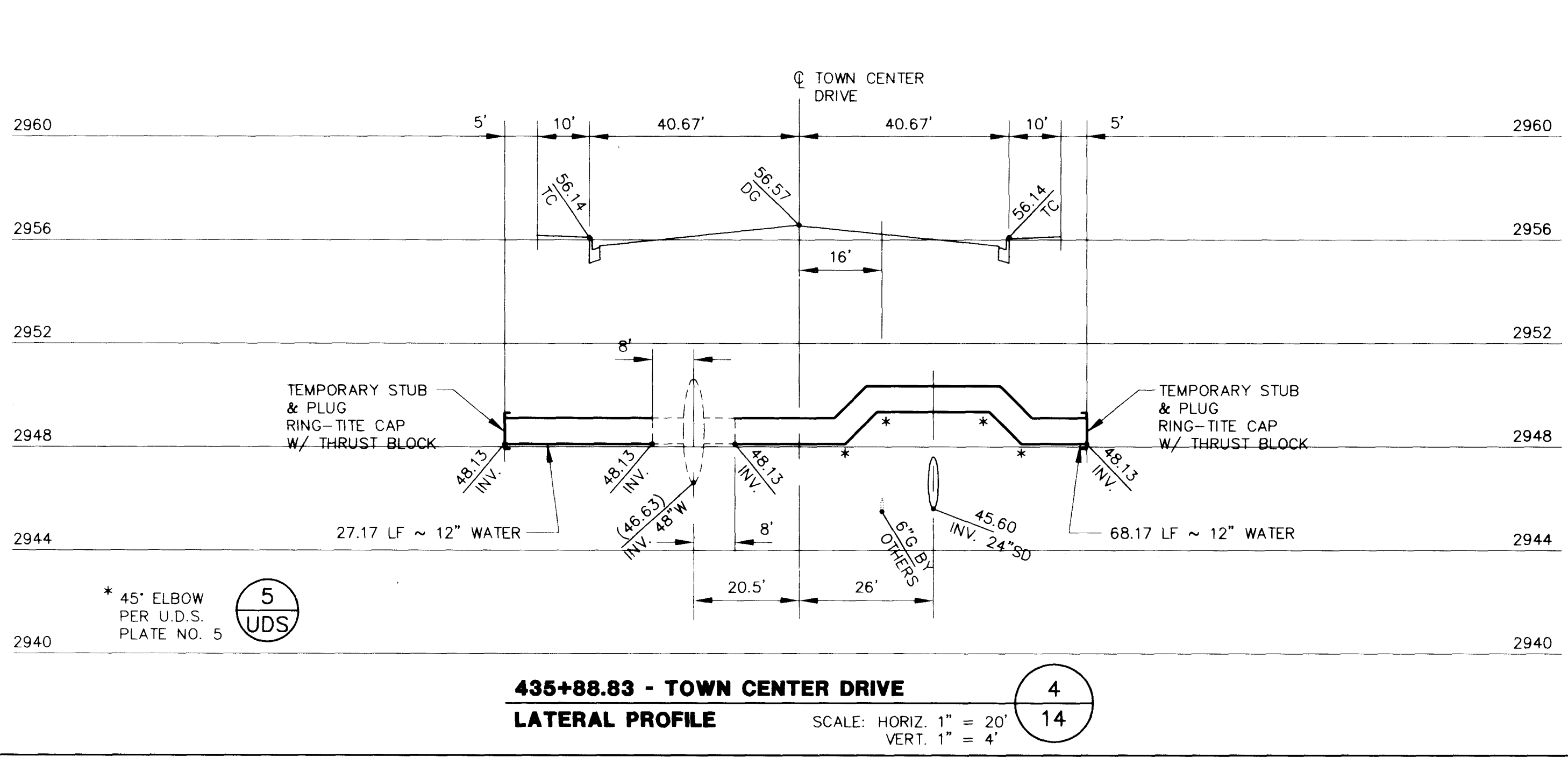

435+88.83 - TOWN CENTER DRIVE
LATERAL PROFILE SCALE: HORIZ. 1" = 20'
 VERT. 1" = 4' 5
14

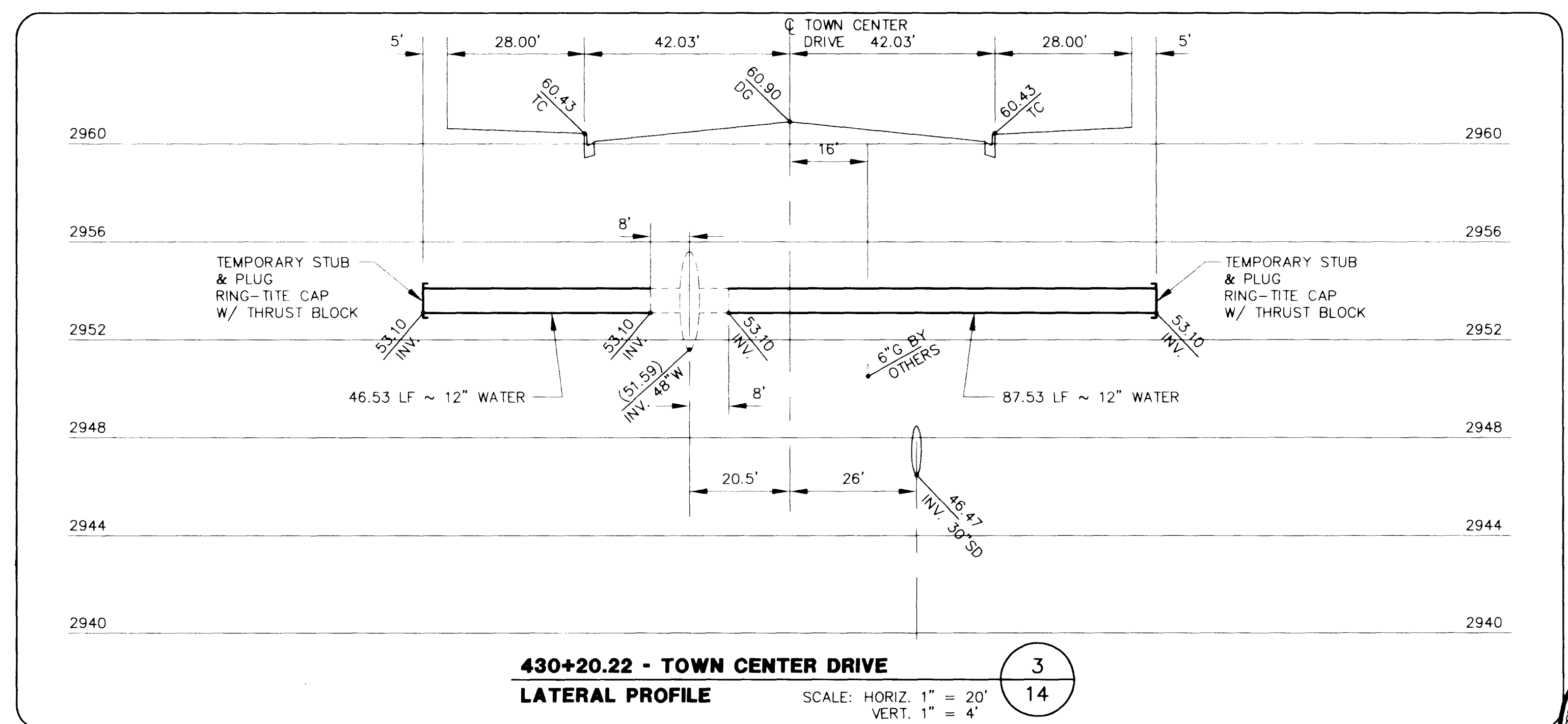

430+20.22 - TOWN CENTER DRIVE
LATERAL PROFILE SCALE: HORIZ. 1" = 20'
 VERT. 1" = 4' 3
14

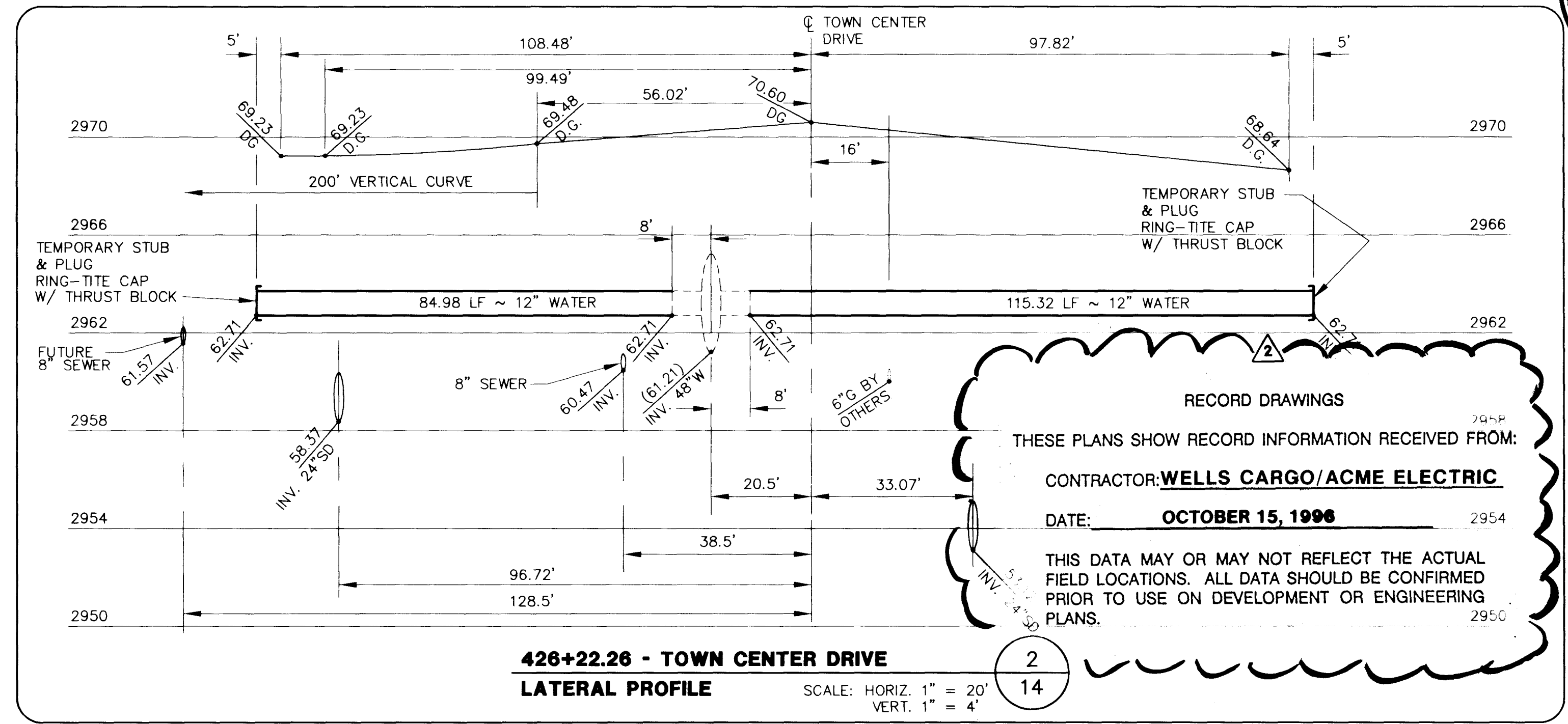

426+22.26 - TOWN CENTER DRIVE
LATERAL PROFILE SCALE: HORIZ. 1" = 20'
 VERT. 1" = 4' 2
14

RECORD DRAWINGS

THESE PLANS SHOW RECORD INFORMATION RECEIVED FROM:
 CONTRACTOR: **WELLS CARGO/ACME ELECTRIC**
 DATE: **OCTOBER 15, 1996**

THIS DATA MAY OR MAY NOT REFLECT THE ACTUAL
 FIELD LOCATIONS. ALL DATA SHOULD BE CONFIRMED
 PRIOR TO USE ON DEVELOPMENT OR ENGINEERING
 PLANS.

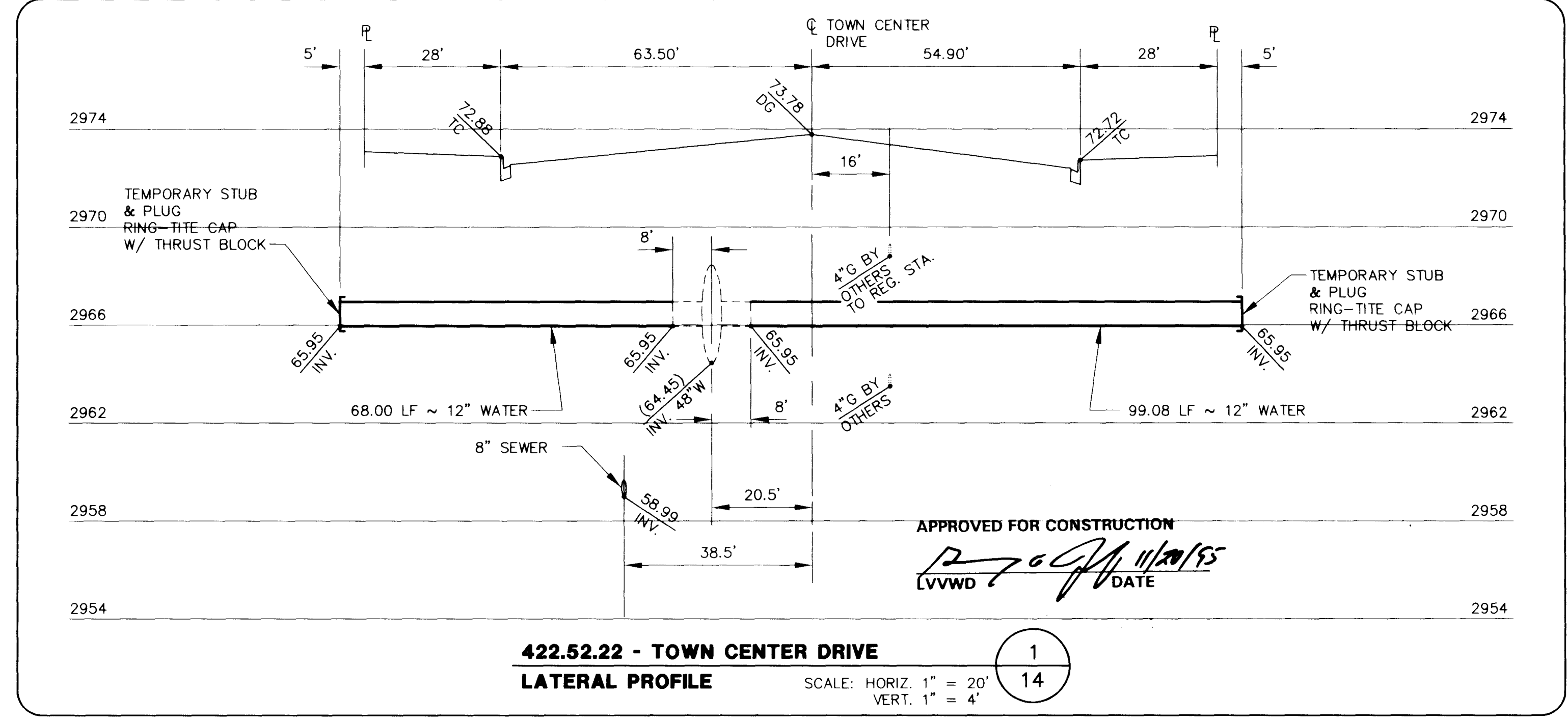

422.52.22 - TOWN CENTER DRIVE
LATERAL PROFILE SCALE: HORIZ. 1" = 20'
 VERT. 1" = 4' 1
14

APPROVED FOR CONSTRUCTION
[Signature]
 DATE: 11/20/95
 LVVWD

FINAL SUBMITTAL

RECOMMENDED CHRISTOPHER W. ANDERSON R.P.E. NO. 5071	DATE
REVISIONS	DATE
REV. NO.	DATE

STATE OF NEVADA
 PROFESSIONAL ENGINEER
 CHRISTOPHER W. ANDERSON
 CIVIL ENGINEER
 LICENSE NO. 5071

G. C. WALLACE, INC.
 Engineering/Architecture
 1555 SOUTH RAINBOW BLVD., LAS VEGAS, NEVADA 89102

SUMMERLIN
TOWN CENTER DRIVE
TOWN CENTER DR - ALTA TO CHARLESTON
WATER LATERAL DETAILS

SHEET
14
 SH1 14 OF 21

