

CRESTDALE LANE

SCALE: HORIZ. 1" = 20'
VERT. 1" = 5'

CURVE DATA				① INDICATES CURVE NUMBER
NO.	DELTA	RADIUS	LENGTH	TANGENT
1	01°46'33"	1064.00'	32.98'	16.49'
2	01°46'33"	1100.00'	34.09'	17.05'
3	01°46'33"	1136.00'	35.21'	17.61'

NOTE: CURVE DATA REPRESENTS PARTIAL CURVE, THIS SHEET ONLY.

- CONSTRUCTION NOTES**
- IMPROVEMENTS**
- ① INSTALL "L" TYPE CURB & GUTTER (S-47 S)
 - ② INSTALL AC PAVEMENT PER STREET SECTIONS SHEET NO. 18
- SEWER**
- ① S INSTALL 8" SEWER PIPE (U-20 S)
 - ② S INSTALL SEWER MANHOLE (SD1-8 CLV)
- WATER**
- ① W INSTALL 12" WATER PIPE (U-20 S)
 - ② W INSTALL 6" WATER GATE VALVE (U-34 S)
 - ③ W INSTALL 6" FIRE HYDRANT ASSEMBLY
- STORM DRAIN**
- ① SD INSTALL 36" STORM DRAIN PIPE (1350-D) (U-20 S)
 - ② SD INSTALL 30" STORM DRAIN PIPE (1350-D) (U-20 S)
 - ③ SD INSTALL 24" STORM DRAIN PIPE (1350-D) (U-20 S)
 - ④ SD INSTALL TYPE II STORM DRAIN MANHOLE (D.2.3.4 S)
- STREET LIGHTING**
- ① SL STREET LIGHT OR COMMON TRENCH, SEE ELECTRICAL PLANS
 - ② SL INSTALL STREET LIGHT, SEE ELECTRICAL PLANS (E-2 S)
- IRRIGATION**
- ① IR BANK "C", 1-6" AND 3-4" SDR35 PVC

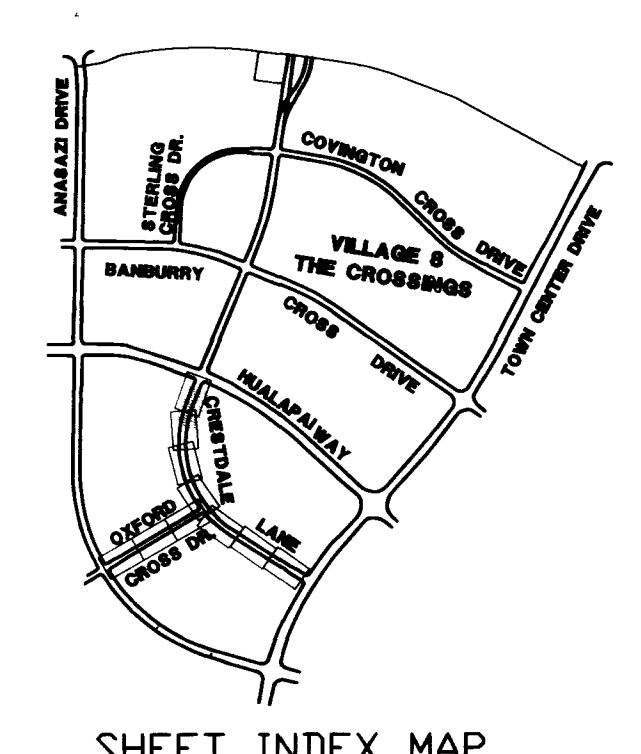
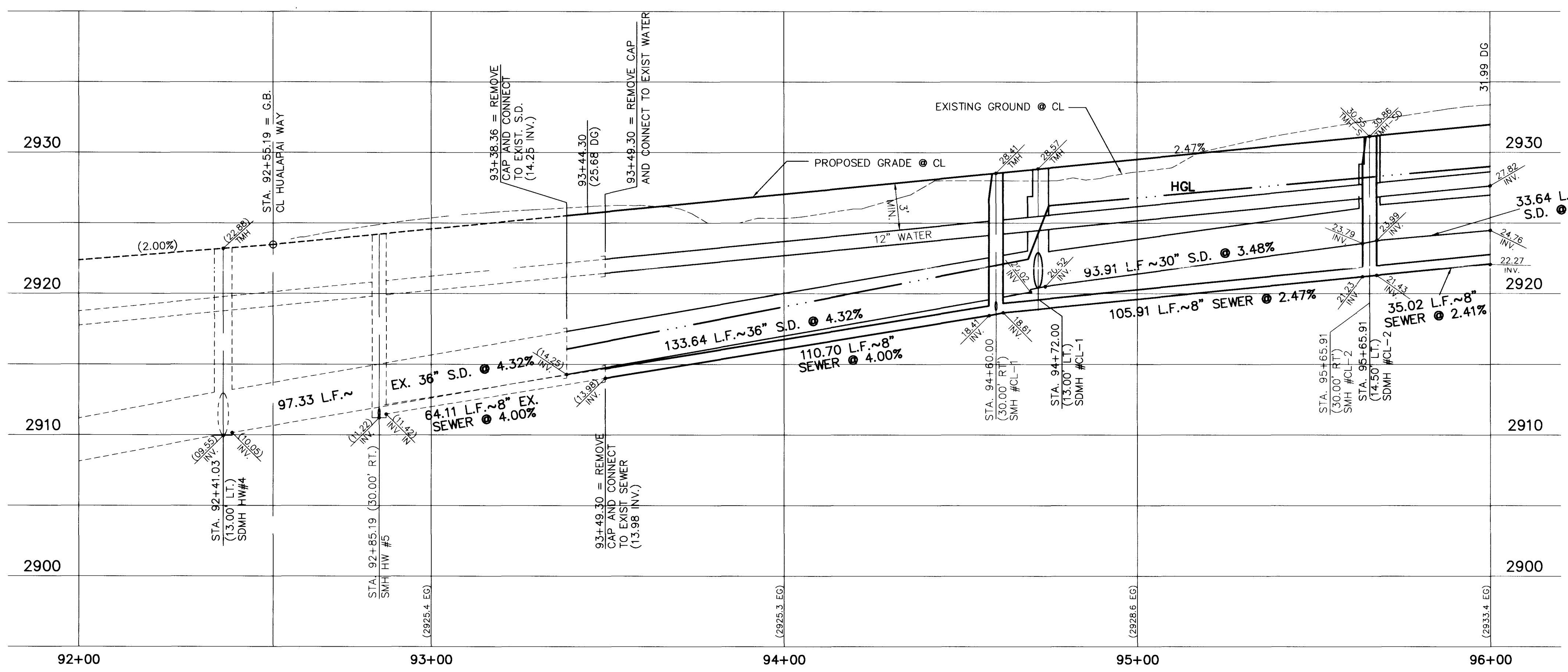

APPROVAL: _____

LAS VEGAS VALLEY WATER DISTRICT

ENGINEER
STATE OF NEVADA
REGISTERED PROFESSIONAL ENGINEER
BERT A. HUGHES
CIVIL
10259
R.P.E. NO. 10259
DATE REV. DATE DESCRIPTION

ENGINEER
STATE OF NEVADA
REGISTERED PROFESSIONAL ENGINEER
G.C. WALLACE, INC.
Engineering/Architecture
1585 SOUTH WANDY BLVD., LAS VEGAS, NEVADA 89102

SUMMERLIN
VILLAGE 8 UNIT 3 IMPROVEMENTS
CRESTDALE LANE
PLAN & PROFILE
STA. 92+55.19 TO STA. 96+00
THESE PLANS ISSUED FOR GRADING ONLY

SHEET **7**
SHT 7 OF 20

JOB NO. 62008.203

6.1.5, CP-1.DWG, 11/03/24

21-2-126 107-V2289

