

MATCHLINE STA. 10+00.00 - SEE SHT. C5.04

CROSSBRIDGE DRIVE

RESTRAIN JOINT NOTE:
 ALL FITTINGS AND JOINTS ON 16-INCH MAIN SHALL MECHANICALLY BE RESTRAINED. AMARILLO FAST-GRIP GASKET FOR RESTRAINING JOINTS IS A LVVWD APPROVED OPTION. THE 16-INCH DIP MAIN SHALL BE BONDED WITH 2-#2 AWG BOND CABLES PER JOINT PER DETAIL 4, C8.04. ALL THE 16-INCH FITTINGS AND VALVES SHALL BE BONDED PER DETAIL 9, C8.04.

FOR ALL DRY UTILITY CROSSINGS

- MAINTAIN MINIMUM 12" VERTICAL SEPARATION AT ALL POINTS OF CROSSING
- MAINTAIN MINIMUM 3" PARALLEL SEPARATION
- ANY EXCAVATION AT BACK OF CURB MUST REMAIN OPEN FOR INSPECTION OF COPPER SERVICE LATERALS. ANY COPPER SERVICE LATERAL KINKED, BENT OR OTHERWISE DAMAGED MUST BE REPLACED FROM THE MAIN TO THE ANGLE METER STOP.

VILLAGE 31
 APN:137-22-000-017

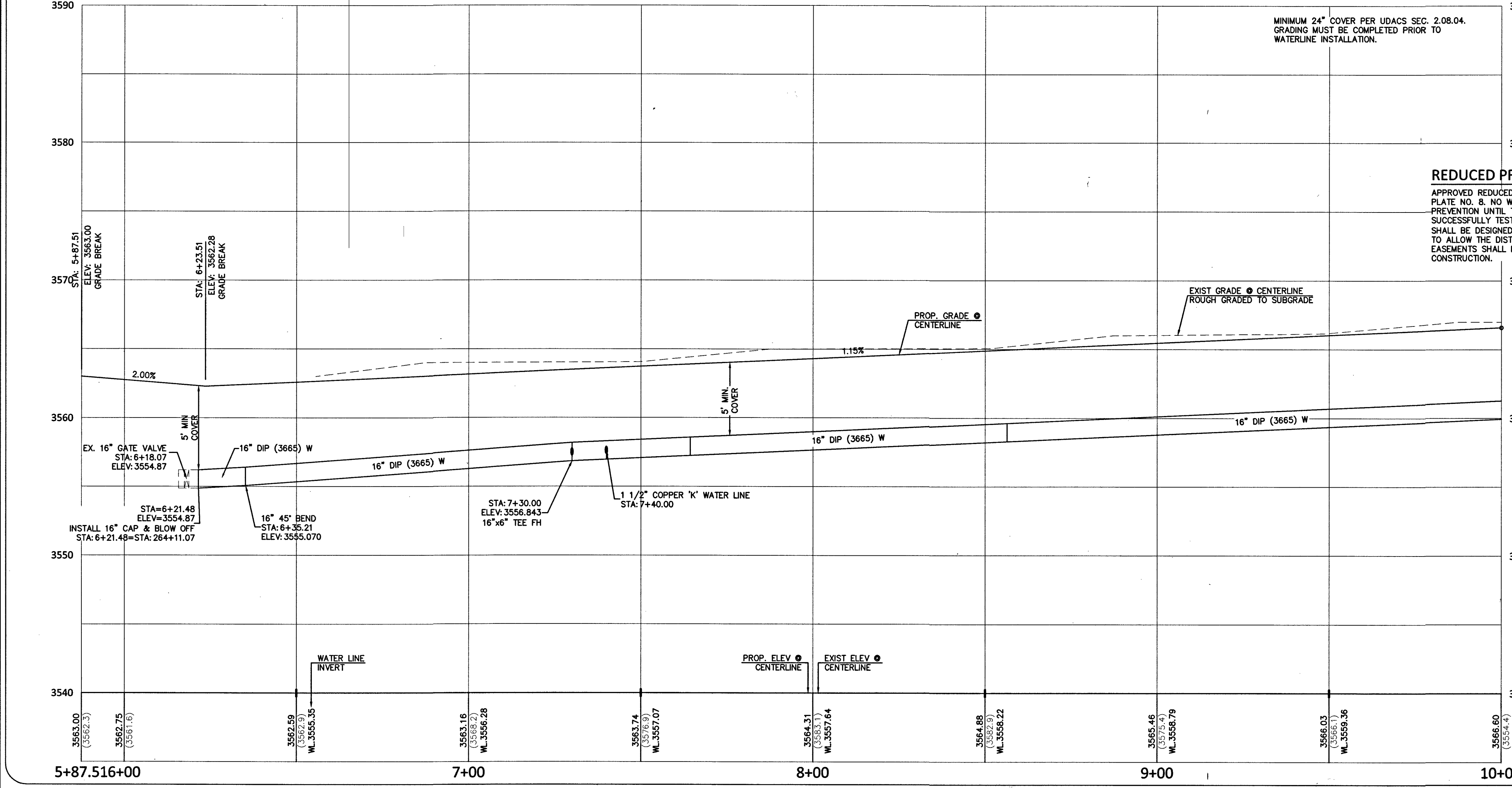

MINIMUM 24" COVER PER UDACS SEC. 2.08.04. GRADING MUST BE COMPLETED PRIOR TO WATERLINE INSTALLATION.

REDUCED PRESSURE PRINCIPLE ASSEMBLY (1) 1 1/2"

APPROVED REDUCED PRINCIPLE ASSEMBLY (S) SHALL BE INSTALLED PER THE UDACS PLATE NO. 8. NO WATER SHALL BE TAKEN FROM A SERVICE REQUIRING BACKFLOW PREVENTION UNTIL THE REDUCED PRESSURE PRINCIPLE ASSEMBLY HAS BEEN SUCCESSFULLY TESTED BY LVVWD. ANY BLOCK WALL OR OTHER FENCE MATERIAL SHALL BE DESIGNED AND CONSTRUCTED AROUND THE OUTSIDE OF THE EASEMENT(S) TO ALLOW THE DISTRICT DIRECT ACCESS FROM THE ADJACENT RIGHT-OF-WAY. EASEMENTS SHALL BE CLEARLY MARKED OR STAKED PRIOR TO THE START OF CONSTRUCTION.

CONSTRUCTION NOTES:

- ITEM: USDOCA: UNIFORM STANDARD DRAWINGS CLARK COUNTY AREA
- INSTALL "A" TYPE ISLAND CURB PER USD DWG NO. 219
- INSTALL "L" TYPE CURB & GUTTER PER USD DWG NO. 216
- INSTALL A.C. PAVEMENT PER TYPICAL STREET SECTION DETAILS
- INSTALL HANDICAP RAMP CURB DEPRESSION (BY OTHERS)
- VERIFY LOCATION AND ELEVATION OF EXISTING IMPROVEMENT. IF DISCREPANCY EXISTS, NOTIFY ENGINEER PRIOR TO CONSTRUCTION

WATER CONSTRUCTION NOTES: 16" WATER MAIN WITH RESTRAINED JOINTS (*)

- ITEM: UDACS: PLATE NO. PER UNIFORM DESIGN AND CONSTRUCTION STANDARD FOR WATER DISTRIBUTION SYSTEMS.
- INSTALL FIRE HYDRANT & ASSEMBLY (TEE & 6" GV) PER UDACS PLT. NO. 40 OR 41
- INSTALL TEE PER UDACS PLT. NO. 31 (*)
- INSTALL BEND PER UDACS PLT. NO. 31. (SEE PLAN FOR 4) (*)
- INSTALL GATE VALVE PER UDACS PLT. NO. 30 AND 39 (*)
- INSTALL REDUCER PER UDACS PLT. NO. 30 (*)
- INSTALL CAP W/ 2" BLOW-OFF ASSY PER UDACS PLT. NO. 36 (*)
- INSTALL 6" MANUAL BLOW OFF ASSY PER UDACS PLT. NO. 37
- CLSM CLASS 1 BACKFILL IN THE TRENCH ZONE PER UDACS PLATE NO. 17 & 19
- INSTALL VERT. 45° BEND PER UDACS PLT. NO. 31 (WITH RESTRAINED JOINTS)
- REMOVE CAP & BLOWOFF PER UDACS PLT. NO. 36 AND CONNECT TO EXISTING WATER LINE
- INSTALL 4" COMBINATION AIR VALVE PER UDACS PLT. NO. 38
- INSTALL 1 1/2" METER & RPPA PER UDACS PLT. NO. 4 & 8 & DETAIL SHEET C5.02 (BRASS BETWEEN METER & RPPA)
- INSTALL CROSS PER UDACS PLT. NO. 31 (*)

SEWER CONSTRUCTION NOTES:

- ITEM: DCSWCS DESIGN AND CONSTRUCTION STANDARDS FOR WASTEWATER COLLECTION SYSTEMS
- INSTALL 48" SEWER MANHOLE WITH SINGLE LID
- INSTALL 60" SEWER MANHOLE WITH SINGLE LID
- INSTALL 48" SEWER MANHOLE W/CORROSION PROTECTION WITH SINGLE LID
- INSTALL 60" SEWER MANHOLE W/CORROSION PROTECTION WITH SINGLE LID
- INSTALL TEMPORARY PLUG AND CAP SEWER STUB
- INSTALL ELASTOMERIC JOINT SEALANT AT ALL MANHOLE JOINTS PER DCSWCS 4.9.7
- REMOVE EXISTING PLUG AND CONNECT TO EXISTING SEWER LINE

STORM DRAIN CONSTRUCTION NOTES:

- ITEM: UDACS: PLATE NO. PER UNIFORM DESIGN AND CONSTRUCTION STANDARD FOR WATER DISTRIBUTION SYSTEMS.
- INSTALL TYPE 2 MODIFIED "CM2" DROP INLET PER USDOCA DWG. NO. 412.1 AND 421
- NOT USED
- INSTALL CAST-IN-PLACE MANHOLE PER DETAIL 7 SHEET C8.02
- INSTALL JUNCTION STRUCTURE
- INSTALL PRECAST MANHOLE TEE W/ 48" RISER
- INSTALL PRECAST MANHOLE TEE W/ 60" RISER
- INSTALL PRECAST ELBOW (SEE PLAN FOR 4)
- INSTALL TEMPORARY PLUG AND CAP STORM DRAIN LINE
- NOT USED
- INSTALL WATER TIGHT ELASTOMERIC JOINTS PER UDACS 2.22.02
- NOT USED
- REMOVE EXISTING PLUG AND CONNECT TO EXISTING STORM DRAIN LINE

SEWER CONNECTION NOTE:

ONE OR MORE SEGMENTS OF THE DOWNSTREAM SEWER SYSTEM THAT WILL SERVE THIS PROJECT HAS NOT BEEN COMPLETED AND OR ACCEPTED FOR MAINTENANCE BY THE CITY OF LAS VEGAS. ANY WORK DONE ON THIS PROJECT PRIOR TO THE COMPLETION AND OR ACCEPTANCE OF THE DOWNSTREAM SEWER SYSTEM(S) SHALL BE DONE AT THE DEVELOPER'S OWN RISK. THE CITY OF LAS VEGAS RESERVES THE RIGHT TO PREVENT THE PHYSICAL CONNECTION OF THIS PROJECT INTO THE DOWNSTREAM SEWER SYSTEM UNTIL ALL SEGMENTS HAVE BEEN COMPLETED AND ACCEPTED FOR MAINTENANCE OR UNTIL SUCH TIME AS THEY ARE DEEMED AVAILABLE FOR SERVICE.

WATER MAIN JOINT DEFLECTION (DIP. 14"-24")

DIP PIPE SHALL BE DEFLECTED AT JOINT ONLY FOR PUSH-ON AND MECHANICAL TYPE DIP JOINTS. MAXIMUM DEFLECTION SHALL BE (1.5) DEGREES PER JOINT WITH A MINIMUM RADIUS OF CURVATURE OF 690 FEET FOR 18 FEET OF PIPE LENGTHS AND 785 FEET FOR 20 FEET PIPE LENGTHS, PER UDACS 2.07.03. FOR CHANGES IN DIRECTION EXCEEDING THE MAXIMUM ALLOWABLE JOINT DEFLECTION, FITTINGS SHALL BE USED.

APPROVED FOR CONSTRUCTION
J. SHARAD, P.E.
 LAS VEGAS VALLEY WATER DISTRICT ENGINEERING SERVICES MANAGER
 DATE: 8/13/17 PROJECT NO: 124806
 LVVWD APPROVED FIRE FLOW 1500 GPM AT 20 PSI RESIDUAL

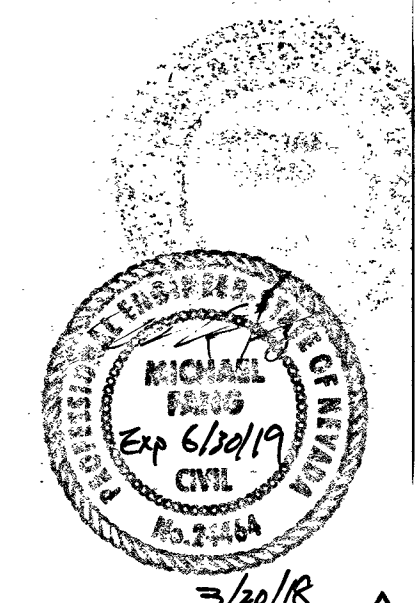

FOR REV 2 ONLY

COLLINS ENGINEERS
 3130 S. DURANGO DR., SUITE 404
 LAS VEGAS, NV 89117
 PHONE: (702) 248-8000
 FAX: (702) 248-8070
 www.collinsengr.com

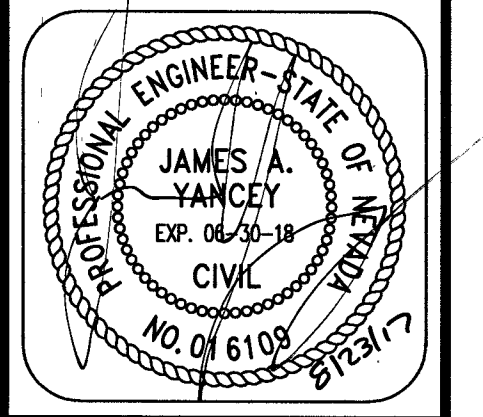

IMPROVEMENT PLANS FOR
THE HOWARD HUGHES COMPANY, LLC
 APN: 137-33-601-001
 UTILITY PLAN & PROFILE
 STA. 5+87.51 TO 10+00.00
 SUMMERLIN VILLAGE 24, CROSSBRIDGE DRIVE UNIT 3
 CITY OF LAS VEGAS

NO.	DATE	DESIGN BY	DESCRIPTION
1	02/12/18	J. M. Saldivar	REVISED PL LOCATION, ADJUSTED ST ELEVATIONS, ADDED 16" ELEV.
2			

CEI PROJECT:	9106
DESIGN BY:	J. SALDIVAR
DRAWN BY:	J. SALDIVAR
CHECKED BY:	K. YAMADA
DATE:	04/2017
SCALE:	1" = 20'
SHEET NUMBER	C5.03
	107V7063
	SHEET 8 OF 26
	H65276