

MATCHLINE - SEE SHEET 4

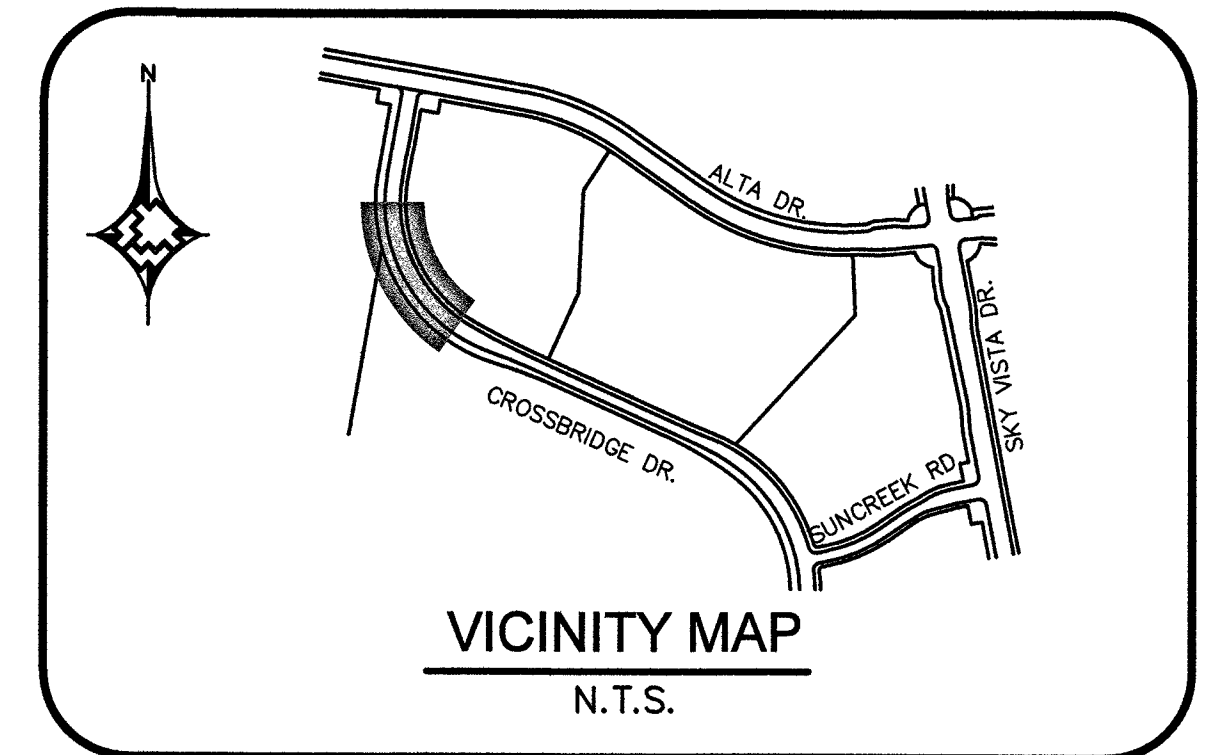

MATERIAL LIST FOR PROPOSED DISTRIBUTION FACILITIES		
ITEM#	STOCK ID#	DESCRIPTION
1	100-0033	PROPOSED 6" PE MAIN

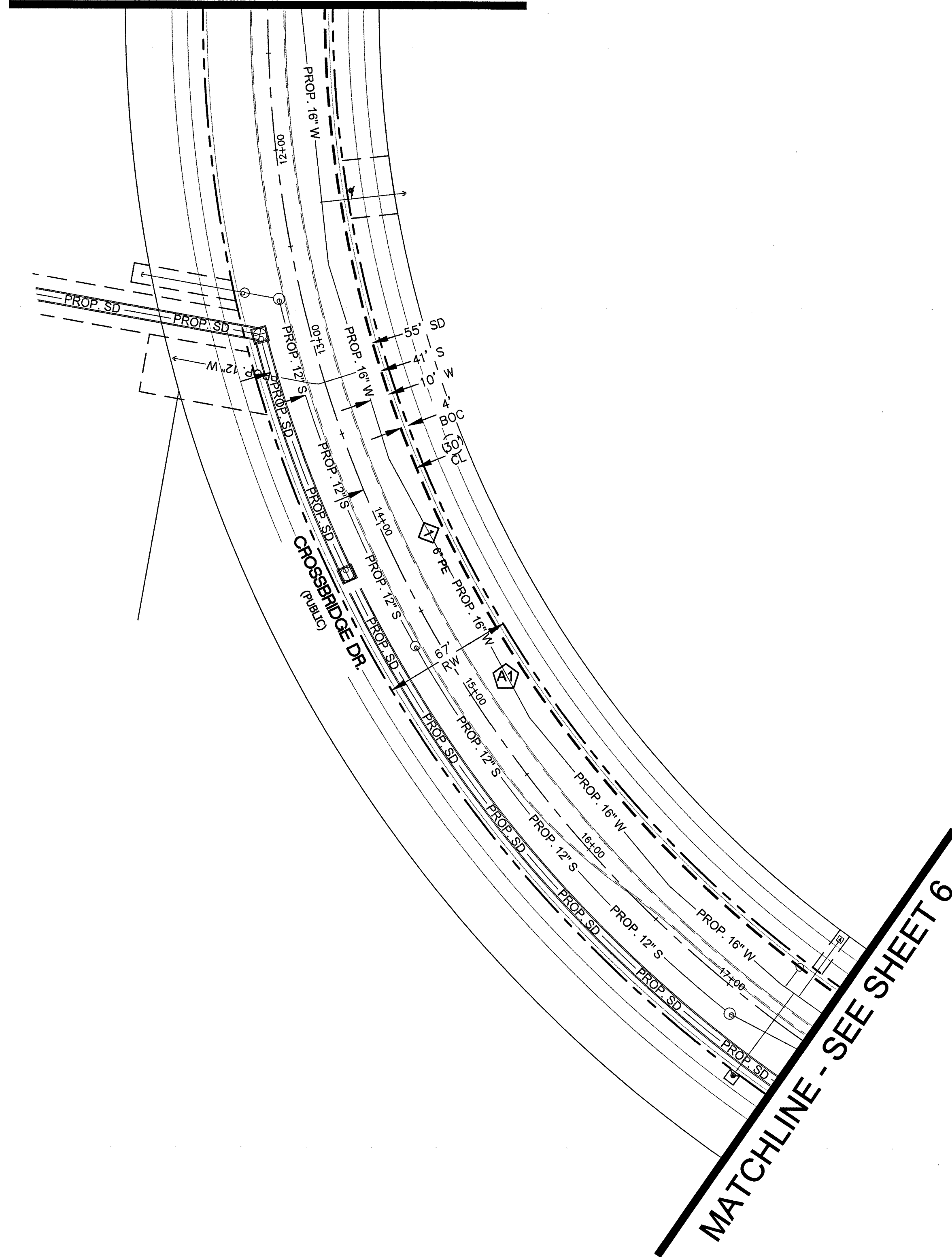

**RTC NOTES:**  
 PAVEMENT REPAIR SHALL CONFORM TO RTC:  
 A1 503

1. _____ 2. _____ 3. _____ 4. _____		AS-BUILT DRAWING-PRESSURE TEST DATA PIPE DIA. _____ TEST MEDIUM _____ TEST METHOD _____ PIPE LENGTH _____ <input type="checkbox"/> AIR <input type="checkbox"/> GAUGE PIPE TYPE _____ <input type="checkbox"/> NITROGEN <input type="checkbox"/> CHART MIN. DURATION _____ <input type="checkbox"/> WATER <input type="checkbox"/> GAUGE/ _____ <input type="checkbox"/> SOAP <input type="checkbox"/> PRESS REC SN# _____ TEST PRES. (PSIG): (MAX) _____ (MIN) _____ TIME: (START) _____ (STOP) _____ DATE: (START) _____ (STOP) _____ PERFORMED BY: _____ DATE VERIFIED BY: _____		INDIVIDUAL PERFORMING VISUAL INSPECTION VISUAL INSPECTION CERTIFICATION I HAVE VISUALLY INSPECTED ALL HEATED ELEMENTS, SOLVENT CEMENT, MECHANICAL JOINTS, AND WELDS THAT I HAVE PERFORMED DATE _____ NAME _____ INSPECTOR _____ FOREMAN _____ REVIEWED BY _____		CONSTRUCTION ISOLATION AREA 323 W.R. NO. 3213310 ENGINEER/TECH: PAMELA KENNEDY ACCOUNT REP: TONY STIPANOV PROJECT CONTACT: CHRISTOPHER ANDERSON SHEET NO: 5 OF 8 SCALE: 1"=40' DWN. BY: SEI DATE: 09/29/2017 CHKD. BY: _____ APPVD. BY: _____		PERMIT INFORMATION CITY OF LAS VEGAS TAX CODE 02-0200 LOCATION SEC 33 T20S R59E ATLAS #/TILE # x561y516 M.D.M.	
REVISIONS NO. DESCRIPTION BY DATE APPVD.		PROPERTY UNITS TAX CODES UNIT NO. UNIT TYPE INSTL. RETIRED INSTL. RETIRED PROPOSED COMPLETED		SOUTHWEST GAS CORPORATION		TITLE <b>SUMMERLIN VILLAGE 24          CROSSBRIDGE UNIT 3          DESIGN PLAN</b> Sheet 31 L-65276 107V7063			

DOC 3213310