

**T & S LEGEND**

- ☐ PULL BOX 3' X 5' X 4' WITH H20 LOADING BOLT DOWN COVER (TRAFFIC) MARKED "TELCO" AND FOUR 18 HOLE CABLE RACKS (2 EACH SIDE).
  - ☐ PULL BOX 2'-6" X 4' X 3' WITH H20 LOADING BOLT DOWN COVER (TRAFFIC) MARKED "TELCO".
  - ☐ UTILITY BOX 17' X 30' X 29 1/2" WITH H20 LOADING BOLT DOWN COVER (TRAFFIC) MARKED "TELCO".
  - ☐ SERVICE 9 5/8" X 16" X 12" WITH H20 LOADING COVER (TRAFFIC) MARKED "TELCO".
  - ☐ PROPOSED PULL BOX 3' X 5' X 4' WITH H20 LOADING BOLT DOWN COVER (TRAFFIC) MARKED "TELCO" AND FOUR 18 HOLE CABLE RACKS (2 EACH SIDE).
  - ☐ PROPOSED PULL BOX 2'-6" X 4' X 3' WITH H20 LOADING BOLT DOWN COVER (TRAFFIC) MARKED "TELCO".
  - ☐ PROPOSED UTILITY BOX 17' X 30' X 29 1/2" WITH H20 LOADING BOLT DOWN COVER (TRAFFIC) MARKED "TELCO".
  - ☐ PROPOSED SERVICE 9 5/8" X 16" X 12" WITH H20 LOADING COVER (TRAFFIC) MARKED "TELCO".
- 45 DEGREE BENDS TO BE SCHEDULE 40 PVC
- PROPOSED CONDUIT IF LESS THAN 4" USE DB-60 TYPE
  - PROPOSED CONDUIT IF LARGER THAN 4" USE DB-100 TYPE
  - PROPOSED 1" PVC CONDUIT (DIRECT BURIAL GRADE).
  - TRENCH ROUTE.
  - EXISTING 2", 3", 3 1/2", 4" OR 5" PVC CONDUIT.
  - EXISTING 1" CONDUIT.
  - ⊙ PROPOSED GROUND ATTACHMENT AT POWER TRANSFORMER.
  - ⊙ PROPOSED TRANSPOUNDER.

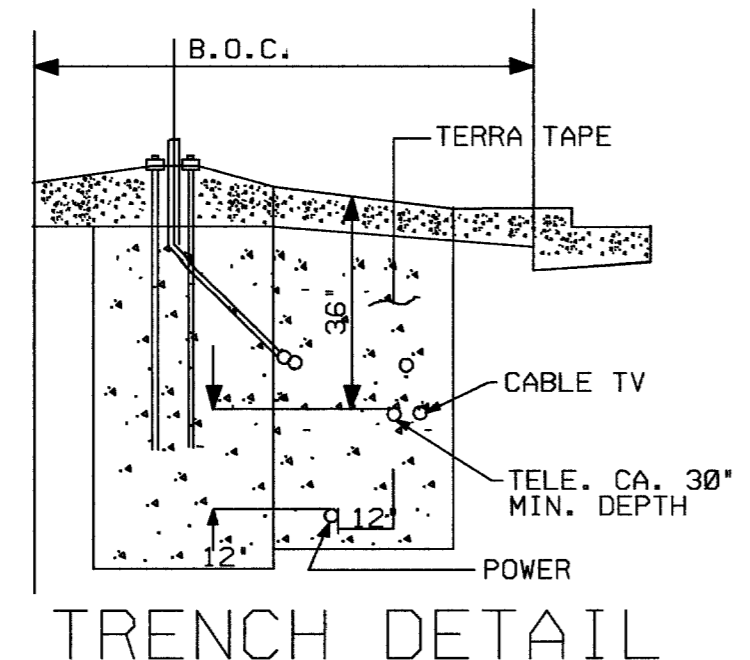

**TRENCH DETAIL**  
REV. 7/2/93

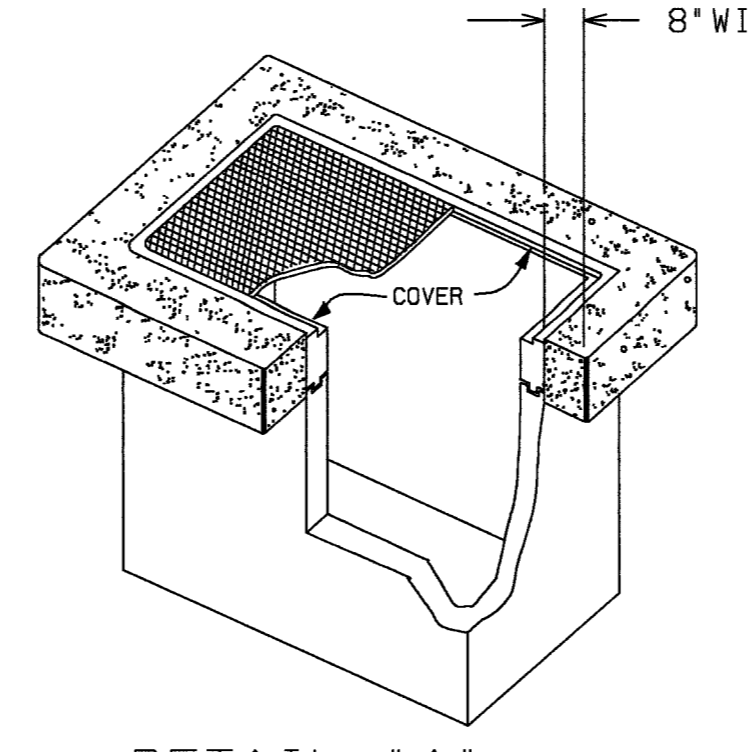
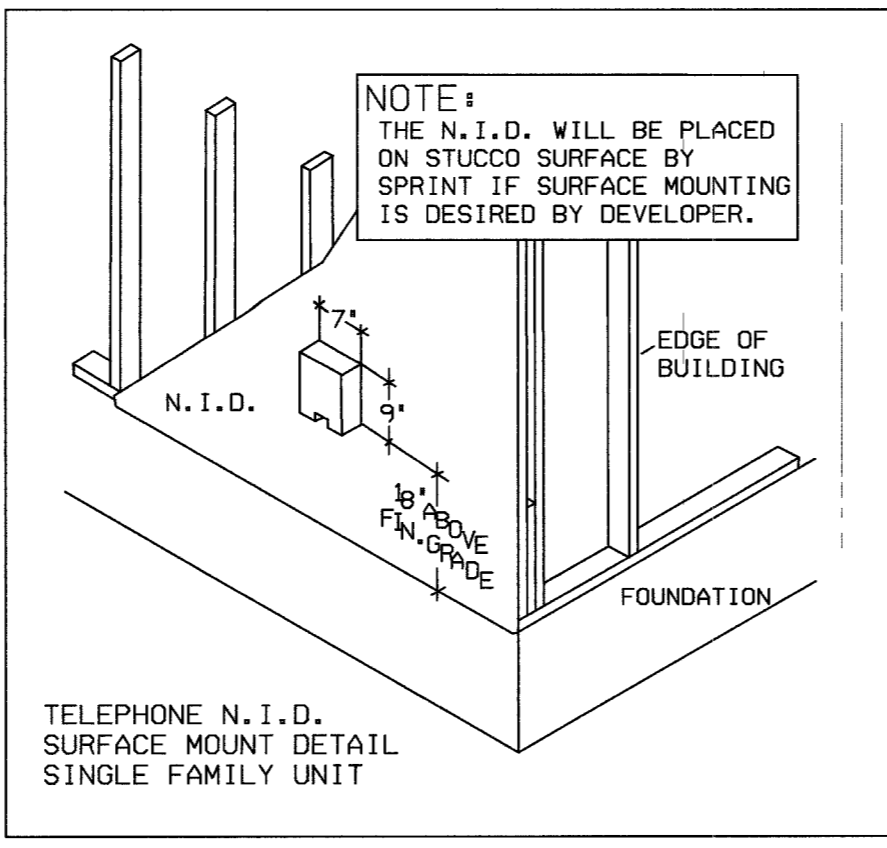

**DETAIL "A"**  
FOR COLLAR THICKNESS REFER TO SPRINT SPECIFICATION 8000

\*\*CONSULT SPRINT TELEPHONE COMPANY SPECIFICATION FOR 3'X5'X4' PULLBOX TO DETERMINE WHETHER "TORSION ASSIST" OR "BEAM AND PLATE" COVER WILL BE UTILIZED.

T 20S, R 59E  
APN 137  
5869' TEL CABLE IN ON-SITE TRENCH  
NO ON-SITE CONDUIT

---- CONTRACTOR / DEVELOPER ----  
CITY OF LAS VEGAS PERMIT REQUIRED  
DEVELOPER/CONTRACTOR SHALL OBTAIN A CITY PERMIT BEFORE ANY EXCAVATION WORK WITHIN CITY OF LAS VEGAS RIGHT OF WAY  
SPRINT INSPECTOR WILL VERIFY CITY PERMIT FOR WORK DONE WITHIN CITY OF LAS VEGAS RIGHT-OF-WAY  
CALL 244-7811 BETWEEN 7 A.M. AND 3 P.M. 24 HOURS IN ADVANCE FOR INSPECTION.  
ANY MODIFICATIONS TO SPRINT'S DESIGN MUST BE APPROVED BY THE ENGINEER.  
THESE PLANS WILL BE VALID FOR SIX MONTHS FROM DATE OF ISSUE

**SPECIAL NOTE:**  
ANY MODIFICATIONS TO SPRINT TELEPHONE'S DESIGN MUST BE APPROVED BY THE ENGINEER: MICHELL TURNER  
TEL #: 702-244-7791

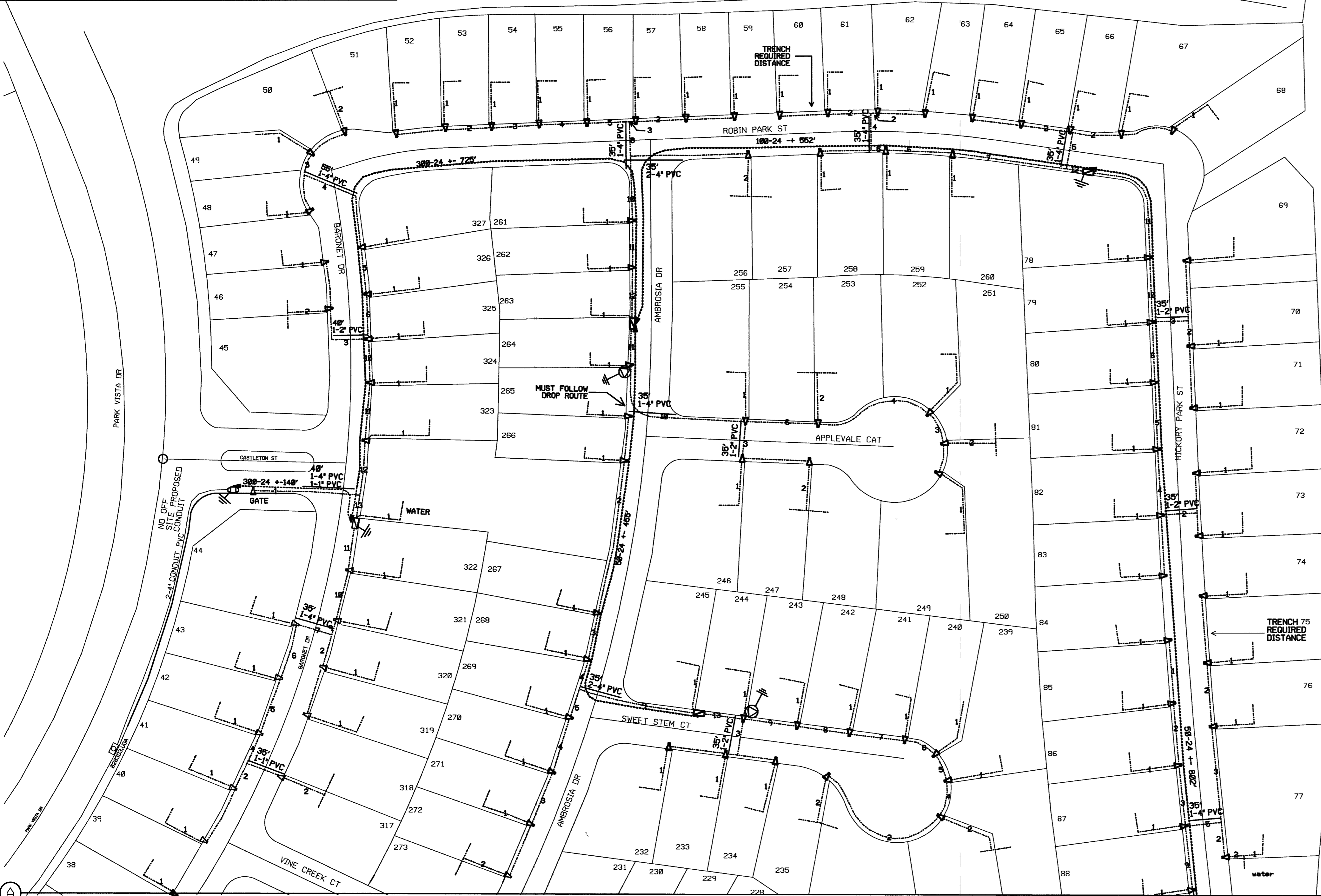
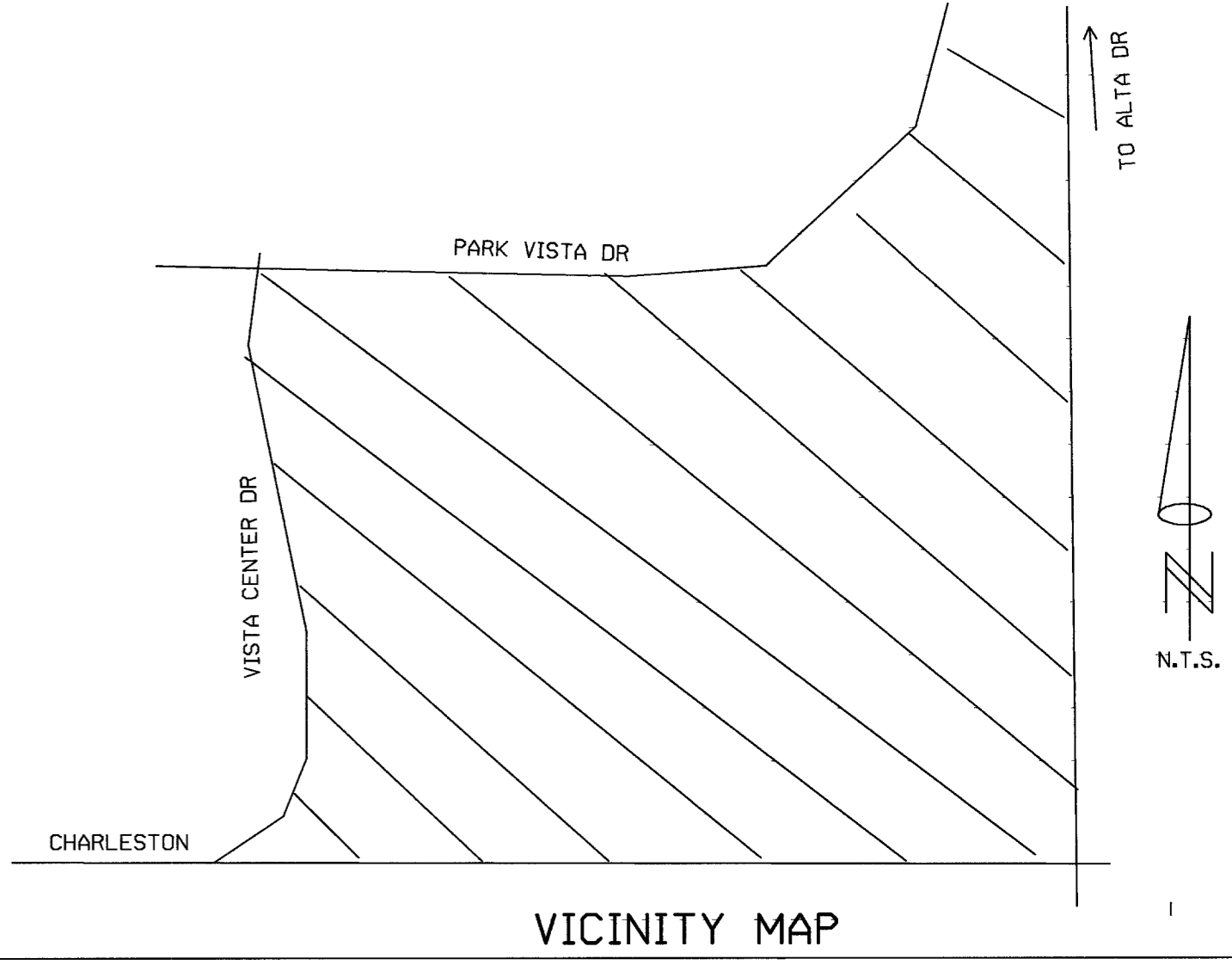

- GENERAL NOTES FOR T&S**
1. ALL CONSTRUCTION SHALL CONFORM TO SPRINT TELEPHONE COMPANY SPECIFICATIONS SEE LATEST ISSUE FOR THE INSTALLATION OF UNDERGROUND RESIDENTIAL DISTRIBUTION TELEPHONE SYSTEM.
  2. ALL TRENCHING, BACKFILLING AND SUBSTRUCTURES ARE TO BE PROVIDED BY THE DEVELOPER AND CONFORM WITH SPRINT STANDARDS.
  3. TRENCHING AND TELEPHONE BOXES ARE TO BE PLACED IN THE SIDEWALK AREA WHENEVER POSSIBLE. ALL TRENCHING WILL BE OF A MINIMUM DEPTH TO MAINTAIN A 30" COVER OVER ALL TELEPHONE FACILITIES AND 12" MINIMUM SEPARATION FROM FOREIGN UTILITIES. BOXES WILL BE ESTABLISHED TO FINISH GRADE.
  4. TRENCHING FOR STREET CROSSINGS IS TO BE OF A DEPTH NECESSARY TO MAINTAIN 30" COVER OVER TELEPHONE FACILITIES FROM FINISH GRADE AND 12" MINIMUM SEPARATION FROM FOREIGN UTILITIES. IF THE MINIMUM COVER CAN NOT BE PROVIDED, SPECIFICATIONS AT DEVELOPER'S EXPENSE.
  5. TRENCH AND SUBSTRUCTURE TO BUILDING MUST BE 18" FROM PROPERTY LINE WITH A MINIMUM DEPTH TO MAINTAIN 30" COVER FROM FINISH GRADE AND 12" MINIMUM SEPARATION FROM FOREIGN UTILITIES. WHEN THE TRENCH WILL BE UNDER PAVEMENT, DEVELOPER IS TO PROVIDE 1" CONDUIT UNDER PAVED AREA AT THE DEVELOPER'S OWN EXPENSE.
  6. ALL TELEPHONE BOXES THAT ARE SUBJECT TO VEHICULAR TRAFFIC WILL BE REQUIRED TO HAVE A PROTECTIVE 8" X 8" CONCRETE COLLAR POURED AROUND THE TOP PORTION OF THE BOX PER SPRINT SPECIFICATIONS.
  7. ANY CONDUIT PLACED FOR DEVELOPER'S CONVENIENCE (I.E. STREET CROSSING, STUB-OUTS FOR FUTURE UNITS) WILL BE PLACED AT DEVELOPER'S EXPENSE.
  8. ALL CONDUIT SHOWN AS SPRINT'S RESPONSIBILITY WILL BE REIMBURSED BASED UPON STANDARD CONTRACTOR PRICE LIST. CONTRACTOR MUST CONTACT SPRINT ENGINEER FOR CURRENT PRICING PRIOR TO CONSTRUCTION.
  9. CABLE RACKS WILL BE INSTALLED IN ALL 3' X 5' X 4' PULL BOXES AND LARGER PER SPRINT SPECIFICATIONS.
  10. WHEN DESIGNATED ON THE CONTRACT DRAWING(S) WITH A GROUNDING SYMBOL, THE DEVELOPER/CONTRACTOR SHALL PROVIDE AND INSTALL A #6 AWG STRANDED COPPER WIRE WITH GREEN PVC INSULATION FROM A SUBSTRUCTURE TO THE NEAREST POWER TRANSFORMER TO LEAVE A 4 FOOT TAILING END INSIDE THE SUBSTRUCTURE. THE DEVELOPER/CONTRACTOR WILL PROVIDE AND INSTALL ALL CLAMPS AS NECESSARY TO FASTEN THE GROUNDING WIRE TO THE TRANSFORMER GROUND ROD OR COUNTERPOISE. EXCEPT 30 BOXES, GROUND WIRE SHALL ENTER THE SUBSTRUCTURE THROUGH THE 1" PVC GROUND SLEEVE.
  11. THE DEVELOPER SHALL PROVIDE A #6 COPPER GROUND WIRE FROM EACH TERMINAL CABINET AND NETWORK INTERFACE DEVICE (NID) FOR A SINGLE FAMILY UNIT TO A COMMON GROUND WITH NEVADA POWER COMPANY PER THE NATIONAL ELECTRIC SAFETY CODE SPECIFICATIONS. ALL TERMINAL CABINETS WILL HAVE A 2" METAL RISER.
  12. IN SOME CASES A PULL BOX MAY HAVE TO BE RELOCATED FROM THE POSITION SHOWN ON THE DRAWING DUE TO INTERFERENCE WITH OTHER UTILITIES SUCH AS STREET LIGHTS, ETC. IF SUCH RELOCATION IS REQUIRED, THE ENGINEER SHALL BE NOTIFIED PRIOR TO RELOCATION.
  13. ALL PULL BOXES (2 1/2' X 4' AND LARGER) AND MANHOLES ARE TO BE GROUNDING WITH A 3/8" X 1/16" TINNED SOFT COPPER BONDING RIBBON PLACED VERTICALLY AROUND THE BOTTOM OF THE BOX WITH 3" ENDS STUBBED INSIDE.
  14. WHEN EXISTING TELEPHONE FACILITIES (POLES, MANHOLES, PULL BOXES, CONDUIT, TERMINALS, ETC.) ARE AFFECTED BY IMPROVEMENTS (REQUIRED BY LOCAL ORDINANCE, E.G. STREETS, SIDEWALKS, GUTTERS, ETC.) THE DEVELOPER SHALL BE RESPONSIBLE FOR THE ADJUSTMENT OF THESE FACILITIES AS REQUIRED.
  15. ALL 2 1/2' X 4' AND 3' X 5' PULL BOXES MUST BE INTERCEPT TYPE BOXES. BASE PORTION MUST BE SET PRIOR TO CABLE PULL. UPPER PORTION WILL BE PLACED AFTER CABLE PULL AND PRIOR TO SPLICING.
  16. ALL STUB-OUTS FROM PULL BOXES TO BACK OF SIDEWALK FOR SERVICE DROP WILL BE AT DEVELOPER'S OPTION AND EXPENSE.
  17. ALL PEDESTALS WILL BE PLACED NO CLOSER THAN 18" TO THE SIDE OF POWER TRANSFORMERS.
  18. FOR INSPECTION, CALL 244-7811 24 HOURS IN ADVANCE.

*[Signature]*  
CITY OF LAS VEGAS APPROVAL  
DATE: 11/4/05

OWNER/CONTRACTOR: HOWARD HUGHES  
G.C. WALLACE (VICKI HACKER)  
TELEPHONE: 804-4388

---- CONTRACTOR / DEVELOPER ----  
ALL WORK REQUIRED OF YOU (TRENCHING, BOXES, CONDUIT, GROUNDING, TERMINALS, ETC.) MUST BE COMPLETED AND INSPECTED A MINIMUM OF 45 DAYS PRIOR TO MOVE-IN IF OUR CUSTOMERS ARE TO HAVE TELEPHONE SERVICE WITHOUT DELAY

AVOID CUTTING UNDERGROUND UTILITY LINES. IT'S COSTLY.

**Call before you Dig.**

1-800-227-2600  
UNDERGROUND SERVICE (USA)

84854

SEE PRINT 2

Title: BURIED CA CONST. KINGWOOD PHASE 2	Township/Encodes: LAS VEGAS	Exchange: LAS VEGAS	Map: WW	Engineer: TURNER, MICHELL	Work Order: 2488854
Location: VILLAGE 20 PARCEL E, F & G	Manager: RICKY NAUGLE	CD: WW	Scale: 1"=50'	Phone: 702-244-7791	NO Create: 07/27/2004
					Print Date: 10/24/2005
					Sheets: 2 of 2

1074836-2-512