

CURVE DATA (1 INDICATES CURVE NUMBER)

CONSTRUCTION NOTES

IMPROVEMENTS

- INSTALL A.C. PAVEMENT PER STREET SECTIONS, SEE SHEET 19
- INSTALL "L" TYPE CURB & GUTTER (S-47)
- INSTALL "A" TYPE ISLAND CURB (S-50)
- INSTALL HANDICAP RAMP CURB DEPRESSION (S-75)
- WATER CROSSING PER L.V.V.W.D. STANDARDS (2/20)

WATER

- INSTALL TEMP. PLUG & CAP W/ 2" BLOW-OFF ASSEMBLY
- INSTALL FIRE HYDRANT ASSEMBLY (U-33)
- INSTALL 12" GATE VALVE & BOX (U-34)
- INSTALL 12" TEE

SEWER

- INSTALL 48" DIA. SEWER MANHOLE (S1-8 CLV)
- INSTALL TEMPORARY PLUG

STORM DRAIN

- INSTALL TYPE I STORM DRAIN MANHOLE (D1,D2)
- INSTALL TYPE II STORM DRAIN MANHOLE (D1,D4)
- INSTALL TEMPORARY PLUG
- INSTALL TYPE "C" DROP INLET (D-14)
- INSTALL MODIFIED TYPE "C" DROP INLET (1/20)

STREET LIGHTING

- STREET LIGHT OR COMMON TRENCH, SEE ELECTRICAL PLAN
- SINGLE STREET LIGHT, SEE ELECTRICAL PLAN (E-2)

IRRIGATION

- BANK "A"; 1-6" & 2-4" SDR35 PVC

NOTES

- ALL EXISTING UTILITY CROSSINGS MUST BE VERIFIED PRIOR TO CONSTRUCTION OF ANY MAIN LINES OR LATERALS THAT MAY BE ADVERSELY EFFECTED. ANY DISCREPANCIES IN LOCATION AND/OR ELEVATION MUST BE PROVIDED TO THE ENGINEER FOR ACCEPTANCE PRIOR TO CONSTRUCTION.
- ALL COMMON LOTS AS SHOWN HEREIN TO BE PRIVATELY MAINTAINED BY THE H.O.A.
- ALL WATER GATE VALVES, SERVICE GATE VALVES, AND FIRE HYDRANT GATE VALVES ARE TO BE CONSTRUCTED UNDER A.C. PAVEMENT. IT IS THE CONTRACTOR'S RESPONSIBILITY TO VERIFY THAT ALL WATER VALVE CANS DO NOT CREATE CONFLICTS WITH THE PROPOSED CURB LINE PRIOR TO PLACEMENT OF CONCRETE. ALL WATER FACILITIES SHOWN IN THESE DRAWINGS HAVE BEEN "SCALED UP" FOR CLARITY ONLY.

NOTE:
THIS SET OF DRAWINGS IS BASED UPON SUMMERLIN DATUM. PREVIOUS DRAWINGS MAY BE BASED ON OTHER DATUM. CARE SHOULD BE OBSERVED WHEN UTILIZING THIS SET OF DRAWINGS.

BENCHMARK

ID #	DESC.	NAVD 88 (FEET)	NAVD 88 (METERS)	SUMMERLIN DATUM
No. 0LV09-36SES	RIVET & PLATE IN TOP OF CURB, NE RETURN OF CHARLESTON BLVD. AND HUALAPAI WAY. (NO. 0LV09-36SES)	2912.23'	887.650	2910.05'

* THIS PROJECT BASED ON SUMMERLIN DATUM

INDIGO DRIVE

SCALE: HORIZ. 1" = 20'
VERT. 1" = 5'

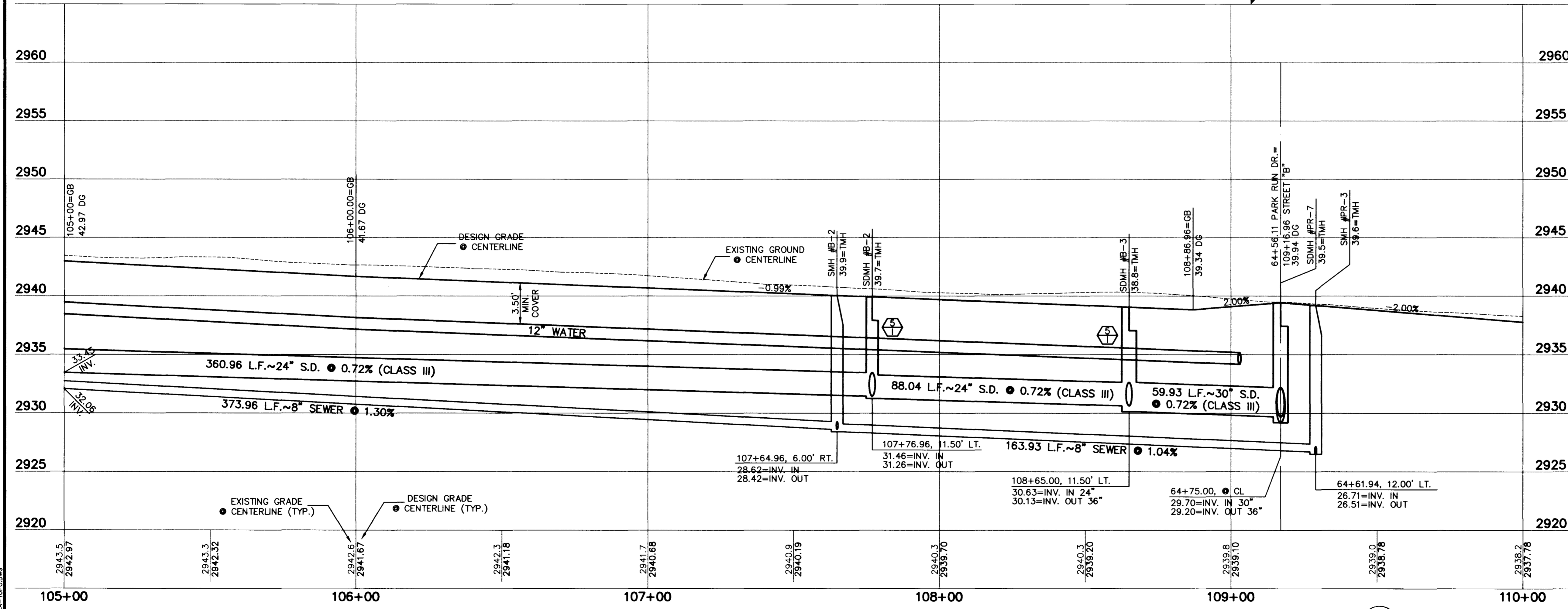
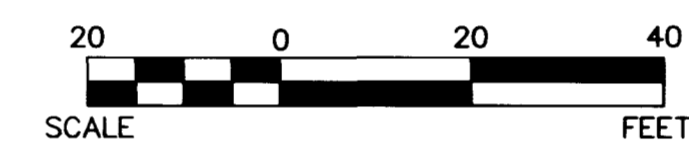
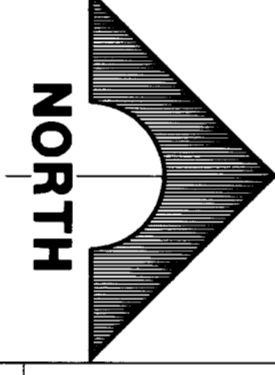

SHEET INDEX MAP

APPROVAL:

Brian Craft
LAS VEGAS VALLEY WATER DISTRICT

DATE: 8.6.97

SHEET 14

SHT 14 OF 28

C.C. WALLACE, INC.
ENGINEERING ARCHITECTURE
1545 SOUTH EAST AVE. SUITE 100, LAS VEGAS, NEVADA 89102 (702) 363-1200
SUMMERLIN DIVISION: (702) 363-0991

SUMMERLIN IMPROVEMENTS
VIL. 12 PARCEL AA IMPROVEMENTS
INDIGO DRIVE
PLAN & PROFILE
STA 105+00 TO 110+00

DATE: 8.6.97
APP. DATE: 8.6.97
REV. DATE: 8.6.97
DESCRIPTION: 10259
P.E. NO. 10259
RECOMMENDED BY: BERT A. HUGHES
CIVIL ENGINEER

JOB NO. 62012.214

AA-PP Fr1 Jul 25 11:45:56 1997 PLOT BY S.T.S.

107Y-4463-AA

