

SEWER NOTES

- ALL CONSTRUCTION AND MATERIALS SHALL BE IN ACCORDANCE WITH THE LATEST EDITION OF THE DESIGN AND CONSTRUCTION STANDARDS FOR WASTEWATER COLLECTION SYSTEMS AND THE UNIFORM STANDARD SPECIFICATIONS FOR PUBLIC WORKS' CONSTRUCTION OFF-SITE IMPROVEMENTS, CLARK COUNTY AREA, NEVADA, AS AMENDED. IN ALL CASES, THESE STANDARDS SHALL SUPERSEDE THE UNIFORM STANDARD SPECIFICATIONS. IT WILL BE THE RESPONSIBILITY OF THE CONTRACTOR TO BE AWARE OF THE CONTENTS OF THE ABOVE SPECIFICATION BOOKS.
- IT SHALL BE THE CONTRACTOR'S RESPONSIBILITY TO PERFORM CONSTRUCTION AS PER PLANS. ANY ADDITIONS, DELETIONS, OR CHANGES SHALL FIRST MEET WITH THE APPROVAL OF THE CONTROLLING AGENCY.
- CHISEL "S" OR "C" IN CURBS WHERE SEWER OR GAS LATERALS PASS UNDER THE CURB.
- POLYVINYL (PVC) SEWER PIPE SHALL MEET ASTM D-3034 SDR 35 SPECIFICATIONS, INSTALLED WITH THE SAND BEDDING AND BACKFILL OF TYPE II GRAVEL.
- ALL MANHOLES IN PAVED STREETS 80' R/W AND LARGER, SHALL HAVE CONCRETE COLLARS.
- TEE SADDLES SHALL BE USED TO CONNECT SEWER LATERALS TO EXISTING MAIN LINES UP TO 12" DIA. SIZE. CONNECTIONS TO 15" OR LARGER MAINS SHALL REQUIRE SPECIAL PROCEDURES.
- A SEWER MAIN CROSSING OVER A WATER MAIN OR LESS THAN 18" UNDER A WATER MAIN, MUST BE REINFORCED CONCRETE ENCASED FOR A DISTANCE NOT LESS THAN TEN FEET (10') TO EACH SIDE OF THE WATER MAIN.
- ALL CONTRACTORS INSTALLING SEWER MAINS THAT WILL BE UNDER THE JURISDICTION OF THE CONTROLLING AGENCY MUST BE CLASS "A" NEVADA CONTRACTORS.
- THE CITY OF LAS VEGAS WILL NOT ACCEPT ANY SEWER MAINS WHICH HAVE A VERTICAL DEFLECTION OF MORE THAN ONE TENTH (0.1) OF A FOOT FROM THE APPROVED CONSTRUCTION PLANS. SEWER MAINS FOUND TO EXCEED THIS TOLERANCE WILL HAVE TO BE REPAIRED OR REMOVED AND REPLACED TO THE SATISFACTION OF THE CITY ENGINEER PRIOR TO ACCEPTANCE BY THE CITY.
- HORIZONTAL CURVED SEWER ALIGNMENT NOTES:
 A. LINE AND GRADE STAKES @ 25' MAX. INTERVALS.
 B. 10" DIA. SEWER @ 350' MIN. RADIUS; 1.64" DEFLECTION PER 20' JOINT; 45' MAX. DELTA.
 C. 12" DIA. SEWER @ 450' MIN. RADIUS; 1.36" DEFLECTION PER 20' JOINT; 45' MAX. DELTA.
- INSTALLATION OF CURVED SEWER REQUIRES SPECIAL CONSTRUCTION PROCEDURES AND INSPECTIONS. CONTACT CITY OF LAS VEGAS CONSTRUCTION SERVICES PRIOR TO INSTALLATION.

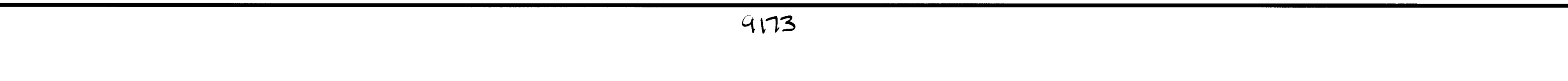
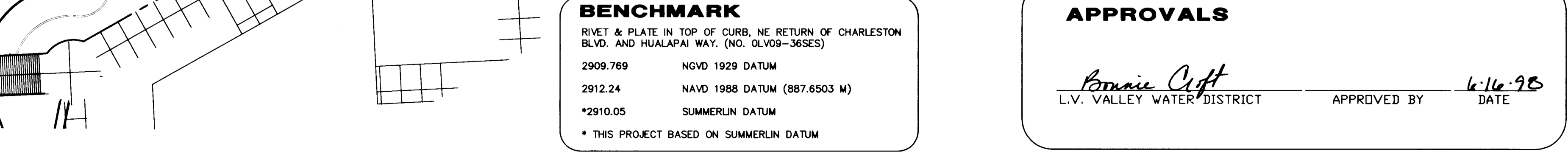
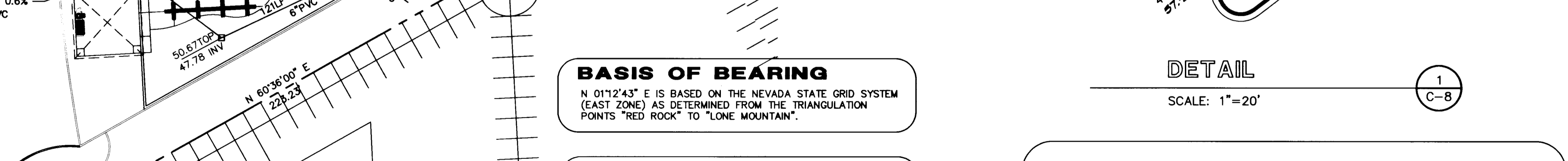
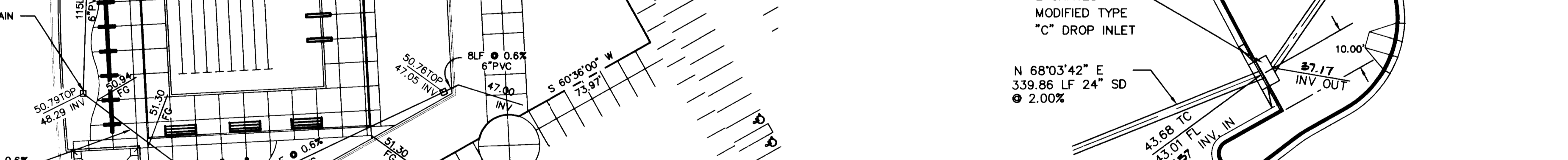
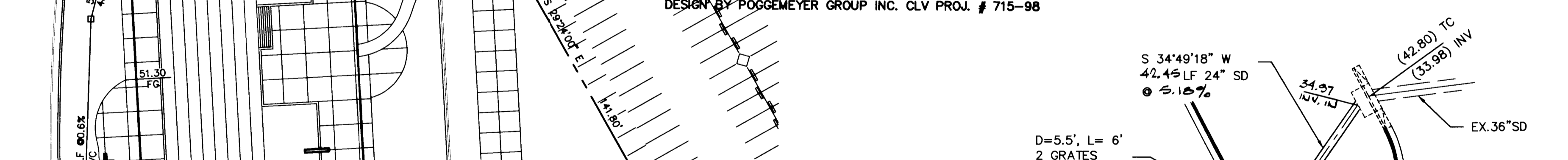
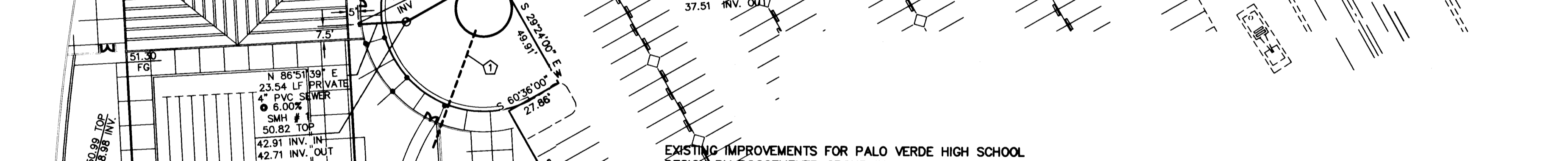
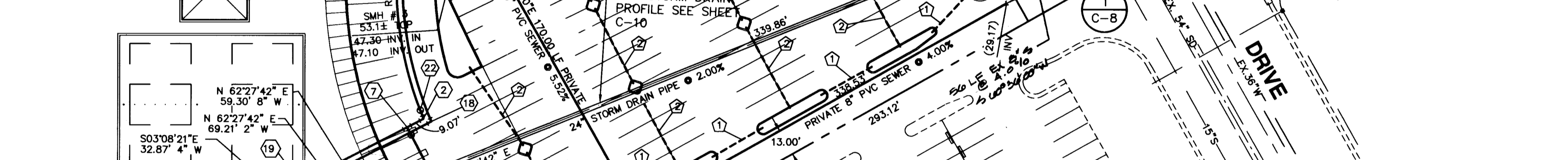
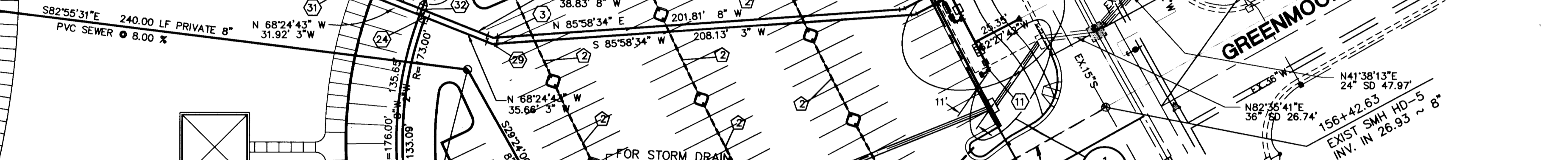
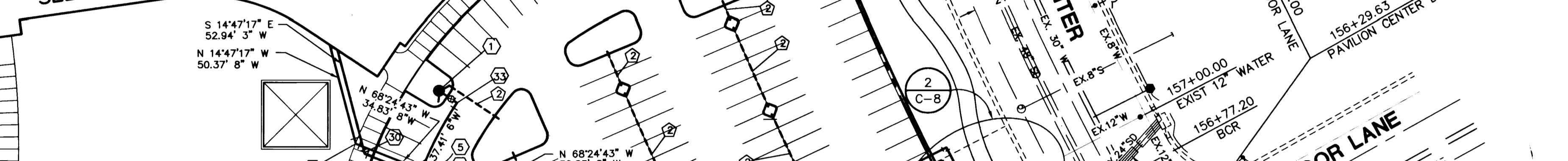
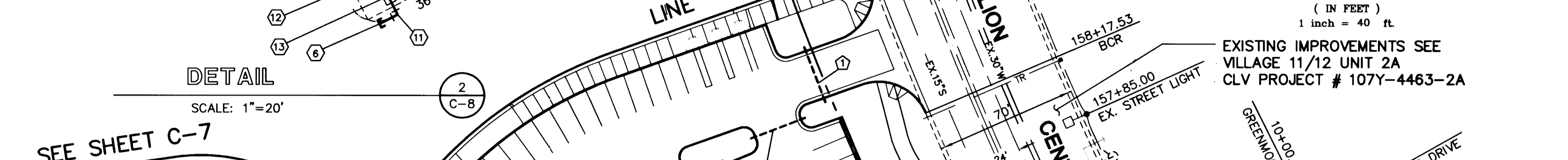

BASIS OF BEARING
 N 01°12'43" E IS BASED ON THE NEVADA STATE GRID SYSTEM (EAST ZONE) AS DETERMINED FROM THE TRIANGULATION POINTS "RED ROCK" TO "LONE MOUNTAIN".

BENCHMARK
 RIVET & PLATE IN TOP OF CURB, NE RETURN OF CHARLESTON BLVD. AND HUALAPAI WAY. (NO. 04V09-36SE5)
 2909.769 NGVD 1929 DATUM
 2912.24 NAVD 1988 DATUM (887.6503 M)
 *2910.05 SUMMERLIN DATUM
 * THIS PROJECT BASED ON SUMMERLIN DATUM

APPROVALS
 L.V. VALLEY WATER DISTRICT
 APPROVED BY *Bonnie Clift* DATE *6-16-98*

BASIS OF BEARING
 N 01°12'43" E IS BASED ON THE NEVADA STATE GRID SYSTEM (EAST ZONE) AS DETERMINED FROM THE TRIANGULATION POINTS "RED ROCK" TO "LONE MOUNTAIN".

BENCHMARK
 RIVET & PLATE IN TOP OF CURB, NE RETURN OF CHARLESTON BLVD. AND HUALAPAI WAY. (NO. 04V09-36SE5)
 2909.769 NGVD 1929 DATUM
 2912.24 NAVD 1988 DATUM (887.6503 M)
 *2910.05 SUMMERLIN DATUM
 * THIS PROJECT BASED ON SUMMERLIN DATUM

APPROVALS
 L.V. VALLEY WATER DISTRICT
 APPROVED BY *Bonnie Clift* DATE *6-16-98*

F:\388-173\dwg\imprv\PHASE1\SP1-ut2.dwg Sat May 16 09:17:26 1998 acabrera

STATE OF NEVADA
 PROFESSIONAL ENGINEER
 G.C. WALLACE, INC.
 Engineering/Architecture
 1525 SOUTH RAINBOW BLVD. LAS VEGAS, NEVADA 89102 (702) 363-1200
 SUMMERLIN DIVISION: (702) 363-0981

RECOMMENDED BY: CHRISTOPHER W. ANDERSON
 P.E. NO. 5071

DATE: _____
 ASSESSOR: _____
 DATE: _____

FINAL SUBMITTAL

SHEET C-8

JOB NO. 388.178

SHT 8 OF 12

650.49-1

