

CITY OF LAS VEGAS GENERAL NOTES

- ALL CONSTRUCTION AND MATERIALS SHALL BE IN ACCORDANCE WITH THE "UNIFORM STANDARD SPECIFICATIONS FOR PUBLIC WORKS CONSTRUCTION OFF-SITE IMPROVEMENTS, CLARK COUNTY AREA NEVADA", LATEST ISSUE; THE "UNIFORM STANDARD DRAWINGS FOR PUBLIC WORKS CONSTRUCTION, CLARK COUNTY AREA, NEVADA" LATEST ISSUE; AND OTHER APPLICABLE APPROVED STANDARDS ISSUED BY THE CONTROLLING AGENCY; THE UNIFORM BUILDING CODE; AND ALL LOCAL CITY CODES AND APPLICABLE ORDINANCES.
- LOCATIONS OF UNDERGROUND UTILITIES SHOWN ON THE DRAWINGS WERE OBTAINED FROM INFORMATION RECEIVED FROM THE APPLICABLE UTILITY COMPANIES. NEITHER THE OWNER NOR ENGINEER ASSUMES ANY RESPONSIBILITY FOR UTILITIES OR STRUCTURES NOT SHOWN, OR NOT IN THE LOCATION SHOWN ON THE DRAWINGS. CONTRACTOR TO VERIFY EXACT LOCATION OF UTILITIES PRIOR TO START OF CONSTRUCTION. THE CONTRACTOR'S RESPONSIBILITY REGARDING UTILITIES SHALL BE AS REQUIRED IN THE SUPPLEMENTAL SPECIFICATIONS, SPECIFICATIONS.
- THE CONTRACTOR SHALL TAKE ALL PRECAUTIONARY MEASURES TO PROTECT EXISTING UTILITY LINES, STRUCTURES, AND STREET IMPROVEMENTS WHICH ARE TO REMAIN IN PLACE, FROM DAMAGE, AND ALL SUCH IMPROVEMENTS OR STRUCTURES DAMAGED BY THE CONTRACTOR'S OPERATIONS SHALL BE REPAIRED OR REPLACED SATISFACTORY TO THE CITY ENGINEER OR OWNING UTILITY COMPANY AT THE EXPENSE OF THE CONTRACTOR.
- ALL CONSTRUCTION SHALL BE AS SHOWN ON THESE PLANS, ANY REVISIONS SHALL HAVE THE PRIOR WRITTEN APPROVAL OF THE CITY ENGINEER.
- TYPE V CEMENT SHALL BE USED IN ALL OFF-SITE CONCRETE WORK. CONCRETE TO BE 3000 P.S.I. MINIMUM AT 28 DAYS. MIX DESIGN TO BE APPROVED BY THE QUALITY CONTROL DIVISION PRIOR TO THE USE ON THE PROJECT.
- CONTRACTOR SHALL PROVIDE ALL NECESSARY HORIZONTAL AND VERTICAL TRANSITIONS BETWEEN NEW CONSTRUCTION AND EXISTING SURFACES TO PROVIDE FOR PROPER DRAINAGE AND FOR INGRESS AND EGRESS TO NEW CONSTRUCTION. THE EXTENT OF TRANSITIONS TO BE AS SHOWN ON PLANS, OR AS DESIGNATED IN THE FIELD BY A CITY INSPECTOR.
- THE CONTRACTOR SHALL TAKE ALL PRECAUTIONS NECESSARY TO PROTECT EXISTING PERMANENT SURVEY MONUMENTS. ANY MONUMENTS DISTURBED SHALL BE REPLACED AND ADJUSTED PER AVAILABLE RECORDS IN ACCORDANCE WITH N.R.S. STATUTE NO. 625.550.

SHEET INDEX

SHEET NO.	DESCRIPTION
1	COVER SHEET
2	NOTES, LEGEND, ABBREVIATIONS, SHEET INDEX & VICINITY MAP
3	GEOMETRIC & PLAN SHEET LAYOUT
4	STORM DRAIN PLANS--SUMMERLIN PKWY. STA. 565+00 TO STA. 571+00
5	STORM DRAIN PLANS--SUMMERLIN PKWY. STA. 579+00 TO STA. 589+00
6	STORM DRAIN PLANS--SUMMERLIN PKWY. STA. 589+00 TO STA. 593+50 -RCB STA. 29+00 TO STA. 30+00, STA. 31+10.63 TO STA. 36+00
7	DRAINAGE CHANNEL PLANS--SUMMERLIN PKWY. STA. 569+50 TO STA. 571+00
8	DRAINAGE CHANNEL PLANS--SUMMERLIN PKWY. STA. 571+00 TO STA. 583+00
9	DRAINAGE CHANNEL PLANS--SUMMERLIN PKWY. STA. 583+00 TO STA. 593+00 -RCB STA. 29+00 TO STA. 30+00, STA. 31+10.63 TO STA. 36+00
10	STORM DRAIN & DRAINAGE CHANNEL PROFILES--LINE "B" & "J2"
11	STORM DRAIN & DRAINAGE CHANNEL PROFILES--LINE "C" & "H"
12	STORM DRAIN PROFILES--LINES "A", "D", "E", "F" & "G"
13	DRAINAGE CHANNEL PROFILES--LINE "J1" & "J2"
14	DRAINAGE CHANNEL PROFILES--LINE "H"
15	TYPICAL SECTIONS--"H", "J1" & "J2" DRAINAGE DITCH
16	DETAILS--MODIFIED TYPE 2A DROP INLET, PIPE CONNECTION DETAILS TO 12"x7" RCB, PIPE COLLAR DETAIL, GRADING DETAILS & CONCRETE APRONS

VICINITY MAP

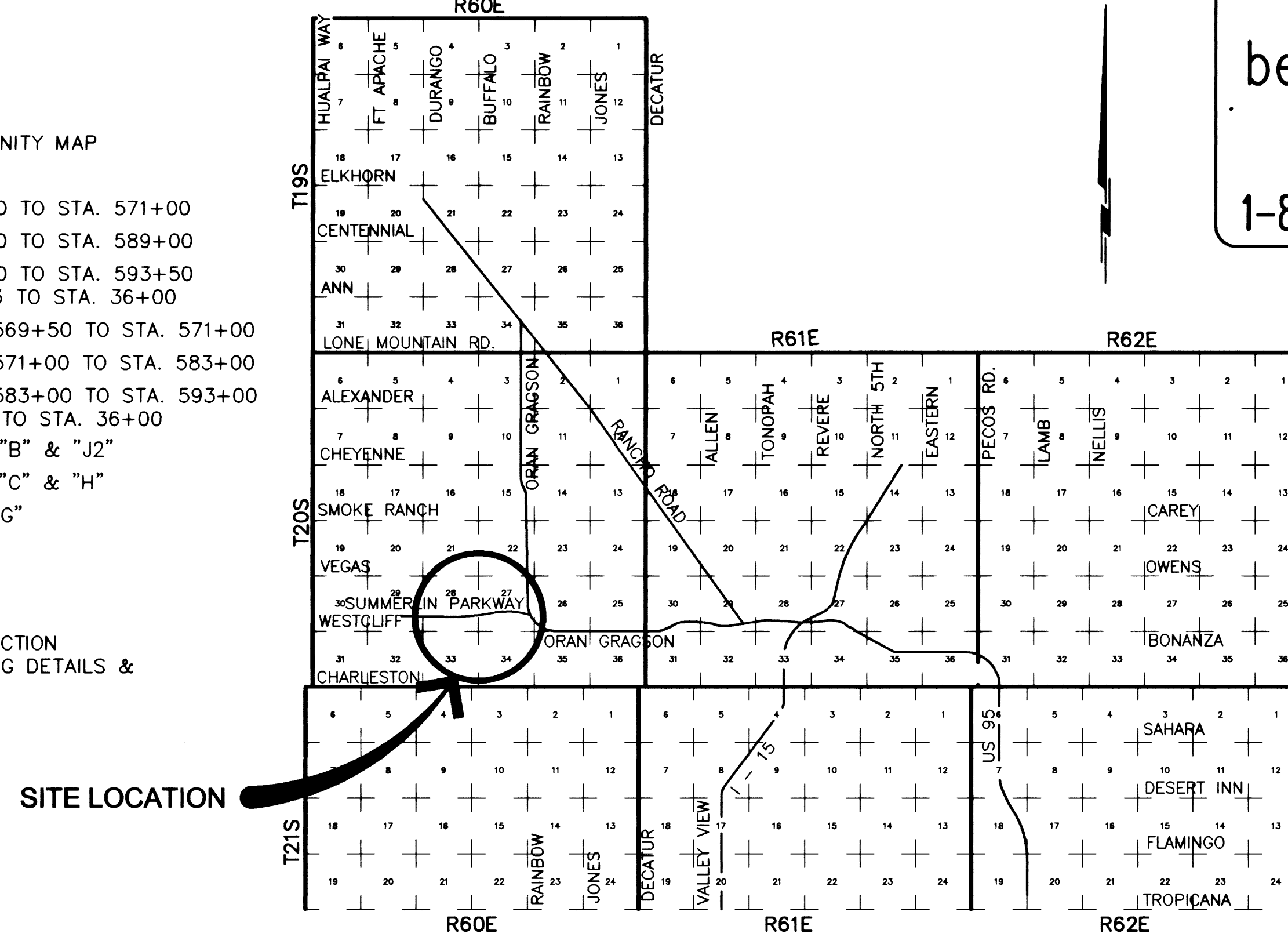

Avoid cutting underground utility lines. It's costly.

Call before you Dig.
1-800-227-2600

ABBREVIATIONS

REVISED 4/3/93

●	AT	LF	LINEAR FEET
AC	ASPHALTIC CONCRETE	LT.	LEFT
AGG.	AGGREGATE	MAX.	MAXIMUM
APPROX.	APPROXIMATE	MH	MANHOLE
ASSY.	ASSEMBLY	MIN.	MINIMUM
BOC, BC	BACK OF CURB	MTL.	MATERIAL
BCR	BACK OF CURB RADIUS	N	NORTH
BLDG.	BUILDING	NAP	NOT A PART
BLK.	BLOCK	NIC	NOT IN CONTRACT
BM	BENCHMARK	NTS	NOT TO SCALE
BVCS	BEGINNING VERTICAL CURVE STATION	OG	ORIGINAL GROUND
BVCE	BEGINNING VERTICAL CURVE ELEVATION	OHE	OVERHEAD ELECTRIC
BW OR BOW	BACK OF WALK	PVMT.	PAVEMENT
CL	CENTERLINE	PC	POINT OF CURVE
CATV	CABLE T.V.	PI	POINT OF INTERSECTION
CLV	CITY OF LAS VEGAS	PP	POWER POLE
COMM.	COMMERCIAL	PT	POINT OF TANGENCY
CONC., PCC	CONCRETE	PB	PULLBOX
CONST.	CONSTRUCTION	RP, PL	POINT OF VERTICAL INTERSECTION
CCSD	CLARK COUNTY STANDARD DRAWINGS	RCP	REINFORCED CONCRETE PIPE
CNDT.	CONDUIT	RAD.	RADIUS
C & G	CURB AND GUTTER	RES	RESIDENTIAL
DET.	DETAIL	RET.	RETAINING
DIA.	DIAMETER	RT.	RIGHT
DI	DROP INLET	R/O-W	RIGHT OF WAY
D/W	DRIVEWAY	R/W	RIGHT OF WAY
DWG.	DRAWING	S.	SOUTH
E.	EAST	SD	STORM DRAIN
EA	EACH	SF	SQUARE FOOT
EG	EX. GROUND OR EDGE OF GUTTER	SHT.	SHEET
EOP, EP	EDGE OF PAVEMENT	SS	SANITARY SEWER
ELEV.	ELEVATION	ST.	STREET
EVCS	END VERTICAL CURVE STATION	STA.	STATION
EVCE	END VERTICAL CURVE ELEVATION	STD.	STANDARD
EXIST., EX.	EXISTING	SY	SQUARE YARD
EXP. JT.	EXPANSION JOINT	S/W	SIDEWALK
FOC	FACE OF CURB	TC	TOP OF CURB
FL	FLOWLINE	TEMP.	TEMPORARY
FG	FINISHED GRADE	T.G.	TOP OF GRADE
FH	FIRE HYDRANT	TMH	TOP OF MANHOLE
FT.	FOOT/FEET	TRANS.	TRANSITION
FUT.	FUTURE	TYP.	TYPICAL
GB	GRADE BREAK	UON	UNLESS OTHERWISE NOTED
GM	GAS METER	VC	VERTICAL CURVE
GV	GAS VALVE	VG	VALLEY GUTTER
HOR.	HORIZONTAL	WC	WHEEL CHAIR
INTX.	INTERSECTION	W.	WEST
INV.	INVERT	WM	WATER METER
K	CURVE COEFFICIENT	WPJ	WEAKENED PLANE JOINT
L	LENGTH	WV	WATER VALVE
		W/	WITH

LEGEND

EXISTING	PROPOSED
TREE	AC PAVEMENT
BUSH	BLOCK WALL
CHAIN-LINK FENCE	SEWER W/MANHOLE
BLOCK WALL	WATER
SEWER	GAS
WATER	UNDERGROUND ELECTRIC
GAS	CABLE T.V.
OVERHEAD ELECTRIC	STORM DRAIN W/MANHOLE
UNDERGROUND ELECTRIC	UNDERGROUND TELEPHONE
CABLE T.V.	DRIVEWAY
STORM DRAIN	CURB AND GUTTER
UNDERGROUND TELEPHONE	FIRE HYDRANT
IRRIGATION	WATER VALVE
DRIVEWAY	WATER METER
CURB AND GUTTER	ELECTRICAL PULLBOX
FIRE HYDRANT	TRAFFIC SIGNAL PULLBOX
UTILITY VALVE	STREETLIGHT
WATER METER	WATER METER
ELECTRICAL PULLBOX	ELECTRICAL PULLBOX
TRAFFIC SIGNAL PULLBOX	TRAFFIC SIGNAL PULLBOX
SEWER MANHOLE	STREET SIGN
STORM DRAIN MANHOLE	DROP INLET
ELECTRICAL MANHOLE	SIDEWALK RAMP
TELEPHONE MANHOLE	ELEVATION
STREETLIGHT	DIRECTION OF FLOW OR SLOPE
POWER POLE	MONUMENT
STREET SIGN	TRAFFIC SIGNAL
DROP INLET	TRAFFIC CONTROLLER
SIDEWALK RAMP	MAILBOX
ELEVATION	EDGE OF PAVEMENT
MONUMENT	CENTERLINE
TRAFFIC SIGNAL	PROPERTY LINE
TRAFFIC CONTROLLER	
MAILBOX	

WATER LINE NOTES

- NO WORK SHALL BEGIN ON THE WATER PLANS UNTIL THEY HAVE BEEN RELEASED FOR CONSTRUCTION BY LVVWD FOLLOWING WATER PLAN APPROVAL. 48 HOUR NOTICE SHALL BE GIVEN TO LVVWD COMMUNICATION SUPPORT CENTER (258-7171) PRIOR TO THE START OF CONSTRUCTION. NOTICE MUST BE GIVEN BY 2:00 PM THE BUSINESS DAY PRIOR TO A LVVWD INSPECTION.
 - ALL WORK SHALL CONFORM TO LVVWD STANDARD PLATES, DRAWINGS, SPECIFICATIONS AND THE UNIFORM DESIGN AND CONSTRUCTION STANDARDS FOR WATER DISTRIBUTION SYSTEMS, LATEST EDITION.
 - ALL WORK, EXCEPT AS MODIFIED BY THESE PLANS OR BY NOTE 2, SHALL BE DONE IN ACCORDANCE WITH THE MOST CURRENT DRAFT OR ADDITION OF THE UNIFORM STANDARD SPECIFICATIONS FOR PUBLIC WORKS CONSTRUCTION OFF SITE IMPROVEMENTS, CLARK COUNTY AREA.
 - A SINGLE PIPE MATERIAL SHALL BE USED THROUGHOUT THE PROJECT UNLESS OTHERWISE APPROVED BY THE LVVWD.
 - ALL SERVICE LATERALS TWO (2) INCHES IN DIAMETER AND SMALLER SHALL BE COPPER TUBING WITH LVVWD APPROVED SERVICE SADDLES.
 - ALL WATER METER BOXES SHALL BE LOCATED OUTSIDE OF DRIVEWAY AREAS.
 - ALL VALVES SHALL BE LOCATED OUTSIDE OF DRIVEWAYS, VALLEY AND CURB GUTTERS.
 - THE FOLLOWING REQUIREMENTS MUST BE MET IN THE EVENT A WATER LINE AND SANITARY OR STORM SEWER LINE CROSS
 - A MINIMUM EIGHTEEN (18) INCH VERTICAL SEPARATION (OUTSIDE TO OUTSIDE) MUST BE MAINTAINED WHEN THE WATER LINE IS INSTALLED OVER THE SANITARY OR STORM SEWER LINE. IF THE VERTICAL SEPARATION CANNOT BE MAINTAINED OR THE WATER LINE MUST BE PLACED UNDER THE SANITARY OR STORM SEWER LINE, THE SANITARY OR STORM SEWER LINE MUST BE CONSTRUCTED WITH ONE OF THE FOLLOWING OR, AS SHOWN ON THESE PLANS:
 - POTABLE WATER SUPPLY QUALITY MATERIAL
 - ENCASEMENT, WITH FOUR (4) INCH CONCRETE (MINIMUM)
 - SLEEVING WITH POTABLE WATER SUPPLY QUALITY PIPE
 - EACH PROVISION MUST EXTEND ALONG THE SANITARY OR STORM SEWER, ON EITHER SIDE OF THE MAIN, A MINIMUM 10 FOOT DISTANCE PERPENDICULAR TO THE WATER MAIN EXTERIOR.
 - WARNING TAPE SHALL BE REQUIRED OVER ALL MAINS, ALL SIX (6) INCH DIAMETER AND LARGER SERVICE LATERALS, AND ANY SERVICE LATERAL NOT INSTALLED PERPENDICULAR TO THE MAIN IN ACCORDANCE WITH STANDARD PLATE NO. 27
 - ALL WATER FACILITIES SHALL BE FILLED, DISINFECTED, PRESSURE TESTED, FLUSHED, FILLED AND AN ACCEPTABLE WATER SAMPLE OBTAINED, PRIOR TO CONNECTION TO THE LVVWD'S DISTRIBUTION SYSTEM.
 - THE CONTRACTOR MUST OBTAIN ALL METERS TWO (2) INCHES AND SMALLER FROM THE LVVWD CENTRAL STORES. TELEPHONE (258-3152) FORTY EIGHT (48) HOURS PRIOR TO PICKUP.
 - CONSTRUCTION MAY INTERRUPT SERVICE WITH LVVWD APPROVAL AND PROPER NOTIFICATION, BETWEEN THE HOURS OF 10 PM AND 6 AM, SUNDAY THROUGH THURSDAY. CIRCUMSTANCES MAY REQUIRE TEMPORARY SERVICE FEEDS BE INSTALLED, WITHOUT LVVWD REIMBURSEMENT, ANY TEMPORARY SERVICE FEED MUST HAVE PRIOR LVVWD APPROVAL.
 - ALL WATER FACILITY CONSTRUCTION MATERIALS USED MUST BE AS LISTED ON THE LVVWD'S PRE-APPROVED MATERIALS AND MANUFACTURERS LISTING FOR NEW FACILITIES, LATEST REVISION, OR SPECIFICALLY APPROVED ON THESE PLANS.
- EXTEND SERVICE LATERALS 2" AND SMALLER**
- WATER METERS IN FINISHED ROADWAYS SHALL BE RELOCATED TO THE BACK OF CURB AND SHALL BE INSTALLED PER THE LVVWD STANDARD PLATE NO. 1 OR 2.
- ALL SERVICE LATERALS 2" AND SMALLER MAY BE EXTENDED, PROVIDED THE FOLLOWING CRITERIA ARE MET:
- LATERAL CAN ONLY BE EXTENDED IF CONNECTING TO COPPER
 - LATERAL MUST BE INSTALLED AT 90 DEGREES TO THE MAIN
 - AN EXISTING SERVICE LATERAL THAT IS NOT COPPER AND IS TO BE ABANDONED FROM THE EXISTING WATER MAIN, SHALL HAVE THE CORPORATION STOP TURNED OFF AT THE MAIN, THE LATERAL CUT 6" DOWNSTREAM FROM THE CORPORATION STOP AND CUT AGAIN 6" DOWNSTREAM FROM THE FIRST CUT SUCH THAT A 6" PIECE OF THE EXISTING LATERAL IS REMOVED. IF THE CORPORATION STOP IS DAMAGED BEYOND REPAIR OR PULLED FROM THE EXISTING MAIN, THE MAIN SHALL BE REPAIRED AT THE CONTRACTOR'S EXPENSE, IN A MANNER APPROVED BY THE LVVWD. IF THE CORPORATION STOP IS NOT WATER TIGHT, THE CONTRACTOR SHALL NOTIFY LVVWD COMMUNICATION SUPPORT CENTER (258-7171) FOR FURTHER DIRECTION.

DATE: _____

REVISIONS: _____

SCALE (H) N/A N/A N/A N/A

SCALE (V) N/A N/A N/A N/A

DATE 6/30/98

DESIGN BY R.E.

W.A. # WU0000

PROJECT ENGINEERING CONSULTANTS, LTD.

7320 SMOKE RANCH ROAD, SUITE H LAS VEGAS, NV 89128 PH. (702) 360-1044

DEPARTMENT OF PUBLIC WORKS

SUMMERLIN PARKWAY DRAINAGE IMPROVEMENTS AT BUFFALO DRIVE

NOTES, LEGEND, SHEET INDEX & VICINITY MAP

SHEET: _____

DRAWING NO. 307-V249

2/16

L:\2002\02.dwg JDM 06/29/98 07:58:19