

RECOMMENDED	DATE	DESCRIPTION	DATE	REV.
CHRISTOPHER W. ANDERSON	5/07			

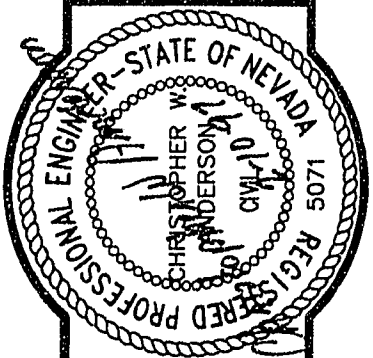

C.C. WALLACE, INC.
Engineering/Architecture
1535 SOUTH HANBURY BLVD/LAS VEGAS, NEVADA 89102

SUMMERLIN
VILLAGE 11/12 THE ARBORS-UNIT 3A-B
TYPICAL STREET SECTIONS

SHEET
25
SHT 25 OF 43

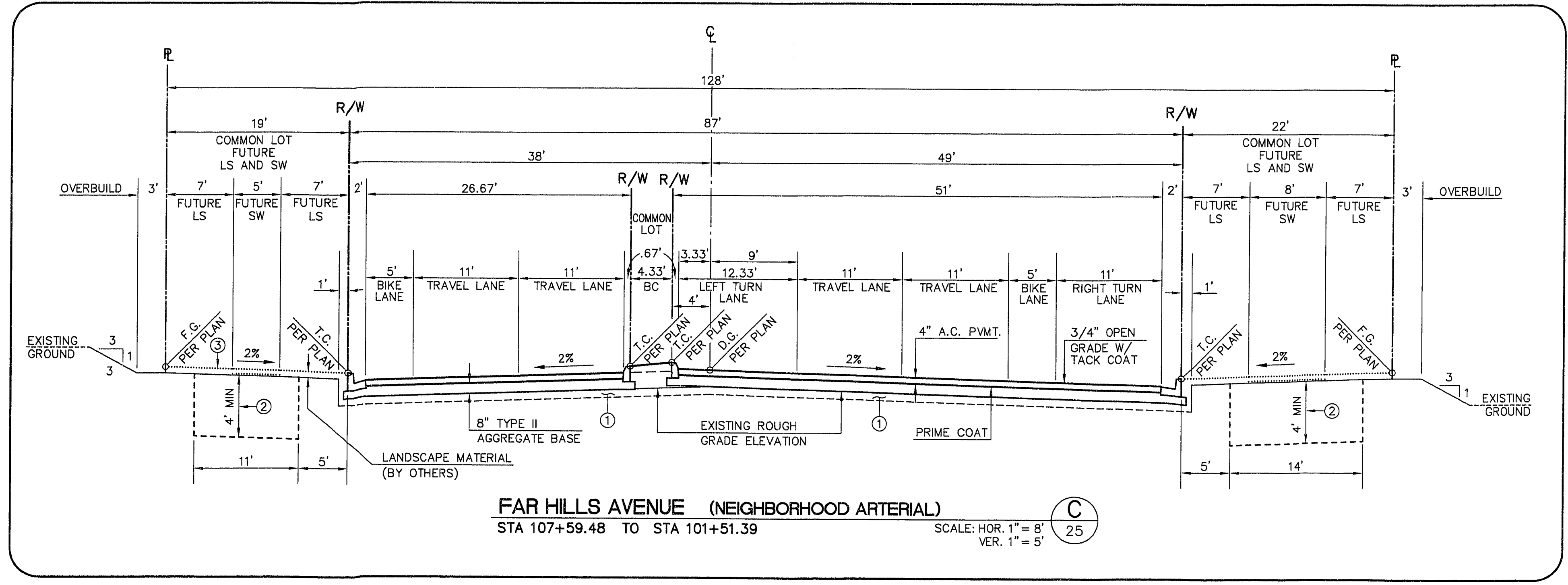
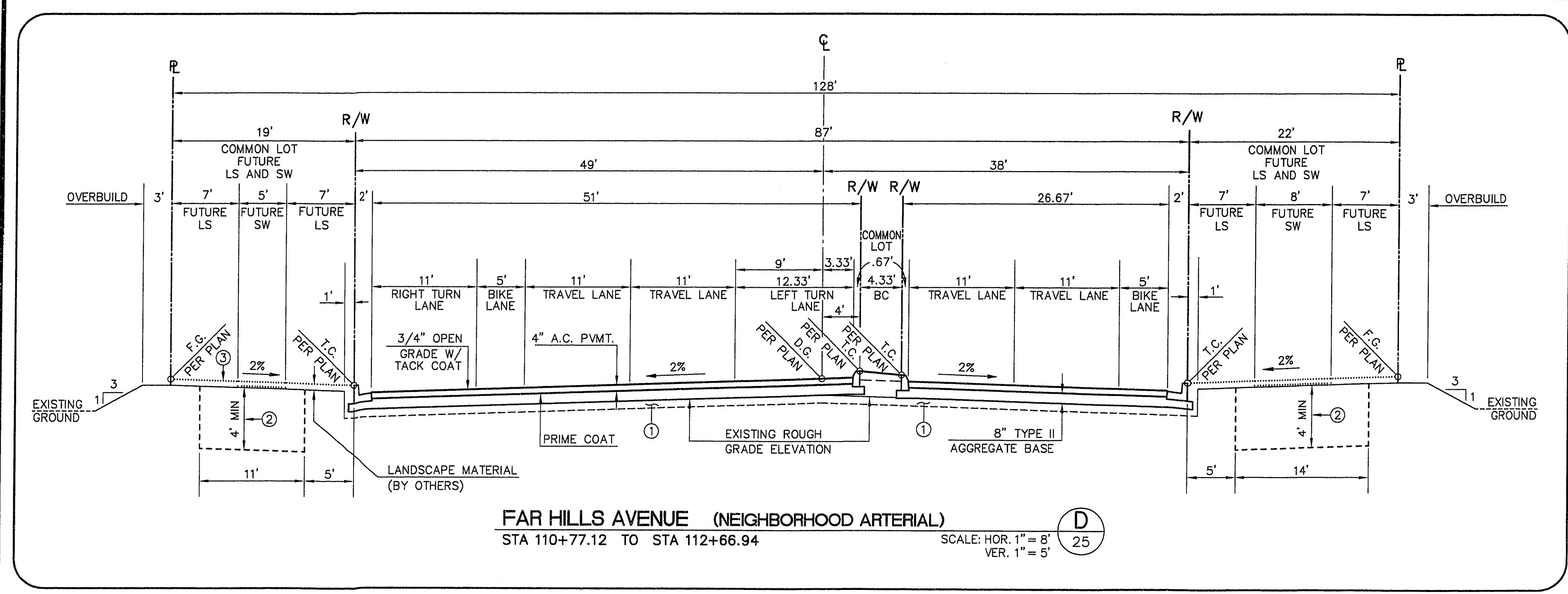

- NOTES:**
- ① - SCARIFY NATIVE 6" AND RECOMPACT TO 95%
 - ② - LANDSCAPE AREA: EXCAVATE AND RECOMPACT TO 85% OR RIP ENTIRE AREA TO DEPTH INDICATED. (N.I.C.) (COMPLETED PER ROUGH GRADING PLANS).
 - ③ - EXISTING ROUGH GRADE (R.G.) 4" BELOW FINISH GRADE (F.G.) FOR FUTURE LANDSCAPE PURPOSES.

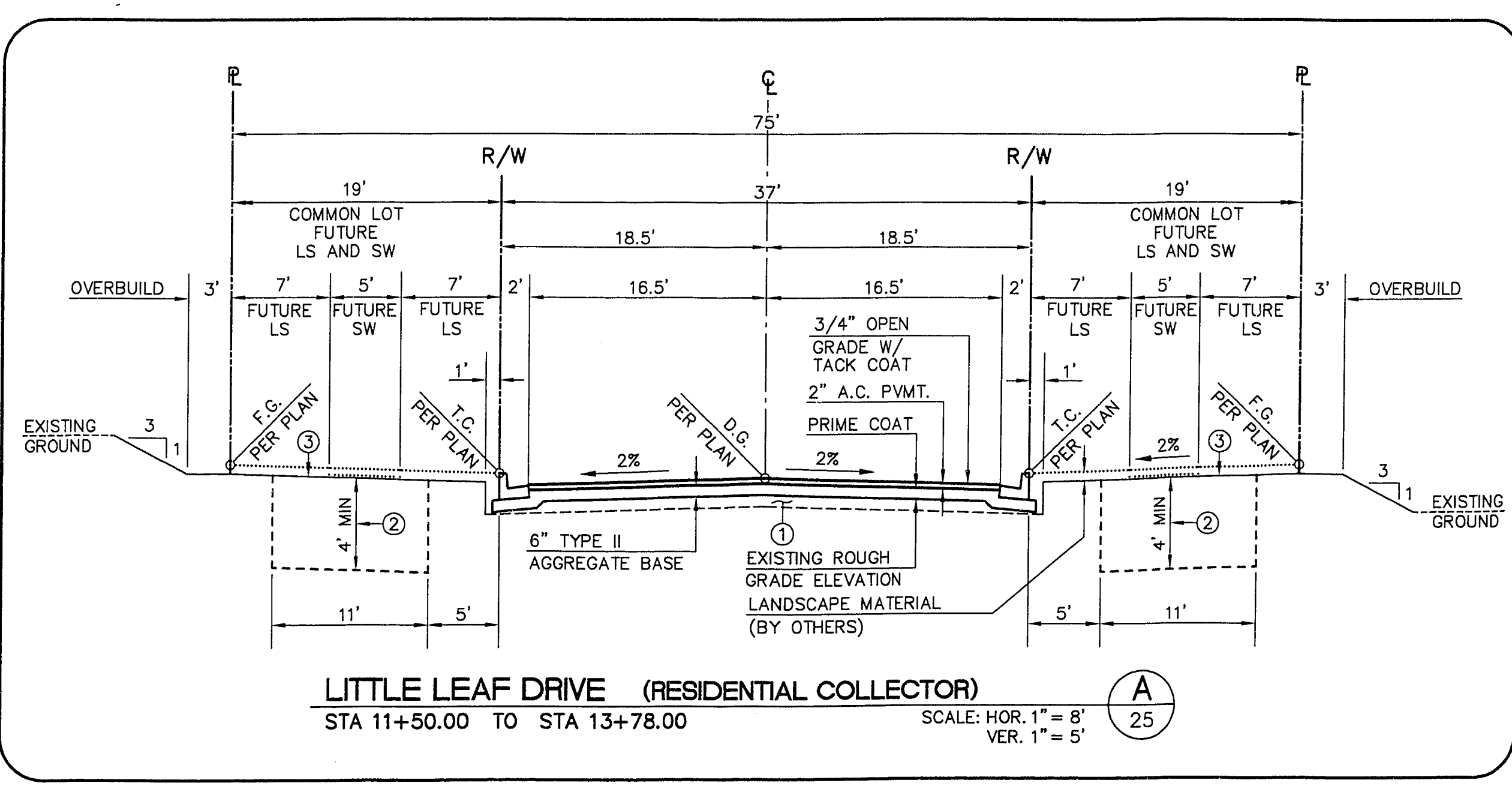
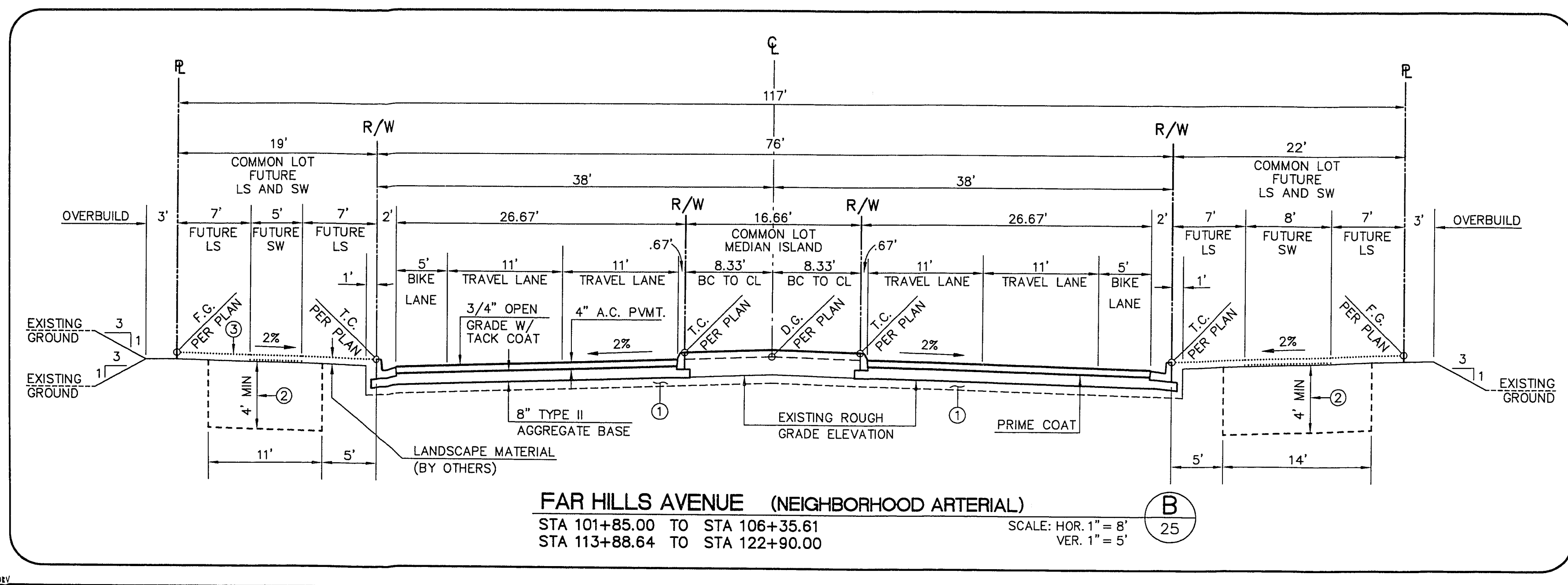

JOB NO. 62011216 January 21, 1997 9:05:47 a.m. Drawing: C:\DWG\11-12\3A\113A-SCL.DWG

1131-25