

10+00.00
CONTINUE ROTOMILL 1" BELOW
LIP OF GUTTER AT EAST AND WEST
LIP OF GUTTER AND TRANSITION TO
1/2" ROTOMILL AT 12' FROM
LIP OF GUTTER. OVERLAY ROAD
WITH 1-1/2" RUBBERIZED ASPHALT
PAVEMENT. FROM STA. 1+10.59
TO 35+17.27.

SCALE: 1"=20'

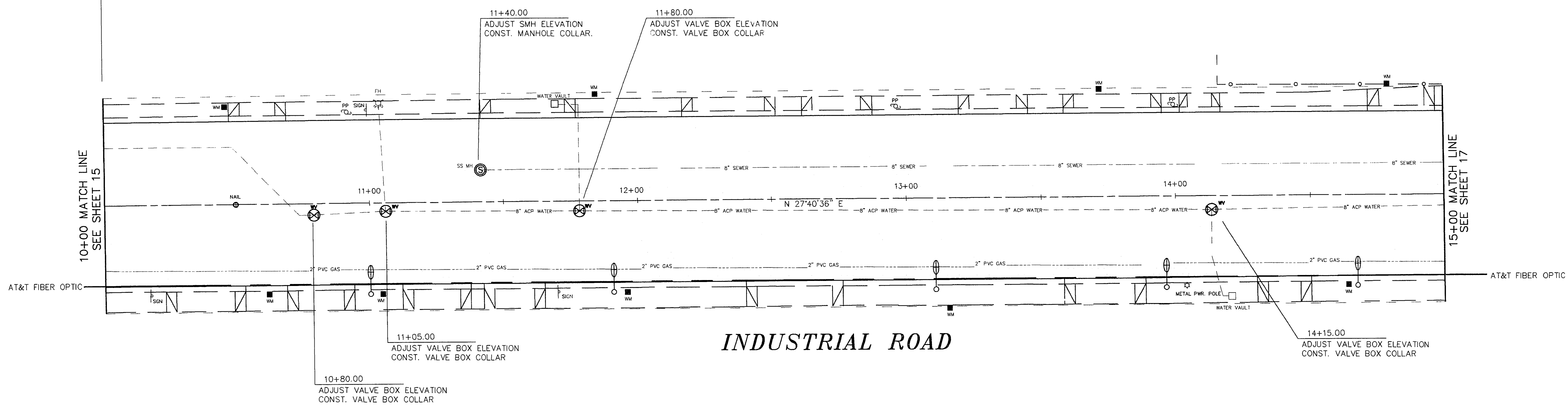
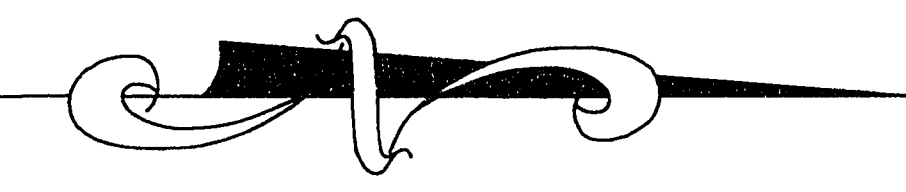

INDUSTRIAL ROAD

10+00 MATCH LINE
SEE SHEET 15

15+00 MATCH LINE
SEE SHEET 17

**CALL
BEFORE YOU
DIG.**
1-800-227-2600
UNDERGROUND SERVICE USA

NOTE:
SEE SHEET 37 FOR QUANTITY
INFORMATION.
SEE SHEET 37 FOR DETAIL
INFORMATION.

CAUTION:
EXISTING UTILITES ARE LOCATED ON
THE PLANS FROM A SEARCH OF
AVAILABLE RECORDS. CONTRACTOR TO
VERIFY LOCATIONS AND DEPTHS PRIOR
TO CONSTRUCTION.

BENCH MARK:
CLARK COUNTY BM# 6C114S4,
RIVET AND PLATE IN THE TOP OF CURB AT
THE SOUTHEAST RETURN OF INDUSTRIAL RD.
AND NORTH BRIDGE LANE, ELEV. 2052.58'

REVISIONS	
NO.	DESCRIPTION

STREET REHABILITATION DESIGN	
DRAWN BY: STREET REH.	DATE: NOV. 1995
CHECKED BY: NANCY RUTH P.E.	DRAWING NO.: 107-V2157
DESIGNED BY: STREET REH.	REV. NO.: 96-1730.11

Department of Public Works INDUSTRIAL ROAD PLAN STATION 10+00 TO 15+00	
DRAWING No.	16
107-V2157	37