

WATER QUANTITIES (ONSITE)

DESCRIPTION	AMOUNT	UNIT
8" CL-150 PVC 8" x 8" TEE W/ THRUST BLOCK	874	LF
8" x 8" TEE	2	EA.
8" x 8" TEE	2	EA.
8" x 90° W/ THRUST	2	EA.
8" GATE VALVE	3	EA.
FIRE HYDRANT / GATE VALVE GATE VALVE ASS.	3	EA.
5/8" METER	27	EA.
5/8" SERVICE LATERAL (INCLUDES SERVICE SADDLES, BENDS, ETC. AS REQUIRED)	27	EA.
6" CL-150 PVC	18	LF

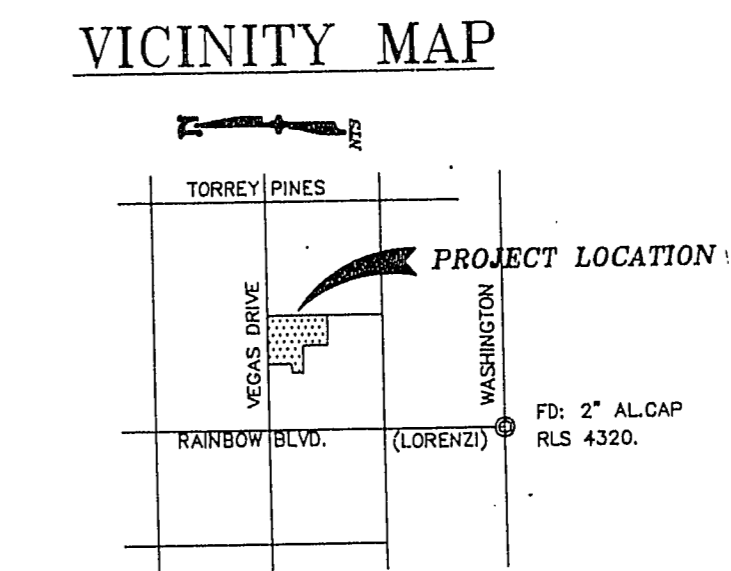

- LAS VEGAS VALLEY WATER DISTRICT STANDARD NOTES**
1. No work shall begin on the water plans until they have been released for construction by the LVWD. Following approval of the plans, notice shall be given to the LVWD Customer Service Department, (800-494) 48 hours prior to actual construction, and 24 hours prior to an inspection.
 2. Call Before You Dig 1-800-227-2600.
 3. All work shall conform to LVWD latest standard plans, drawings, and specifications.
 4. All work, except as modified herein or by Note 3, shall be done in accordance with the most current draft or addition of the Uniform Standard Specifications for Public Works Construction (Crate Publications, Clark County Area).
 5. District approved service saddles or tapped collars shall be required on all 1 1/4" and 1" service laterals. Service saddles only shall be permitted on 1 1/2" and 1" service laterals. Double tapped collars are not permitted.
 6. **COPPER SERVICE LATERALS:** All 1/4" to 1" service laterals shall be of copper tubing in accordance with the District's specifications and standard plans.
 7. The maximum allowable joint deflection for ACP and Ductile iron pipe shall be as follows:

PIPE SIZE	DEF.	Ductile iron slip joints	Ductile iron mechanical joints
6 inch	2.5 degrees	2.5 degrees	2.5 degrees
8 - 12 inch	2.5 "	2.5 "	2.5 "
14 - 16 inch	2.0 "	1.5 "	1.5 "
18 - 24 inch	1.5 "	1.5 "	1.5 "

 On PVC pipe, the maximum offset for a 20' length of factory billed pipe shall be 16 inches for 6" pipe, 12 inches for 8" pipe, and 9 inches for 10" and 12" pipe. If these offsets conflict with the pipe manufacturer's recommendation, the more stringent requirement shall apply.
 8. All water meter boxes shall be located outside of driveway areas.
 9. All valves shall be located outside of driveways and valley gutters.
 10. Detector tape shall be required in accordance with Standard Plate 90. 27 water indicators, and as follows:
 - a) over all mains not installed 4 feet from back of curb.
 - b) over all service laterals not installed at right angles to main.
 11. All water mains shall be pressure tested at 200 psi for a continuous two hour period, in accordance with District Standards.
 12. All water mains shall be disinfected, flushed, and an acceptable health sample obtained, prior to the connection of the water mains and/or laterals to the District's System.
 13. Contractor to obtain all meters 1" and smaller from LVWD Central Stores. Telephone 258-3132 forty-eight (48) hours prior to pickup.

STREET LIGHTS

100 W HPS	13 EA.
NEW SERVICE	1940 L.F.

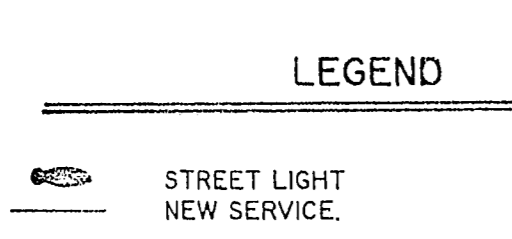

NOTE: S.S. LATERALS WILL BE 4" SDR 35 PVC @ 2.0% MIN.

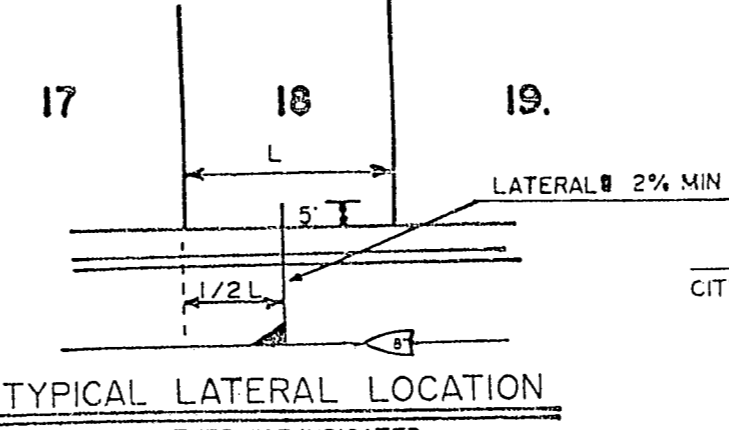

APPROVALS

Signature: [Signature] DATE: 5/18/92

LAS VEGAS VALLEY WATER DISTRICT

LAS VEGAS FIRE DEPARTMENT

Fire Flow Requirement is 1500 gallons per minute at 20 pounds per square inch residual.

Based on:

- Square footage 1800 S.F.
- Largest area between area separation walls 1800
- Height 20 FT.
- Type of Construction V-N
- Exposures
- Sprinkler System NO
- Roof Construction TILE
- Reviewed By: David Barrera
- Date: 5/12/92

SUMMIT ENGINEERING CORPORATION
 CONSULTING ENGINEERS AND SURVEYORS
 115 WEST BEAR ANNUK SAHU #2 LAS VEGAS, NEVADA 89109
 PHONE (702) 798-6800

DESIGNED BY: [Blank]
 DRAWN BY: [Blank]
 CHECKED BY: [Blank]
 DATE: MARCH 3, 1992

STREET LIGHT AND UTILITY PLAN FOR PHASE I
RAINBOW PARK I
 CITY OF LAS VEGAS, CLARK COUNTY, NEVADA

SCALE: 1" = 40'
 SHEET 6A OF 12
 JOB NO. 20251

307 Y-4217

10-22-144