

SUBMITTED  
*William Thomas*  
 CAS VEGAS CITY ENGR  
 DATE 8/4/77  
*Robert L. Walker*  
 CAS VEGAS FIELD ENGR  
 DATE 8/3/77  
*James L. MacFarlane*  
 CAS VEGAS CONTROL ENGR  
 DATE 8/3/77  
 SUBMITTED  
*James L. MacFarlane*  
 CAS VEGAS CONTROL ENGR  
 DATE 8/3/77  
 PROFESSIONAL ENGINEER  
 CIVIL  
 NO. 3572

CURVE DATA

No	Δ	R	L	T
1	34°18'34"	31.00	48.37	30.68
2	42°41'22"	"	47.06	31.38
3	40°00'00"	26.00	46.27	25.00
4	30°21'18"	466.00	246.84	126.49
5	30°21'18"	500.00	268.34	137.40
6	12°30'18"	500.00	142.36	72.51
7	10°06'31"	500.00	88.22	48.22
8	3°44'33"	500.00	37.06	16.34
9	11°52'17"	234.00	110.63	55.52
10	43°34'20"	26.00	26.00	37.87
11	87°26'49"	26.00	31.68	24.87
12	3°24'54"	234.00	90.47	23.26

CONSULTING ENGINEERS & PLANNERS  
 VTP  
 1718 PARADISE BLVD. LAS VEGAS, NEVADA 89102  
 STEWART PLACE UNIT 4  
 STREET PLAN & PROFILE  
 MARION DR

SCALE	WO NO 2317.4	DATE 8/27/77	SHEET	OF
HORIZ 1"=40'	DES	REV.	2	10
VERT	CHK	REV.		

5202

19.4.50

1078-2725-4

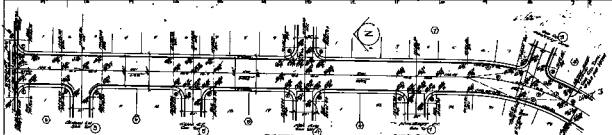
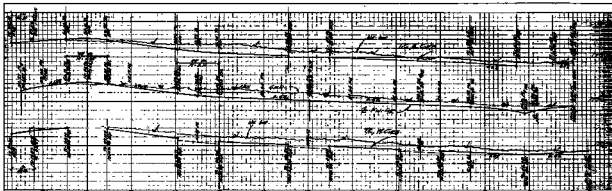

*Handwritten notes and signatures:*  
 [Illegible signature]  
 [Illegible signature]  
 [Illegible signature]

Station	Grade	Width	Notes
0+00	1.5%	12'	
0+25	1.5%	12'	
0+50	1.5%	12'	
0+75	1.5%	12'	
1+00	1.5%	12'	
1+25	1.5%	12'	
1+50	1.5%	12'	
1+75	1.5%	12'	
2+00	1.5%	12'	
2+25	1.5%	12'	
2+50	1.5%	12'	
2+75	1.5%	12'	
3+00	1.5%	12'	
3+25	1.5%	12'	
3+50	1.5%	12'	
3+75	1.5%	12'	
4+00	1.5%	12'	
4+25	1.5%	12'	
4+50	1.5%	12'	
4+75	1.5%	12'	
5+00	1.5%	12'	
5+25	1.5%	12'	
5+50	1.5%	12'	
5+75	1.5%	12'	
6+00	1.5%	12'	
6+25	1.5%	12'	
6+50	1.5%	12'	
6+75	1.5%	12'	
7+00	1.5%	12'	
7+25	1.5%	12'	
7+50	1.5%	12'	
7+75	1.5%	12'	
8+00	1.5%	12'	
8+25	1.5%	12'	
8+50	1.5%	12'	
8+75	1.5%	12'	
9+00	1.5%	12'	
9+25	1.5%	12'	
9+50	1.5%	12'	
9+75	1.5%	12'	
10+00	1.5%	12'	

Yell

STANDARD PLACE DUTY 4  
 STREET PLANNING  
 MAPS CO.

DATE: 1945  
 DRAWN BY: [Illegible]  
 CHECKED BY: [Illegible]