

SUBMITTED BY:

Charley R. Johnson 10/7/76  
 CHARLEY R. JOHNSON  
 Registered Professional Engineer # 3005

**STREET LIGHTING SPECIFICATIONS**  
 Underground 250 Volt Single Phase Two Wire System

Street lighting standards shall be as shown by Drawing No. 400.1, Page 40 of Uniform Standard Drawings and must conform to Sections 405 and 405 and any other applicable sections of the Uniform Standard Specifications.

On 80' R/W streets, there shall be two poles on diagonal corners.  
 On 100' R/W streets, there shall be one pole at each corner.

Mercury vapor luminaires to be used on 51' R/W and 60' R/W streets, except at intersections, shall be 175 watt, 250 volt T.E.S. distribution Type 3, with integral constant voltage ballasts, similar to line material catalog #H3412 or approved equal.

175 watt mercury vapor lamps shall be ASA Code #H39-22RC/1.1  
 400 watt mercury vapor lamps shall be ASA Code #H33-1GL/1.1  
 Photo cell and control to be 120/240 volts.

Spacing of standards shall be 150 Feet maximum on 51' R/W and 60' R/W streets on one side to provide 0.9 F.C.  
 Spacing of standards shall be 150 feet maximum on 80' R/W streets on both sides staggered to provide 0.9 F.C.  
 Spacing of standards on 100' R/W streets or more shall be 120 feet maximum on both sides staggered to provide 1.4 to 2.0 F.C.

All standards to be 15" back of curb.

Schedule 40 rigid non-metallic conduit (RNC) or approved equal complying with Article 347 of the National Electrical Code may be used for underground applications and to be within 12" back of curb and 24" cover.

Fuse holders and connectors shall be installed in the bases of all lighting standards; the fuse holders shall be Russ-Troxhex-AA.

Base covers for lighting standards are not to be installed before breakout caps are placed and inspected. All material used in underground wiring, in breakout caps and under base covers to be inspected before installations.

Foundations shall be constructed and located to line and grade as directed by the Field Engineer.

Lighting standard and mast arm cable to luminaire shall be 10/2 U.F. Type 500 volt copper cable.

The contractor shall be responsible for avoiding damage to property, either public or private, and in the event of such damage shall make satisfactory repairs at his own expense.

The Contractor shall furnish complete service to transformers and control system, if required.

The service point standard is to be installed at the approved location shown on plans and to conform to Drawing No. 401.1, Page 44 of the Uniform Standard Drawings.

In the selection of 175 and 400 watt mercury vapor luminaires to be used in a particular development, one approved manufacturer shall be specified.

These specifications to become effective on all City of Las Vegas multiple street lighting designs approved on or after September 1, 1971.

These specifications shall be superseded by any revised specifications in existence at the time of installation.

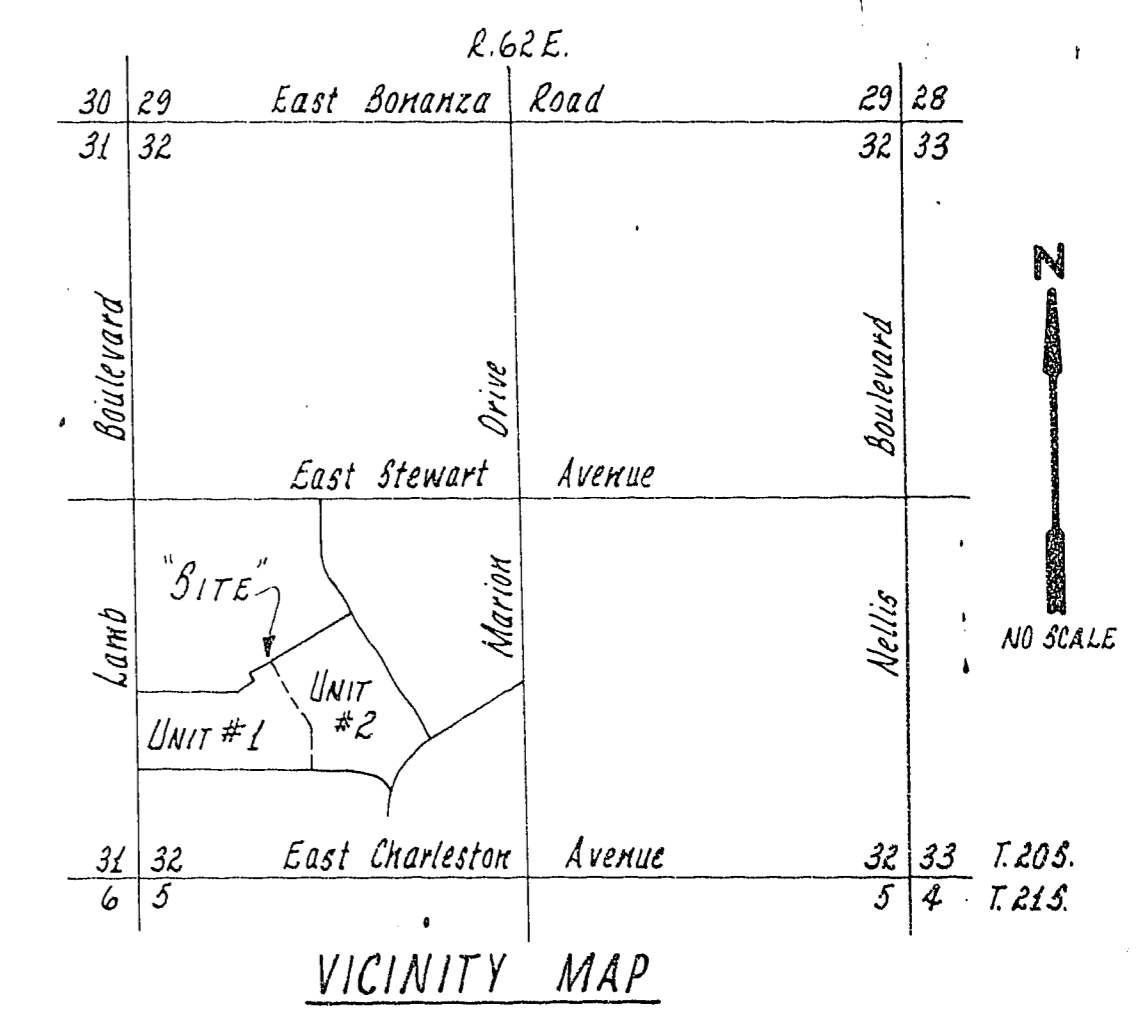

- LEGEND & QUANTITY ESTIMATE**
- 175-Watt MVL w/ Standard 11 Ea.
  - ⊕ 400 Watt MVL w/ Standard 5 Ea.
  - 1 1/4" RNC Conduit 5540 LF
  - Service Point Wiring 2#2'S #176
  - All Field Wiring 2#4'S THW
  - No 3 1/2 Pull Box 1 Ea.

APPROVED:

NEVADA REG. NO. DATE  
 William Harris 11/2/76  
 LAS VEGAS CITY ENGINEER DATE

DATE  
 Douglas 11-9-76  
 LAS VEGAS CITY ELECTRICIAN DATE

DATE  
 11-9-76  
 CITY OF LAS VEGAS ELECT. COORD. DATE

CONSULTING ENGINEERS & PLANNERS 2209 PARADISE ROAD, LAS VEGAS, NEVADA 89105 702-735-0227				
<b>STEWART PLACE-UNIT 2</b>				
MASTER STREET LIGHT PLAN				
SCALE: 1"=60'	WO. NO. 2377-2	DATE 10/7/76	SHEET	OF
HORIZ:	DES.	REV.	13	13
VERT:	CHK.	REV.		

1612-81 2074-2825-2