

BUILDING SECTION - BUILDING B
SCALE: 1/8" = 1'-0" 997BBSF A7.05

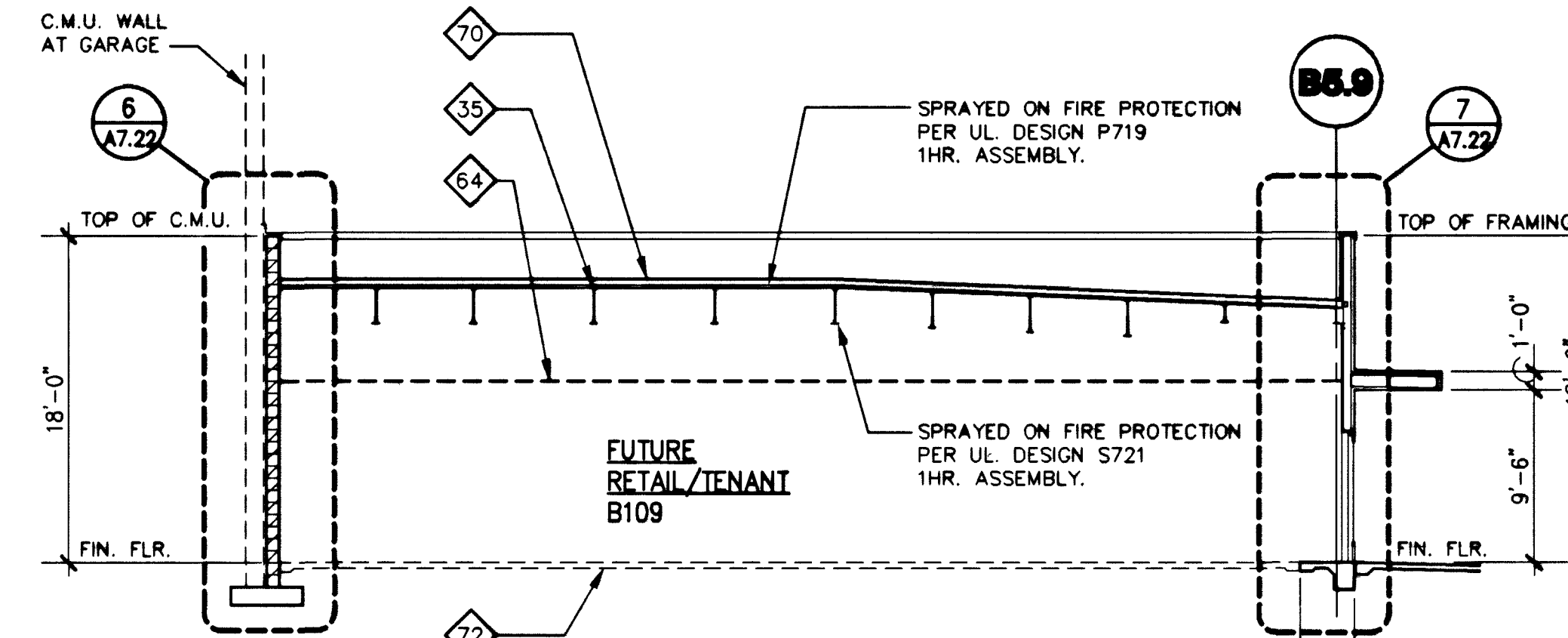

BUILDING SECTION - BUILDING B
SCALE: 1/8" = 1'-0" 997BBSG A7.05

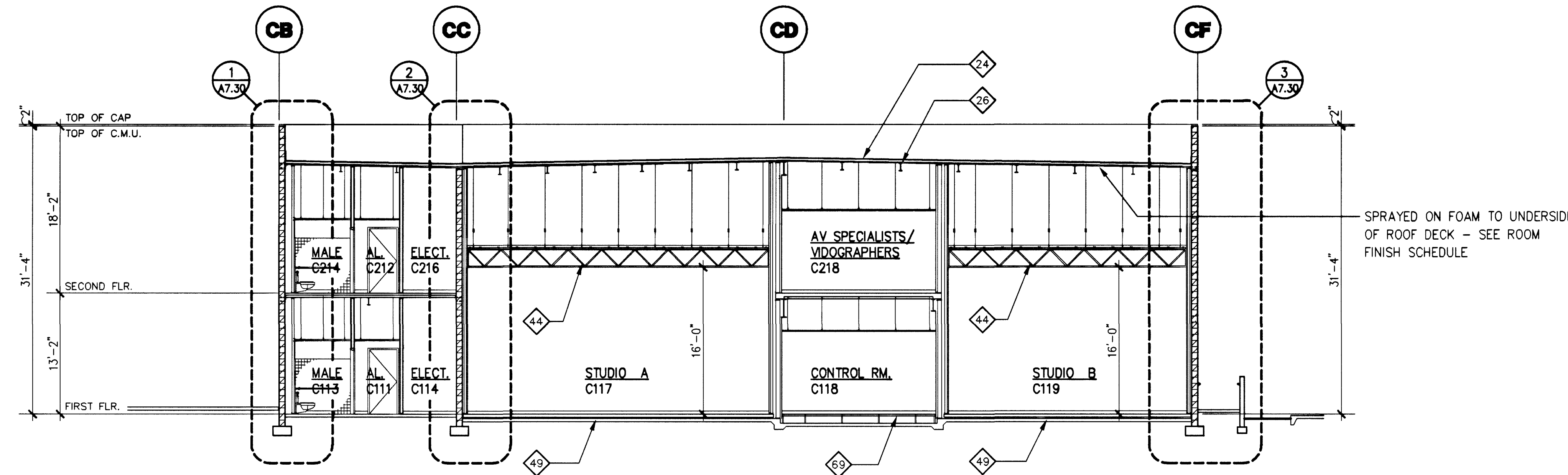

BUILDING SECTION - BUILDING C
SCALE: 1/8" = 1'-0" 997CBSA A7.05

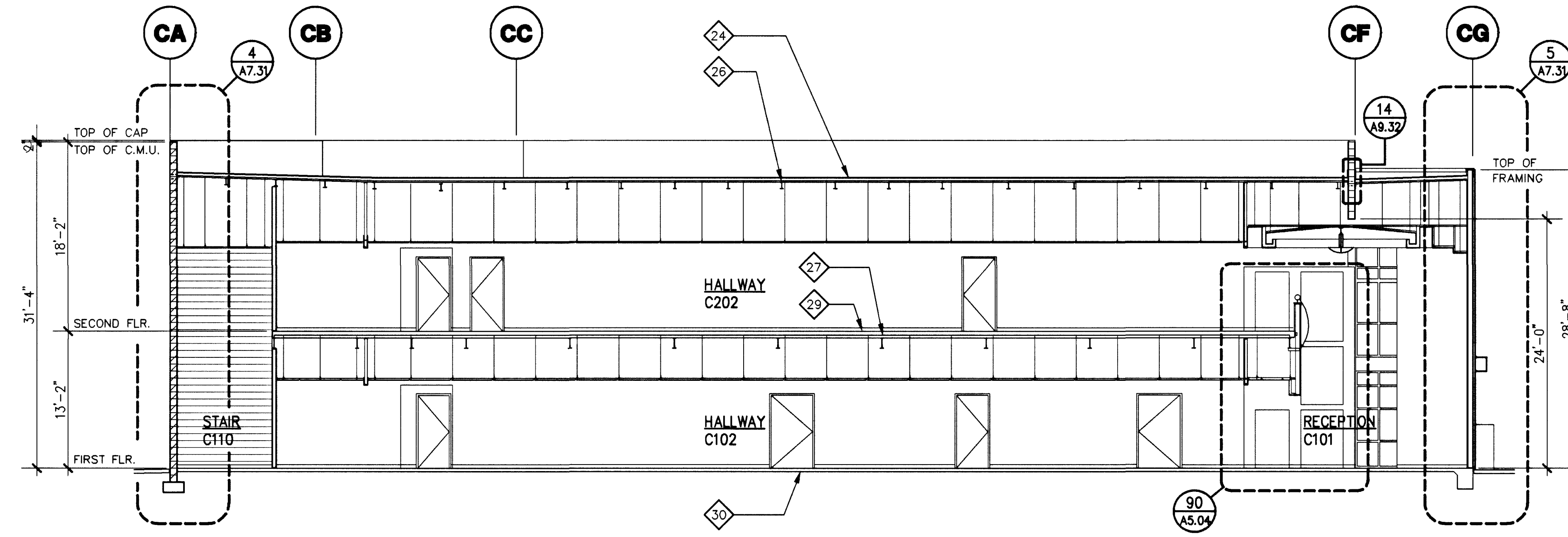

BUILDING SECTION - BUILDING C
SCALE: 1/8" = 1'-0" 997CBSB A7.05

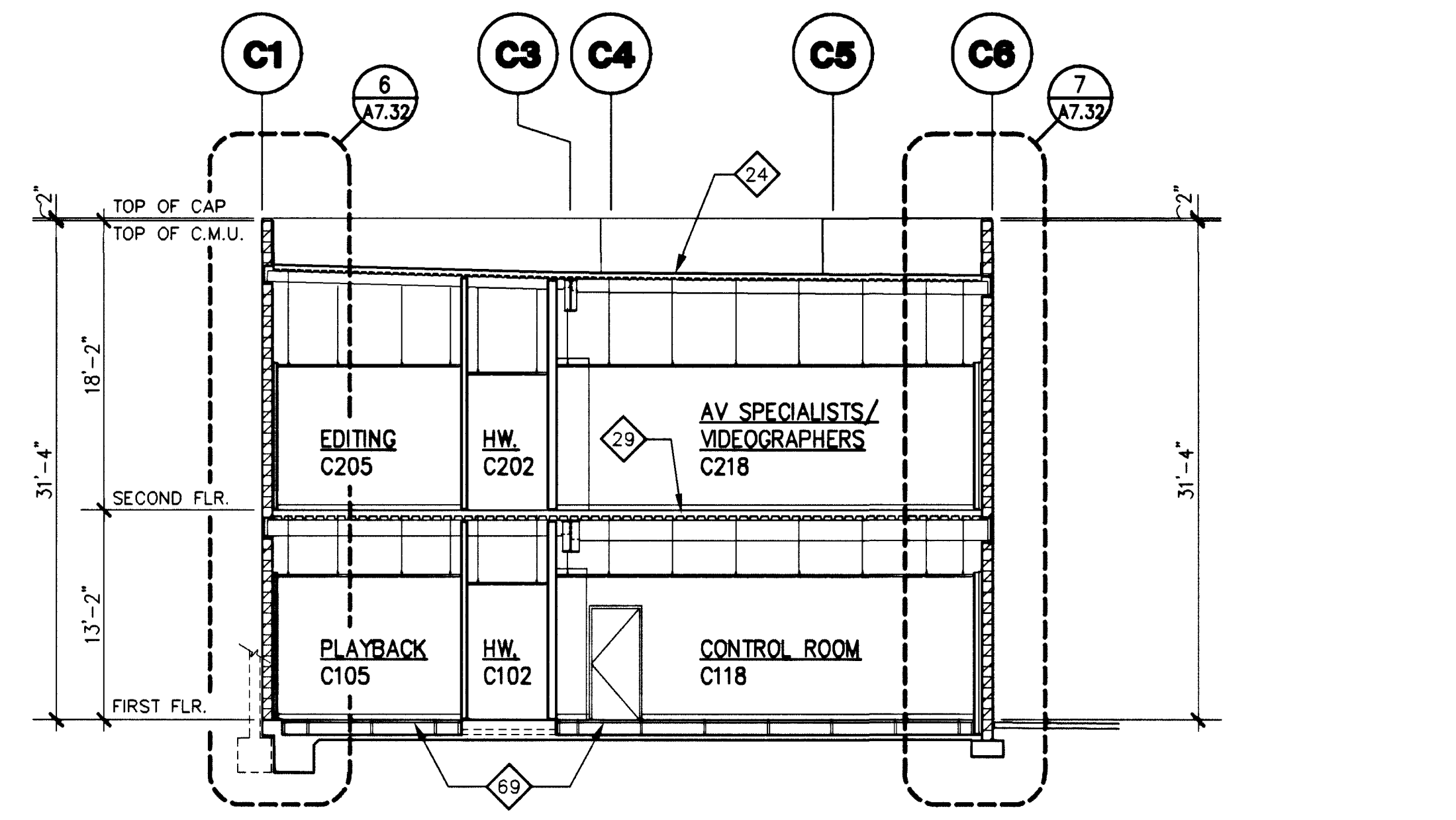

BUILDING SECTION - BUILDING C
SCALE: 1/8" = 1'-0" 997CBSG A7.05

SECTION NOTES

DESCRIPTION

- 1 INSULATED STONE PANEL
- 2 CMU WALL CONSTRUCTION
- 3 ALUMINUM STOREFRONT FRAME
- 4 1" INSULATED GLASS
- 5 TRANSLUCENT INSULATED PANEL
- 6 PREMANUFACTURED METAL CAP FLASHING
- 7 ROLL UP DOOR
- 8 STEEL DOOR FRAME
- 9 STEEL DOOR
- 10 ALUMINUM DOOR FRAME
- 11 ALUMINUM CURTAIN WALL
- 12 STEEL TUBE - PAINTED
- 13 CERAMIC TILE
- 14 SLOPED GLAZING SYSTEM
- 15 METAL SUN SCREEN
- 16 METAL LOUVRES
- 17 CHAIN LINK FENCE CLOSURE WITH GATES
- 18 PRE-CAST CONCRETE PANEL
- 19 PRE-CAST STRUCTURE
- 20 PIPE RAILS
- 21 STANDPIPE
- 22 PRE-CAST CONCRETE SILL
- 23 PRE-CAST CONCRETE COLUMN COVER
- 24 SINGLE PLY MEMBRANE ROOFING OVER
- 25 RIGID INSULATION OVER METAL DECK
- 26 TRANSLUCENT PANEL SKYLIGHT SYSTEM
- 27 STEEL FLOOR BEAMS
- 28 STEEL STUD FRAMING
- 29 CONCRETE FLOOR ON METAL FLOOR DECK
- 30 CONCRETE FLOOR SLAB ON GRADE
- 31 CONCRETE WALK ON GRADE
- 32 5/8" TYPE "X" GYPSUM SHEATHING
- 33 FIBERGLASS WALL INSULATION
- 34 SUSPENDED CEILING SYSTEM AS SCHEDULED
- 35 STEEL ROOF TRUSS
- 36 HIGH STRENGTH WEATHER RESISTANT CABLE GUARDRAIL
- 37 CONCRETE TIRE STOP
- 38 GRADE BACK FILL
- 39 PRE-ENGINEERED STEEL STAIR WITH STEEL TUBE HANDRAILS AND GUARDRAILS
- 40 TUBE HANDRAILS AND GUARDRAILS
- 41 OUTER SOUND WALL CONSTRUCTION
- 42 INDEPENDENT INNER STUDIO SOUND WALL
- 43 SUSPENDED SOUND BARRIER CEILING
- 44 OPEN WEB CEILING JOIST FOR STUDIO LIGHTING
- 45 DIAGONAL BRACE
- 46 EXISTING BUILDING CONSTRUCTION
- 47 EXISTING STREET PAVING
- 48 EXPANSION JOINT
- 49 JACK-UP CONCRETE FLOOR SYSTEM
- 50 CONCRETE TOPPING SLAB
- 51 METAL PANEL JOINT
- 52 GALV. MTL. SCUPPER OPENING AT ROOF LINE
- 53 2" CMU GAP
- 54 FLASHING WITH COUNTER FLASHING
- 55 FINISH GRADE
- 56 GALV. MTL. CONDUCTOR HEAD WITH DOWN SPOUT
- 57 FUTURE RETAIL/TENANT BUILDING NOT SHOWN FOR CLARITY - SEE BUILDING SECTIONS A/A7.05 AND B/A7.05
- 58 DECORATIVE CONCRETE RETAINING WALL
- 59 STEEL SCOFFIT FRAMING
- 60 EXTERIOR FINISH COAT ON EXTERIOR GRADE
- 61 GYPSUM SHEATHING
- 62 EXPANSION JOINT COVER
- 63 SINGLE PLY MEMBRANE OVER EXTERIOR GRADE
- 64 GYPSUM SHEATHING
- 65 STEEL ROOF LADDER
- 66 FUTURE CEILING PER TENANT
- 67 6"X CONTINUOUS STAINLESS STEEL TUBE GUARDRAIL TOP 1/2" STAINLESS STEEL RAILING SUPPORT FINIS
- 68 LARGE FINIS TO BE LOCATED 10'-6" O.C. TO MATCH LIGHTING FIXTURE ABOVE. SMALL FINIS TO BE LOCATED CENTERED BETWEEN LARGE FINIS.
- 69 3/4" WOOD CAP AND 1" CONTINUOUS ALUMINUM GYPSUM BOARD REVEAL UNDER
- 70 1/8" EPS ON 5/8" EXTERIOR GRADE GYPSUM SHEATHING (1 3/4" TOTAL THICKNESS)
- 71 PRE-CAST CONCRETE COLUMN COVER
- 72 CAST IN PLACE CONCRETE
- 73 RAISED FLOORING SYSTEM
- 74 SINGLE PLY MEMBRANE ROOFING OVER RIGID INSULATION ON 5/8" TYPE "X" GYPSUM SHEATHING ON METAL DECK
- 75 SINGLE LAYER OF #5 BUILDING FELT ON EXTERIOR GYPSUM SHEATHING
- 76 FUTURE CONCRETE SLAB PER TENANT IMPROVEMENT
- 77 1 1/2" COLD ROLLED CHANNEL UPLIFT STRUT ATTACHED AT CEILING COLD ROLLED CHANNELS TO UNDERSIDE OF STRUCTURE ABOVE AT 8'-0" O.C.
- 78 EXTERIOR INSULATION FINISH SYSTEM (1 1/2" RIGID INSULATION) ON 5/8" TYPE "X" EXTERIOR GRADE GYPSUM SHEATHING.
- 79 SAFING INSULATION TO BE COMPRESSION FIT BETWEEN FLOOR SLAB AND CURTAIN WALL STUDS WITH SAFING "Z" CLIPS AT 24" O.C. MAX. (1 HOUR RATING)
- 80 6"X CONTINUOUS STAINLESS STEEL TUBE GUARDRAIL TOP 1/2" STAINLESS STEEL RAILING SUPPORT FINIS LOCATED 10'-6" O.C.
- 81 3/4" WOOD CAP AND 1" CONTINUOUS ALUMINUM GYPSUM BOARD REVEAL UNDER

RECORD DRAWINGS
DECEMBER 20, 2008

STEWART AVENUE
PARKING GARAGE



KITRELL GARLOCK
AND ASSOCIATES, AIA

4070 S. DECATUR BLVD. STE. B-5
LAS VEGAS, NEVADA 89103 USA
WWW.KGA-ARCHITECTS.COM
TELEPHONE 702.367.6000
FACSIMILE 702.367.3045

CONSULTANTS

CONTRACTOR
POCKEMEYER
DOCK GROUP
PHONE 702.338.8888

STRUCTURAL
SOUTHWICK
AND ASSOCIATES
PHONE 702.338.8888

MECHANICAL / PLUMBING / ELECTRICAL
BA
CONSULTING ENGINEERS
PHONE 702.338.8888

TECHNOLOGY CONSULTANT
SPER MASON
& WELKE, INC.
PHONE 702.338.8888

FABRIC CONSULTANT
INTERFAZ
DESIGN
PHONE 702.338.8888

PROJECT
STEWART AVENUE
PARKING GARAGE

107-V-333B

BUILDING SECTIONS
BUILDING B AND
BUILDING C

76

DATE
AUGUST 23, 2000

JOB NO.
99997.00

SHEET
A7.05

51905