

APPROXIMATE QUANTITIES THIS SHEET

ITEM NO.	DESCRIPTION	CLV	RFM	FID	TOTAL	UNIT
104.500	LIME STABILIZED BASE		3605	323	3928	S.Y.
302.200	TYPE II GRAVEL BASE		915	73	988	C.Y.
334.008	4 IN. ASPHALTIC CONCRETE SINGLE LIFT		664	55	719	TONS
354.910	ISLAND ASPHALTIC COLORING	96			96	GAL.
333.500	1/2 IN. OPEN-GRADED PLANT-MIX SUR		2847	238	3085	S.Y.
334.503	1/2 IN. AC ISLAND SURFACING		56	71	56	TONS
334.800	BITUMINOUS PRIME COAT		854		800	L.F.
340.041E	17 IN. EXTRUDED "A" TYPE CURB		100	306	406	L.F.
500.902	"L" TYPE C&G (24 IN. WIDE)		65		65	L.F.
340.145	5 IN ISLAND CONCRETE		41		41	S.F.
512.500	ADJUST SEWER MANHOLE				1	E.A.
201.000	EXCAVATION-UNCLASSIFIED					
	CUT		631	94	725	C.Y.
	FILL		22	17	39	C.Y.
500.800	CONCRETE CAP FOR SEWER	1			1	L.S.
560.190	3/4" ISLAND WATER SERVICE CONNECTION	2			2	E.A.

EXISTING UTILITIES ARE LOCATED ON THE PLANS FOR THE CONVENIENCE OF THE CONTRACTOR ONLY. THE CONTRACTOR SHALL BEAR FULL RESPONSIBILITY FOR PROTECTION OF UTILITIES AND THE CITY BEARS NO RESPONSIBILITY FOR UTILITIES NOT SHOWN ON THE PLANS OR NOT IN THE LOCATION SHOWN ON THE PLANS.

CONTRACT DRAWING
NOV 8 1974

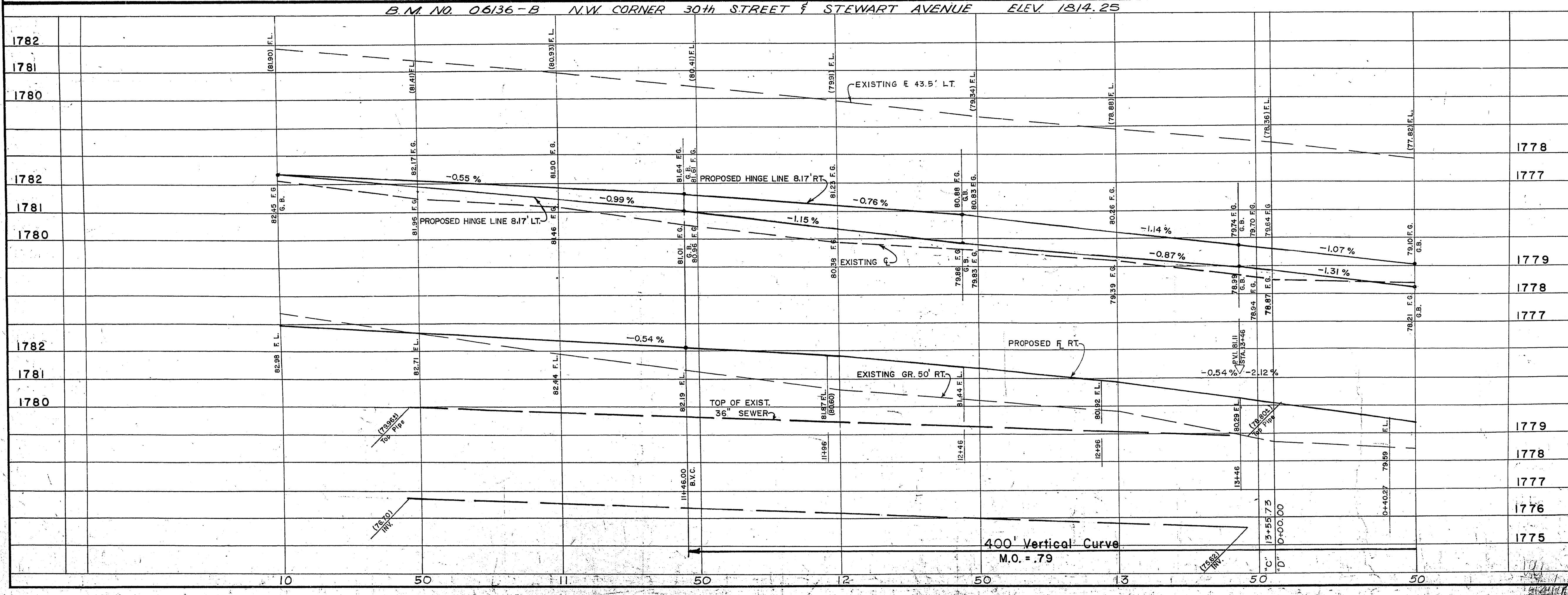

CURVE DATA

CURVE NO.	LOC	DELTA	RADIUS	LENGTH	TANGENT
①	B.C.	180°00'00"	2.0'	6.28	∞
②	B.C.	12°02'26"	250.0'	52.54'	26.37'
③	R/W	89°41'11"	20.0'	31.31'	19.89'
④	R/W	90°18'49"	20.0'	31.53'	20.11'
⑤	B.C.	01°02'28"	250.0'	4.54'	2.27'
⑥	B.C.	11°15'23"	250.0'	49.12'	24.64'

Professional Engineer Seal for William J. Williams, Civil Engineer, No. 10174.

REVISION NO. DESCRIPTION BY DATE APPROVED

CITY OF LAS VEGAS NEVADA
DEPARTMENT OF PUBLIC WORKS
SERVICES DIVISION

STEWART AVE.
28th to NELLIS BLVD

W.O. NO. 7682 F.BK. NO. 69-8X DATE 11/16/73 DRAWING NO. 107-V819A
 SC. IN. 1" = 20' FILE NO.
 DES. G. Williams, G. Williams
 DR. W. Williams, G. Williams
 APPROVED BY DIRECTOR OF PUBLIC WORKS 10/25/74 SHEET 14 OF 70