

21-5-7

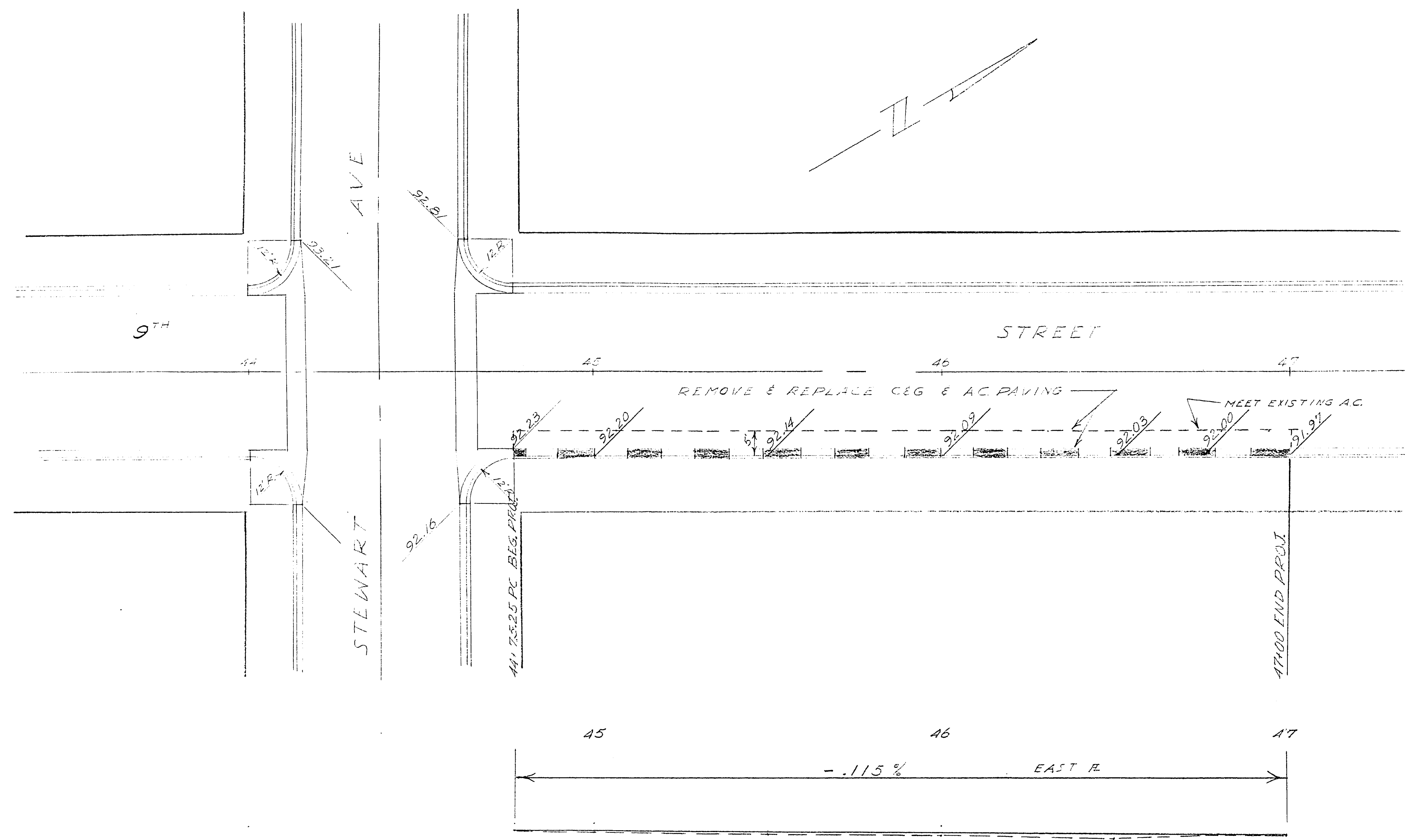

REMOVE & REPLACE 67.8 SQ YDS. AC PAVING
 REMOVE & REPLACE 225 "L" C&G

1990
 1985
 1980

REVISION
 EAST & 9TH ST STEWART AVE NORTH

CITY OF LAS VEGAS, NEVADA			
ENGINEERING DEPT.			
FLOW LINE CORRECTION			
9TH ST. STA 44+75.25 TO 47+00			
DESIGNED BY	KCH	DATE	SCALE 1"=20' (31.8' H. VERT)
DRAWN BY	KCH	2-53	FIELD BOOK NO.
CHECKED BY	J.E.S.	2-7-80	WORK ORDER NO. 8-7
APPROVED	<i>[Signature]</i>		DRAWING NO.
CITY ENGR.			6A OF 27
			100-23