

# STEWART AVENUE

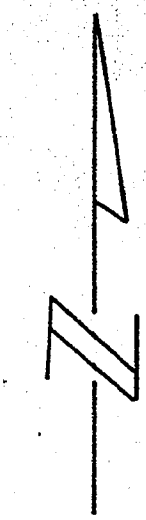

7+00 TO 12+00 REMOVE EXIST. 3.5' BARR. WIRE FENCE TO P.V. (BY OWNER)  
7+00 TO 12+00 CONST. 5' CONC. S/W

B 7+00 MATCH LINE SEE SHT. 7

7+00 to 12+00 Install 5.00 L.F. of 24" S.S.P. 10' RC.

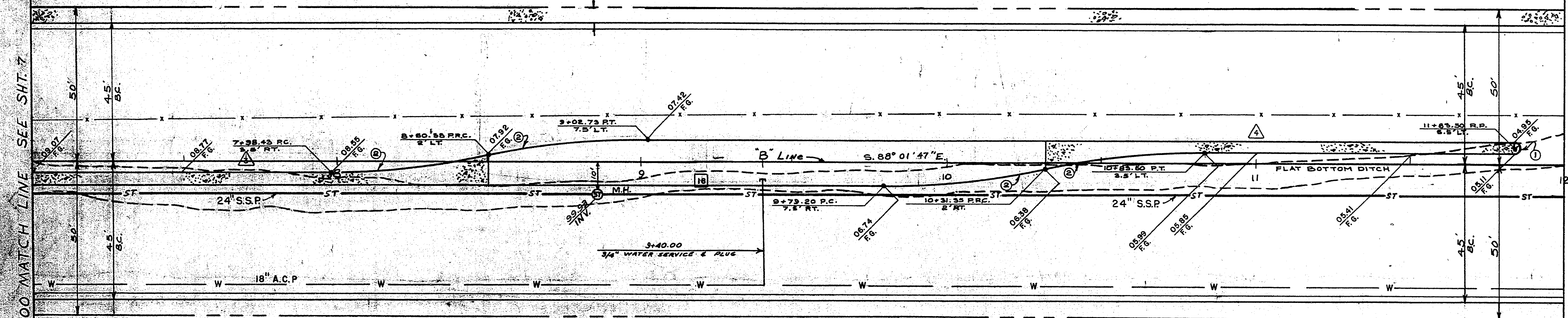

"B" 12+00 MATCH LINE SEE SHT. 9

## APPROXIMATE QUANTITIES THIS SHEET

ITEM NO.	DESCRIPTION	CLV510	CLV	R5H	S1D	TOTAL	UNIT
ALT(1)(2)	24 IN. S.S.P.			500		500	L.F.
302.200	TYPE II GRAVEL BASE	232		512		744	C.Y.
334.008	4 IN. ASPHALTIC CONCRETE SINGLE LIFT	207		789		996	TONS
354.200	1/2 IN. OPEN-GRADED PLANT-MIX SUR	889	42	380		4269	S.Y.
334.503	1-1/2 IN. A.C. ISLAND SURFACING	267		25		292	TONS
334.800	BITUMINOUS PRIME COAT	1000		1014		1281	GAL.
340.014	1" TYPE C.C.G. (24" IN. WIDE)			975		975	L.F.
340.040E	14" EXTRUDED "A" TYPE CURB			1409		1409	S.F.
512.600	STORM DRAIN MANHOLE			8		8	VF
201.100	EXCAVATION-UNCLASSIFIED			1672		3525	C.Y.
	FILL	0		152		152	C.Y.
160.150	3/4" IN. ISLAND WATER SERVICE CONNECTOR					2500	L.F.
340.114	CONST. 5' FT. CONC. SIDEWALK					1508	S.Y.
103.500	1" TYPE STABILIZED BASE			3889			

BM. NO. 06136-B NW. CORNER 30<sup>TH</sup> STREET & STEWART AVENUE ELEV. 1814.25

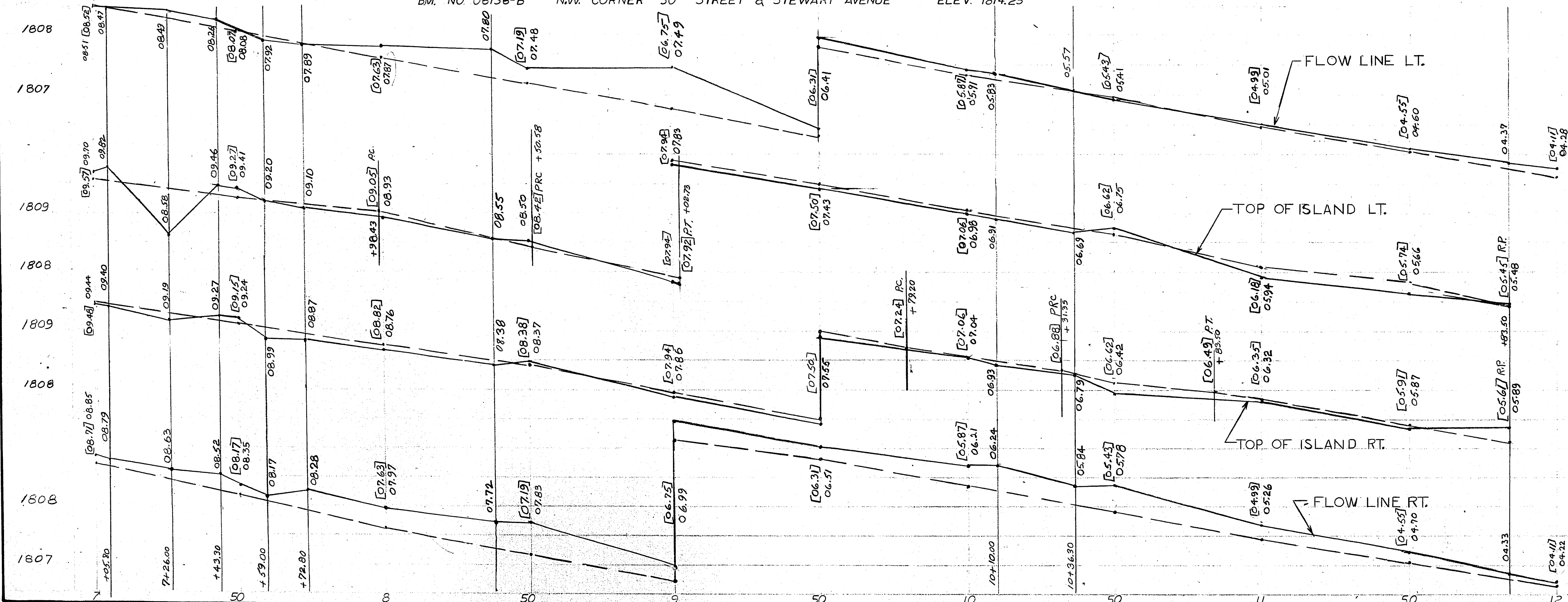

*William Hampton*  
10/17/74

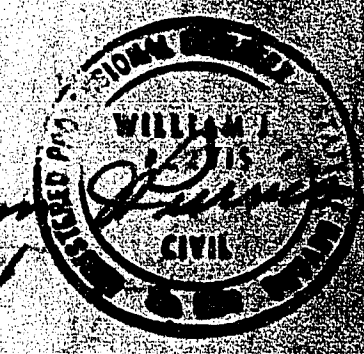

EXISTING UTILITIES ARE LOCATED ON THE PLANS FOR THE CONVENIENCE OF THE CONTRACTOR ONLY. THE CONTRACTOR SHALL BEAR FULL RESPONSIBILITY FOR PROTECTION OF UTILITIES AND THE CITY BEARS NO RESPONSIBILITY FOR UTILITIES NOT SHOWN ON THE PLANS OR NOT IN THE LOCATION SHOWN ON THE PLANS.

**CONTRACT DRAWING**  
NOV. 5 1974

### CURVE DATA

CURVE NO.	LOC.	DELTA	RADIUS	LENGTH	TANGENT
1	BC	180° 00' 00"	2.0'	6.25'	
2	BC	12° 02' 26"	250.0'	12.54'	28.57'

REVISION NO.	DESCRIPTION	BY	DATE	APPROVED
1	STREET GRADE CHANGE	C.P.M.	5-13-75	

**CITY OF LAS VEGAS NEVADA**  
DEPARTMENT OF PUBLIC WORKS  
SERVICES DIVISION

**STEWART AVE**  
28<sup>TH</sup> to NELLIS BLVD

W.D. NO. 7080 F.B. NO. 66-44 DATE 11/19/74 DRAWING NO. 1194  
SCHEMATIC 21 IS. CIVIL 22  
DESIGNED BY [Signature] CHECKED BY [Signature]  
DRAWN BY [Signature] IN CHARGE BY [Signature]  
APPROVED BY DIRECTOR OF PUBLIC WORKS [Signature] 10/25/74  
SHEET 3 OF 10

