

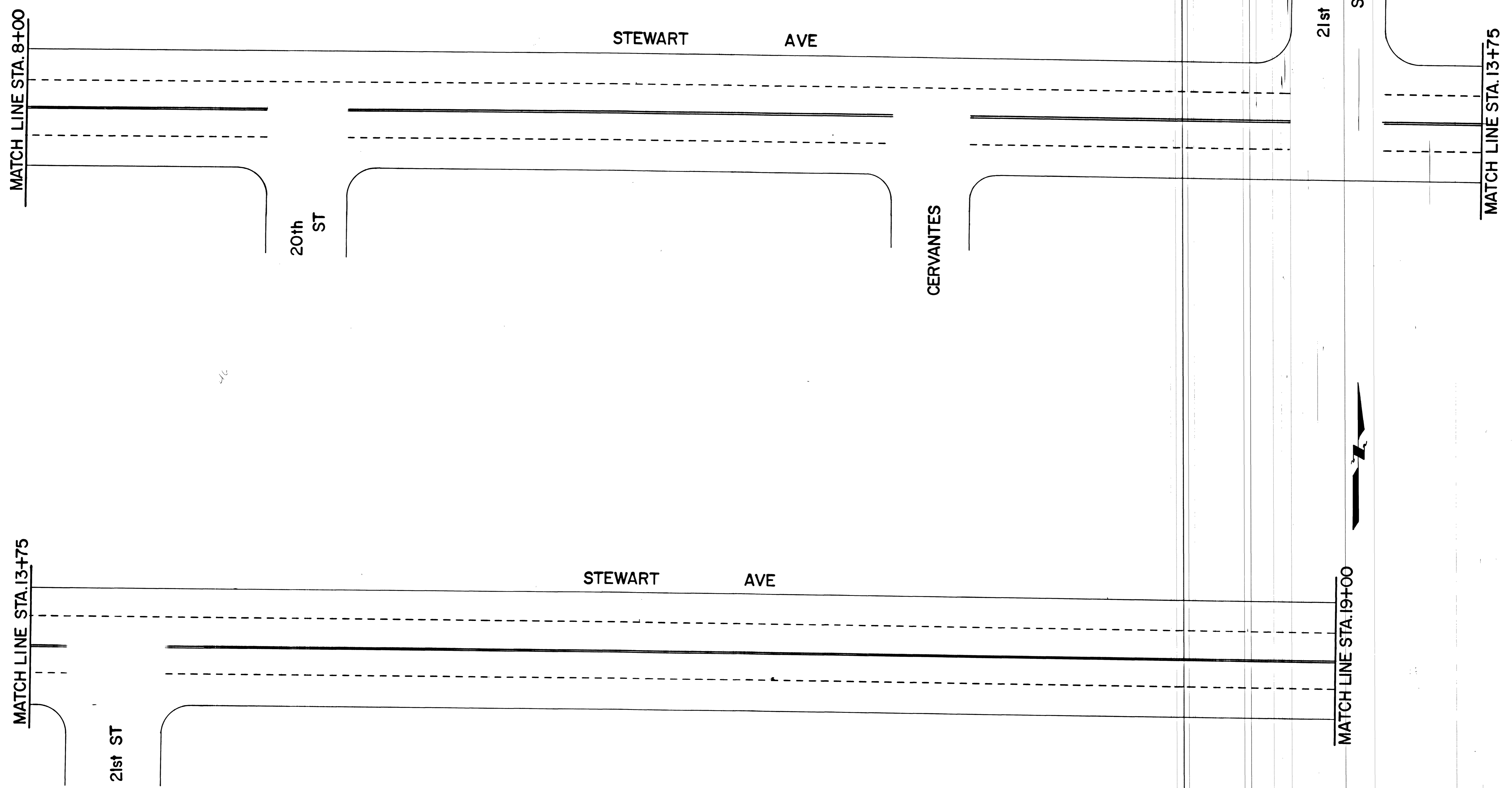

FED. RD. REG. NO.	STATE	PROJECT NO.	COUNTY	SHEET NO.
9	NEVADA	PNS-0005 (14)	CLARK	25



APPROXIMATE QUANTITIES THIS SHEET				
LANE LINE	FEET	WHITE CERAMIC	REFLECTIVE	
			RED/CLEAR	
	1,997	160		54
	FEET	YELLOW CERAMIC	YELLOW REFLECTIVE	
DOUBLE YELLOW	486	149		47

	Department of Public Services Traffic Engineering Division	
	DELINEATION	
STEWART AVE SIXTH ST TO EASTERN AVE		Scale 1" = 20' Design by G. DAMMER Approved by Supervisor of Traffic <i>[Signature]</i>
Date 12-24-79	W.O. no.	Drawn by J. CARLSON Date 3-6-12
Revisions		Date

42252