

FED. RD. REG. NO.	STATE	PROJECT NO.	COUNTY	SHEET NO.
9	NEVADA	PMS-0005(14)	CLARK	24

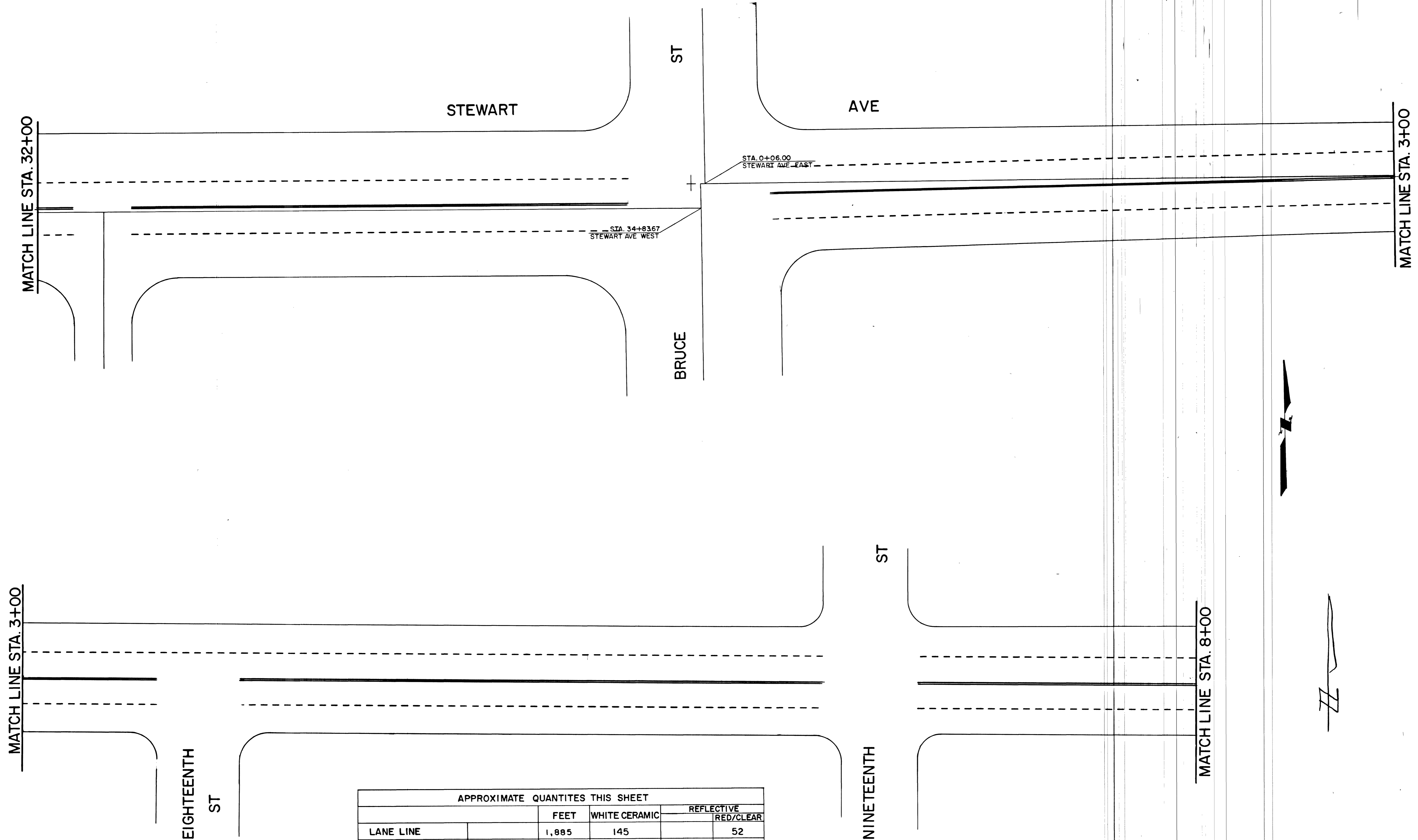

APPROXIMATE QUANTITIES THIS SHEET

	FEET	WHITE CERAMIC	REFLECTIVE	
			RED/CLEAR	
LANE LINE	1,885	145		52
DOUBLE YELLOW	935	293	YELLOW	REFLECTIVE 95

	Department of Public Services	Traffic Engineering Division	W.O. no.
	DELINEATION	STEWART AVE SIXTH ST TO EASTERN AVE	Drawn by JOHN CARLSON Date 8-6-12
Scale 1" = 20' Design by G. DAMMEIR Approved by Supervisor of Traffic <i>[Signature]</i>		Date 12-24-79	Date
		Revisions	Date