

FED. RD. REG. NO.	STATE	PROJECT NO.	COUNTY	SHEET NO.
9	NEVADA	PMS-0005(14)	CLARK	23

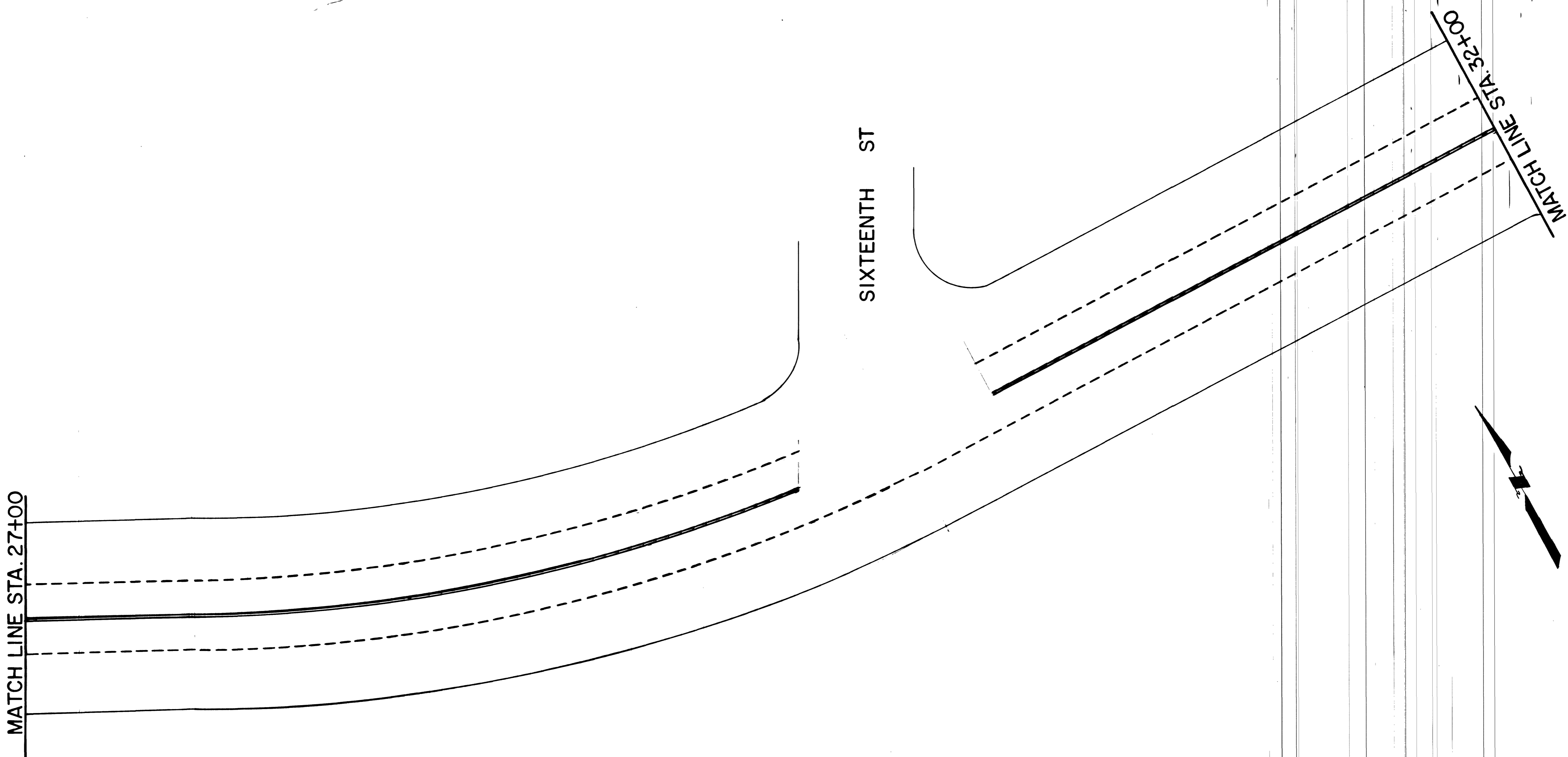

SIXTEENTH ST

MATCH LINE STA. 27+00

MATCH LINE STA. 32+00

APPROXIMATE QUANTITIES THIS SHEET					
	FEET	WHITE CERAMIC	REFLECTIVE		
				RED/CLEAR	
LANE LINE	937	75		25	
	FEET	YELLOW CERAMIC	YELLOW	REFLECTIVE	
DOUBLE YELLOW	431	133		43	

 Drawing no. 208-V328	DELINEATION STEWART AVE SIXTH ST TO EASTERN AVE	Scale 1" = 20' Design by G. DAMMEIR Approved by Supervisor of Traffic <i>[Signature]</i>	Date 12-24-79 Drawn by J. CARLSON Date 1-3-6-82	W.O. no. Revisions Date
		Department of Public Services Traffic Engineering Division	Date Revisions Date	Date Revisions Date