

NOTE:
SEE SHEET TR2 FOR LOCATION OF UNDERGROUND TRAFFIC SIGNAL CONNECTORS, CONDUITS AND FIBER OPTICS BEFORE BEGINNING CONSTRUCTION.

CONSTRUCTION NOTES

- 1 CONSTRUCT AC PAVEMENT PER TYPICAL STREET SECTION ON SHEET DT-1
- 2 REMOVE EXISTING PAVEMENT AND REPLACE PER CONSTRUCTION NOTE NO. 1
- 3 SAWCUT AND MATCH EXISTING AC
- 4 INSTALL TYPE III MONUMENT PER USDOCA DWG. NO. 241
- 5 (NOT USED)
- 6 ADJUST WATER VALVE BOX TO FINISHED GRADE PER LUDAS PLATE NO. & VALVE SHALL BE ACCESSIBLE AT ALL TIMES.
- 7 ADJUST STORM DRAIN MANHOLE TO FINISHED GRADE
- 8 CONTRACTOR TO PROTECT IN PLACE AND MATCH NEW PAVEMENT TO TOP OF ELECTRIC BOX.
- 9 PROTECT EXISTING DROP INLET IN PLACE

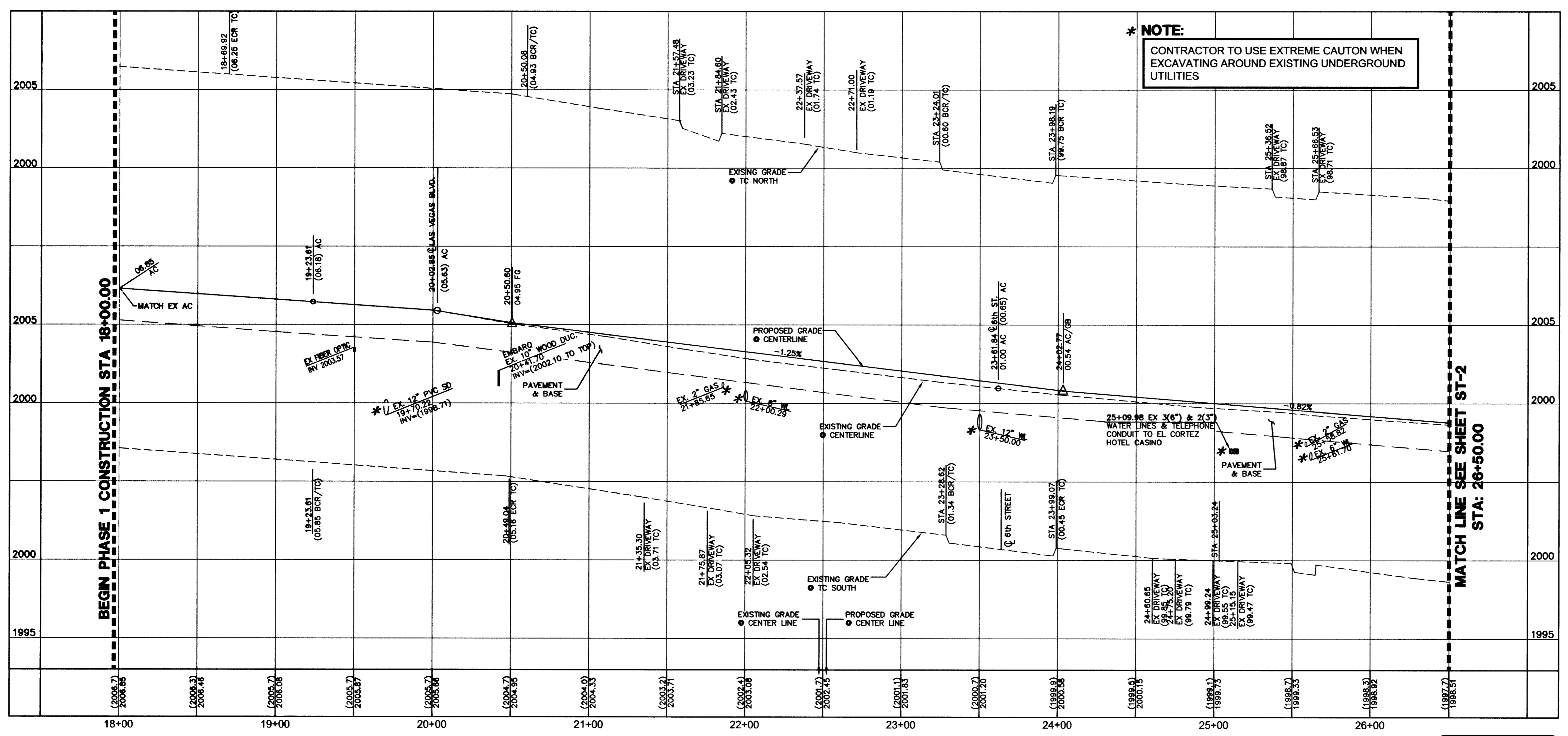

BEGIN PHASE 1 CONSTRUCTION STA 18+00.00

MATCH LINE SEE SHEET ST-2 STA: 26+50.00

LAS VEGAS VALLEY WATER DISTRICT DATE

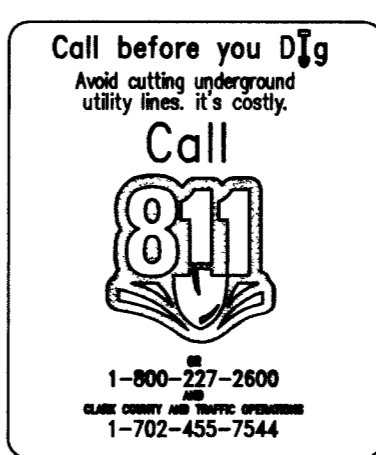

DISCLAIMER NOTE
UTILITY LOCATIONS SHOWN HEREON ARE APPROXIMATE ONLY. IT SHALL BE THE CONTRACTOR'S RESPONSIBILITY TO DETERMINE THE EXACT HORIZONTAL AND VERTICAL LOCATION OF ALL EXISTING UNDERGROUND AND OVERHEAD UTILITIES PRIOR TO COMMENCING CONSTRUCTION. NO REPRESENTATION IS MADE THAT ALL EXISTING UTILITIES ARE SHOWN HEREON. THE ENGINEER ASSUMES NO RESPONSIBILITY FOR UTILITIES NOT SHOWN OR UTILITIES NOT SHOWN IN THEIR PROPER LOCATION.

Avoid cutting underground utility lines. It's costly.
Call before you Dig
1-800-227-2600
WORKSHEET SERVICE (USA)

Avoid overhead power line contact.
Call before you OVERHEAD
1-702-227-2929
UTILITY SERVICE DEPARTMENT

DRAWN BY: JSR DESIGNED BY: GAS CHECKED BY: KTY PROJECT NO:	AUGUST, 2007 STA: 18+00.00 TO 26+50.00 PHASE 1 STEWART AVENUE SEWER & PAVEMENT REHABILITATION, PHASE I - LV BLVD. TO MARYLAND PKWY.	SCALE: HORIZ 1"=40' VERT 1"=4' SHEET ST-1 8 OF 15 SHEETS DRAWING NO. 107V3546-1	BAUGHMAN & TURNER, INC. CIVIL ENGINEERS LAND SURVEYORS LAND PLANNERS LAS VEGAS, NEVADA 89102 1210 HINSON STREET PHONE: (702) 878-2695 FAX: (702) 878-8771
---	---	--	--