

16/175

CURVE DATA				
NO	Δ	R	T	L
①	85°32'35"	30.00'	27.75'	44.79'
②	92°37'09"	30.00'	31.40'	48.50'
③	180°00'00"	1.5'	∞	4.71'
④	12°02'26"	250.00'	26.37'	52.54'
⑤	14°46'01"	250.00'	32.40'	64.43'
⑥	94°32'50"	3.5'	73.50'	10.66'
⑦	94°27'25"	25.00'	27.02'	41.21'
⑧	85°32'35"	25.00'	23.13'	37.33'

DIRECTOR OF PUBLIC WORKS DATE
James Hampton 6/17/75
 CITY ENGINEER DATE
 6-17-75
 J.O. VBA 6/17/75

K54 - C.L.V. W.O. 7682 SHTS. 34, 38
 & 39 ARE SUPERCEDED AS REQD. BY
 THIS PLAN PER MEETING OF 6/19/75

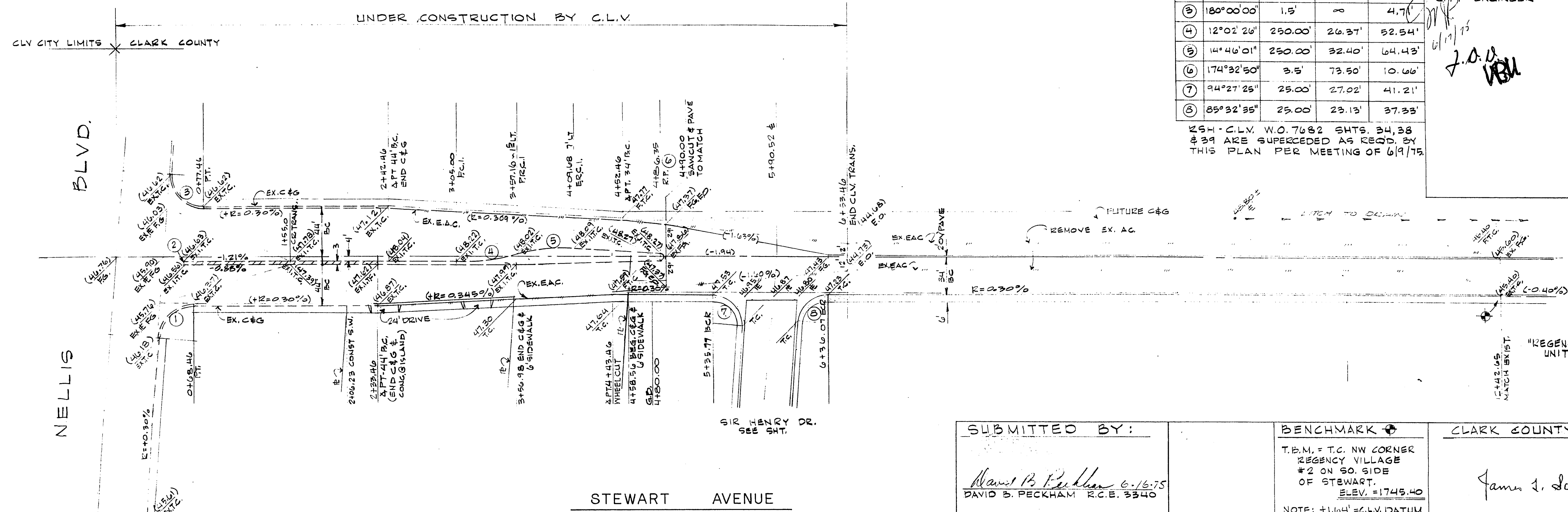

SUBMITTED BY: *David B. Peckham* 6-16-75
 DAVID B. PECKHAM R.C.E. 3340

BENCHMARK: T.B.M. = T.C. NW CORNER REGENCY VILLAGE #2 ON SO. SIDE OF STEWART. ELEV. = 1745.40
 NOTE: +1.64' = C.L.V. DATUM

CLARK COUNTY ENGINEERING DEPT.
James J. Scholl 6/16/75

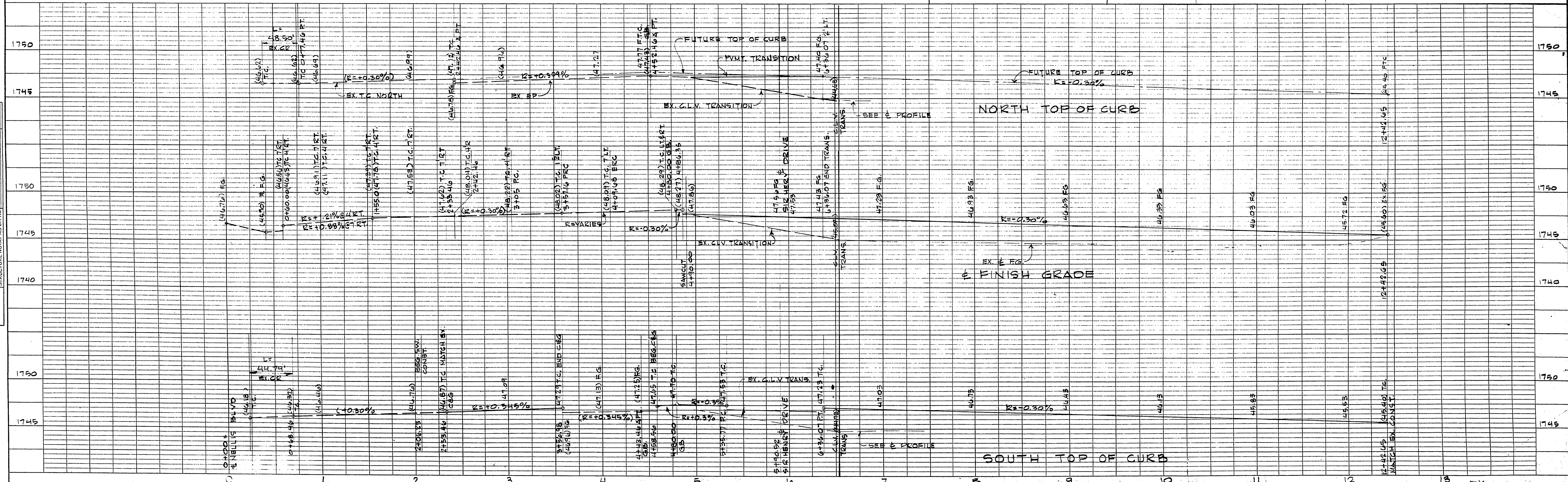

PLAN
 SURVEYED, PLOTTED, CHECKED, NOTE BOOK, ALIGNMENT CHECKED, RT. OF WAY CHECKED.
 BY: _____ DATE: _____

PROFILE
 SURVEYED, PLOTTED, CHECKED, NOTE BOOK, VERTICAL ALIGNMENT CHECKED, STRUCTURE NOTATIONS CHECKED.
 BY: _____ DATE: _____