

**PROPOSED SIGN**  
12"x18" R7-8 "RESERVED PARKING" SIGN  
**PROPOSED SIGN**  
30" R1-1 "STOP" SIGN

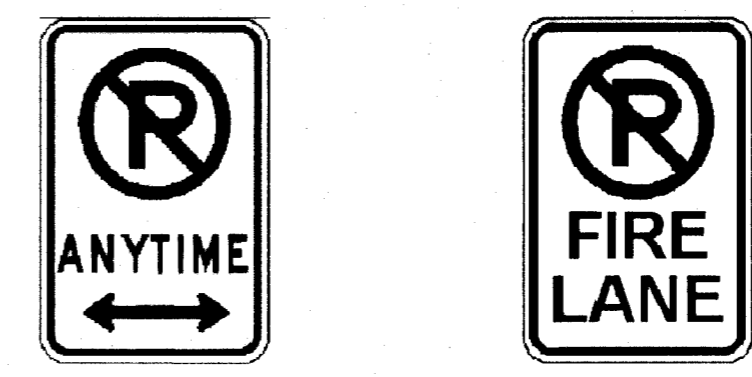

**PROPOSED SIGN**  
12"x18" R7-1APR "NO PARKING" SIGN  
**PROPOSED SIGN**  
12"x18" R7-9A "NO PARKING" SIGN

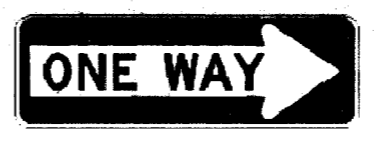

**PROPOSED SIGN**  
36"x12" R6-1R "ONEWAY" SIGN

**CONSTRUCTION NOTES - TRAFFIC**

ITEM	PUBLIC QUANTITY	PRIVATE QUANTITY
INSTALL 4" WIDE SOLID STRIPING	N/A	1542 L.F.
INSTALL 4" WIDE SOLID STRIPING 3" OC AT 45° DIAGONAL	N/A	2408 L.F.
INSTALL 250 WATT LUMINAIRE PER STD DWG 314, 320, & 321	3 EA.	N/A
INSTALL 2" PVC STREETLIGHT CONDUIT WITH (1) #8 AND (2) #4 THW COPPER CONDUCTORS PER STD DWG 313 & 321	55 L.F.	N/A
INSTALL F.A.S.T. 4" PVC CONDUIT WITH #8 BARE OR GREEN TRACER WIRE	NOT USED	NOT USED
HANDICAP PARKING STALL W/ R7-8 "RESERVED PARKING" SIGN	N/A	13 EA.
RED PAINTED CURB FOR FIRE LANE ACCESS	N/A	2,160 L.F.
INSTALL R7-9APR "NO PARKING" SIGN	N/A	32 EA.
INSTALL R1-1 30" "STOP" SIGN	N/A	4 EA.
INSTALL 18"x 24" R7-1APR "NO PARKING" SIGN	N/A	10 EA.
INSTALL 36"x 12" R6-1R "ONE WAY" SIGN	5 EA.	N/A
REMOVE FOUNDATION 24" MIN BELOW FG CONNECT CONDUIT AND PULL WIRE.	5 EA.	N/A
200 AMP 240V PAD MOUNT SERVICE WITH 2-2 POLE 60 AMP CIRCUIT BREAKERS 1-1 POLE 15 AMP CIRCUIT BREAKERS 0-1 POLE 40 AMP CIRCUIT BREAKERS 2-2 POLE 60 AMP CONTACTORS 1-BY-PASS SWITCH PER CONTACTOR	5 EA.	N/A

**NOTE:**  
ANY WORK IN NDOT RIGHT-OF-WAY REQUIRES A SEPARATE NDOT PERMIT.

**UTILITY NOTE**

UTILITY LOCATIONS SHOWN HEREON ARE APPROXIMATE ONLY. IT SHALL BE THE CONTRACTOR'S RESPONSIBILITY TO DETERMINE THE EXACT HORIZONTAL AND VERTICAL LOCATION OF ALL EXISTING UNDERGROUND UTILITIES PRIOR TO COMMENCING CONSTRUCTION. NO REPRESENTATION IS MADE THAT ALL EXISTING UTILITIES ARE SHOWN HEREON. THE ENGINEER ASSUMES NO RESPONSIBILITY FOR UTILITIES NOT SHOWN OR UTILITIES NOT SHOWN IN THEIR PROPER LOCATION.

AVOID CUTTING UNDERGROUND UTILITY LINES. IT'S COSTLY.  
**Call before you Dig**  
1-800-227-2600  
UNDERGROUND SERVICE (USA)

AVOID HITTING OVERHEAD POWER LINES. IT'S COSTLY.  
**Call before you Dig**  
CALL 1-702-227-2929

CALL BEFORE YOU DIG UNDERGROUND  
CALL 1-702-227-2929

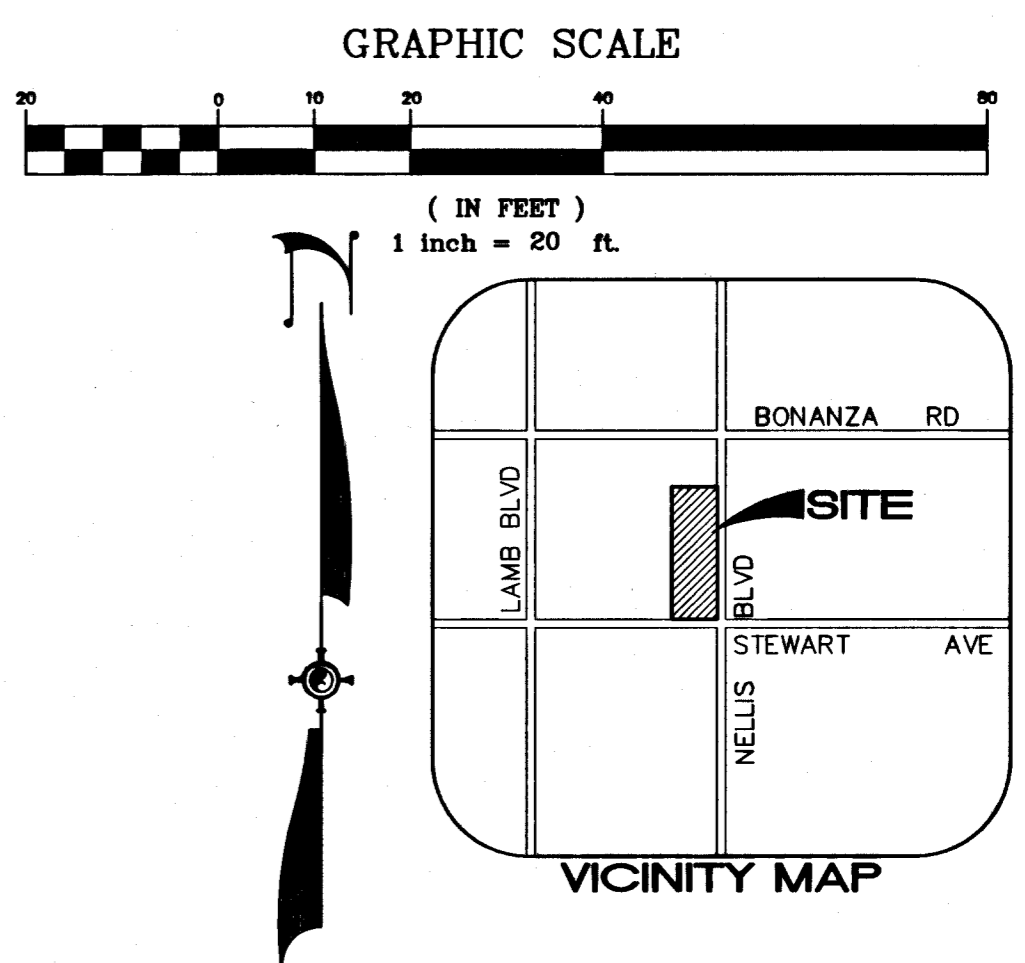

**LEGEND**

- CENTERLINE
- PROPERTY LINE
- RIGHT OF WAY
- EXISTING CONTOUR W/ ELEVATION
- EXISTING CURB & GUTTER
- EXISTING GRADES
- EXISTING 100W STREET LIGHT
- EXISTING 250W STREET LIGHT
- EXISTING 250W DBL ARM STREET LIGHT
- TC TOP OF CURB
- FL FLOW LINE
- AC ASPHALT CONCRETE
- SW SIDEWALK

**EXISTING**

- EXISTING TYPE 4 CENTERLINE (TO REMAIN)
- EXISTING LEFT TURN LANE LINE (TO REMAIN)
- EXISTING CROSSWALK (TO REMAIN)
- EXISTING STOP BAR (TO REMAIN)
- EXISTING 4" PAINTED DIRECTIONAL STRIPING (TO REMAIN)
- EXISTING SIGNAL LIGHT MAST ARM AND APPURTENANCES (TO REMAIN)
- EXISTING RIGHT HAND TURN LANE (TO REMAIN)

**SUMMIT ENGINEERING CORPORATION**  
389 FLOTT ROAD, SUITE A, LAS VEGAS, NV, 89109  
PHONE (702) 252-3238 FAX: (702) 252-3247

DESIGNED BY: ACADRIA  
DRAWN BY: ACADRIA  
CHECKED BY:  
DATE: Copyright SUMMIT ENG 2007

**CIVIL IMPROVEMENT PLANS FOR STEWART AND NELLIS TRAFFIC, SIGNAGE, STRIPING AND STREETLIGHT PLAN**  
CLARK COUNTY LAS VEGAS

SHEET	SCALE	REV.	DATE	DESCRIPTION	BY	APPD
C21	HORIZ: 1"=20'					
26	VERT: N/A					

JOB NO: J73098  
DATE: 8-28-AUG-2007

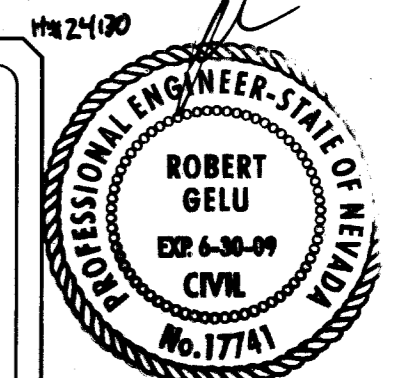

9-26-07  
1074960