

FLOOD ZONE INFORMATION

The subject site is located within Zone X, as shown on FIRM Community Panel Number 32003C2187, revised September 27, 2002. AND 32003C2195, revise September 27, 2002. Zone X is determined to be outside the 0.2% annual flood plain.

RAW EARTHWORK QUANTITIES W/ OVER EX.

APPROX. CUT = 26,037 C.Y. EXPORTED DIRT
 APPROX. FILL = 47,222 C.Y. IMPORT
 APPROX. NET FILL = 47,222 C.Y. IMPORT

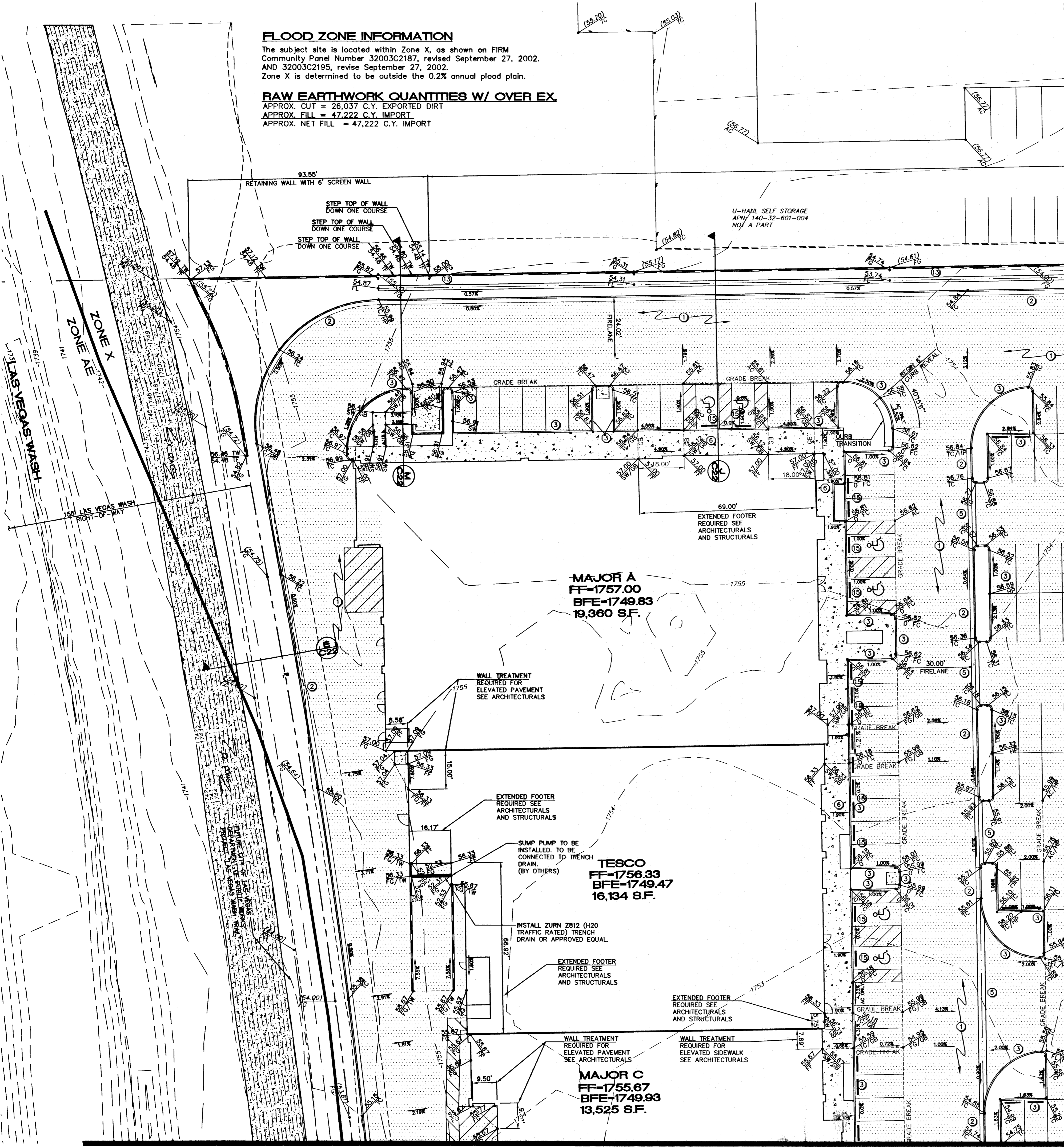

ITEM	DESCRIPTION	DIST (A)	DIST (B)
(A)	CONSTRUCT HANDICAP RAMP (CASE II) USING ARMOR TILE TRUNCATED DOMES EQUIVALENT TO C.C.U.S.D. NO. 235	8.00'	8.00'
(B)	CONSTRUCT HANDICAP RAMP (CASE II) USING ARMOR TILE TRUNCATED DOMES EQUIVALENT TO C.C.U.S.D. NO. 235	9.50'	4.50'

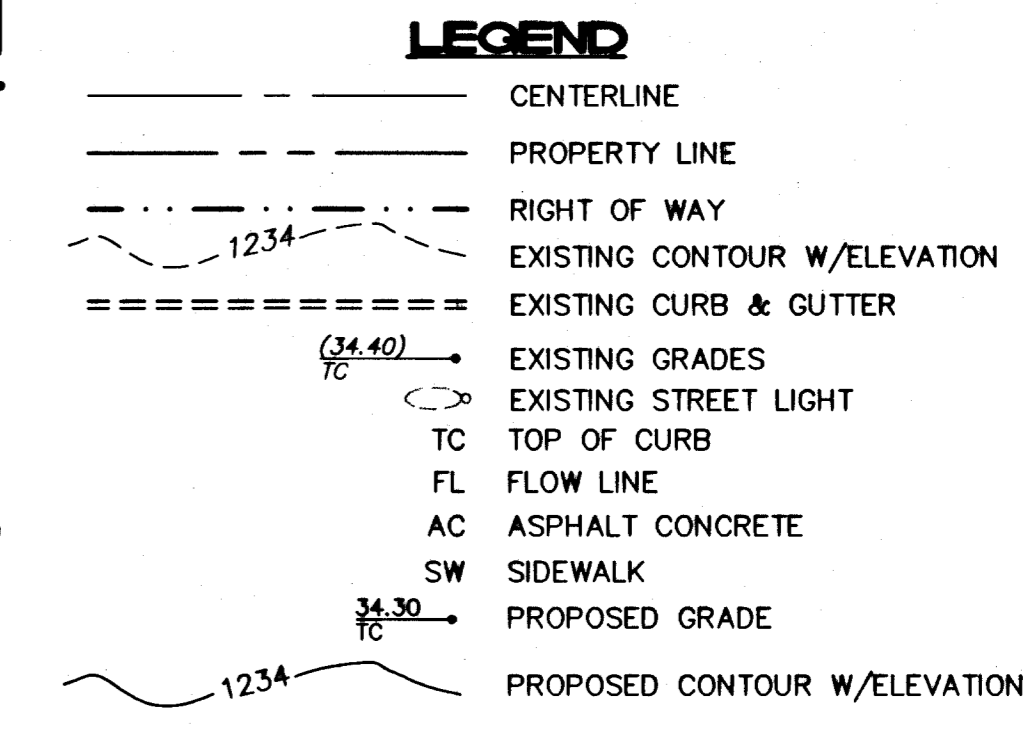
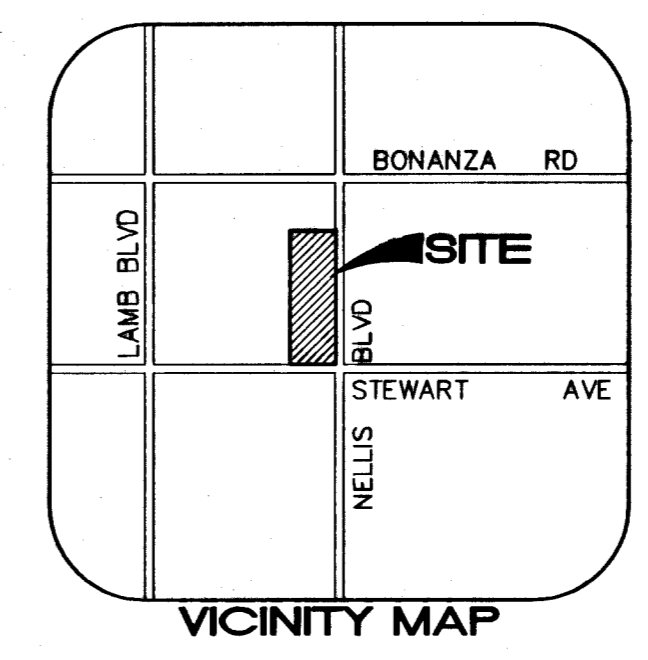
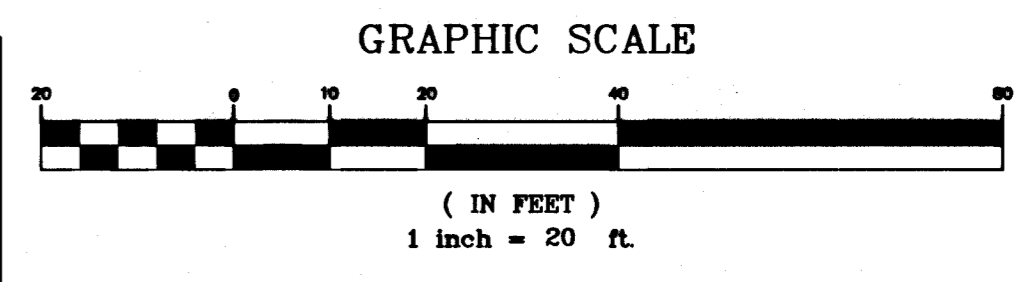

GRADING NOTES

ITEM	QUANTITY	
	PUBLIC	PRIVATE
1	N/A	3' AC = 19,792 S.Y. 6' TYPE II = 3,299 C.Y.
2	N/A	1,330 L.F.
3	N/A	2,171 L.F.
4	8 EA.	6 EA.
5	N/A	1,109.93 L.F.
6	N/A	20,029 S.F.
7	2,434 S.F.	N/A
8	825 S.F.	N/A
9	2 EA.	N/A
10	618 S.Y.	N/A
11	644 S.Y.	N/A
12	N/A	1 EA.
13	N/A	1,109.93 L.F.
14	N/A	N/A
15	N/A	27 EA.
16	146 L.F.	N/A

MATCHLINE SEE SHEET C8 OF 26

GRADING NOTES

- ALL GRADING SHALL BE PERFORMED AS SHOWN ON THESE PLANS. NO DEVIATION FROM THESE PLANS IS PERMITTED WITHOUT WRITTEN PERMISSION FROM THE ENGINEER.
- ALL PAD AND ONSITE SWALE ELEVATIONS SHOWN ON THESE PLANS ARE ROUGH GRADE ONLY. ALL OTHER GRADES ARE FINISHED GRADES.
- A COPY OF THE APPROVED GRADING PLANS ARE TO BE ON THE JOB SITE THROUGHOUT THE ENTIRE COURSE OF CONSTRUCTION.
- ALL GRADING IS TO BE PERFORMED IN CONFORMANCE WITH THE GEOTECHNICAL REPORT AS FOLLOWS:
 TERRACON
 PROJ # 64055095
 DATED 07-22-2005
- NO STRUCTURE, VEGETATION, OR OBJECT OF ANY KIND IS PERMITTED OVER TWENTY-FOUR (24) INCHES IN HEIGHT (MEASURED FROM THE TOP OF THE ADJACENT CURB IF CURB EXISTS) WITHIN THE SIGHT VISIBILITY ZONES.

I CERTIFY THAT THIS GRADING PLAN IS IN CONFORMANCE WITH THE APPROVED DRAINAGE STUDY ON FILE AT THE CITY OF LAS VEGAS FOR THIS PROJECT (DS4170)
 ROBERT GELU, P.E. #17741 9-26-07 DATE

BASIS OF BEARING
 NORTH 89°21'36" EAST, BEING THE BEARING OF THE SOUTH LINE OF THE SOUTHEAST QUARTER (SE 1/4) OF THE NORTHEAST QUARTER (NE 1/4) OF SECTION 32, TOWNSHIP 20 SOUTH, RANGE 62 EAST, M.D.M., CLARK COUNTY, NEVADA, AS SHOWN BY MAP THEREOF ON FILE IN FILE 38, PAGE 11 OF PARCEL MAPS IN THE CLARK COUNTY RECORDER'S OFFICE, CLARK COUNTY, NEVADA.

PROJECT BENCHMARK
 CLARK COUNTY BENCHMARK STATION 6002 33W4 BEING A 2" BRASS CAP REFERENCE MONUMENT IN TOP OF CURB AT THE NORTHEAST CORNER OF THE INTERSECTION OF NELLIS BOULEVARD AND STEWART AVENUE, NEAR THE P.C. OF NELLIS BOULEVARD.
 PUBLISHED ELEV: 533.6817m (NAVD 88)
 PUBLISHED CONVERSION FACTOR: m = 3937/1200 = U.S. SURVEY FEET
 CONVERTED ELEV: 1750.92 U.S. SURVEY FEET

UTILITY NOTE
 UTILITY LOCATIONS SHOWN HEREON ARE APPROXIMATE ONLY. IT SHALL BE THE CONTRACTOR'S RESPONSIBILITY TO DETERMINE THE EXACT HORIZONTAL AND VERTICAL LOCATION OF ALL EXISTING UNDERGROUND UTILITIES PRIOR TO COMMENCING CONSTRUCTION. NO REPRESENTATION IS MADE THAT ALL EXISTING UTILITIES ARE SHOWN HEREON. THE ENGINEER ASSUMES NO RESPONSIBILITY FOR UTILITIES NOT SHOWN OR UTILITIES NOT SHOWN IN THEIR PROPER LOCATION.
 Call before you Dig
 1-800-227-2600
 UNDERGROUND SERVICE (USA)

Call before you UnderGround
 1-702-465-7511
 1-702-228-8811
 LAS VEGAS AREA COMPLETED TRAFFIC SYSTEM

PROFESSIONAL ENGINEER - STATE OF NEVADA
 ROBERT GELU
 EX-6-30-09
 CIVIL
 No. 17741
 9-26-07
 10744960

SUMMIT ENGINEERING CORPORATION
 98 FLOTT ROAD, SUITE A, LAS VEGAS, NV 89109
 PHONE (702) 252-3888 FAX (702) 252-3847

DESIGNED BY: ACADRIA
 DRAWN BY: ACADRIA
 CHECKED BY:
 DATE: Copyright SUMMIT ENG 2007

NEVADA
 CLARK COUNTY
 LAS VEGAS

BY	APP'D	DESCRIPTION	DATE	REV.

SCALE: 1"=20'
 HORIZ: N/A
 VERT: N/A
 JOB NO: J73093
 IN DESIGN: J73093 (F:\m\103_07_Grading\DWG_103_07_Grading.DWG - 8:53 AM - 29-AUG-2007)

SHEET C7 OF 26