

MATCHLINE SEE SHEET C7 OF 26

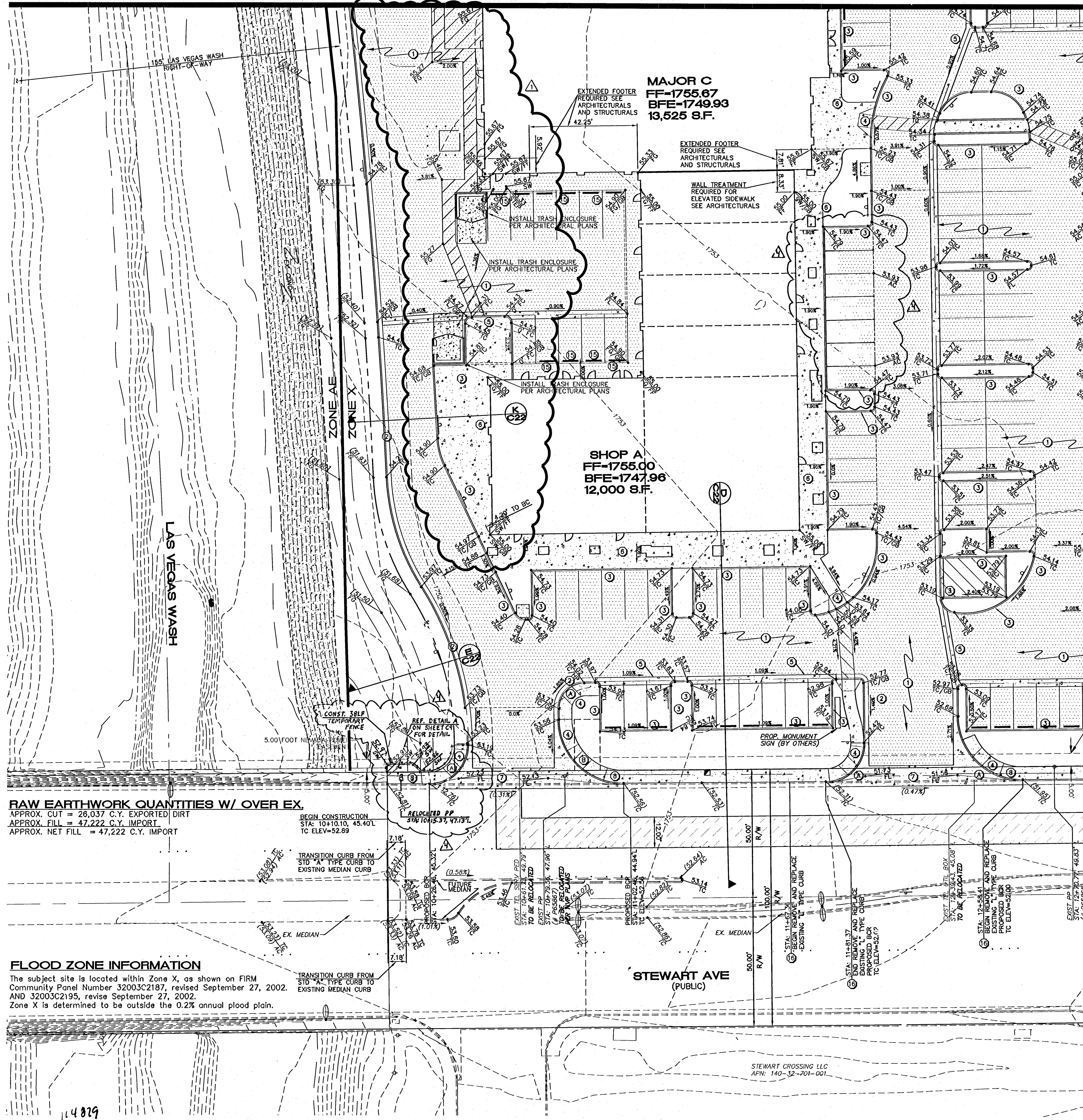

RAW EARTHWORK QUANTITIES W/ OVER EX.
 APPROX. CUT = 26,037 C.Y. EXPORTED DIRT
 APPROX. FILL = 47,222 C.Y. IMPORT
 APPROX. NET FILL = 47,222 C.Y. IMPORT

FLOOD ZONE INFORMATION
 The subject site is located within Zone X, as shown on FIRM Community Panel Number 32003C2187, revised September 27, 2002, AND 32003C2195, revised September 27, 2002. Zone X is determined to be outside the 0.2% annual flood plain.

MAJOR C
 FF-1755.67
 BFE-1749.93
 13,525 S.F.

SHOP A
 FF-1755.00
 BFE-1747.96
 12,000 S.F.

LEGEND

- CENTERLINE
- PROPERTY LINE
- - - RIGHT OF WAY
- - - EXISTING CONTOUR W/ELEVATION
- - - EXISTING CURB & GUTTER
- - - EXISTING GRADES
- - - EXISTING STREET LIGHT
- TC TOP OF CURB
- FL FLOW LINE
- AC ASPHALT CONCRETE
- SW SIDEWALK
- - - PROPOSED GRADE
- 0 FC' 0' FACE OF CURB (AC AND SIDEWALK AT SAME ELEVATION)

I CERTIFY THAT THIS GRADING PLAN IS IN CONFORMANCE WITH THE APPROVED DRAINAGE STUDY ON FILE AT THE CITY OF LAS VEGAS FOR THIS PROJECT (054170-1)
 ROBERT GELU, P.E. #17741 DATE 5-16-08

ITEM	DESCRIPTION	DIST (A)	DIST (B)
A	CONSTRUCT HANDICAP RAMP (CASE II) USING ARMOR TILE TRUNCATED DOMES EQUIVALENT TO C.C.U.S.D. NO. 235	8.00'	8.00'
B	CONSTRUCT HANDICAP RAMP (CASE I) USING ARMOR TILE TRUNCATED DOMES EQUIVALENT TO C.C.U.S.D. NO. 235	9.50'	4.50'

GRAPHIC SCALE

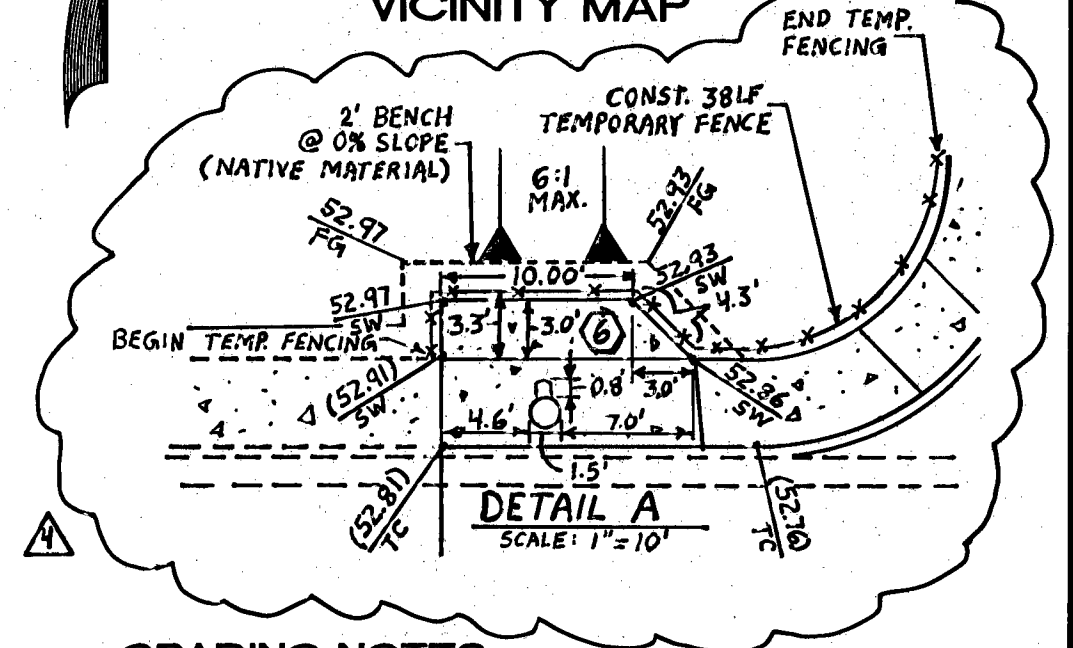
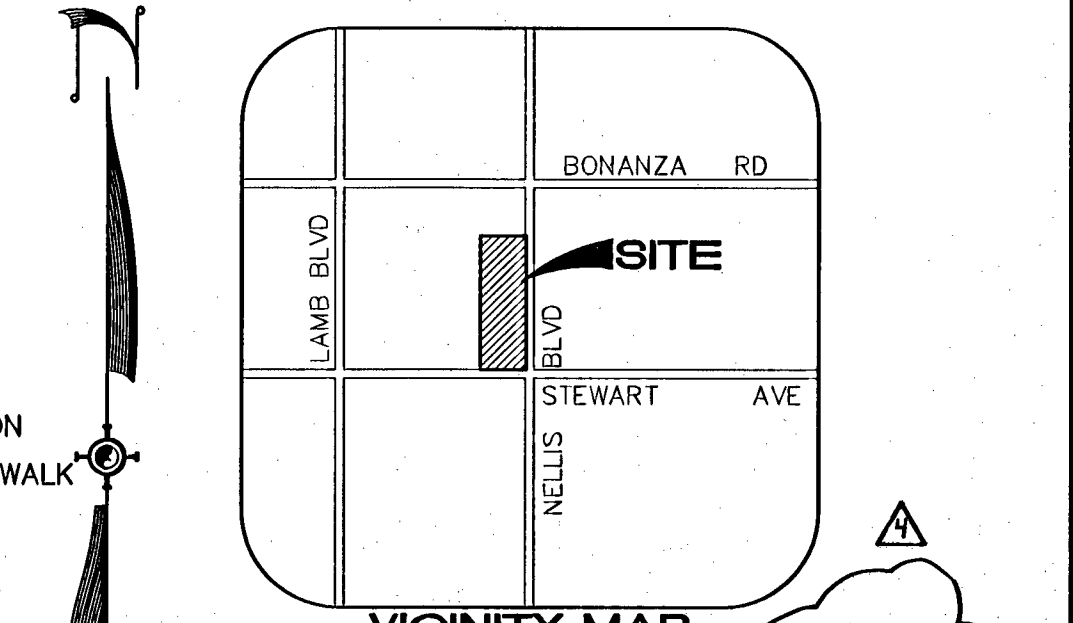
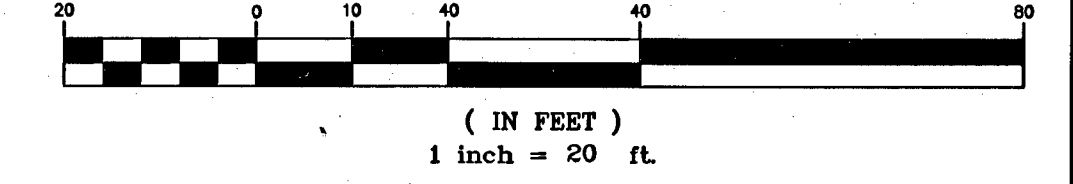

GRADING NOTES

ITEM	QUANTITY	QUANTITY	
		PUBLIC	PRIVATE
1. CONSTRUCT 3" AC OVER 6" TYPE II AB PER SOILS REPORT	N/A		3" AC = 19,792 S.Y. 6" TYPE II = 3,299 C.Y.
2. CONSTRUCT "L" TYPE CURB PER STD DWG NO 216	N/A		1,336 L.F.
3. CONSTRUCT "A" TYPE CURB PER STD DWG NO 219	N/A		2,185 L.F.
4. CONSTRUCT HANDICAP RAMP (CASE II) PER C.C.S.D. NO. 235 (SEE NOTE THIS SHEET)	8 EA.		8 EA.
5. CONSTRUCT 3" WIDE VALLEY GUTTER PER DETAIL	N/A		1,086 L.F.
6. CONSTRUCT VARIABLE WIDTH 4" THICK SIDEWALK PER C.C.S.D. NO. 234	N/A		20,029 S.F. 20,516 S.F. 20,550 S.F.
7. CONSTRUCT 6" WIDE VALLEY GUTTER PER C.C.S.D. NO. 228	2,434 S.F.		N/A
8. CONSTRUCT 5" WIDE 4" THICK SIDEWALK PER C.C.S.D. NO. 234	825 S.F.		N/A
9. CONSTRUCT 2" WIDE SIDEWALK UNDERDRAIN PER C.C.S.D. NO. 236	2 EA.		N/A
10. SAWCUT, TRENCH AND BACKFILL PER C.C.S.D. NO. 504	618 S.Y.		N/A
11. INSTALL CLASS 150 - 6" DIA 12" RIP RAP	615 S.Y.		N/A
12. CONSTRUCT DEPRESSED CURB PER DETAIL	N/A		1 EA.
13. CONSTRUCT 2" WIDE VALLEY GUTTER PER DETAIL	N/A		1,109.93 L.F.
14. CONSTRUCT CURB TRANSITION PER DETAIL	N/A		N/A
15. INSTALL PRECAST BUMPER BLOCKS PER C.C.S.D. 238	N/A		25 EA. 27 EA.
16. REMOVE AND REPLACE EXISTING "L" TYPE CURB AND GUTTER PER C.C.S.D. 219	146 L.F.		N/A
17. INSTALL TACK ON ISLAND CURB PER C.C.S.D. 220	103 L.F.		N/A

PROFESSIONAL ENGINEER - STATE OF NEVADA
 MICHAEL P. VIALPANDO
 11/24/08
 FOR REVISION ONLY

MATCHLINE SEE SHEET C10 OF 26

GRADING NOTES

- ALL GRADING SHALL BE PERFORMED AS SHOWN ON THESE PLANS. NO DEVIATION FROM THESE PLANS IS PERMITTED WITHOUT WRITTEN PERMISSION FROM THE ENGINEER.
- ALL PAD AND ONSITE SWALE ELEVATIONS SHOWN ON THESE PLANS ARE ROUGH GRADE ONLY. ALL OTHER GRADES ARE FINISHED GRADES.
- A COPY OF THE APPROVED GRADING PLANS ARE TO BE ON THE JOB SITE THROUGHOUT THE ENTIRE COURSE OF CONSTRUCTION.
- ALL GRADING IS TO BE PERFORMED IN CONFORMANCE WITH THE GEOTECHNICAL REPORT AS FOLLOWS:
 TERRACON
 PROJ # 64055095
 DATED 07-22-2005
- NO STRUCTURE, VEGETATION, OR OBJECT OF ANY KIND IS PERMITTED OVER TWENTY-FOUR (24) INCHES IN HEIGHT (MEASURED FROM THE TOP OF THE ADJACENT CURB IF CURB EXISTS) WITHIN THE SIGHT VISIBILITY ZONES.

BASIS OF BEARING

NORTH 89°21'38" EAST, BEING THE BEARING OF THE SOUTH LINE OF THE SOUTHEAST QUARTER (SE 1/4) OF THE NORTHEAST QUARTER (NE 1/4) OF SECTION 32, TOWNSHIP 20 SOUTH, RANGE 62 EAST, M.D.M., CLARK COUNTY, NEVADA, AS SHOWN BY MAP THEREOF ON FILE IN FILE 38, PAGE 11 OF PARCEL MAPS IN THE CLARK COUNTY RECORDER'S OFFICE, CLARK COUNTY, NEVADA.

PROJECT BENCHMARK

CLARK COUNTY BENCHMARK STATION 6002 33W4 BEING A 2" BRASS CAP REFERENCE MONUMENT IN TOP OF CURB AT THE NORTHEAST CORNER OF THE INTERSECTION OF NELLIS BOULEVARD AND STEWART AVENUE, NEAR THE P.C. OF NELLIS BOULEVARD.

PUBLISHED ELEV: 533.6817m (NAVD 88)
 PUBLISHED CONVERSION FACTOR: 1.98337/1200 = U.S. SURVEY FEET
 CONVERTED ELEV: 1750.92 U.S. SURVEY FEET

UTILITY NOTE

UTILITY LOCATIONS SHOWN HEREON ARE APPROXIMATE ONLY. IT SHALL BE THE CONTRACTOR'S RESPONSIBILITY TO DETERMINE THE EXACT HORIZONTAL AND VERTICAL LOCATION OF ALL EXISTING UNDERGROUND UTILITIES PRIOR TO COMMENCING CONSTRUCTION. NO REPRESENTATION IS MADE THAT ALL EXISTING UTILITIES ARE SHOWN HEREON. THE ENGINEER ASSUMES NO RESPONSIBILITY FOR UTILITIES NOT SHOWN OR UTILITIES NOT SHOWN IN THEIR PROPER LOCATION.

AVOID CUTTING UNDERGROUND POWER LINES. IT'S COSTLY.
 Call before you Dig
 1-800-227-2600
 UNDERGROUND SERVICE (USA)

AVOID HITTING OVERHEAD POWER LINES. IT'S COSTLY.
 Call before you Dig
 1-702-227-2829

AVOID HITTING UNDERGROUND AND STREET LIGHTS. IT'S COSTLY.
 Call before you Dig
 1-702-455-7511
 CLARK COUNTY PUBLIC UTILITIES DEPARTMENT
 1-702-229-6611
 LAS VEGAS AREA COMPLEMENTED TRAFFIC SYSTEM

PROFESSIONAL ENGINEER - STATE OF NEVADA
 ROBERT GELU
 EX-6-30-09
 CIVIL
 No. 17741

SUMMIT ENGINEERING CORPORATION
 381 PULIT ROAD, SUITE A LAS VEGAS, NV 89166
 PHONE 702-222-6666 FAX 702-222-6667

DESIGNED BY: ACADRIA
 DRAWN BY: ACADRIA
 CHECKED BY:
 DATE: Copyright SUMMIT ENG. 2008

NEVADA
 CLARK COUNTY
 LAS VEGAS

CIVIL IMPROVEMENT PLANS FOR STEWART AND NELLIS GRADING PLAN

REV.	DATE	DESCRIPTION	BY	APPD
1	5/09/08	ADD TRASH BIN UPDATE - QUANTITIES	MG/RS	
2	11/20/08	SW PORPAT + TEMP FENCING	MG/RS	
3		ADDED AND HC PARKING REMOVED	MG/RS	

SCALE: HORIZ: 1"=20' VERT: N/A
 JOB NO: U73068
 SHEET 09 OF 26
 RELOT CLV DWG NO. 10714960