

LEGEND

- CENTERLINE
- PROPERTY LINE
- RIGHT OF WAY
- EXISTING CONTOUR W/ELEVATION
- EXISTING CURB & GUTTER
- EXISTING GRADES
- EXISTING STREET LIGHT
- TC TOP OF CURB
- FL FLOW LINE
- AC ASPHALT CONCRETE
- SW SIDEWALK
- PROPOSED GRADE
- PROPOSED CONTOUR W/ELEVATION
- 0' FACE OF CURB (AC AND SIDEWALK AT SAME ELEVATION)

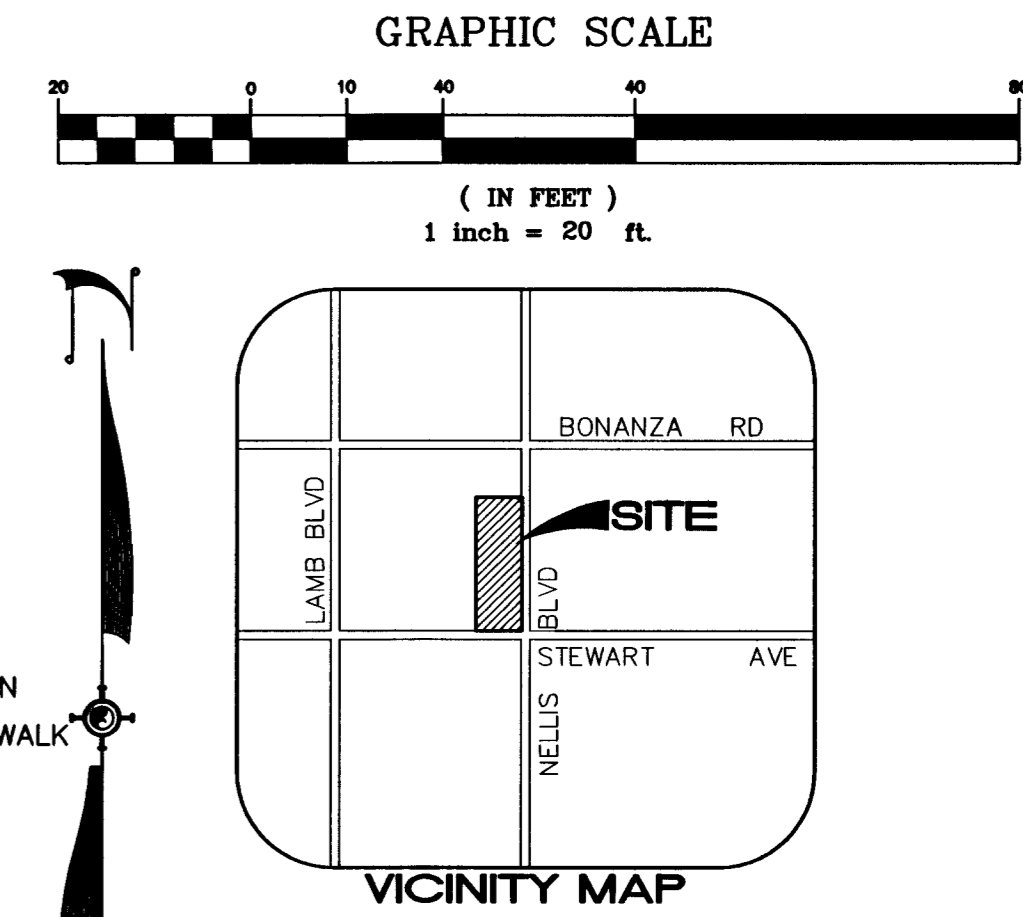

CERTIFY THAT THIS GRADING PLAN IS IN CONFORMANCE WITH THE APPROVED DRAINAGE STUDY ON FILE AT THE CITY OF LAS VEGAS FOR THIS PROJECT (DS4170-1)

ROBERT GELU, P.E. #17741 DATE 5-16-08

ITEM	DESCRIPTION	DIST (A)	DIST (B)
A	CONSTRUCT HANDICAP RAMP (CASE I) USING ARMOR TILE TRUNCATED DOMES EQUIVALENT TO C.C.U.S.D. NO. 235	8.00'	8.00'
B	CONSTRUCT HANDICAP RAMP (CASE II) USING ARMOR TILE TRUNCATED DOMES EQUIVALENT TO C.C.U.S.D. NO. 235	9.50'	4.50'

GRADING NOTES

ITEM	QUANTITY	
	PUBLIC	PRIVATE
1	N/A	3' AC = 19,792 S.Y. 6" TYPE II = 3,299 C.Y.
2	N/A	1,336 L.F.
3	N/A	2,185 L.F.
4	8 EA.	6 EA.
5	N/A	1,086 L.F.
6	N/A	20,315 S.F.
7	2,434 S.F.	N/A
8	825 S.F.	N/A
9	2 EA.	N/A
10	618 S.Y.	N/A
11	615 S.Y.	N/A
12	N/A	1 EA.
13	N/A	1,109.93 L.F.
14	N/A	N/A
15	N/A	27 EA.
16	146 L.F.	N/A
17	103 L.F.	N/A

MATCHLINE SEE SHEET C10 OF 26

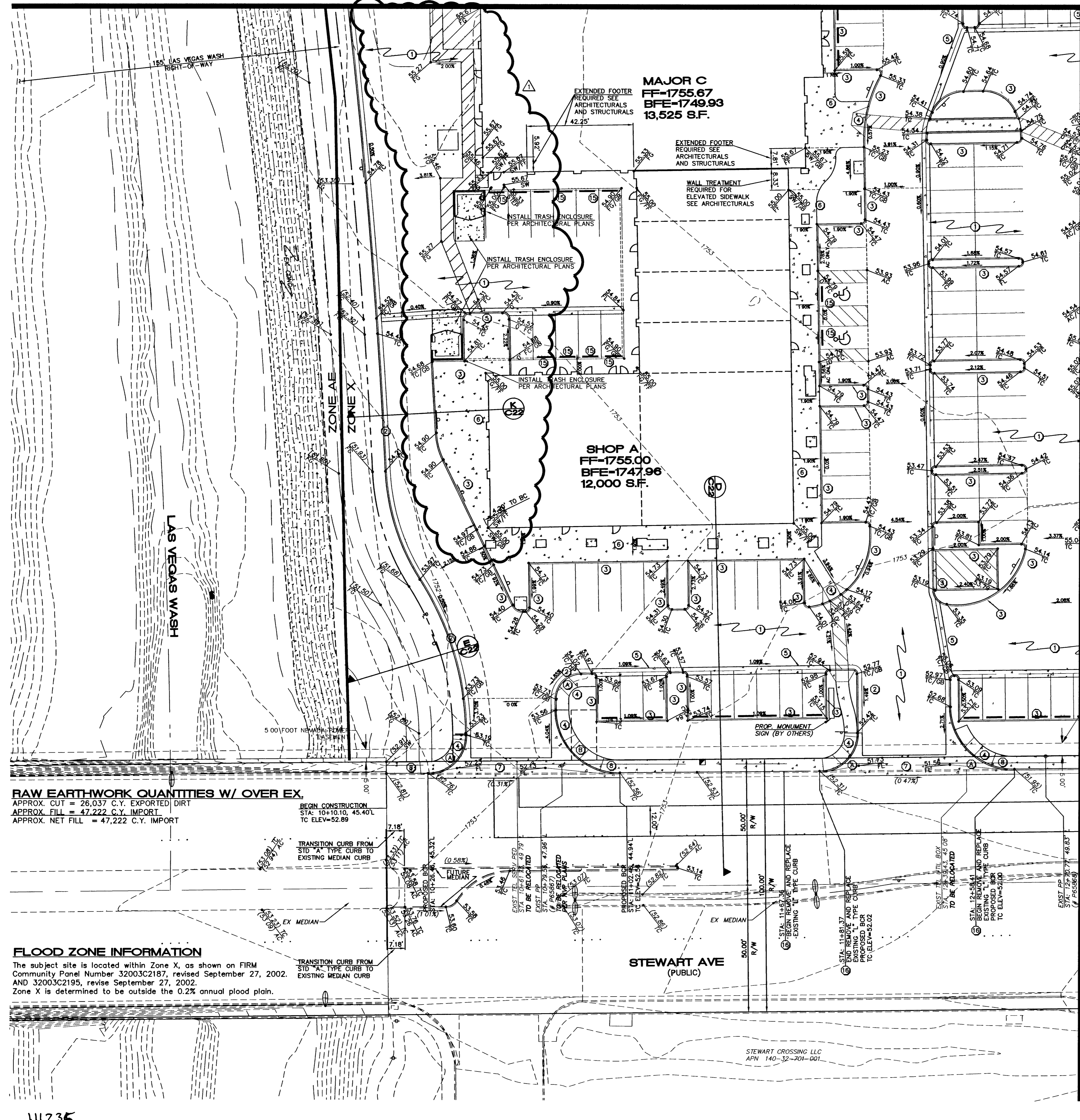

RAW EARTHWORK QUANTITIES W/ OVER EX.
 APPROX. CUT = 26,037 C.Y. EXPORTED DIRT
 APPROX. FILL = 47,222 C.Y. IMPORT
 APPROX. NET FILL = 47,222 C.Y. IMPORT

FLOOD ZONE INFORMATION
 The subject site is located within Zone X, as shown on FIRM Community Panel Number 32003C2187, revised September 27, 2002, AND 32003C2195, revised September 27, 2002. Zone X is determined to be outside the 0.2% annual flood plain.

GRADING NOTES

- ALL GRADING SHALL BE PERFORMED AS SHOWN ON THESE PLANS. NO DEVIATION FROM THESE PLANS IS PERMITTED WITHOUT WRITTEN PERMISSION FROM THE ENGINEER.
- ALL PAD AND ONSITE SWALE ELEVATIONS SHOWN ON THESE PLANS ARE ROUGH GRADE ONLY. ALL OTHER GRADES ARE FINISHED GRADES
- A COPY OF THE APPROVED GRADING PLANS ARE TO BE ON THE JOB SITE THROUGHOUT THE ENTIRE COURSE OF CONSTRUCTION
- ALL GRADING IS TO BE PERFORMED IN CONFORMANCE WITH THE GEOTECHNICAL REPORT AS FOLLOWS:
TERRACON
PROJ # 64055095
DATED 07-22-2005
- NO STRUCTURE, VEGETATION, OR OBJECT OF ANY KIND IS PERMITTED OVER TWENTY-FOUR (24) INCHES IN HEIGHT (MEASURED FROM THE TOP OF THE ADJACENT CURB IF CURB EXISTS) WITHIN THE SIGHT VISIBILITY ZONES

BASIS OF BEARING

NORTH 89°21'36" EAST, BEING THE BEARING OF THE SOUTH LINE OF THE SOUTHEAST QUARTER (SE 1/4) OF THE NORTHEAST QUARTER (NE 1/4) OF SECTION 32, TOWNSHIP 20 SOUTH, RANGE 82 EAST, M.D.M., CLARK COUNTY, NEVADA, AS SHOWN BY MAP THEREOF ON FILE IN FILE 38, PAGE 11 OF PARCEL MAPS IN THE CLARK COUNTY RECORDER'S OFFICE, CLARK COUNTY, NEVADA.

PROJECT BENCHMARK

CLARK COUNTY BENCHMARK STATION 6002 33W4 BEING A 2" BRASS CAP REFERENCE MONUMENT IN TOP OF CURB AT THE NORTHEAST CORNER OF THE INTERSECTION OF NELLIS BOULEVARD AND STEWART AVENUE, NEAR THE P.C. OF NELLIS BOULEVARD.

PUBLISHED ELEV: 533.6817m (NAVD 88)
 PUBLISHED CONVERSION FACTOR: m * 3937/1200 = U.S. SURVEY FEET
 CONVERTED ELEV: 1750.92 U.S. SURVEY FEET

UTILITY NOTE

UTILITY LOCATIONS SHOWN HEREON ARE APPROXIMATE ONLY. IT SHALL BE THE CONTRACTOR'S RESPONSIBILITY TO DETERMINE THE EXACT HORIZONTAL AND VERTICAL LOCATION OF ALL EXISTING UNDERGROUND UTILITIES PRIOR TO COMMENCING CONSTRUCTION. NO REPRESENTATION IS MADE THAT ALL EXISTING UTILITIES ARE SHOWN HEREON. THE ENGINEER ASSUMES NO RESPONSIBILITY FOR UTILITIES NOT SHOWN OR UTILITIES NOT SHOWN IN THEIR PROPER LOCATION.

Call before you Dig
1-800-227-2600

Call before you UnderGround
1-702-455-7811

PROFESSIONAL ENGINEER STATE OF NEVADA
ROBERT GELU
EPE 6-30-09
CIVIL
No. 17741

SUMMIT ENGINEERING CORPORATION
381 PILOT ROAD, SUITE A LAS VEGAS, NV 89109
PHONE (702) 252-3828 FAX (702) 252-3307

DESIGNED BY: ACADRH4
 DRAWN BY: ACADRH4
 CHECKED BY:
 DATE: Copyright SUMMIT ENG 2008

NEVADA
 CLARK COUNTY
 LAS VEGAS

CIVIL IMPROVEMENT PLANS FOR STEWART AND NELLIS GRADING PLAN

REV. DATE DESCRIPTION BY APPD
 5/09/08 ADD TRASH BIN, UPDATE QUANTITIES

SCALE: HORIZ: 1"=20' VERT: N/A
 SHEET: C9 OF 26
 JOB NO: U730983
 INVDWG: U730983-PLN-6002-33W4-GRADING 1627 AM * 29-APR-2008

REPLLOT CLY DWG NO. 10744960