

LEGEND

1	INSTALL B-36 PULL BOX (24"x36"x24")
2	EXISTING B-36 PULL BOX (24"x36"x24")
3	INSTALL B-50 PULL BOX (13"x24"x24")
4	EXISTING B-50 PULL BOX (13"x24"x24")
5	INSTALL B-100 PULL BOX (24"x36"x24")
6	EXISTING B-100 PULL BOX (24"x36"x24")
7	INSTALL T-200 CATV VAULT (30"x48"x36")
8	EXISTING T-200 CATV VAULT (30"x48"x36")
9	INSTALL T-400 CATV VAULT (36"x60"x36")
10	EXISTING T-400 CATV VAULT (36"x60"x36")
11	INSTALL T-600 CATV VAULT (48"x72"x36")
12	EXISTING T-600 CATV VAULT (48"x72"x36")
13	INSTALL NEW CATV PEDESTAL
14	EXISTING NEW CATV PEDESTAL
15	R&R S/W SLAB(S)
16	POTHOLE
17	--- S/WALK/DIRT TRENCH INSTALL
18	--- ASPHALT/STREET TRENCH INSTALL
19	--- PROPOSED BORE
20	--- EXISTING CATV CONDUIT(S)
21	--- OHC PROPOSED OVERHEAD FIBER OPTIC CABLE OR COAX INSTALL
22	--- XHC EXISTING OVERHEAD FIBER OPTIC CABLE OR COAX
23	--- U.G. FIBER/COAX PULL
24	--- RIGHT OF WAY LINE
25	--- LOT/PROPERTY LINE
26	--- EDGE OF PAVEMENT
27	P EXISTING NVE PULL BOX
28	T EXISTING TELCO PULL BOX
29	TM EXISTING TELCO MANHOLE
30	T EXISTING TELCO POLE
31	EXISTING NVE POLE
32	NVE EXISTING NVE TRANSMISSION POLE
33	EXISTING JOINT POLE
34	EXISTING JOINT POLE WITH TRANSFORMER
35	POLE ANCHOR
36	EXISTING NVE TRANSFORMER TRANSFORMER PAD
37	TS SNWA TEST STATION
38	COX POWER SUPPLY (49"x24"x52")
39	RC INSTALL RHINO CABINET
40	RISER POLE/QUADRANT DETAIL RISER OWNERSHIP NOTED
41	RAILROAD
42	MH EXISTING MANHOLE (SS),(SD)...ETC
43	--- 1in CONDUIT LATERAL
44	
45	

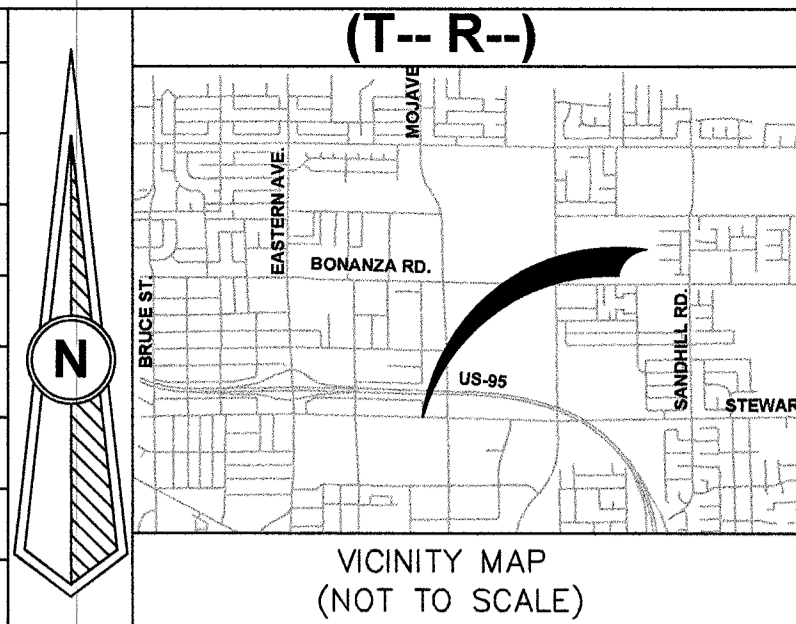

REVISIONS

REV	DESCRIPTION	DATE	BY
△			

TOTAL FOOTAGE FOR COAX OVERLASH: 393'

ALL CONSTRUCTION AND MATERIALS SHALL BE IN ACCORDANCE WITH THE "UNIFORM STANDARD SPECIFICATIONS FOR PUBLIC WORKS CONSTRUCTION OFF-SITE IMPROVEMENTS, CLARK COUNTY AREA NEVADA" LATEST ISSUE; THE "UNIFORM STANDARD DRAWINGS FOR PUBLIC WORKS CONSTRUCTION, CLARK COUNTY AREA NEVADA" LATEST ISSUE; AND OTHER APPLICABLE APPROVED STANDARDS ISSUED BY THE CONTROLLING AGENCY; ALL LOCAL CITY CODES AND ORDINANCES APPLICABLE.

APPROVED FOR CONSTRUCTION

THIS APPROVAL IS FOR WORK IN CLV RW OR CLV EASEMENT ONLY. OBTAINING PERMISSION OR EASEMENT FOR WORK SHOWN IN PRIVATE PROPERTY IS THE RESPONSIBILITY OF THE UTILITY.

APPROVAL: [Signature] DATE: 8 25 16

PERMIT #	11818-20
DRAWN BY:	HC
DATE:	08/05/16
SCALE:	1:20
NO.:	
PROJECT #	40520160000063316
TECH #	702-210-7011
APPROVED BY:	BOB MILLER

COX

1700 VEGAS DRIVE
LAS VEGAS, NEVADA 89106
PHONE: (702) 545-1606
FAX: (702) 545-2606

DISCLAIMER NOTE

UTILITY LOCATIONS SHOWN HEREON ARE APPROXIMATE ONLY. IT SHALL BE THE CONTRACTOR'S RESPONSIBILITY TO DETERMINE THE EXACT HORIZONTAL AND VERTICAL LOCATION OF ALL EXISTING UNDERGROUND AND OVERHEAD UTILITIES PRIOR TO COMMENCING CONSTRUCTION. NO REPRESENTATION IS MADE THAT ALL EXISTING UTILITIES ARE SHOWN HEREON. THE ENGINEER ASSUMES NO RESPONSIBILITY FOR UTILITIES NOT SHOWN OR UTILITIES NOT SHOWN IN THEIR PROPER LOCATIONS.

AVOID CUTTING UNDERGROUND UTILITIES. IT'S COSTLY.
CALL 811 BEFORE YOU DIG
OR 1-800-227-2600
UNDERGROUND SERVICE (USA)

AVOID OVERHEAD POWER LINE CONTACT
CALL BEFORE YOU OVERHEAD
1-702-227-2929
NEVADA POWER ENVIRONMENT AND SAFETY SERVICE DEPARTMENT

AVOID HITTING UNDERGROUND STREET LIGHTS. IT'S COSTLY.
CALL BEFORE YOU DO UNDERGROUND.
BEFORE YOU UNDERGROUND
1-702-465-8000
CLARK COUNTY TRAFFIC OPERATIONS AND
1-702-452-4300
LAS VEGAS AREA COMPUTERIZED SYSTEM

TOTAL BORE	---
TOTAL DIRT TRENCH	---
TOTAL ASPHALT TRENCH	---
TOTAL TRENCH	---
SIDEWALK REMOVAL/REPAIR	---
TOTAL S/W PANELS	---
TOTAL LINEAR FOOTAGE	---

CITY OF LAS VEGAS

333 N. RANCHO DRIVE
LAS VEGAS, NEVADA 89106
(702) 229-6885

CITY/ENTITY: CITY OF LAS VEGAS

PROJECT LOCATION: STEWART & 30TH

SUB-CONTRACTOR: CLOVER CABLE

3040 MARCO STREET LAS VEGAS, NV 89115

ENTITY NOTES:

SHEET No: **1**

SHEET 1 OF 1