

OWNER/DEVELOPER

APN: 139-35-301-007
 ARCHDIOCESE OF LAS VEGAS
 336 CATHEDRAL WAY
 LAS VEGAS, NEVADA 89109
 CONTACT: BROTHER DODD
 PHONE: 702-735-7865

PROJECT INFORMATION

APN: 139-35-301-007
 SITE ADDRESS: 203 N 15TH ST
 ACREAGE: NET 2.92 ACRES
 GROSS 2.92
 ZONING: CVMC DISTRICT (C-V)
 BUILDING INFORMATION:
 HEIGHT: 36'
 FLOORS: 2
 TYPE: IIB
 TOTAL SQUARE FEET: 17,900

LEGEND

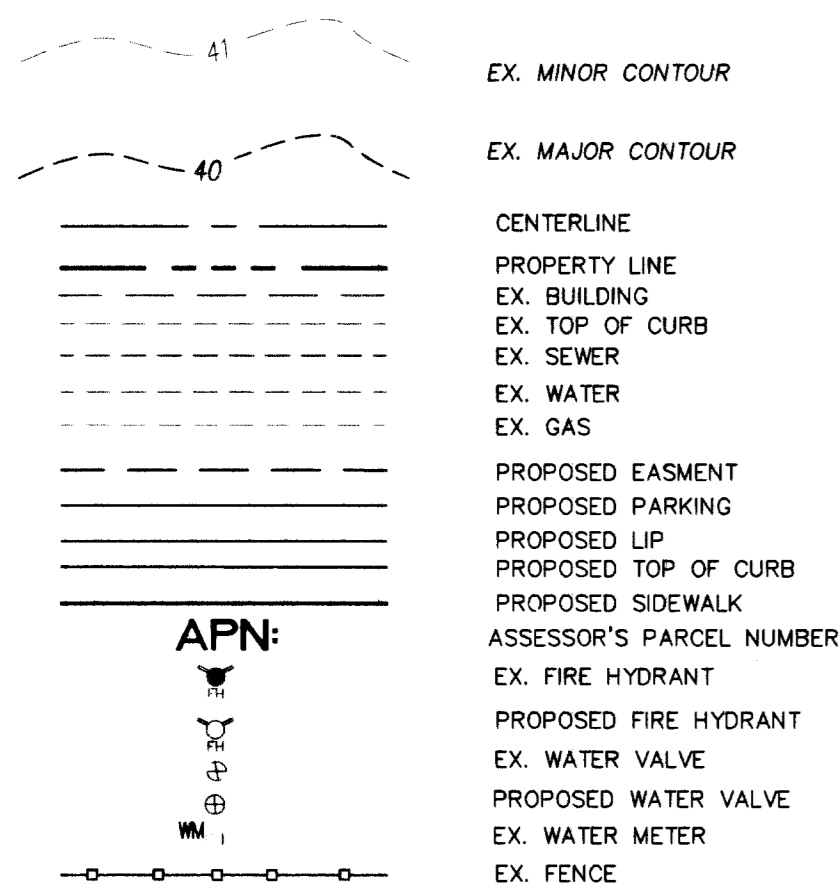

APN:

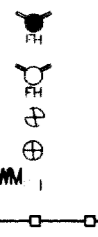

ABBREVIATIONS

| | |
|--------|--|
| AVE | AVENUE |
| BC | BACK OF CURB |
| FC | FACE OF CURB |
| TC | TOP OF CURB |
| FG | FINISHED GROUND |
| FL | FLOW LINE |
| FS | FINISHED SURFACE |
| CG | CURB AND GUTTER |
| FF | FINISH FLOOR ELEVATION |
| AC | ASPHALTIC CONCRETE |
| TSW | TOP OF SIDE WALK |
| FH | FIRE HYDRANT |
| EP | EDGE OF PAVEMENT |
| ECR | END OF CURB RETURN |
| ROW | RIGHT-OF-WAY |
| ST | STREET |
| STA. | STATION |
| NDOT | NEVADA DEPARTMENT OF TRANSPORTATION |
| CCASD | CLARK COUNTY AREA STANDARD DRAWING |
| UDACS | "UNIFORM DESIGN AND CONSTRUCTION STANDARDS FOR WATER DISTRIBUTION SYSTEMS" |
| DCSWCS | "DESIGN AND CONSTRUCTION STANDARDS FOR WASTEWATER COLLECTION SYSTEMS" |

DEVIATIONS FROM STANDARDS

NONE

IMPROVEMENT PLANS FOR ST. BRIDGET'S CHURCH @ STEWART AND 15TH STREET

APN: 139-35-301-007

OWNER/DEVELOPER ~ ROMAN CATHOLIC CHURCH LAS VEGAS

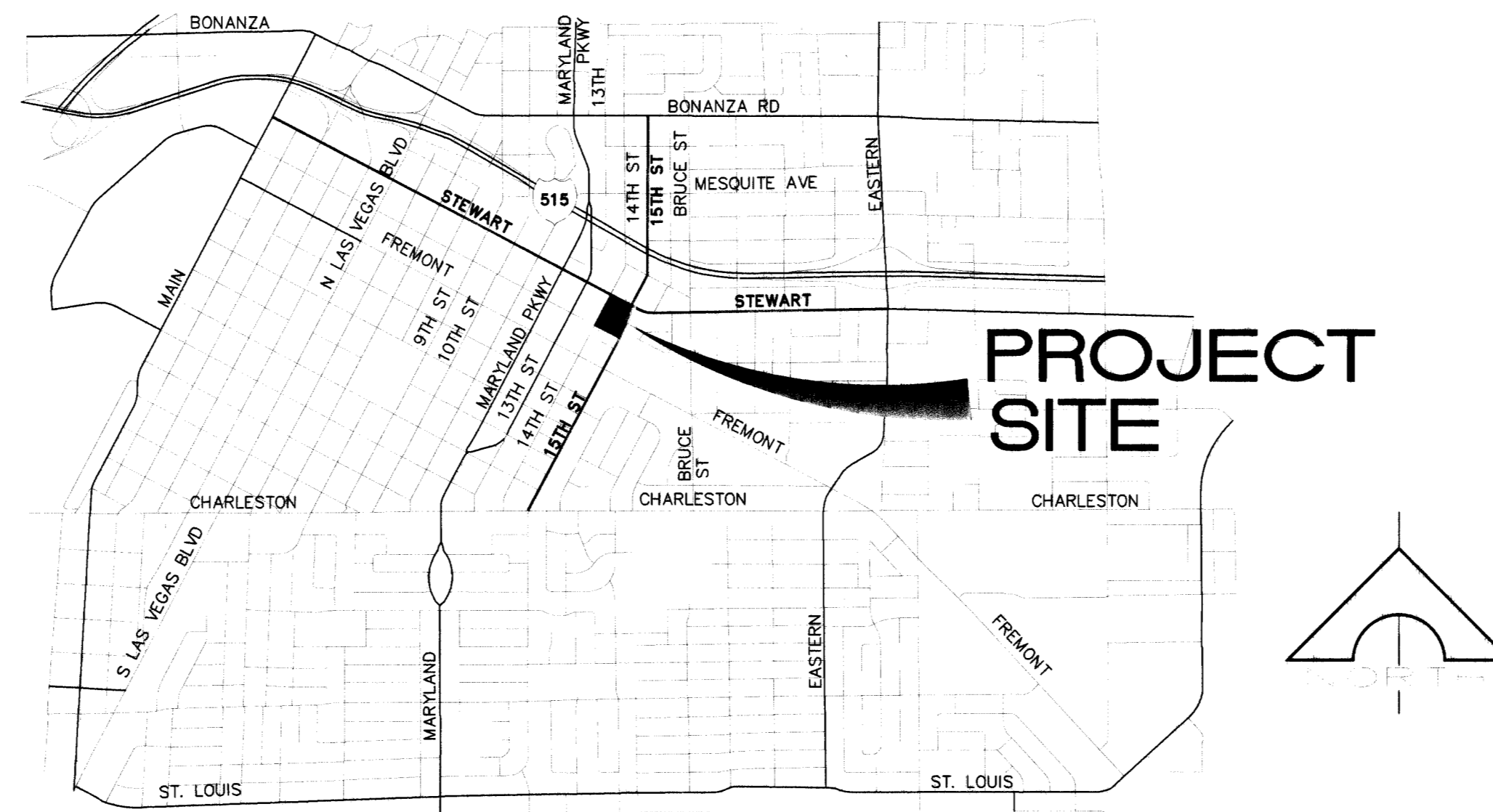

VICINITY MAP
 N.T.S.

OWNER/DEVELOPER

APN: 139-35-301-007
 ARCH DIOSES OF LAS VEGAS
 336 CATHEDRAL WAY
 LAS VEGAS, NEVADA 89109
 CONTACT: MARY ALDRICH
 PHONE: (702) 735-7865

BENCHMARK

CITY OF LAS VEGAS BENCHMARK NO STEWART 35 12 BEING A RIVET AND PLATEIN TOP OF CURB @ SE CORNER OF STEWART AND MARYLAND PARKWAY. ELEVATION = 603.4244 METERS (1979.73 FEET) NAVD88.

BASIS OF BEARING

THE CENTERLINE OF STEWART AVENUE BETWEEN THIRTEENTH STREET AND FOURTEENTH STREET BEARS SOUTH 62°05'37" EAST PER RECORD OF SURVEY: FILE 67, PAGE 79, OFFICIAL RECORDS OF CLARK COUNTY, NEVADA.

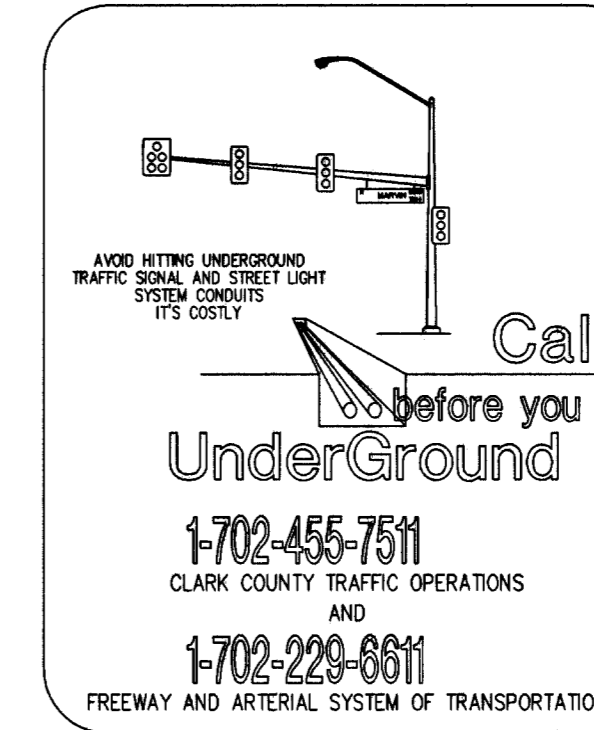

AVOID CUTTING UNDERGROUND UTILITY LINES. IT'S COSTLY!
 CALL BEFORE YOU DIG
 1-800-227-2600
 UNDERGROUND SERVICE ALERT (USA)

AVOID OVERHEAD POWERLINE CONTACT
 CALL BEFORE YOU OVERHEAD
 1-702-227-2929
 NEVADA POWER ENVIRONMENT AND SAFETY SERVICES DEPARTMENT

SHEET INDEX

| | | |
|---|--------|-----------------------------|
| 1 | CV-1 | COVER SHEET |
| 2 | NT-1 | NOTE SHEET |
| 3 | GP-1 | GRADING PLAN |
| 4 | HC-1 | HORIZONTAL CONTROL |
| 5 | UT-1 | UTILITY PLAN |
| 6 | DT-1 | DETAIL SHEET |
| 7 | PPI-1 | PROFILE |
| 8 | TR/STL | TRAFFIC / STREET LIGHT PLAN |

APPROVALS

Jorge Cervantes
 JORGE CERVANTES PE #13977 PTOE
 LAS VEGAS CITY ENGINEER
 10-20-06 DATE

APPROVAL OF THESE PLANS IS LIMITED TO THOSE IMPROVEMENTS CONSTRUCTED IN THE DEDICATED RIGHTS-OF-WAY AND/OR DEDICATED EASEMENTS. THIS APPROVAL DOES NOT AUTHORIZE THE CONSTRUCTION OF ANY IMPROVEMENTS THAT DEVIATE FROM ADOPTED STANDARDS AND/OR SPECIFICATIONS EXCEPT THOSE SPECIFICALLY LISTED UNDER "DEVIATIONS FROM STANDARDS." THE ENGINEER SHALL RESOLVE ANY DEVIATION OTHER THAN THOSE LISTED IN "DEVIATIONS FROM STANDARDS" IN FAVOR OF THE UNIFORM STANDARDS DRAWINGS AND SPECIFICATION CLARK COUNTY AREA NEVADA.

Arnell
 CITY OF LAS VEGAS FIRE MARSHAL
 9/20/06 DATE

APPROVAL BY THE FIRE DEPARTMENT HAVING JURISDICTION IS REQUIRED PRIOR TO OBTAINING FINAL APPROVAL FROM THE LVVWD.

Wendy Bateman
 NEVADA POWER COMPANY
 9/17/06 DATE

NEVADA POWER COMPANY ACKNOWLEDGES THAT WE HAVE RECEIVED YOUR PLANS AND WILL PROVIDE SERVICE TO ALL ELECTRICAL NEEDS ASSOCIATED WITH THIS PROJECT. NEVADA POWER COMPANY RESERVES THE RIGHT TO ADDRESS ANY EXISTING OR FUTURE CONFLICTS ONCE THE FINAL DESIGN IS COMPLETED. THE NEW SERVICE AND THE RESOLUTION OF ANY CONFLICTS WILL BE ACCOMPLISHED PURSUANT TO THE NEVADA PUBLIC UTILITY COMMISSION'S RULES AND REGULATIONS.

Kendal A. Clavel
 SOUTHWEST GAS
 9/17/06 DATE

Penley Miller
 COX COMMUNICATIONS LAS VEGAS, INC. Penley Miller
 9/16/06 DATE

Embarq
 EMBARQ
 9.8.06 DATE

THE AFFIXED EMBARQ NEVADA APPROVAL DOES NOT ASSUME OR GUARANTEE LIABILITY FOR KNOWN OR UNKNOWN CONFLICTS WITH EXISTING OR PROPOSED IMPROVEMENTS. RESOLUTION OF ANY CONFLICT WILL BE ACCOMPLISHED PURSUANT TO LOCAL ORDINANCES, NEVADA REVISED STATUTES AND/OR PUBLIC UTILITY COMMISSION RULES AND REGULATIONS.

PROJECT NAME: ST. BRIDGET'S CHURCH

This project water plan complies with the Las Vegas Valley Water District's technical requirements. However, this water plan is

NOT APPROVED FOR CONSTRUCTION

at this time and this signature does not provide or imply a water commitment.

M. Margó Wheeler
 LVVWD SHEET: CV, NT, UT, PPI
 ESN 052
 PROJECT # 112605
 9/16/06 DATE
 REVISED 06/01/04

M. Margó Wheeler
 LAS VEGAS VALLEY WATER DISTRICT
 PROJECT #112605 SHEETS (CV1, NT1, UT1, PPI1)
 11/02/07 DATE

M. Margó Wheeler
 M. MARGO WHEELER, AICP
 DIRECTOR OF PLANNING AND DEVELOPMENT
 THIS PLAN MEETS THE APPLICABLE STANDARDS OF THE PLANNING AND DEVELOPMENT DEPARTMENT
 10/12/06 DATE

| REV. NO. | DATE | DESCRIPTION | SHT. NO. |
|----------|------|-------------|----------|
| 1 | | | |
| 2 | | | |
| 3 | | | |
| 4 | | | |
| 5 | | | |
| 6 | | | |
| 7 | | | |
| 8 | | | |

JPL ENGINEERING INC.

8620 SOUTH EASTERN AVE, SUITE 8
 LAS VEGAS, NV 89123

Phone (702) 898-6269 • Fax (702) 896-0647

ST. BRIDGET'S CHURCH

COVER SHEET

SEPTEMBER 2006

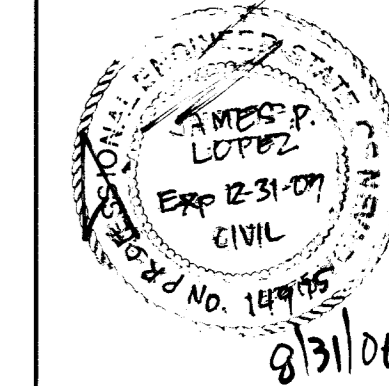

JOB # 05-088

SHEET NO.:

CV

1 OF 8 SHEETS

CLV DWG NO 10714732