

MATCH LINE - SEE SHEET C2.04

PROJECT SITE
A PORTION OF APN: 125-21-102-001

MIDDLE SCHOOL

ELEMENTARY SCHOOL

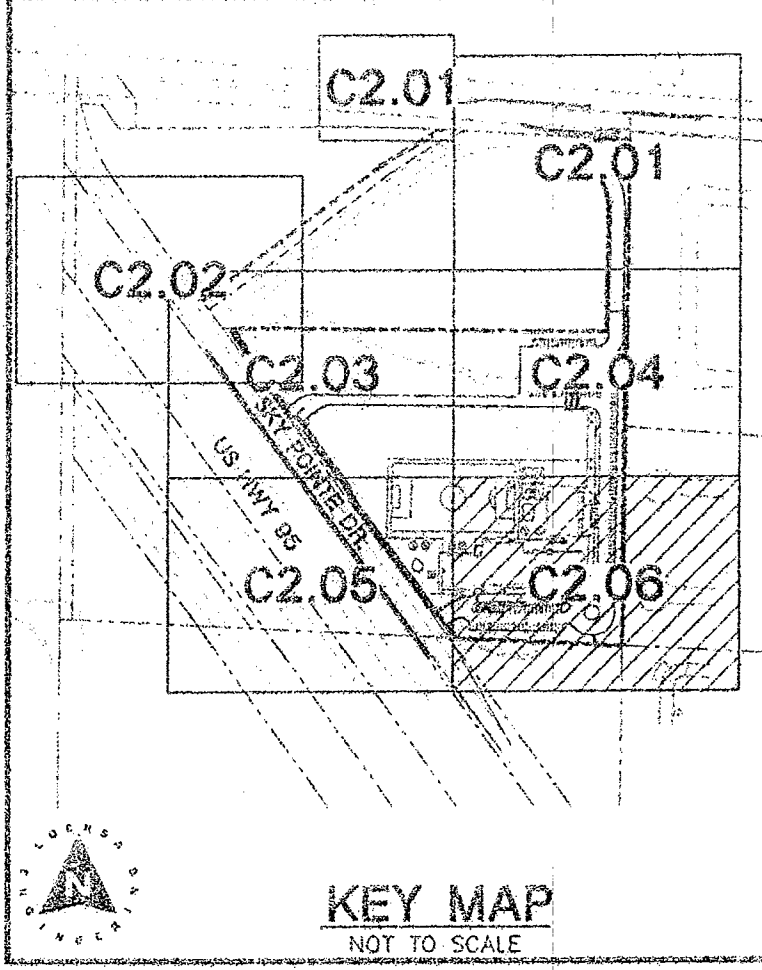
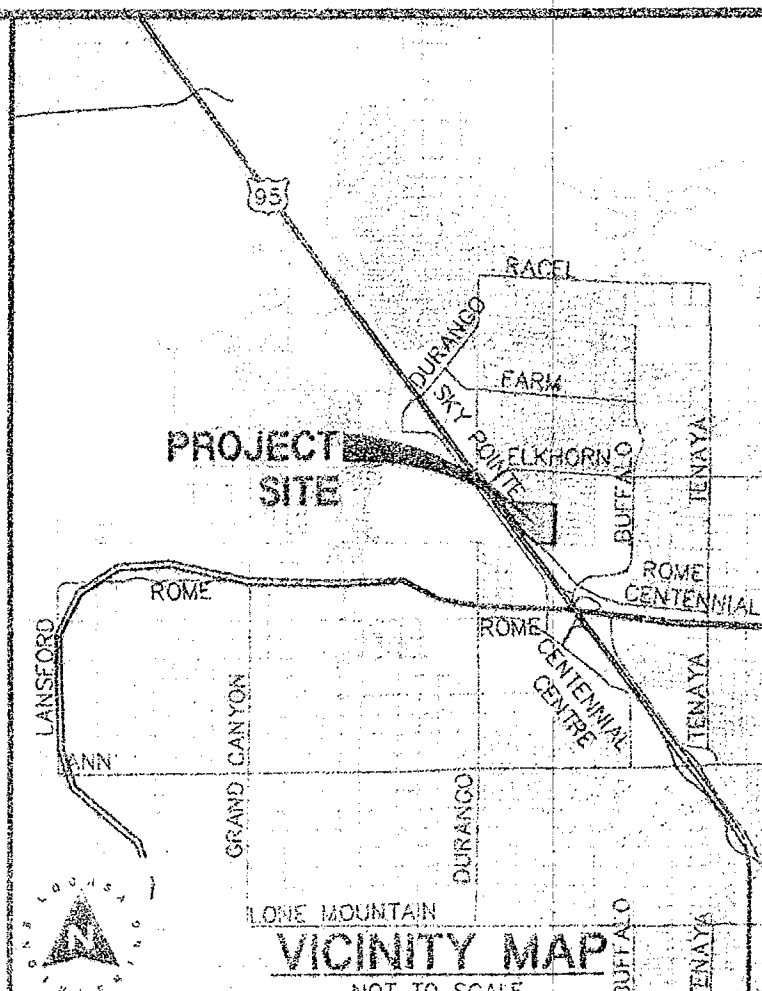
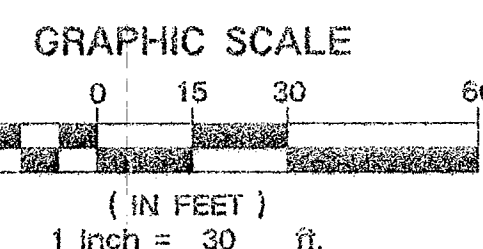
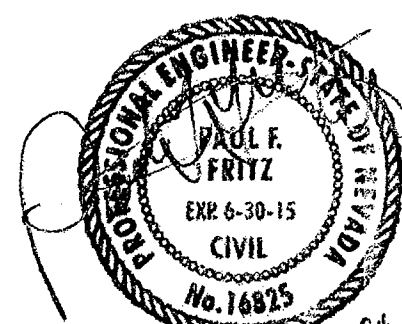

TRAFFIC NOTES:

- 1. INSTALL 36" R1-1 STOP SIGN.
2. INSTALL 6M-3R SIGN (12"x36") AT 35' O.C.
3. INSTALL 4" WHITE PAINTED EDGE LINE.
4. INSTALL 6" WHITE PAINTED EDGE LINE.
5. INSTALL WHITE TYPE I FILM PAVEMENT MARKING.
6. INSTALL 8" RIGHT TURN LANE (RPM) PER CCAUSD 245.
7. INSTALL TYPE II CENTERLINE (RPM) PER CCAUSD 244.
8. INSTALL TYPE IV LANE LINE (RPM) PER CCAUSD 244.1.
9. INSTALL TYPE I CENTERLINE (RPM) PER CCAUSD 244.
10. INSTALL YELLOW TYPE I FILM 24" WIDE CHEVRONS PER CCAUSD 245.
11. INSTALL W3-1 SIGN (36"x36"). RIGHT LANE ENDS SIGN CONDUCTOR.
12. INSTALL 2" PVC CONDUIT W/ 2 (#4) AND 1 (#8) CONDUCTOR.
13. INSTALL 4" PVC CONDUIT W/ FIBER OPTIC CABLE PER CCAUSD 680.
14. INSTALL NO. 3-1/2 PULLBOX PER CCAUSD 705.
15. INSTALL P-30 PULLBOX PER CCAUSD 761.
16. INSTALL STREETLIGHT STANDARD PER TOWN SQUARE DESIGN MANUAL FIGURE 15 WITH STREETLIGHT BASE PER DETAIL 8 ON C6.02.
17. INSTALL R3-3 SIGN (30"x30"). NO PARKING SIGN.
18. INSTALL R3-7R SIGN (36"x36"). RIGHT LANE MUST TURN RIGHT SIGN.
19. INSTALL 200 AMP SERVICE PEDESTAL SERVICE W/ (3) #1/0 THW CONDUCTORS PER CCAUSD 331, 332, AND 335.
20. OBLITERATE EXISTING STRIPING.
21. RELOCATE EXISTING R4-8 SIGN WITH EXISTING OMI-1 OBJECT MARKER.
22. INSTALL LEFT TURN LANE LINE (RPM) PER C.C.A.U.S.D. 246.
23. INSTALL 6" WHITE PAINTED BIKE LANE LINE.
24. INSTALL WHITE PAINTED 6"x2' SKIP LANE PATTERN PER C.C.A.U.S.D. 246.1.
25. INSTALL R4-4 (36"x30") SIGN.
26. INSTALL R3-17 (24"x18") SIGN PER C.C.A.U.S.D. 246.1.
27. INTERCEPT EX. CONDUIT. INSTALL NO. 3 PULLBOX PER C.C.A.U.S.D. 705. REPEL CONDUCTORS.
28. INSTALL 2" STREETLIGHT CONDUIT WITH (2) #4 AND (1) #8 CONDUCTOR.
29. RELOCATE EX. STREETLIGHT AND INSTALL NEW FOUNDATION. CHIP EX. FOUNDATION 24" BELOW GRADE.
30. INSTALL (2) 250W LUMINAIRES ON STREETLIGHT POLE PER TOWN CENTER DESIGN MANUAL FIGURE 15 WITH STREETLIGHT FOUNDATION PER TOWN CENTER DESIGN MANUAL.
31. INSTALL YELLOW MEDIAN NOSE MARKINGS PER C.C.A.U.S.D. 248.
32. INSTALL PRECAST BUMPER BLOCKS 2' FROM CURB FACE PER DETAIL 5/6.01 (TYP.).
33. INSTALL 9' x 18' PARKING WITH 4" WHITE PAINTED LINES. (TYPICAL)
34. INSTALL BLUE AND WHITE PAINTED HANDICAP PAVEMENT MARKINGS PER DETAIL 8/C6.02.
35. INSTALL 4" WHITE PAINTED HATCH LINES 3' O.C. @ 45°.
36. INSTALL R7-8 "MINIMUM \$250 FINE FOR USE BY OTHERS" NRS 484.408 SIGN (12" x 18") PER DETAIL 2/C6.02.
37. INSTALL R7-9 "MINIMUM \$250 FINE FOR USE BY OTHERS" NRS 484.408 SIGN "VAN ACCESSIBLE" (12" x 18") PER DETAIL 2/6.02.
38. INSTALL BIKE LANE DELINEATION PER CCAUSD 244.9.

HORIZONTAL CONTROL NOTE:

ALL DIMENSIONS SHOWN ARE TO BACK OF CURB UNLESS NOTED OTHERWISE ON PLANS

SIGHT VISIBILITY ZONE

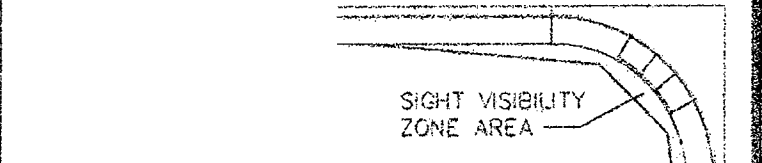

NOTE: NO STRUCTURE, VEGETATION, OR OBJECT OF ANY KIND IS PERMITTED OVER TWENTY-FOUR (24) INCHES IN HEIGHT (MEASURED FROM THE TOP OF THE ADJACENT CURB IF CURB EXISTS) WITHIN THE SIGHT VISIBILITY ZONES.

CITY OF LAS VEGAS FIRE DEPARTMENT APPROVAL

APPROVAL OF THESE PLANS SHALL NOT BE CONSTRUED TO BE A PERMIT FOR, OR AN APPROVAL OF, ANY VIOLATION OF ANY OF THE PROVISIONS OF THE STATE OR COUNTY LAWS. FIRE FLOW 2875 GPM AT 20 P.S.I. RESIDUAL.

FIRE ACCESS NOTES/ LEGEND:

- 1. INSTALL FIRE LANE SIGN AT A MAXIMUM DISTANCE OF EVERY 100' ALONG THE FIRE LANE PER FIRE LANE DETAIL ON THIS SHEET.
2. INSTALL FIRE LANE ENTRANCE WARNING SIGN PER DETAIL ON THIS SHEET.
3. PAINTED CURB OR PAVEMENT.
4. FIRE TRUCK ACCESSIBLE ROUTE.

NEVADA DEPARTMENT OF TRANSPORTATION (NDOT) PERMIT REQUIRED:

AN APPROVED NDOT OCCUPANCY PERMIT SHALL BE OBTAINED THROUGH THE DISTRICT OFFICE TO ANY CONSTRUCTION WITHIN THE NDOT RIGHT OF WAY. PLANS SHOWING WORK IN NDOT RIGHT OF WAY MUST SHOW NDOT STATIONING. THE DEVELOPER ASSUMES ALL LIABILITY FOR WORK CONDUCTED UNDER THE DISTRICT OBTAINED PERMIT THROUGH WARRANTY EXPIRATION.

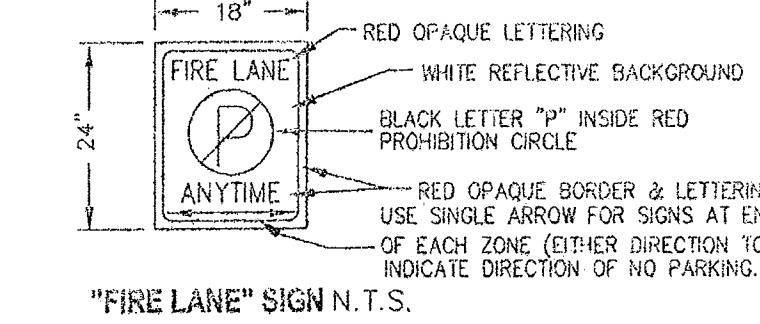

- NOTE: ITEMIZED LIST
SCHOOL FLASHER ASSEMBLY AND FACILITIES FOR A SOLAR POWERED FLASHER/JUSTED BELOW WILL BE PROVIDED TO THE CLV MAINTENANCE YARD FOR FABRICATION, ASSEMBLY AND INSTALLATION BY CLV PERSONNEL, PER CLV TRAFFIC DIVISION DIRECTION.
1. TWO (2) SCHOOL FLASHER SYSTEMS-CLV PART No. SZFLVN.
2. TWO (2) SCHOOL FLASHER RADIO CONTROLLED CLOCK TIMERS - CLV PART No. 503645LV.
3. TWO (2) BATTERY CABINETS EA. WITH A 10 AMP SOLAR REGULATOR.
4. TWO (2) RIGID BATTERY GROUP 27 BATTERIES.
5. TWO (2) DCF AT 12VDC 2-CIRCUIT FLASHER.
6. TWO (2) CIRCUIT BOARD FLASHER INTERFACE WITH SWITCH WITH PANEL AND REGULATOR WIRED.
7. TWO (2) 125 WATT SOLAR PANEL WITH TOP OF POLE MOUNTING.
8. TWO (2) 10dB YAGI ANTENNA WITH MOUNTING BRACKET WITH 60' LEAD.
9. FOUR (4) 12" AMBER 12 VDC LED'S.
10. TWO (2) 8" AMBER 12 VDC LED'S.

FLASHER NOTE:
1. INSTALL TYPE "L" FOUNDATION PER USDOCA STD. DWG. NO. 722 WITH BOLT PATTERN FOR A NEW "XXA-30"-0" SCHOOL FLASHER POLE, INCLUDING MAST ARM, L=35" PER STD. DWG. NO. 746. SEE NOTE "ITEMIZED LIST" HEREON FOR ADDITIONAL FLASHER INFORMATION.

MATCH LINE - SEE SHEET C2.05

APN: 125-21-202-001 NOT A PART

Legend table with columns for CL or SURVEY LINE, EASEMENT LINE, SAWCUT LINE, SCARP LINE, DESCRIPTION, EXISTING, PROPOSED, CONTOUR LINES, EDGE OF PAVEMENT, 'A' TYPE CURBS, 'L' TYPE CURBS, WALLS, FENCES, AC PAVEMENT, CONCRETE, SPOT ELEVATIONS, SIGNS, MANHOLE W/ DESCRIPTION, MANHOLE DESCRIPTIONS, FIRE HYDRANTS, FIRE VALVES, REDUCERS, CLEAN OUTS, UTILITY BOX OR VAULT, BACKWATER VALVES, 150W HPS STREET LIGHTS, 200W HPS STREET LIGHTS, 250W HPS STREET LIGHTS.

HORIZONTAL CONTROL & TRAFFIC & LIGHTING PLAN SHEET 6 OF 6

SOMERSET ACADEMY SKY POINTE & ELKHORN LAS VEGAS, NV

03-25-14

257 7476

Praveer Gecelic

ASBULLT

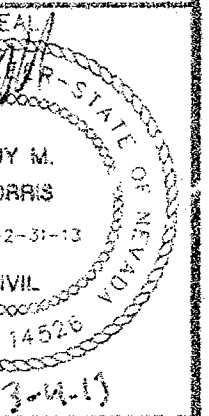

C2.06 SHEET 8 OF 27