

BASIS OF BEARING

N0°21'06"E - BEING THE WEST LINE OF THE SOUTHWEST QUARTER (SW 1/4) OF SECTION 33, TOWNSHIP 20, RANGE 62 EAST, M.D.M. AS SHOWN ON FILE 62 OF SURVEYS, PAGE 40, OF OFFICIAL RECORDS. CLARK COUNTY, NEVADA.

BENCHMARK

CITY OF LAS VEGAS BENCHMARK BOOK, PAGE 20-62-SWC BENCHMARK # 40.

6C0233W4 - BEING A 2" DOMED BRASS CAP IN TOP OF CURB, NE RETURN, NELLIS BLVD. AND STEWART AVE.

NAVD88 ELEVATION:
533.6904 METERS
1750.95 U.S. SURVEY FEET

SEE SHEET NO. 15
MATCHLINE, STA. 130+00.00

SEE SHEET NO. 15
MATCHLINE, STA. 130+00.00

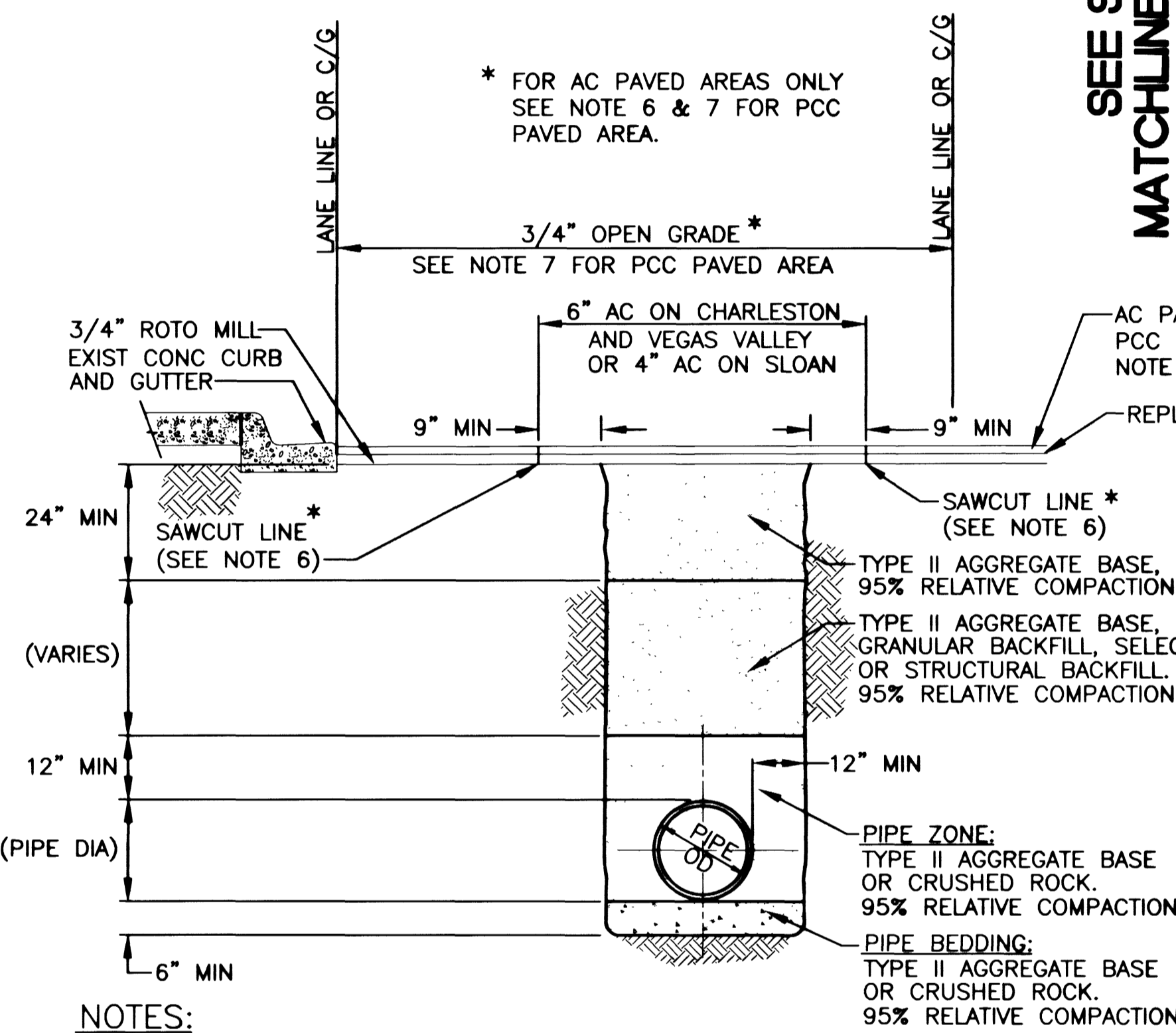

- NOTES:**
1. THE TOP 24" BELOW THE PAVEMENT SHALL BE TYPE II AGGREGATE BASE COMPACTED TO A MINIMUM OF 95% MAXIMUM DENSITY.
 2. NO STONES OR LUMPS GREATER THAN 3" PERMITTED IN TRENCH BACKFILL.
 3. MECHANICAL COMPACTION ONLY; NO JETTING OR FLOODING ALLOWED.
 4. TRENCH EXCAVATION SHALL COMPLY WITH THE CURRENT REGULATIONS AS DETERMINED BY THE NEVADA OCCUPATIONAL SAFETY AND HEALTH ADMINISTRATION.
 5. PCC PAVEMENT FROM STA. 10+00 TO 12+00, AC PAVEMENT FROM 12+00 TO 44+50
 6. THE SAWCUT LINE SHALL MOVE TO NEAREST PANEL JOINT ON PCC PAVED AREA.
 7. SEE USD STD DWG NO. 230 FOR PCC PAVEMENT CONCRETE THICKNESS SHALL BE 10" MINIMUM.

STANDARD TRENCH BACKFILL DETAIL (A)
NOT TO SCALE SHEETS 5,6,7,8,9,10,11,12,13,14,15,16

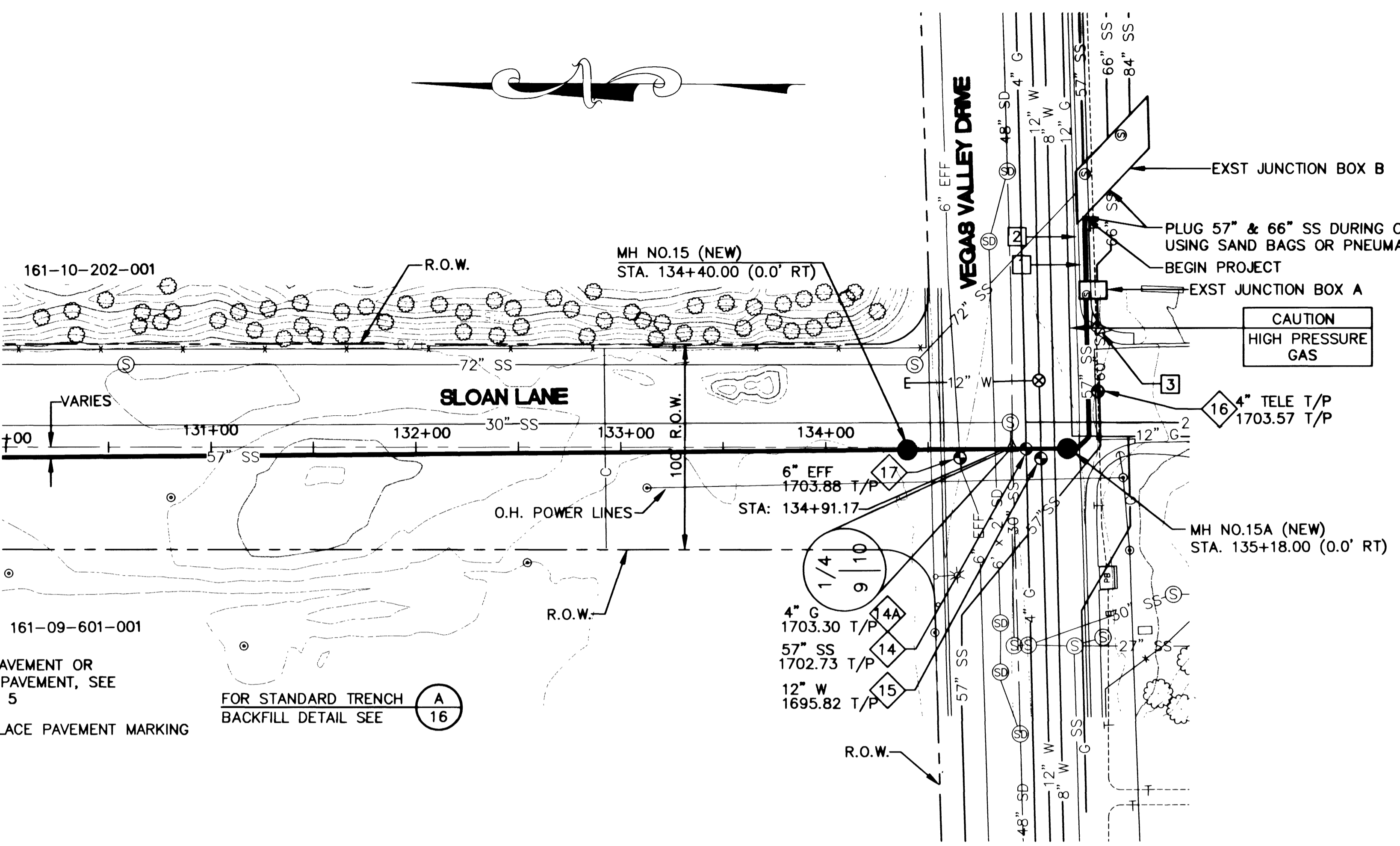

- 1 REPLACE SIDEWALK PER CCPW STD. DWG. No. 234, REMOVE AND REPLACE ALTERNATIVE.
- 2 REPLACE C & G PER CCA STD. DWG. No. 216, REMOVE AND REPLACE ALTERNATIVE.
- 3 REPLACE WHEELCHAIR RAMP PER CCA STD. DWG NO. 235, REMOVE AND REPLACE ALTERNATIVE.

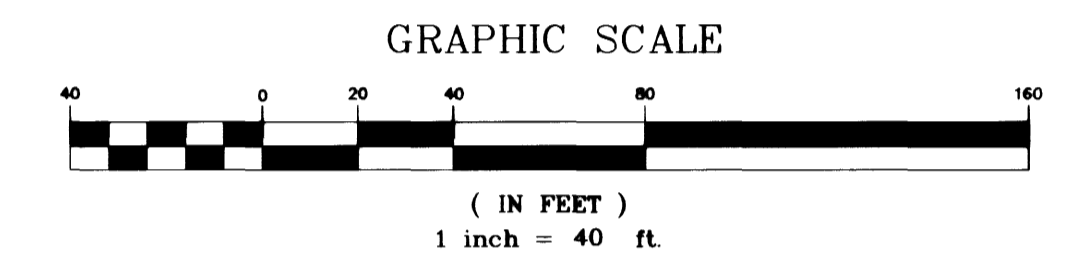

Armin GPH
LAS VEGAS VALLEY WATER DISTRICT
DATE 2-01-08

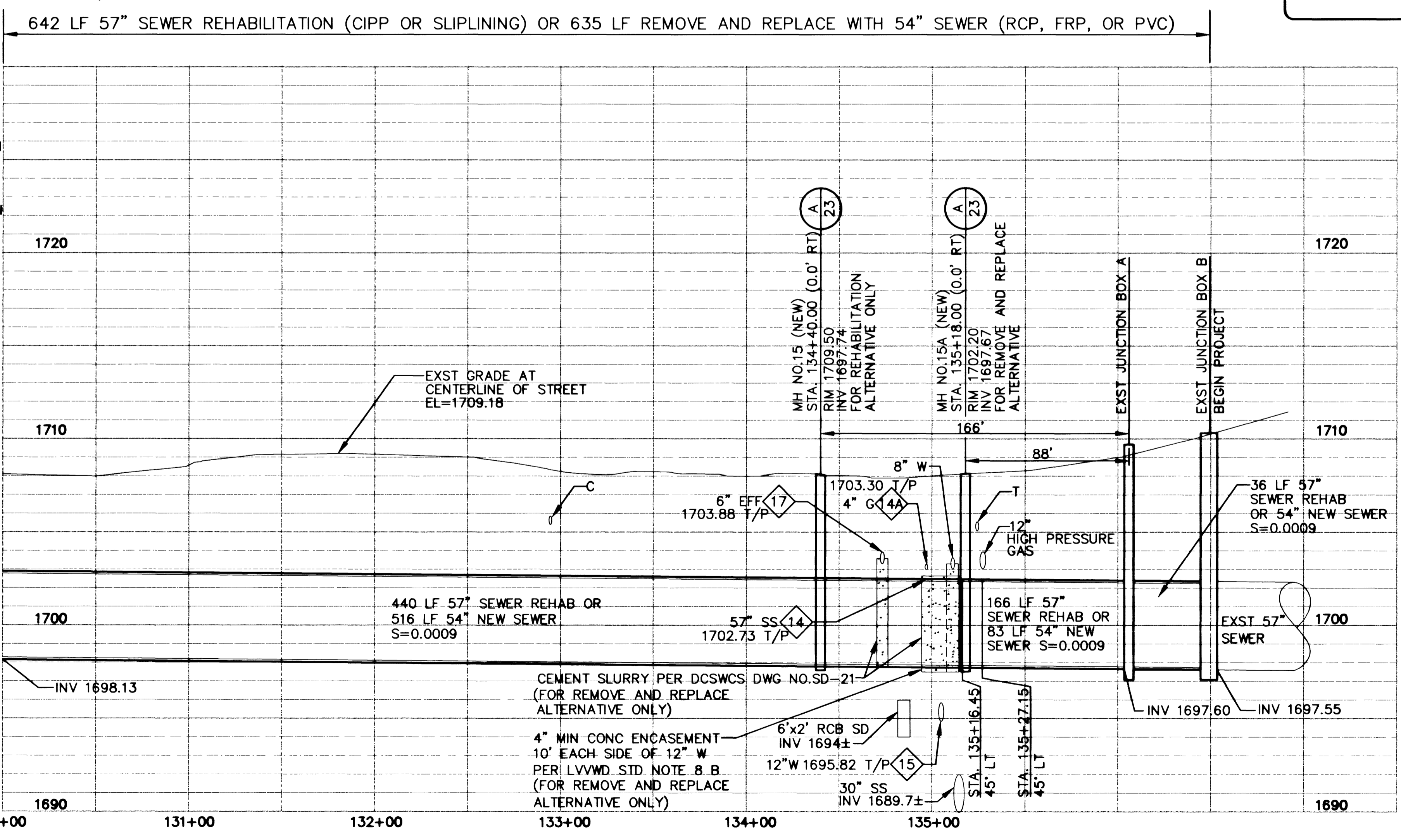

Call before you Dig
1-800-227-2600
NOTICE
UTILITY LOCATIONS SHOWN HEREON ARE APPROXIMATE ONLY. IT SHALL BE THE CONTRACTOR'S RESPONSIBILITY TO DETERMINE THE EXACT VERTICAL AND HORIZONTAL LOCATION OF ALL EXISTING UNDERGROUND UTILITIES PRIOR TO COMMENCING CONSTRUCTION. NO REPRESENTATION IS MADE THAT ALL EXISTING UTILITIES ARE SHOWN HEREON. THE ENGINEER ASSUMES NO RESPONSIBILITY FOR UTILITIES NOT SHOWN OR UTILITIES NOT SHOWN IN THEIR PROPER LOCATION.
CALL BEFORE YOU DIG: 1-800-227-2600

DATE: _____
REVISIONS: _____
DESIGN BY: S. L.
DRAFTED BY: GAA/ROB
SCALE (V) 1"=4'
DATE 01/28/00
SCALE (H) 1"=40'
FLD. BK. # N/A
PROJECT: DEPARTMENT OF PUBLIC WORKS
SLOAN LANE SEWER
PLAN AND PROFILE
BEGINNING OF PROJECT
TO STA. 130+00
SHEET: _____
DRAWING NO. 307-V784 B
16
26

ENGINEERING DESIGN DIVISION
ACTING CITY ENGINEER: JERRY WALKER, P.E.
DESIGN ENGINEER: STANLEY CONSULTANTS, INC.
BD No. 00173026

Stanley Consultants Inc.
1771 EAST FLAMINGO ROAD, SUITE 104-B
LAS VEGAS, NEVADA 89119 (702) 369-9396
A Stanley Group Company
Engineering, Environmental
and Construction Services
Worldwide

26961