

**MATCHLINE - SEE SHEET 3 FOR CONTINUATION**

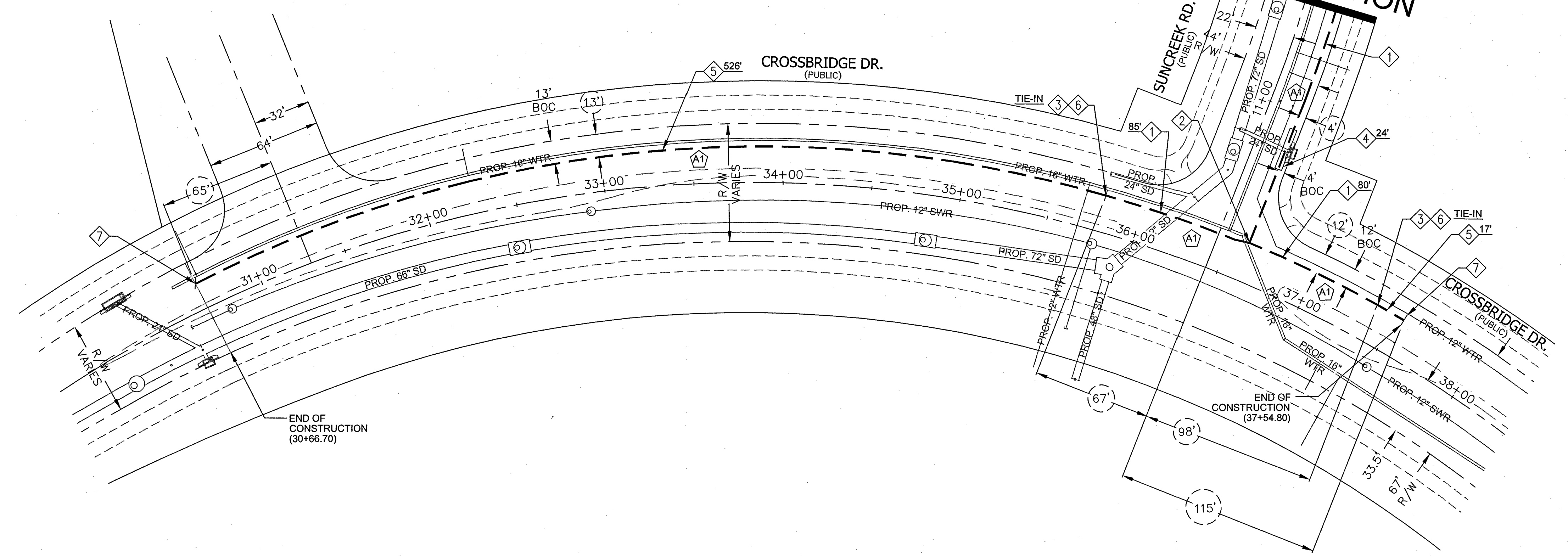

**LEGEND:**

	EXISTING GAS LINE
	GAS LINE TO BE ABANDONED
	EXISTING GAS SERVICE
	PROPOSED MAIN GAS LINE (NEW)
	PROPOSED SERVICE LATERAL (NEW)
	PROPOSED SERVICE LINE (NEW)
	RIGHT OF WAY LINE
	STREET CENTERLINE
	PROPERTY LINE
	BACK OF CURB
	MATCHLINE
	EASEMENT
	EXISTING ANODELESS RISER
	EXISTING ANODE RISER
	EXISTING GAS LIGHT
	EXISTING GAS VALVE
	SAWCUT & PATCH

**RTC NOTES:**  
 PAVEMENT REPAIR SHALL CONFORM TO RTC STANDARD(S):  
 A1 503

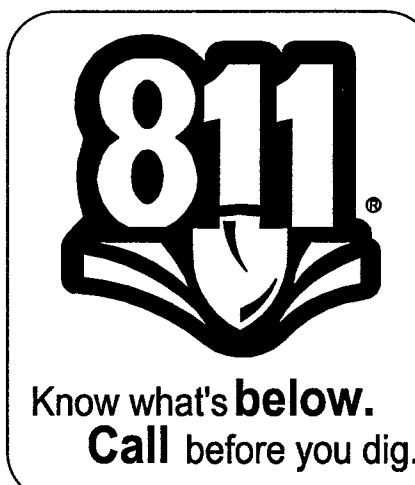

NO.	DESCRIPTION	BY	DATE	APPVD.
REVISIONS				

TAX CODES	UNIT NO.	UNIT TYPE	INSTL. PROPOSED	RETIRED PROPOSED	INSTL. COMPLETED	RETIRED COMPLETED

PROPERTY UNITS

**AS-BUILT DRAWING-PRESSURE TEST DATA**

PIPE DIA.	PIPE LENGTH	PIPE TYPE	MIN. DURATION	TEST PRES. (PSIG)	TIME	DATE	PERFORMED BY

**VISUAL INSPECTION CERTIFICATION**

I HAVE VISUALLY INSPECTED ALL HEATED FUSIONS, SOLVENT CEMENT, MECHANICAL JOINTS, AND WELDS THAT I HAVE PERFORMED.

NAME: \_\_\_\_\_ DATE: \_\_\_\_\_

INSPECTOR: \_\_\_\_\_

FOREMAN: \_\_\_\_\_

REVIEWED BY: \_\_\_\_\_

AS-BUILTS ACCEPTED BY: \_\_\_\_\_ DATE: \_\_\_\_\_

POSTED BY: \_\_\_\_\_ DATE: \_\_\_\_\_

POSTING QCD BY: \_\_\_\_\_ DATE: \_\_\_\_\_

**CONSTRUCTION**

INSPECTOR: \_\_\_\_\_

FOREMAN: \_\_\_\_\_

REVIEWED BY: \_\_\_\_\_

**PERMIT INFORMATION**

CITY OF LAS VEGAS

TAX CODE: 02-0200

**ISOLATION AREA**

323

**W.R. NO.**

2011018 INT.  
3130175 EXT.

**LOCATION**

T20S  
R59E  
SEC 33, 34  
M.D.M.

**ATLAS #/TILE #**

x561y514

**ENGINEER/TECH:** PAMELA KENNEDY  
**ACCOUNT REP:** SHANTE ANDERSON  
**PROJECT CONTACT:** CHRIS ANDERSON

PHONE: 702-365-2065  
 PHONE: 702-528-8596  
 PHONE: \_\_\_\_\_

SHEET NO: 4 OF 4  
 DWN. BY: ZONE ENG  
 CHKD. BY: \_\_\_\_\_

SCALE: 1" = 40'  
 DATE: 2/29/16  
 APPVD. BY: \_\_\_\_\_

**TITLE**

**SUMMERLIN VILLAGE 23A & 24 SKY VISTA IMPROVEMENTS & CROSSBRIDGE INFRASTRUCTURE EXTENSIONS**

H # 57159 1076423 344 57A