

SEE SHEET UT3 FOR CONTINUATION

**DOUBLE CHECK DETECTOR ASSEMBLY (DCDA) (2) 8"**

THE DOUBLE CHECK DETECTOR ASSEMBLIES SHALL BE INSTALLED IN ACCORDANCE WITH THE UDACS PLATE NO. 11C. ANY BLOCK WALL OR OTHER MATERIAL SHALL BE DESIGNED AND CONSTRUCTED AROUND THE OUTSIDE OF THE EASEMENT(S), SO AS TO ALLOW THE DISTRICT DIRECT ACCESS FROM THE ADJACENT RIGHT-OF-WAY. EASEMENTS SHALL BE CLEARLY MARKED OR STAKED PRIOR TO THE START OF CONSTRUCTION.

**DUAL REDUCED PRESSURE PRINCIPLE ASSEMBLY (2) 2"**

APPROVED DUAL REDUCED PRESSURE PRINCIPLE ASSEMBLY(S) SHALL BE INSTALLED PER THE UDACS PLATE NO. 11B. NO WATER SHALL BE TAKEN FROM A SERVICE REQUIRING BACKFLOW PREVENTION UNTIL THE REDUCED PRESSURE PRINCIPLE ASSEMBLY HAS BEEN SUCCESSFULLY TESTED BY THE LVVWD. ANY BLOCK WALL OR OTHER FENCE MATERIAL SHALL BE DESIGNED AND CONSTRUCTED AROUND THE OUTSIDE OF THE EASEMENT(S) TO ALLOW THE DISTRICT DIRECT ACCESS FROM THE ADJACENT RIGHT-OF-WAY. EASEMENT SHALL BE CLEARLY MARKED OR STAKED PRIOR TO THE START OF CONSTRUCTION.

**LOT:**

THIS PROPERTY MAY HAVE STATIC WATER PRESSURE IN EXCESS OF 80 PSI. THE UNIFORM PLUMBING CODE, REQUIRES THAT INDIVIDUAL, ON-SITE (PRIVATE), PRESSURE-REDUCING VALVES BE INSTALLED WHENEVER THE PRESSURE EXCEEDS 80 PSI. PRV'S ARE THE DEVELOPER'S RESPONSIBILITY, AND WILL NOT BE INSPECTED OR INCLUDED IN THE ACCEPTANCE OF LVVWD FACILITIES.

ALL SEWER/STORM DRAINS CROSSING WATER LINES MUST CONFORM TO SECTION 2.19 OF THE UNIFORM DESIGN AND CONSTRUCTION STANDARDS FOR POTABLE WATER SYSTEMS (UDACS) FOR WATER AND STORM MAIN CROSSINGS AND CLEARANCES.

**NOTE:**  
INSTALL PIPELINE MARKER BALLS IN TRENCH ABOVE EACH HORIZONTAL ELBOW FITTING, PER UDACS PLATE NO. 27.

**WATER MAIN JOINT DEFLECTION (PVC, 4"-24")**  
PVC PIPE SHALL BE DEFLECTED AT THE JOINT ONLY. THE MAXIMUM ALLOWABLE DEFLECTION SHALL BE ONE (1) DEGREE PER JOINT WITH A MINIMUM RADIUS OF CURVATURE OF 1,150 FEET, PER UDACS 2.06.2. FOR CHANGES IN DIRECTION EXCEEDING THE MAXIMUM ALLOWABLE JOINT DEFLECTION, FITTINGS SHALL BE USED.

**FIRE FLOW CALCULATIONS (TYP. BUILDING)**

FIRE FLOW REQUIREMENT IS: 2,625 GALLONS PER MINUTE AT 20 PSI RESIDUAL PRESSURE.

BASED ON:  
 SQUARE FOOTAGE: 81,524 SF  
 LARGEST AREA BETWEEN 4-HOUR AREA SEPARATION WALLS: N/A S.F.  
 BUILDING HEIGHT: 38 FEET  
 NUMBER OF STORIES: 3 FLOORS  
 TYPE OF CONSTRUCTION: TYPE VA HOUR  
 OCCUPANCY: 101508  
 FULL AUTOMATIC SPRINKLERS SYSTEM: YES

**APR 12, 2007**  
DATE

**CITY FIRE MARSHAL**

APR 12, 2007-701-037  
USA and CITY OF LAS VEGAS LEASE

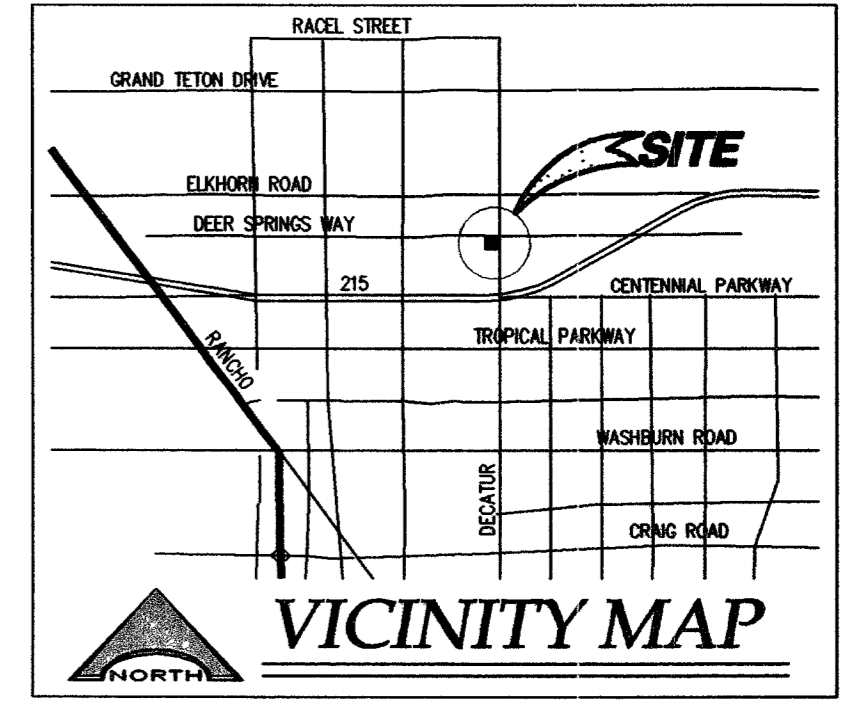
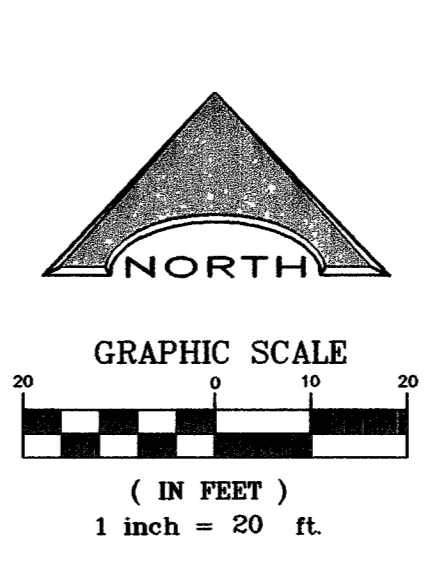
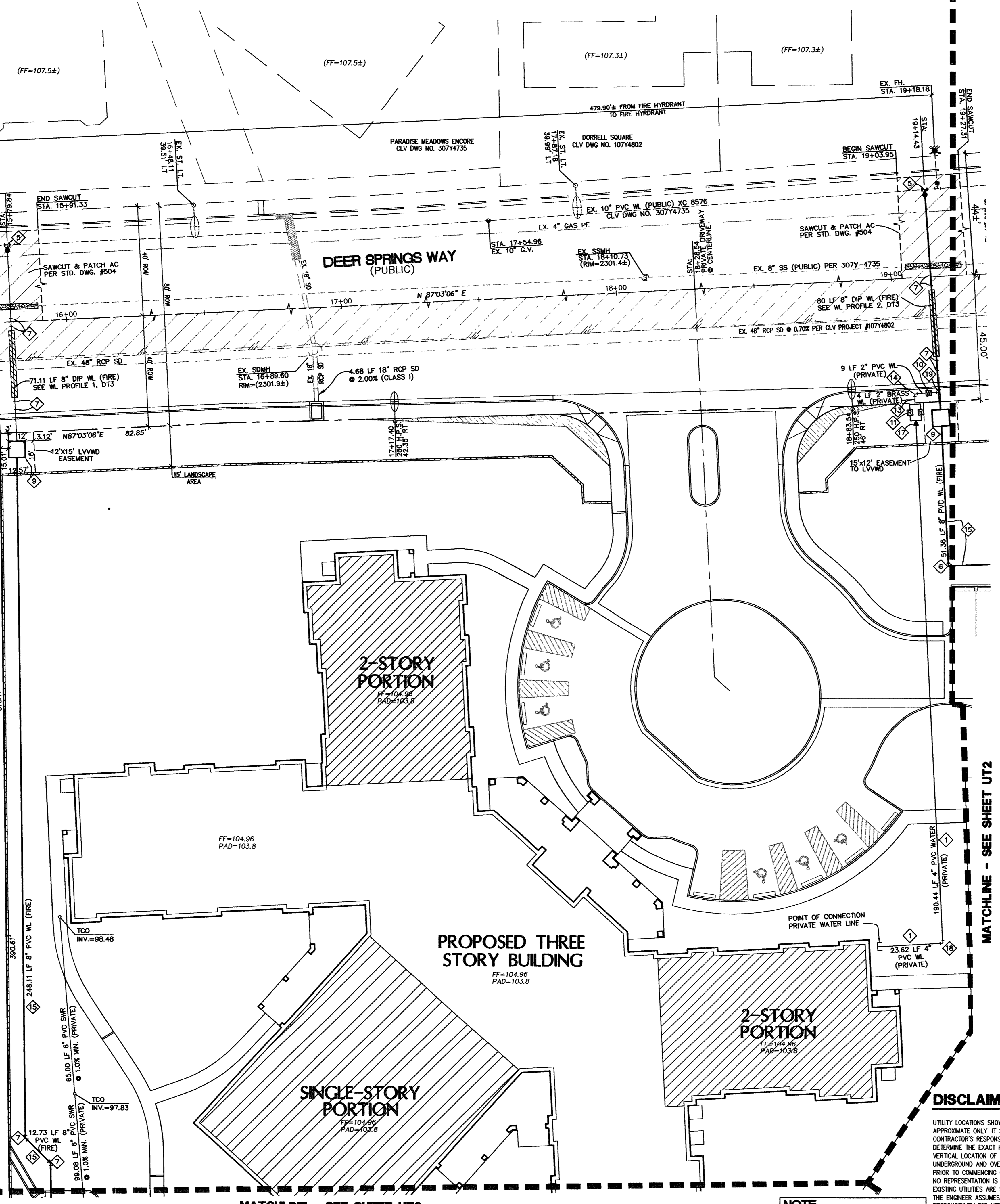

**LEGEND AND ABBREVIATIONS**

DW	DOMESTIC WATER	INV	INVERT OF PIPE
WL	WATER LINE	TCO	TOP CLEAN OUT
SS	SANITARY SEWER	PVC	POLY VINYL CHLORIDE
SWR	SEWER	APN	ACCESSOR'S PARCEL NUMBER
◆	CONSTRUCTION NOTE	---	RIGHT-OF-WAY LINE
---	PROPERTY LINE	---	STREET CENTERLINE
---	STREET LIGHT CONDUIT	---	SAWCUT LINE
FF=22.0	FINISH FLOOR ELEVATION	○	EXISTING STREETLIGHT
○	PROPOSED 250 HPS STREETLIGHT		

**WATER CONSTRUCTION NOTES & QUANTITIES**

	PUBLIC	PRIVATE
◆ INSTALL 4" PVC DOMESTIC WATER		218 LF
◆ INSTALL 8" x 8" x 8" TEE		4 EA
◆ INSTALL FIRE HYDRANT ASSEMBLY (INCL: TEE, VALVE, LATERAL, RISER, THRUST BLOCKS, AND ALL ASSORTED HARDWARE) PER UDACS PLATE 7	2 EA	3 EA
◆ INSTALL 8" GATE VALVE PER UDACS PLATE 3 AND 8.	4 EA	7 EA
◆ INSTALL 10"x8" MJ TAPPING SLEEVE AND 8" TAPPING VALVE PER UDACS PLATE 22	2 EA	
◆ INSTALL 8" 90° BEND		2 EA
◆ INSTALL 8" 45° BEND	12 EA	2 EA
◆ INSTALL 8" 22.5° BEND		4 EA
◆ INSTALL 8" DCDA PER UDACS 11C (3' BEHIND BACK OF SW)	2 EA	
◆ INSTALL 2" METER PER UDACS PLATE 10	1 EA	
◆ INSTALL DUAL 2" RPPA PER UDACS 11B (3' BEHIND BACK OF SW)	2 EA	
◆ INSTALL 8" x 8" x 6" TEE		1 EA
◆ INSTALL 2" BRASS WATERLINE	9 LF	
◆ INSTALL 2" BRASS 90° BEND	1 EA	
◆ INSTALL 8" PVC FIRE PRIVATE UNLESS NOTED PUBLIC	81 LF	1480 LF
◆ INSTALL BLUE REFLECTIVE RAISED PAVEMENT MARKERS AT FIRE HYDRANTS	1 EA	4 EA
◆ INSTALL 4"x2" REDUCER (AFTER RPPA)	1 EA	
◆ INSTALL 4" 90° BEND		1 EA
◆ INSTALL 2" SERVICE SADDLE PER UDACS 1D	1 EA	
◆ INSTALL 8" PVC WL	693 EA	
◆ INSTALL 12" PVC WL	682 LF	
◆ INSTALL 12" 45° BEND	1 EA	
◆ INSTALL 12" GATE VALVE PER UDACS PLATE 3 AND 8.	EA	
◆ INSTALL 10"x10" MJ TAPPING SLEEVE W/10" TAPPING VALVE PER UDACS PLATE 22	1 EA	
◆ INSTALL CAP & 2" BLOW-OFF VALVE UDACS PLX. 4A	1 EA	4 EA
◆ INSTALL FIRE DEPARTMENT CONNECTION		1 EA
◆ INSTALL 6" GATE VALVE		

**BENCHMARK**  
 FOUND CITY OF LAS VEGAS BM RIVET AND PLATE IN CONCRETE CYLINDER AT THE SW CORNER OF BRADLEY AND ROME. SLV90 2456 2309.12(±ft) 703.8215(m) NAVD88

**BASIS OF BEARING**  
 NORTH 86°55'18" EAST, BEING THE BEARING OF THE CENTERLINE OF ROME BOULEVARD AS SHOWN ON A MAP ON FILE IN THE CLARK COUNTY, NEVADA RECORDER'S OFFICE AS FILE 106, PAGE 81 OF SURVEYS.

**OWNER**  
 NEVADA H.A.N.D.,  
 235 WARM SPRINGS ROAD SUITE 101  
 LAS VEGAS, NEVADA 89119-4212  
 TEL: (430-9025) CONTACT: ROBERT FIEBLEMAN

**DISCLAIMER NOTE**  
 UTILITY LOCATIONS SHOWN HEREON ARE APPROXIMATE ONLY IT SHALL BE THE CONTRACTOR'S RESPONSIBILITY TO DETERMINE THE EXACT HORIZONTAL AND VERTICAL LOCATION OF ALL EXISTING UNDERGROUND AND OVERHEAD UTILITIES PRIOR TO COMMENCING CONSTRUCTION. NO REPRESENTATION IS MADE THAT ALL EXISTING UTILITIES ARE SHOWN HEREON. THE ENGINEER ASSUMES NO RESPONSIBILITY FOR UTILITIES NOT SHOWN OR UTILITIES NOT SHOWN IN THEIR PROPER LOCATION.

**Call before you Dig**  
 1-800-227-2600  
 UNDERGROUND SERVICE (USA)

**Call before you OVERHEAD**  
 1-702-227-2929  
 NEVADA POWER ENVIRONMENT AND SAFETY SERVICES DEPARTMENT

**Call before you Underground**  
 1-702-455-7511  
 CLARK COUNTY TRAFFIC OPERATIONS  
 1-702-229-6611  
 LAS VEGAS AREA COMPUTERIZED TRAFFIC SYSTEM

REV NO. REVISION DESCRIPTION

**NEVADA H.A.N.D.**  
 235 WARM SPRINGS ROAD SUITE 101  
 LAS VEGAS, NEVADA 89119-4212  
 TEL: (702) 739-3345 CONTACT: ROBERT FIEBLEMAN

**L.R. NELSON CONSULTING ENGINEERS, INC.**  
 8785 West Russell Road Suite 200  
 Las Vegas, Nevada 89118  
 (702) 798-7978  
 (702) 451-2286 FAX

**SILVER SKY AT DEER SPRINGS**  
 DEER SPRINGS WAY AND DECATUR BLVD  
 CITY OF LAS VEGAS

**UTILITY PLAN**

**SEAL**  
 KIMBERLY D. MANGES  
 12/24/07  
 CIVIL  
 LICENSE NO. 17097  
 4-20-07

**SCALE: 1" = 20'**

**SHEET**  
 UT1  
 5 OF 23 SHEETS  
 CLV DRAWING NO. 107V4842

APPROVED BY: [Signature]  
 DESIGNED BY: [Signature]  
 CHECKED BY: [Signature]  
 PROJECT NO. 818-013-062

DRAWN BY: [Signature] MAR 2007  
 DATE

LAS VEGAS VALLEY WATER DISTRICT  
 PROJECT #113910