

Call before you Dig  
1-800-227-2600

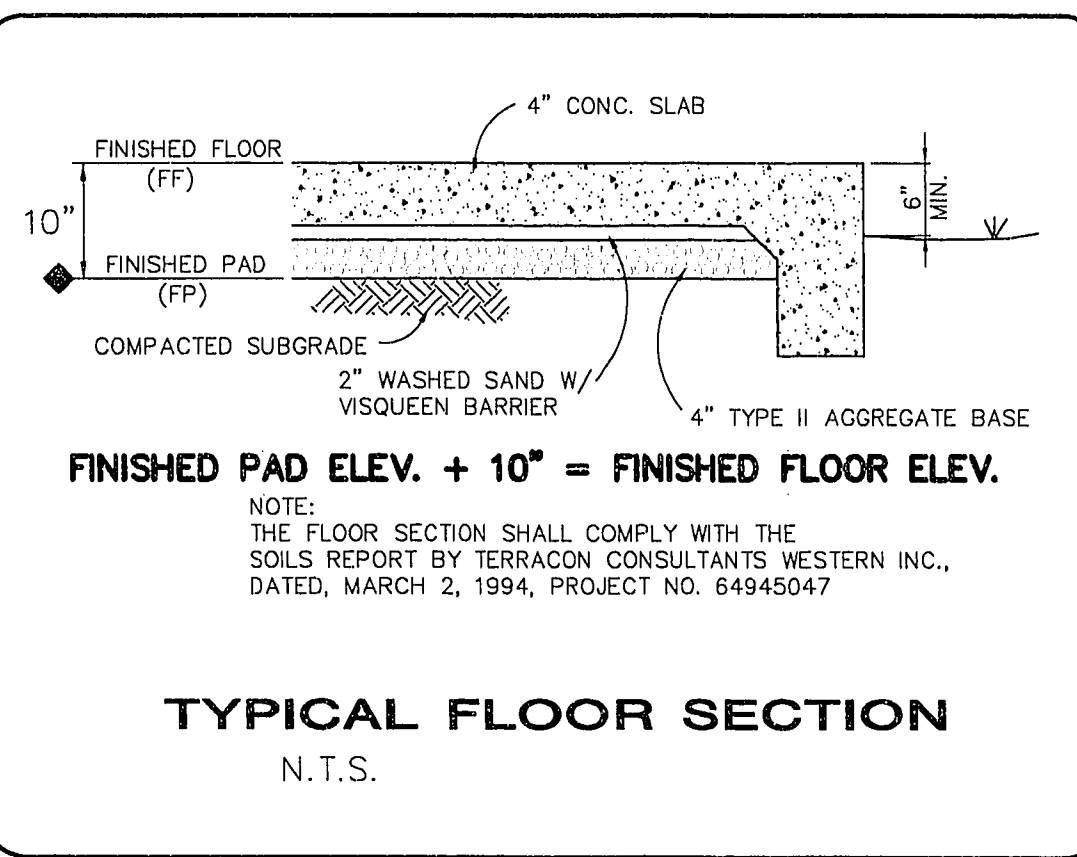

**NOTE:**  
ALL WALLS IN THIS SET OF IMPROVEMENT PLANS ARE THE DEVELOPERS RESPONSIBILITY FOR CONSTRUCTION EXCEPT THE VILLAGE WALLS AS INDICATED IN SECTIONS B & C. ALL EXPOSED SURFACES OF RETAINING WALLS (DESIGNED BY OTHERS) AND SURFACE TREATMENTS MUST COMPLY WITH THE REQUIREMENTS OF THE "TRAILS DESIGN CRITERIA".  
"TRAILS AT SUMMERLIN RESIDENTIAL DESIGN CRITERIA"

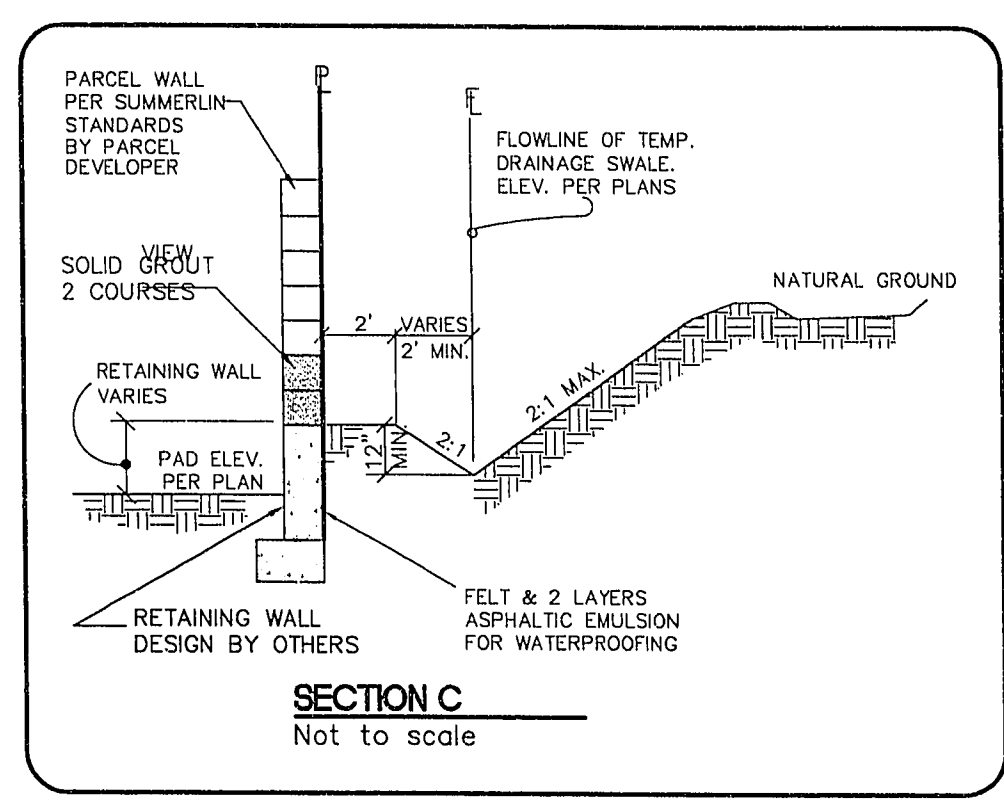
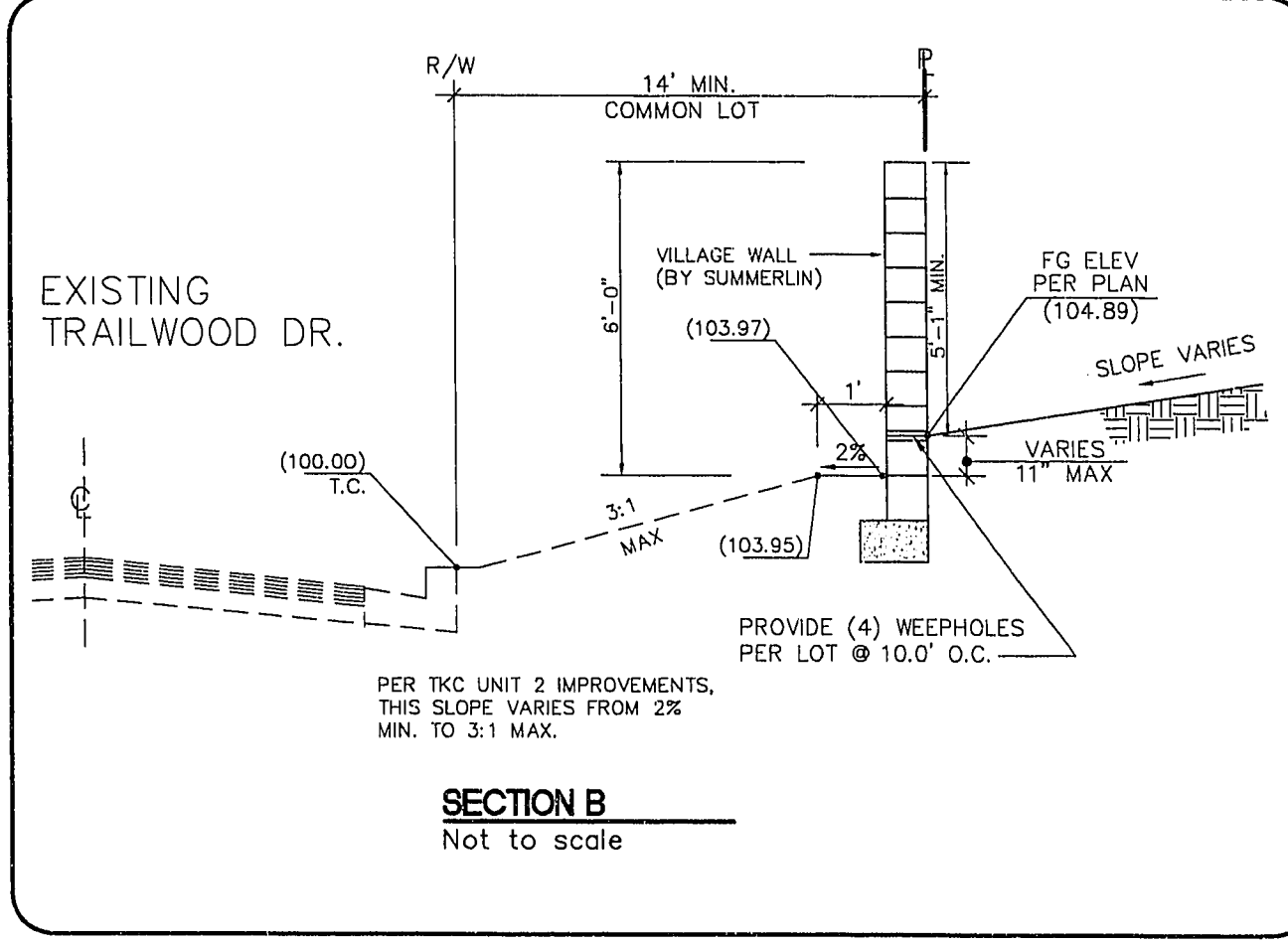
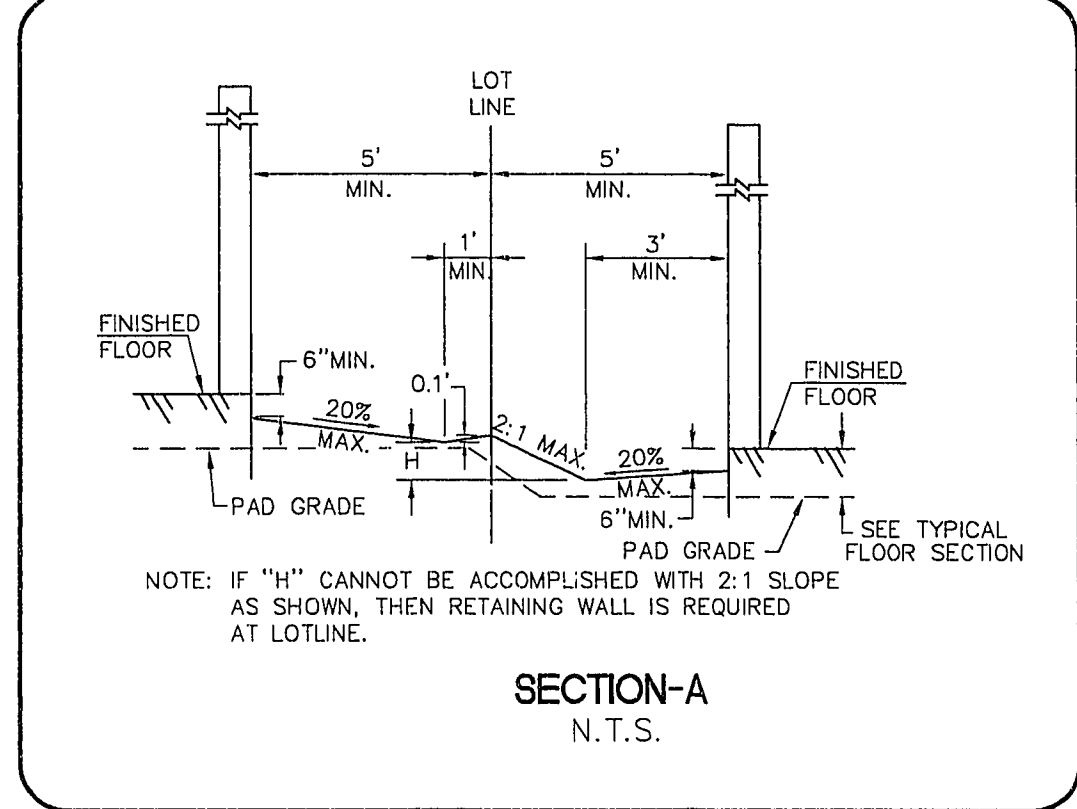
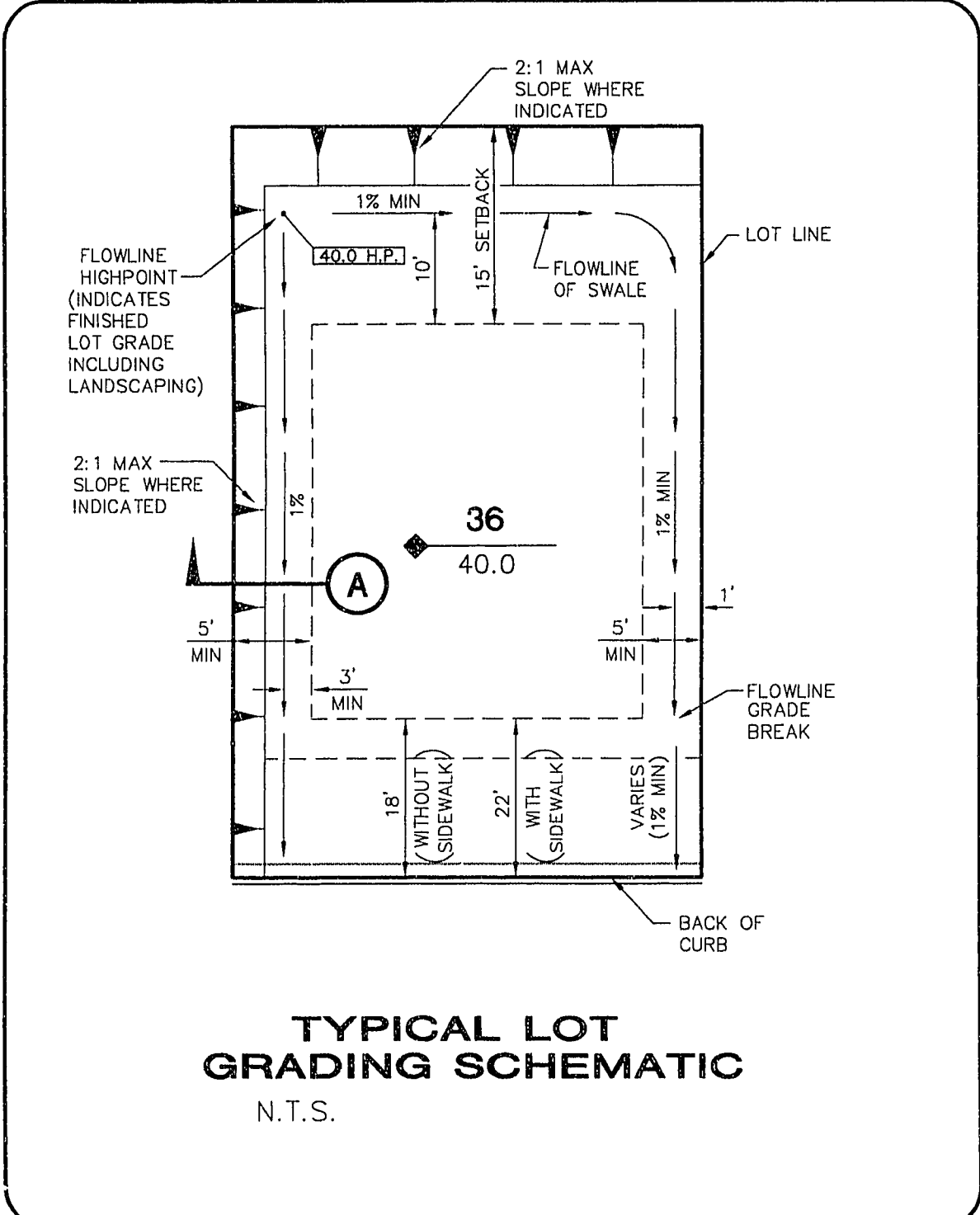
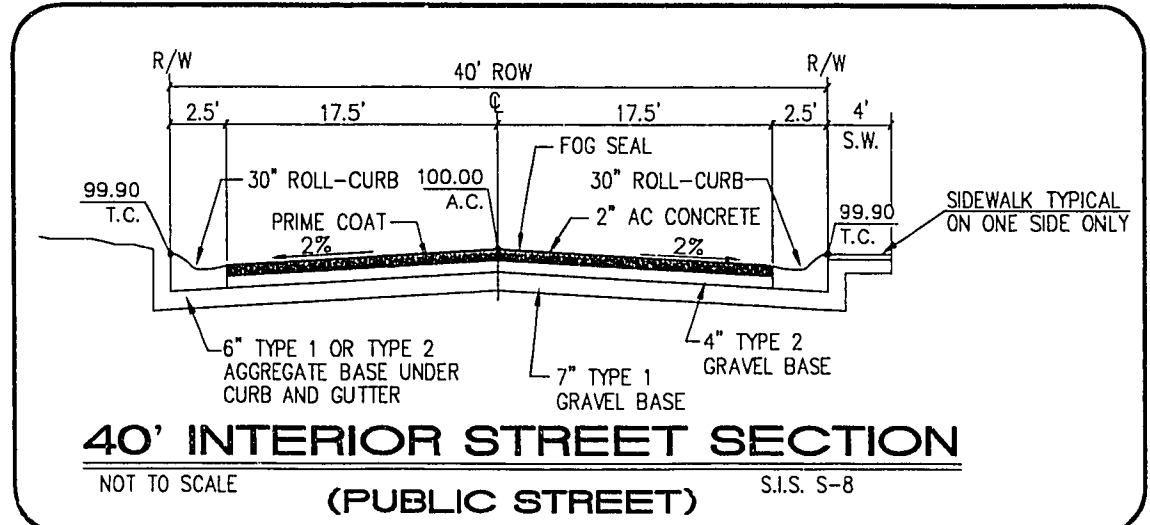
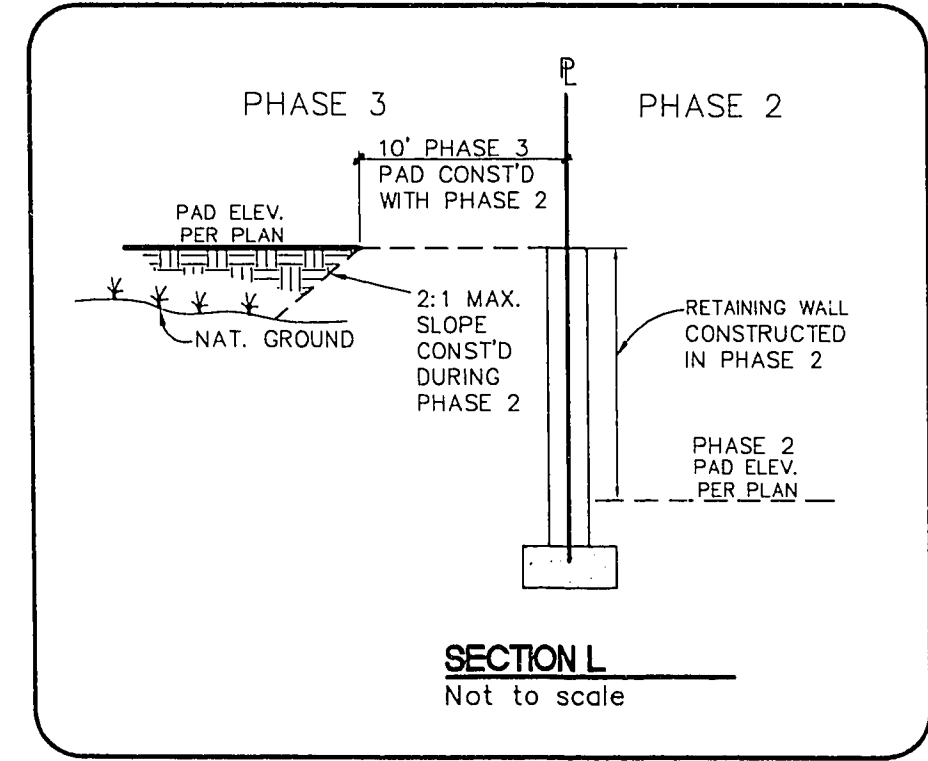
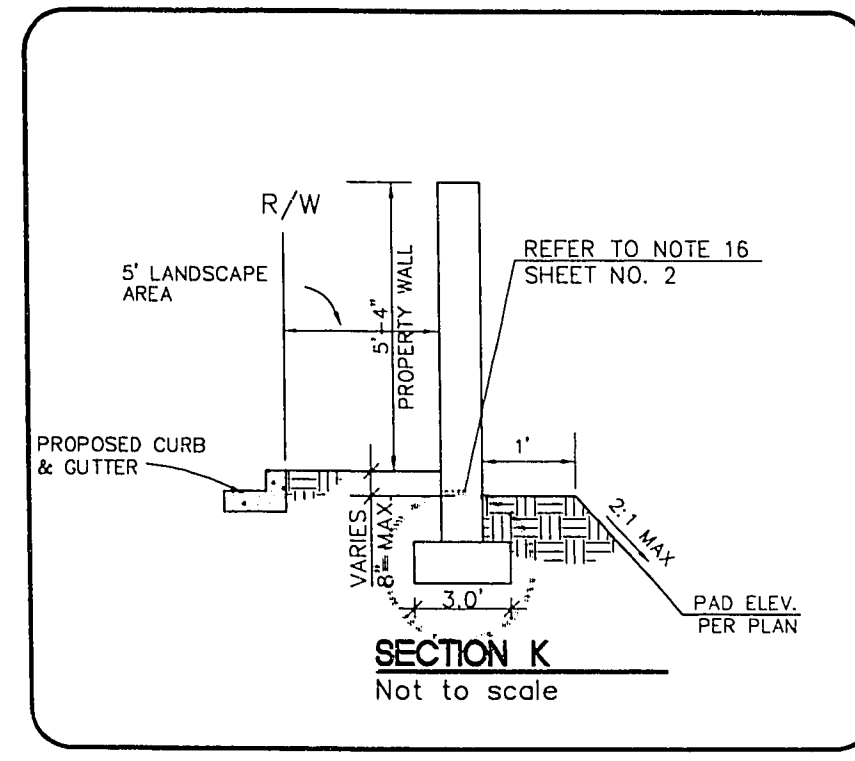
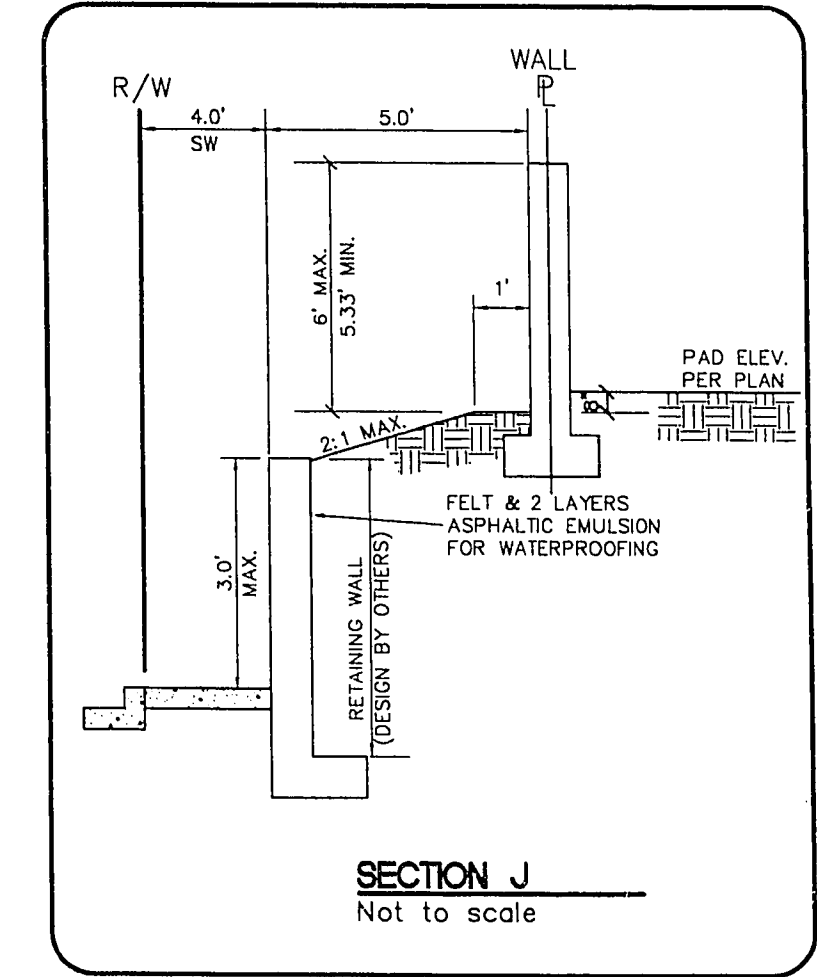
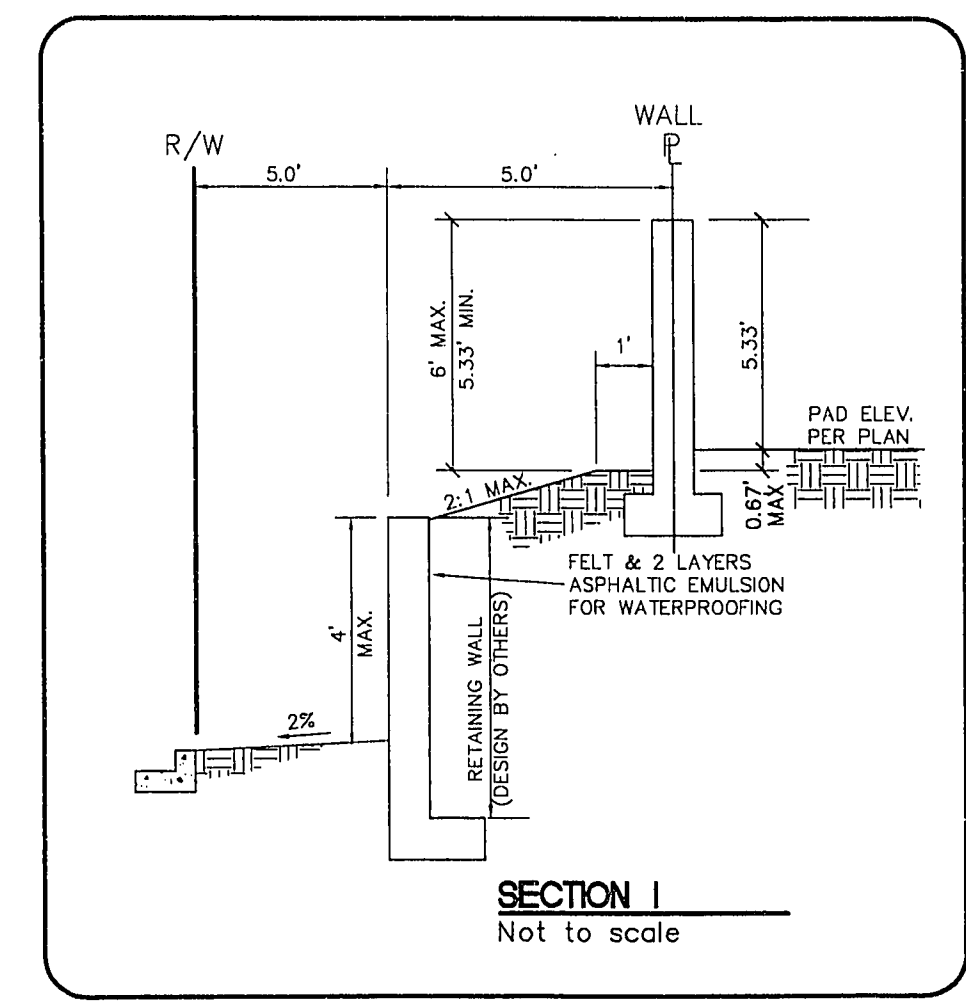
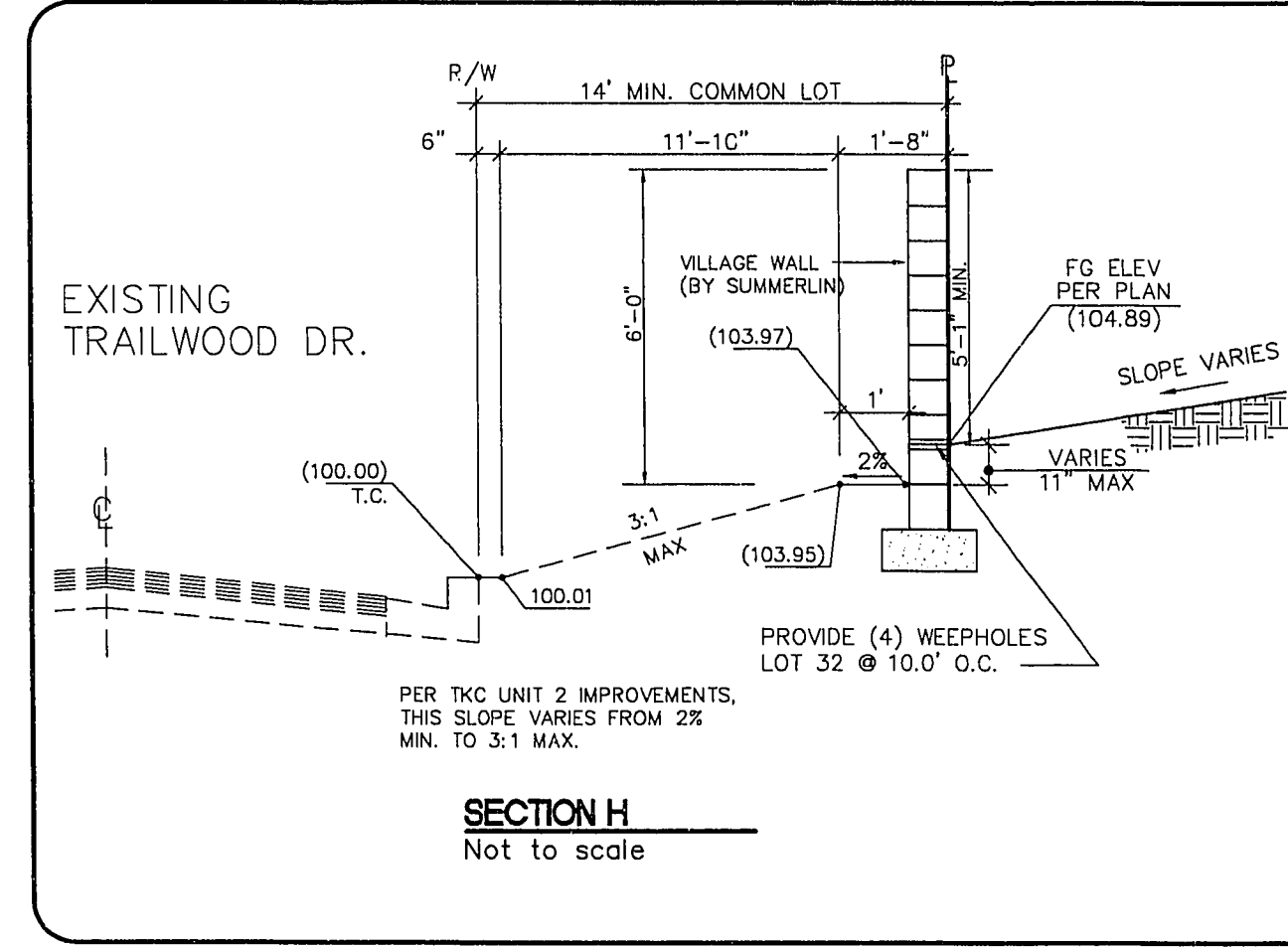
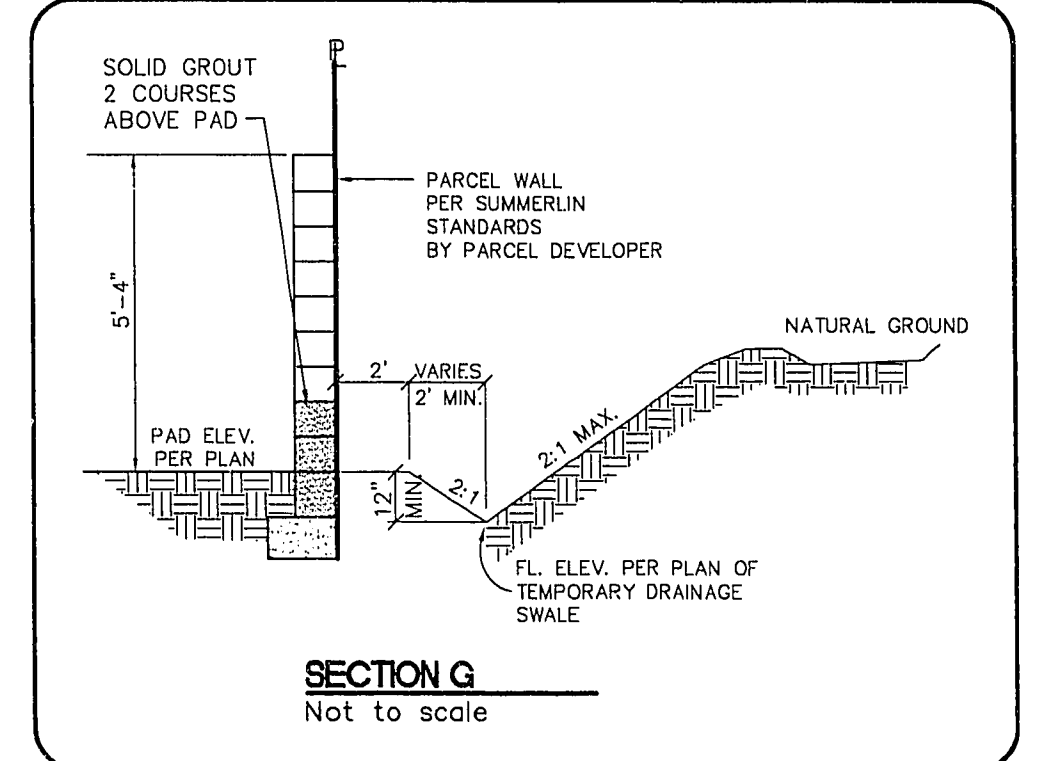
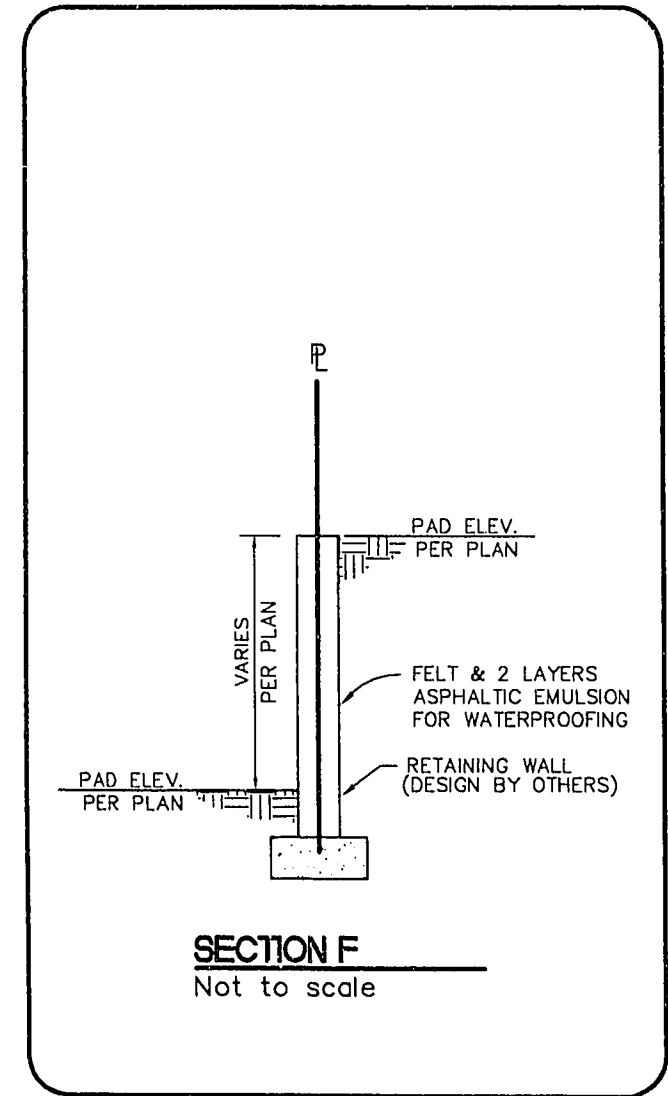
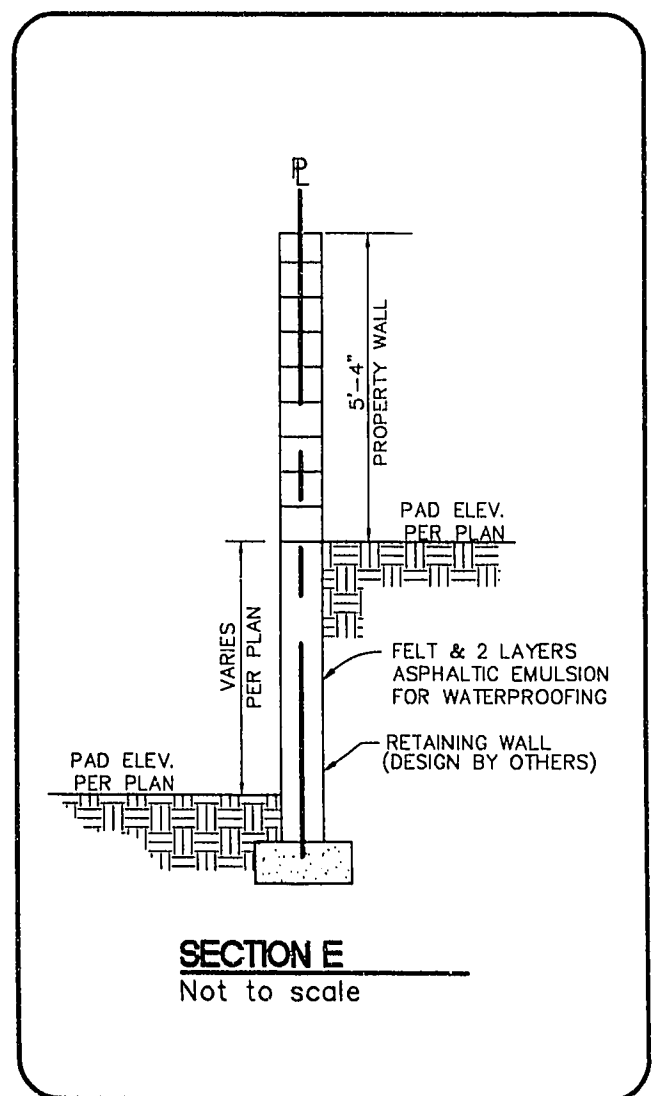
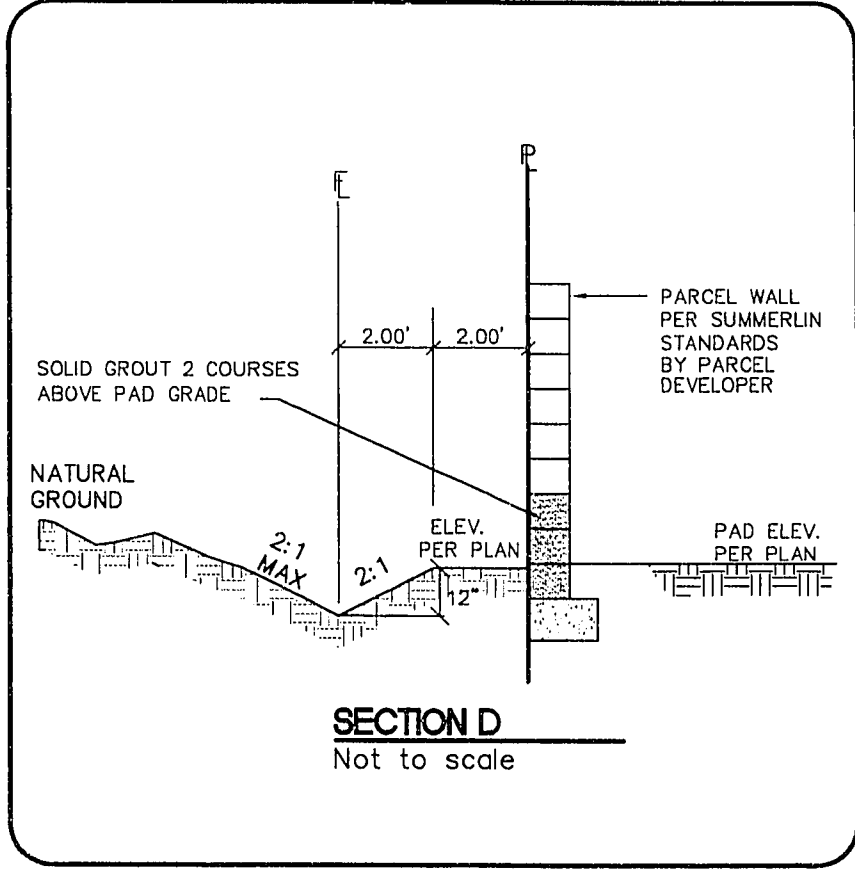

**NOTE:**  
REFER TO NOTE 16 SHEET NO. 2 OF CITY OF LAS VEGAS GENERAL NOTES FOR PROPERTY WALL AND RETAINING WALL REQUIREMENTS.

VOID  
8/30/95  
T.H.K.

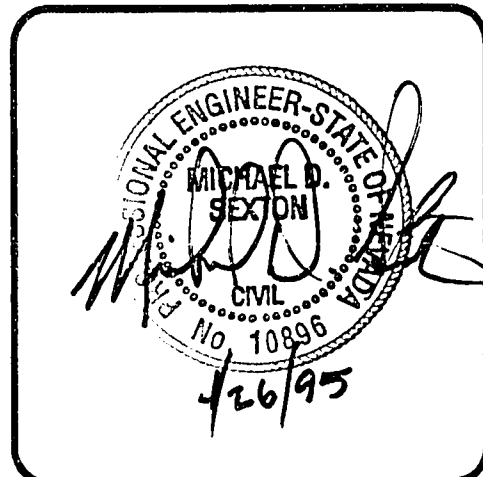

Job Number	7089.626	Drawn by	ITW	Scale	
Sheet Number	10 OF 10	Checked by	KEK	File No.	626MP
Date	SEP. 23, 1994	Date	SEP. 23, 1994		
Drawings	6263-10	FOOT DATE			
PHASE THREE DETAIL SHEET					
POST-BUCKLEY <b>PSJ</b> S. SCHUCHMAN J. JERNICAN ENGINEERING - PLANNING - SURVEYING - CONSTRUCTION SERVICES 6600 West Charleston Blvd. Las Vegas, Nevada 89102 Phone: 702/736-6044 Fax: 702/736-7755					
No.	REVISIONS	Date	Instr.	Appr.	Date

C:\DWG5\6263\6263-10 Tue Apr 25 16:15:53 1995 Church Engineering - ERICM

11-15-167

107Y-4331-3