

DISCLAIMER NOTE:

UTILITY LOCATIONS SHOWN HEREON ARE APPROXIMATE ONLY. IT SHALL BE THE CONTRACTOR'S RESPONSIBILITY TO DETERMINE THE EXACT HORIZONTAL AND VERTICAL LOCATION OF ALL EXISTING UNDERGROUND OR OVERHEAD UTILITIES PRIOR TO COMMENCING CONSTRUCTION. NO REPRESENTATION IS MADE THAT ALL EXISTING UTILITIES ARE SHOWN HEREON. THE ENGINEER ASSUMES NO RESPONSIBILITY FOR UTILITIES NOT SHOWN OR UTILITIES NOT SHOWN IN THEIR PROPER LOCATION. CONTRACTOR TO NOTIFY ENGINEER OF ANY CHANGES OR DISCREPANCIES.

Call before you Dig
 Avoid overhead power line contact. It's costly. Avoid cutting underground utility lines. It's costly.
Call before you Overhead
 Nevada Power
1-702-227-2929
 Environment and Safety Services Department
 Clark County Traffic Operations
1-800-227-2600
1-702-455-7544

BENCHMARK
 CITY OF LAS VEGAS BENCHMARK NO. 6LVS0 1854
 A RING AND PLATE IN THE TOP OF CURB AT THE NORTHEAST CORNER OF GRAND CANYON AND ELKHORN
 ELEVATION=840.308 METERS (NAV'D98)
 ELEVATION=2756.91 US SURVEY FEET (NAV'D98)

BASIS OF BEARINGS
 N 0°00'21" W, BEING THE EAST LINE OF THE SOUTHWEST QUARTER (SE 1/4) OF THE SOUTHWEST QUARTER (SW 1/4) OF SECTION 18, TOWNSHIP 19 SOUTH, RANGE 60 EAST, M.D.M., AS SHOWN THAT CERTAIN MAP IN FILE 82, PAGE 20, OF PARCELS AND PLATS ON FILE IN THE COUNTY RECORDERS OFFICE, CLARK COUNTY, NEVADA.

STREETLIGHT CIRCUIT CAPACITY VERIFICATION FOR PUBLIC CIRCUIT

CAPACITY CALCULATIONS	
1 CIRCUIT CAPACITY:	60 AMPS
2 MAXIMUM CONTINUOUS CURRENT DRAW (90%)	48 AMPS
3 EXISTING CIRCUIT LOAD (ENTER 0 IF NEW)	0.0 AMPS
4 AVAILABLE (2 MINUS 3)	48 AMPS
PROPOSED LUMINAIRE LOAD TO CIRCUIT:	
5 7 NUMBER OF 82 WATT STILTS @ 0.7 AMPS/EA	4.9 AMPS
6 3 NUMBER OF 130 WATT STILTS @ 1.0 AMPS/EA	3.0 AMPS
7 0 NUMBER OF 250 WATT STILTS @ 2.0 AMPS/EA	0 AMPS
8 TOTAL PROPOSED ADDITIONAL LOAD (5+6+7)	7.9 AMPS
REMAINING AVAILABLE LOAD (4 MINUS 8)	40.1 AMPS

NOTES:
 THE CONTRACTOR SHALL CONTACT THE TRAFFIC ENGINEERING DIVISION (TRANSPORTATION SECTION) THROUGH THE PROJECT'S OFFICE PRIOR TO INITIATING PAVING TO RECEIVE DIRECTION FOR ANY PERMANENT OR TEMPORARY MODIFICATIONS TO THE APPROVED DRAWINGS REGARDING FINAL PAVEMENT TRANSITIONS, MARKINGS AND SIGNING THAT ARE REQUIRED TO MATCH ADJACENT ROADWAY SEGMENTS. THE CONTRACTOR SHALL PROVIDE A DRAWING FOR APPROVAL BY THE TRAFFIC ENGINEERING DIVISION DEPICTING ANY ADJUSTMENTS TO THE FINAL PAVEMENT MARKINGS AND SIGNAGE, WHICH MAY INCLUDE OMITTING, ADDING OR MODIFYING PAVEMENT MARKINGS AND TRAFFIC CONTROL SIGNS SUCH THAT ADEQUATE TRANSITIONS AND LANE TERMINATIONS BETWEEN ADJACENT ROADWAY SEGMENTS ARE CONSTRUCTED.

TRAFFIC CONSTRUCTION NOTES

- SIGNS**
- INSTALL 1-30" R1-1 STOP SIGN AND 2-9" STREET NAME SIGNS PER PRIVATE STREET STDS
 - INSTALL 1-36" R1-1 STOP SIGN AND 2-12" STREET NAME SIGNS PER USDOCA No. 250
 - EXISTING STOP SIGN TO REMAIN IN PLACE
 - INSTALL OM-3R SIGN AT 35' O.C.
 - EXISTING OM-3R SIGNS TO BE RELOCATED OR RETURNED TO CC TRAFFIC OPS
 - RELOCATE 35 MPH SIGNS
 - RELOCATE 25 MPH SIGNS
 - EXISTING CROSS WALK SIGN TO REMAIN IN PLACE
 - REMOVE EXISTING END OF ROAD BARRICADES
 - RELOCATE STOP SIGN AND STREET NAME SIGNS
 - INSTALL R2-1 25 MPH SPEED LIMIT SIGN
 - INSTALL R3-17 BIKE LANE SIGN
 - INSTALL R8-3A NO PARKING SIGN
- STREETLIGHTS**
- INSTALL 1-1/4" PVC STREETLIGHT CONDUIT WITH PULL STRING
 - INSTALL No. 3 1/2 PULL BOX PER USDOCA No. 326
 - INSTALL 4" FIBER OPTIC CONDUIT WITH #8 TRACER WIRE AND PULL CORD IN THE CONDUIT
 - INSTALL P30 PULL BOX WITH "FIBER OPTIC" INSCRIBED ON LID PER USDOCA No. 761
 - INSTALL 82W LED STREET LIGHT
 - INSTALL 130W LED STREET LIGHT
 - INSTALL TWO 130W LED STREET LIGHTS AND RELATED APPURTENANCES FOR SIGNALIZED INTERSECTION PER USDOCA No. 885 (1 OF 2) WITH 200 AMP SERVICE PEDESTAL AND TYPE R CABINET
 - INSTALL 125 AMP PRIVATE WALL MOUNTED SERVICE
- PAVEMENT MARKINGS AND MISCELLANEOUS**
- INSTALL BLUE COLORED REFLECTIVE RAISED PAVEMENT MARKERS ADJACENT TO THE FIRE HYDRANT ON ALL IMPROVED FIRE APPARATUS ACCESS ROADWAYS WITH HARD SURFACE, INCLUDING BOTH PUBLIC AND PRIVATE ROADS, OR FIRE LANES
 - PAINT CURB RED IN FRONT OF FIRE HYDRANT
 - INSTALL 8" WIDE PAINTED EDGELINE
 - INSTALL 6" WIDE PAINTED EDGELINE
 - INSTALL 4" WIDE PAINTED EDGELINE
 - EXISTING CROSS WALK MARKINGS
 - EXISTING TRANSITION PAVEMENT MARKINGS PER USDOCA No. 245, REPLACE AS NECESSARY
 - INSTALL TYPE 2 CENTERLINE DELINEATION PER USDOCA No. 244
 - EXISTING EDGELINE PAVEMENT MARKINGS
 - EXISTING TYPE 1 CENTERLINE
 - INSTALL 2" WIDE PAINTED STOP BAR PER USDOCA No.254
 - INSTALL CROSSWALK MARKINGS PER USDOCA No.259
 - INSTALL TYPE 4 LANE LINE PER USDOCA No.244.1
 - REMOVE EXISTING LANE LINES THROUGH INTERSECTION (BCR TO BCR)
 - EXISTING LANE LINES TO REMAIN IN PLACE
 - EXISTING BIKE LANE LINE TO REMAIN IN PLACE
 - INSTALL 6" WIDE BIKE LANE STRIPE
 - INSTALL LEFT TURN PAVEMENT ARROWS
 - EXISTING STOP BAR TO REMAIN IN PLACE

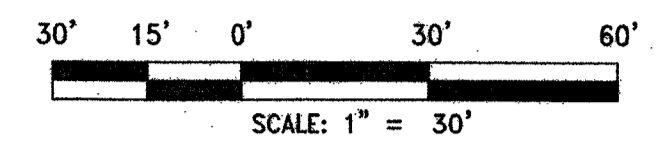

AS-BUILT PER PLAN 9/21/15
Dean Chomakov

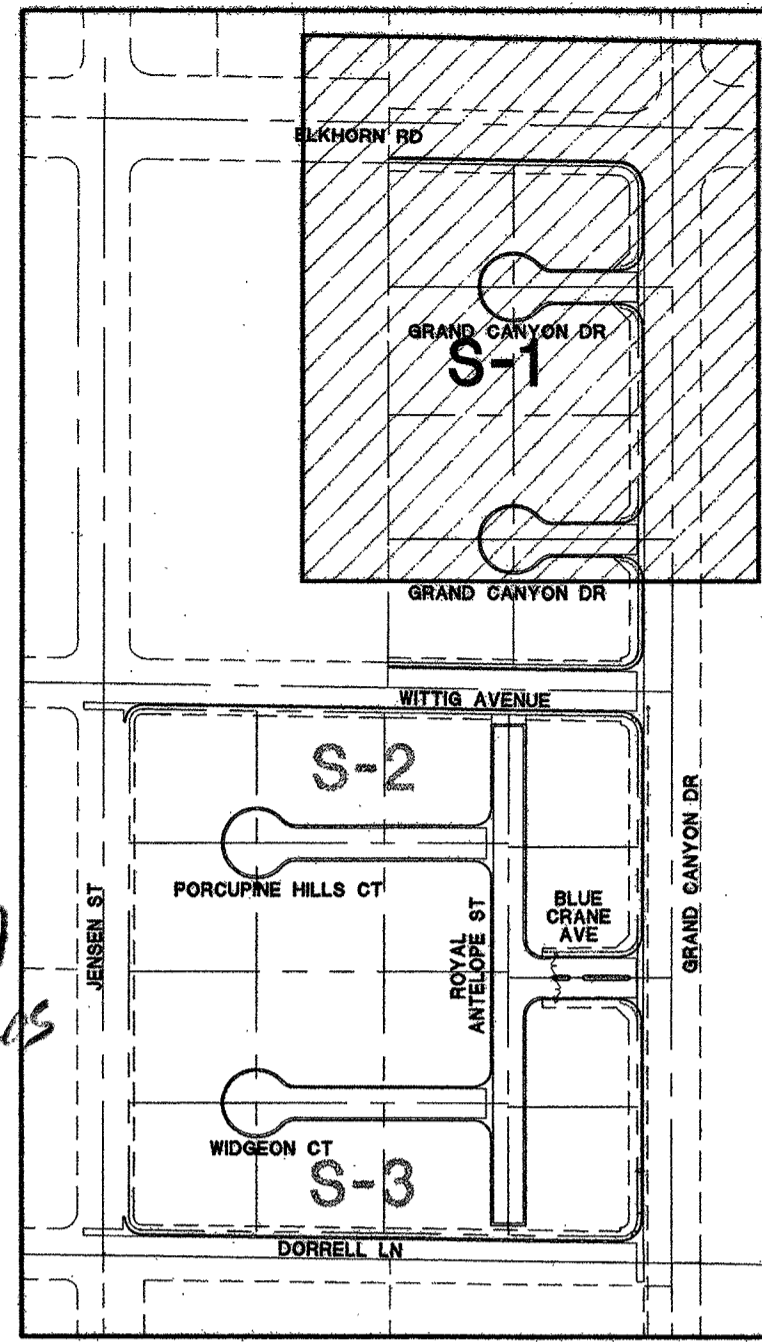

CURVE TABLE

CURVE	DELTA	RADIUS	LENGTH	TANGENT	"A"	"B"
C1	90°44'10"	25.00	39.59	25.32	-	-
C2	90°00'0"	25.00	39.27	25.00	4.5'	9.5'
C3	180°0'0"	2.50	7.85	INFINITE	-	-
C4	180°0'0"	2.50	7.85	INFINITE	-	-
C5	180°0'0"	2.50	7.85	INFINITE	-	-
C6	180°0'0"	2.50	7.85	INFINITE	-	-
C7	90°0'0"	25.00	39.27	25.00	8.0'	8.0'
C8	89°11'4"	25.00	38.91	24.85	4.5'	9.5'
C9	90°48'56"	25.00	39.63	25.36	8.0'	8.0'
C10	90°0'0"	25.00	39.27	25.00	4.5'	9.5'
C11	90°0'0"	25.00	39.27	25.00	8.0'	8.0'
C12	90°0'0"	25.00	39.27	25.00	8.0'	8.0'
C13	90°0'0"	25.00	39.27	25.00	8.0'	8.0'
C14	89°8'18"	30.00	48.66	29.54	8.0'	8.0'
C15	90°47'3"	20.00	31.69	20.28	8.0'	8.0'
C16	89°17'43"	20.00	31.17	19.76	8.0'	8.0'
C17	90°0'0"	20.00	31.42	20.00	8.0'	8.0'
C18	90°0'0"	20.00	31.42	20.00	8.0'	8.0'
C19	90°0'0"	20.00	31.42	20.00	8.0'	8.0'
C20	48°49'38"	19.50	16.62	8.85	-	-
C21	277°39'15"	40.50	196.26	35.42	-	-
C22	48°49'38"	19.50	16.62	8.85	-	-
C23	90°0'0"	20.00	31.42	20.00	-	-
C24	90°0'0"	20.00	31.42	20.00	-	-
C25	48°49'38"	19.50	16.62	8.85	-	-
C26	277°39'15"	40.50	196.26	35.42	-	-
C27	48°49'38"	19.50	16.62	8.85	-	-
C28	90°0'0"	20.00	31.42	20.00	-	-
C29	48°49'38"	19.50	16.62	8.85	-	-
C30	277°39'15"	40.50	196.26	35.42	-	-
C31	48°49'38"	19.50	16.62	8.85	-	-
C32	48°49'38"	19.50	16.62	8.85	-	-
C33	277°39'15"	40.50	196.26	35.42	-	-
C34	48°49'38"	19.50	16.62	8.85	-	-

SVZ LINE TABLE

LINE	BEARING	LENGTH
L1	S 89°16'32" E	75.89
L2	N 0°0'42" W	110.89
L3	S 74°38'38" W	113.02
L4	S 45°21'23" W	18.58
L5	S 83°56'21" W	80.73
L6	N 0°0'42" W	90.00
L7	S 0°0'42" E	5.00
L8	S 45°0'42" E	25.58
L9	S 73°0'23" E	92.38
L10	N 80°53'53" E	61.42
L11	S 89°59'18" W	55.00
L12	S 0°0'42" E	71.00
L13	N 7°30'2" E	77.85
L14	N 44°59'18" E	5.81
L15	N 82°34'49" W	78.86
L16	N 89°59'18" E	72.00
L17	S 0°0'42" E	59.00
L18	N 8°38'56" W	85.39
L19	N 45°0'42" W	5.99
L20	N 89°59'18" E	59.00
L21	N 0°0'42" W	72.00
L22	S 7°29'11" W	78.86
L23	S 44°59'18" E	5.99
L24	S 81°21'4" W	65.58
L25	N 82°34'49" W	78.86
L26	N 89°59'18" E	72.00
L27	S 0°0'42" E	59.00
L28	N 8°38'56" W	85.39
L29	N 45°0'42" W	5.99
L30	N 89°59'18" E	59.00
L31	N 0°0'42" W	72.00
L32	S 7°25'11" W	78.86
L33	S 44°59'18" W	5.99
L34	S 81°21'4" W	65.58
L35	S 0°0'42" E	59.00
L36	N 89°59'18" E	61.00
L37	N 81°35'5" W	67.64
L38	N 45°0'42" W	5.99
L39	N 8°38'56" W	85.39
L40	S 0°0'42" E	134.00
L41	N 0°0'42" W	5.00
L42	N 44°59'18" E	23.11
L43	N 5°35'14" E	137.93
L44	N 44°36'14" W	18.62
L45	N 83°56'26" W	92.84
L46	S 89°11'46" E	87.36
L47	S 0°0'42" E	46.36
L48	N 0°0'42" W	48.83
L49	N 0°0'42" W	86.99
L50	S 0°0'42" E	4.00
L51	S 43°36'52" E	24.93
L52	S 8°14'50" E	30.83
L53	S 7°46'39" W	62.02
L54	S 45°23'45" W	18.78
L55	S 83°44'24" W	76.59
L56	S 89°11'46" E	71.65
L57	S 0°0'42" E	158.00
L58	N 0°0'42" W	4.80
L59	N 43°35'28" E	23.63
L60	N 3°29'56" E	142.16
L61	N 0°0'42" W	51.00
L62	S 0°0'42" E	4.00
L63	S 43°36'52" E	24.93
L64	S 8°14'50" E	34.51
L65	N 89°7'1" W	171.89
L66	S 85°59'14" E	194.02
L67	S 8°15'6" E	22.92
L68	S 3°29'56" W	73.94
L69	S 43°35'28" W	23.63
L70	S 0°0'42" E	4.00
L71	N 0°0'42" W	73.53
L72	N 89°11'46" W	76.73
L73	S 0°11'1" W	83.73
L74	N 5°31'7" E	87.47
L75	N 45°0'42" E	10.73
L76	N 84°19'29" E	81.38
L77	S 83°47'24" E	88.12
L78	N 89°16'32" E	84.25
L79	N 0°11'1" E	77.25
L80	S 2°29'26" E	62.66
L81	S 44°57'40" E	10.19

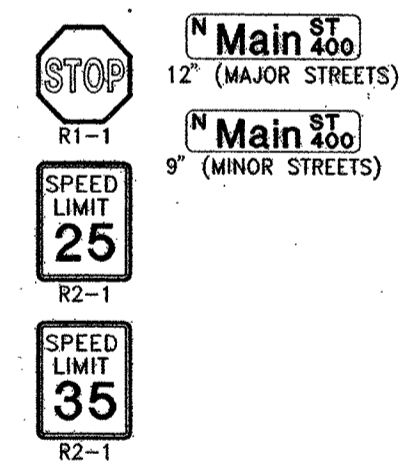

Traffic Signs

DATE: September 20, 2014
 HORIZ. SCALE: 1"=50'
 VERT. SCALE: N/A
 DRAWN BY: CR
 DESIGNED BY: SC
 CHECKED BY: JIL
 APPROVED BY: JIL
 PROJECT #: 3110.007

TOLL NORTH LV, LLC
 1140 CENTER DRIVE SUITE 250
 LAS VEGAS, NV 89144
 PHONE: 702-443-8800 FAX: 702-443-8810

RCI Engineering
 4325 Dean Martin Drive Suite 300 Las Vegas, Nevada 89103
 PHONE: 702-453-0800 FAX: 702-453-0801

NEVADA

IMPROVEMENT PLANS FOR
SAVONA UNIT 3
 A SINGLE FAMILY RESIDENTIAL SUBDIVISION
 STREET LIGHT, SIGNAGE, & STRIPING PLAN
 (SHEET 1 OF 3)

TRAFFIC / IC

CITY OF LAS VEGAS

9/20/2014

S-1
 SHEET 33 OF 35

DWG # 10745003
 CLV PROJECT # 052625