

BENCHMARK
 CITY OF LAS VEGAS BENCHMARK NO. 6LV90 1854
 A RIVET AND PLATE IN THE TOP OF CURB AT THE
 NORTHEAST CORNER OF GRAND CANYON AND ELKHORN
 ELEVATION=840.308 METERS (NAVD'88)
 ELEVATION=2756.91 US SURVEY FEET (NAVD'88)

BASIS OF BEARINGS
 N 00°00'21" W, BEING THE EAST LINE OF THE SOUTHEAST QUARTER (SE
 1/4) OF THE SOUTHWEST QUARTER (SW 1/4) OF SECTION 18, TOWNSHIP
 19 SOUTH, RANGE 50 EAST, M.D.M., AS SHOWN THAT CERTAIN MAP IN
 FILE 82, PAGE 20, OF PARCEL MAPS ON FILE IN THE COUNTY RECORDERS
 OFFICE, CLARK COUNTY, NEVADA.

**GRAND CANYON DRIVE
 (PUBLIC)**

NOTE
 SEE SHEET P-1 FOR CENTERLINE DATA, CURB DATA, AND UTILITY
 PROFILES.

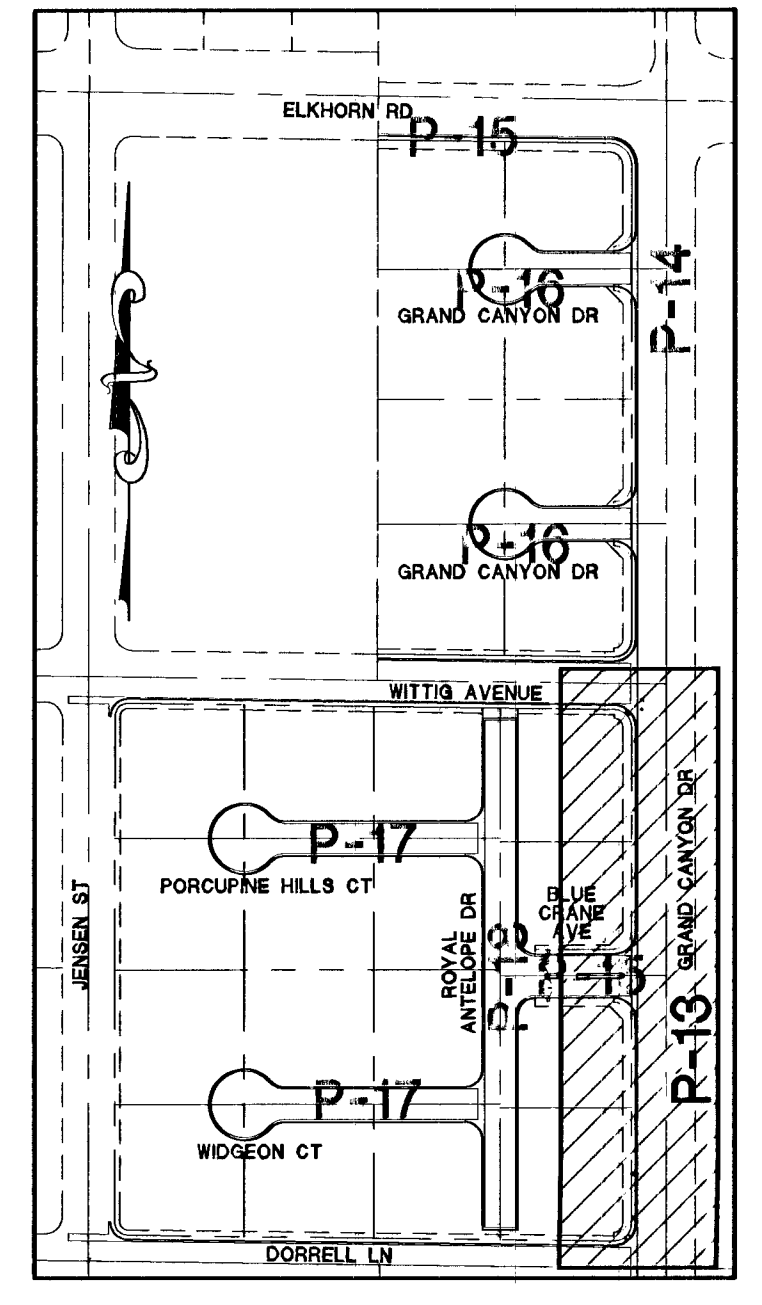
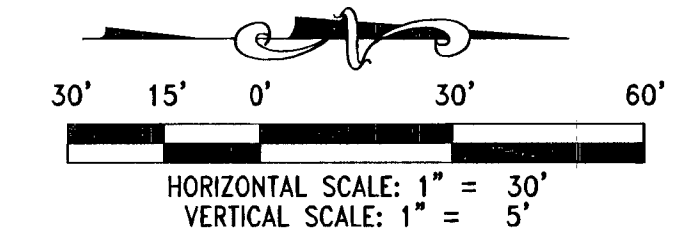

REV	DESCRIPTION	BY	APPD	DATE
1	ISSUE FOR PERMIT			
2	ISSUE FOR CONSTRUCTION			

TOLL NORTH LV, LLC
 1140 TOWN CENTER DRIVE SUITE 250
 LAS VEGAS, NV 89144
 PHONE: 702-243-9800 FAX: 702-243-9810

RCI Engineering
 4325 Dean Martin Drive Suite 300 Las Vegas, Nevada 89103
 PHONE: 702-243-0800 FAX: 702-243-0807

DISCLAIMER NOTE:
 UTILITY LOCATIONS SHOWN HEREON ARE APPROXIMATE ONLY. IT SHALL BE THE CONTRACTORS RESPONSIBILITY TO DETERMINE THE EXACT HORIZONTAL AND VERTICAL LOCATION OF ALL EXISTING UNDERGROUND OR OVERHEAD UTILITIES PRIOR TO COMMENCING CONSTRUCTION. NO REPRESENTATION IS MADE THAT ALL EXISTING UTILITIES ARE SHOWN HEREON. THE ENGINEER ASSUMES NO RESPONSIBILITY FOR UTILITIES NOT SHOWN OR UTILITIES NOT SHOWN IN THEIR PROPER LOCATION. CONTRACTOR TO NOTIFY ENGINEER OF ANY CHANGES OR DISCREPANCIES.

Avoid overhead power line contact. If it costs, Call before you Overhead
 1-702-227-2929
 Nevada Power Environment and Safety Services Department

Call before you Dig
 Avoid calling underground utility lines. If it costs, Call before you Dig
 1-800-227-2600
 CLARK COUNTY TRAFFIC OPERATIONS
 1-702-455-7544

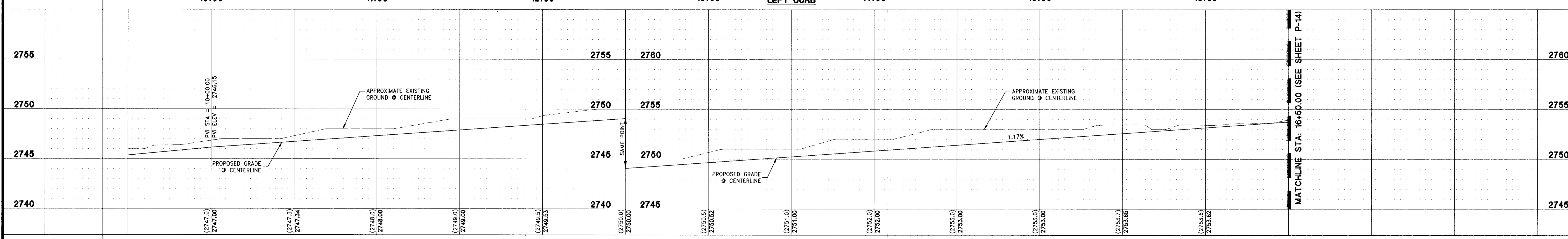
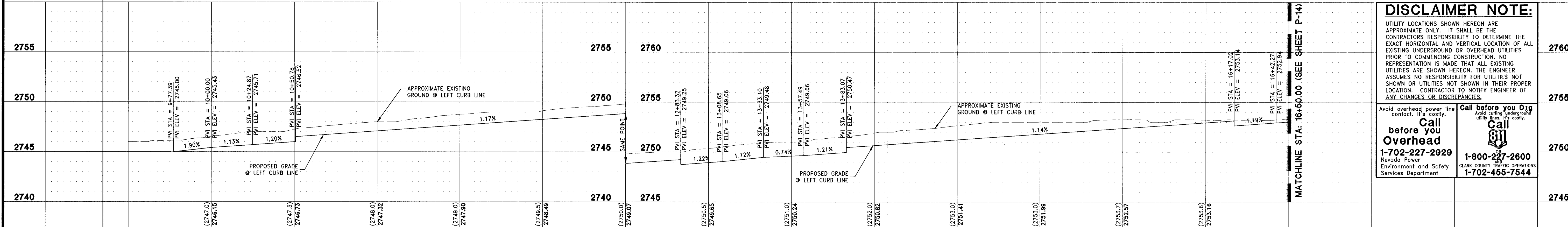

IMPROVEMENT PLANS FOR
SAVONA UNIT 3
 A SINGLE FAMILY RESIDENTIAL SUBDIVISION
PLAN AND PROFILE - GRAND CANYON DRIVE
 STA: 9+50.00 - 16+50.00

CITY OF LAS VEGAS
 9/20/2014

PROFESSIONAL ENGINEER - STATE OF NEVADA
 JOHN I. LAND
 Exp. 12/31/2015
 CIVIL
 No. 16441

9/20/2014
 DRAWING
P-13
 SHET 27 OF 35
 DWG # 1074500
 CLV PROJECT # 052625