

SANITARY SEWER (WEST) (PUBLIC)
 HORIZONTAL SCALE: 1"=30'
 VERTICAL SCALE: 1" = 3'

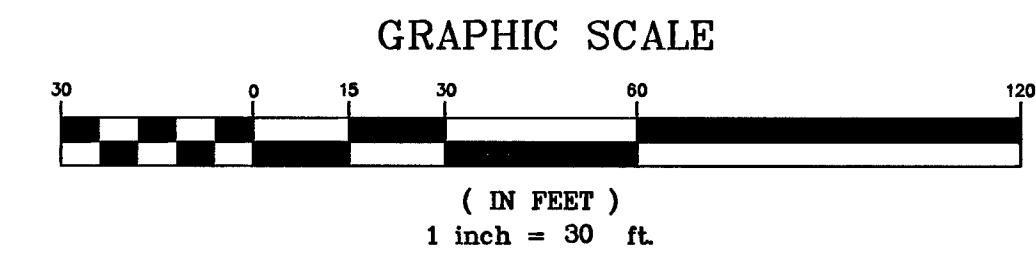

LEGEND

---	PROPERTY LINE
---	STREET CENTERLINE
---	PROP "L" CURB & GUTTER
---	EXIST. "L" CURB & GUTTER
---	PROPOSED "A" CURB & GUTTER
---	PROPOSED RETAINING WALL
---	EXIST SCREEN/RETAINING WALL
---	PROP WTR
---	EXIST WTR
---	PROP SS
---	EXISTING SS
⊙	WATER CONSTRUCTION NOTE
⊙	SEWER CONSTRUCTION NOTE
⊙	PROP. HYDRANT
⊙	EX. HYDRANT
⊙	EXISTING SSMH
⊙	PROPOSED SSMH
---	SEWER LATERAL

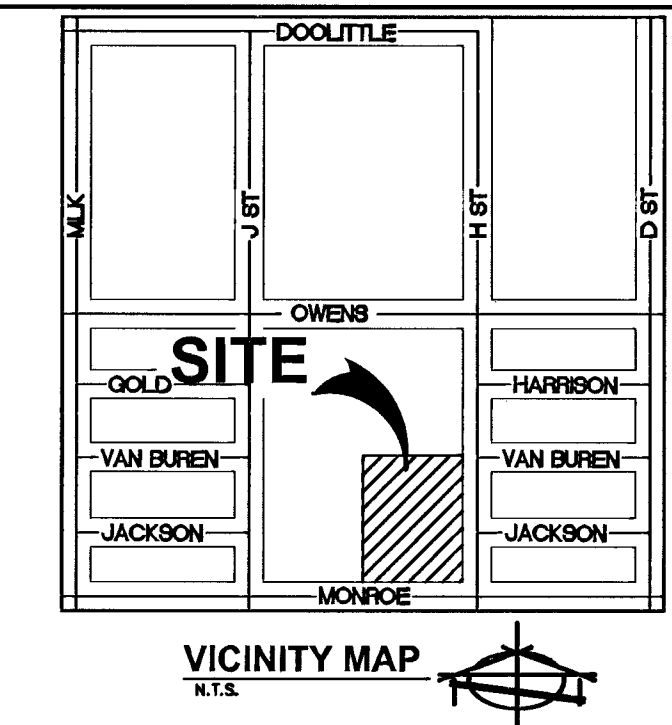
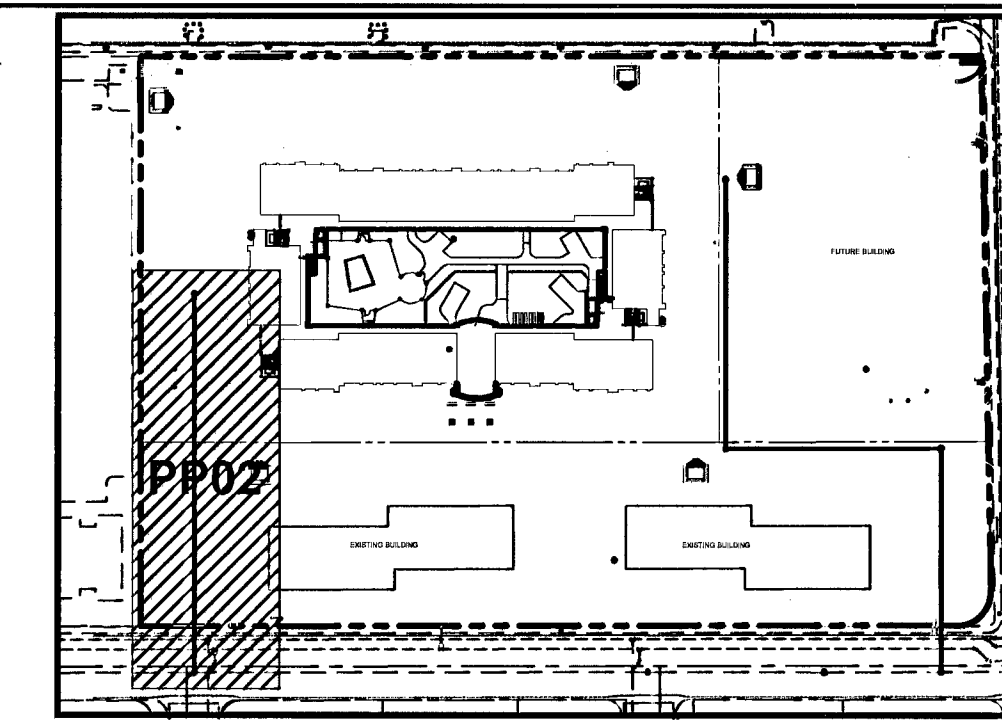
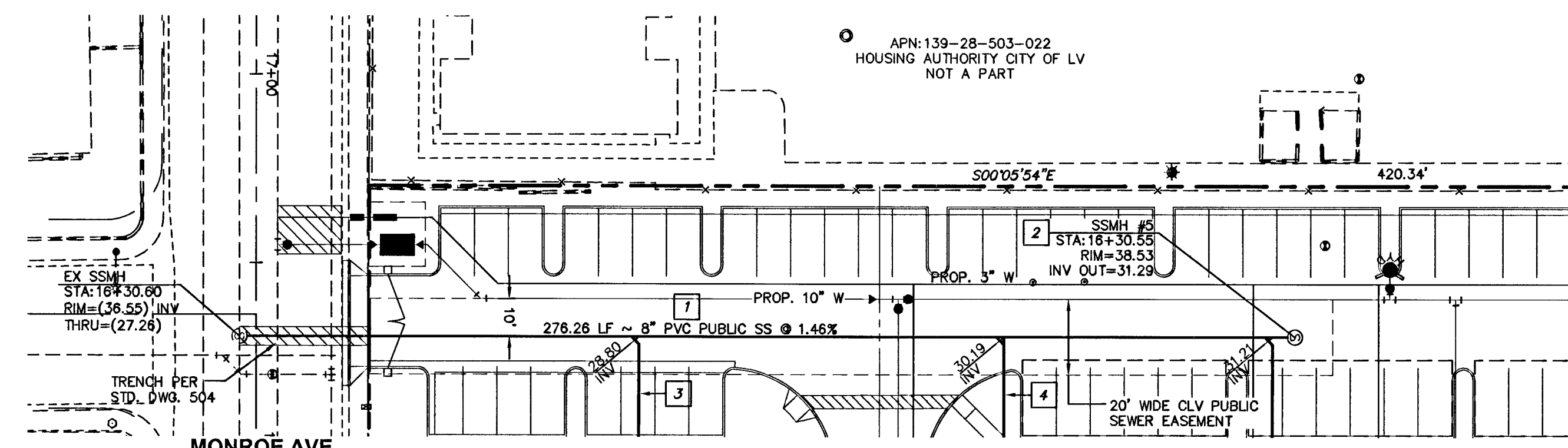

SANITARY SEWER (WEST) (PUBLIC)
 HORIZONTAL SCALE: 1"=30'

SEWER CONSTRUCTION NOTES

#	ITEM	UNIT	QUANTITY	
			PUBLIC	PRIVATE
1	INSTALL 8" PVC (SDR-35) SEWER PIPE	LF	788	-
2	CONSTRUCT 48" SEWER MANHOLE PER STD DWG # SD-1	EA	5	-
3	INSTALL 6" PVC SEWER LATERAL PER DCWSCS SD-17	LF	-	373
4	INSTALL 4" PVC SEWER LATERAL PER DCWSCS SD-17	LF	-	325
5	INSTALL 4" SANITARY SEWER CLEAN OUT	EA	-	9
6	INSTALL 6" SANITARY SEWER CLEAN OUT	EA	-	3

LEGAL DESCRIPTION

THAT PORTION OF THE NORTHEAST QUARTER (NE 1/4) OF SECTION 28, TOWNSHIP 20 SOUTH, RANGE 61 EAST M.D.M., CITY OF LAS VEGAS, CLARK COUNTY, NEVADA, DESCRIBED AS FOLLOWS:

PARCEL TWO (2), AS SHOWN BY MAP THERE OF IN FILE 87 OF PARCEL MAPS, PAGE 93, IN THE OFFICE OF THE COUNTY RECORDER OF CLARK COUNTY, NEVADA.

BASIS OF BEARING

N00°41'22"W, BEING THE CENTERLINE OF J STREET AS SHOWN ON PARCEL TWO (2) AS SHOWN BY MAP THERE OF IN FILE 87 OF PARCEL MAPS, PAGE 93, IN THE OFFICE OF THE COUNTY RECORDER OF CLARK COUNTY, NEVADA.

BENCHMARK

CITY OF LAS VEGAS BENCHMARK NO. 1092 T20S, R61E 2LV01 28NE08 RIVET AND PLATE IN TOP OF CURB @ NW CORNER OF H ST & MONROE, ELEV: 691.7740 METERS (2033.38 FEET)

DISCLAIMER NOTE

UTILITY LOCATIONS SHOWN HEREON ARE APPROXIMATE ONLY. IT SHALL BE THE CONTRACTOR'S RESPONSIBILITY TO DETERMINE THE EXACT HORIZONTAL AND VERTICAL LOCATION OF ALL EXISTING UNDERGROUND AND OVERHEAD UTILITIES PRIOR TO COMMENCING CONSTRUCTION. NO REPRESENTATION IS MADE THAT ALL EXISTING UTILITIES ARE SHOWN HEREON. THE ENGINEER ASSUMES NO RESPONSIBILITY FOR UTILITIES NOT SHOWN OR UTILITIES NOT SHOWN IN THEIR PROPER LOCATION.

Call before you dig
 800-452-4529
 Call before you dig
 1-800-227-2929
 NEVADA POWER, ENVIRONMENT AND SAFETY SERVICES DEPARTMENT
H#28975CLV#
 107V5134

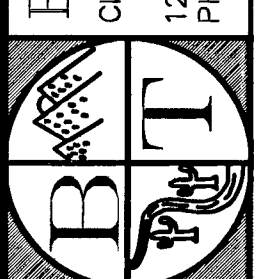
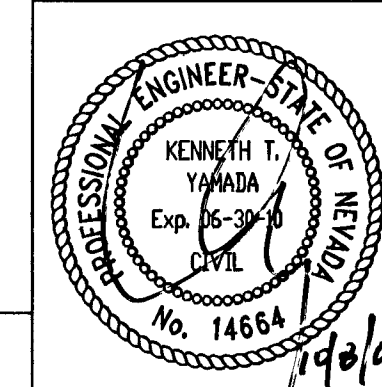

**SARANN KNIGHT
 PLAN AND PROFILE-PUBLIC SEWER**
 SECTION 28, TOWNSHIP 20 SOUTH, RANGE 61 EAST, M.D.B. & M. CITY OF LAS VEGAS
H STREET & MONROE AVENUE

SHEET
PP2
 OF
9 of 10
 PROJ. NO.
 CDCPN-SARANN KNIGHT

DATE: OCTOBER 2008
 DESIGN: MV
 DRAWN: CR
 CHECK: KTY
 SCALE: 1:30

PREPARED FOR:
CDCPN
 2008 ALTA DR
 LAS VEGAS, NV 89106
 PHONE: (702) 875-8882

DATE: OCTOBER 2008
 DESIGN: MV
 DRAWN: CR
 CHECK: KTY
 SCALE: 1:30

BAUGHMAN & TURNER, INC.
 CIVIL ENGINEERS
 LAND PLANNERS
 LAND SURVEYORS
 1210 HINSON STREET
 LAS VEGAS, NEVADA 89102
 PHONE: (702) 878-2695
 FAX: (702) 870-8771

114115