

1 3' VALLEY GUTTER DETAIL N.T.S.

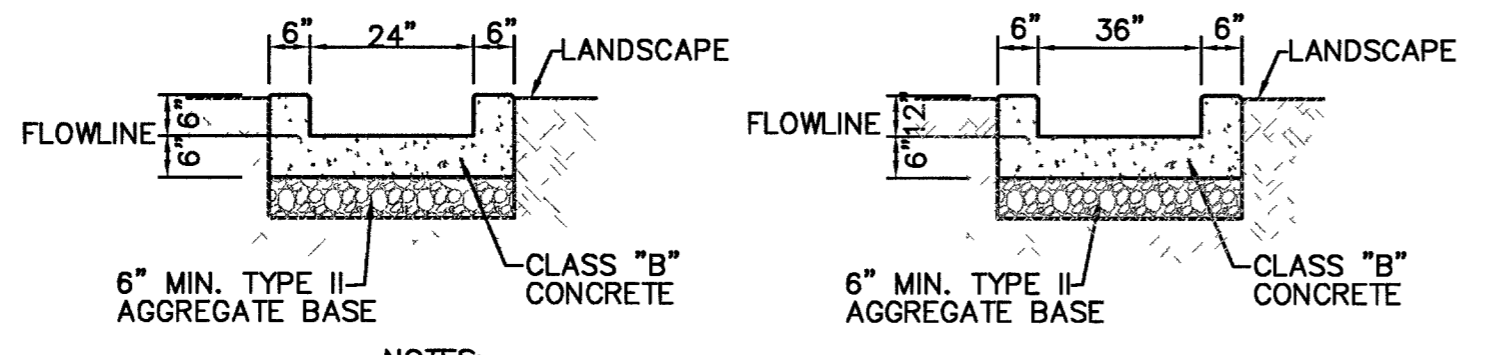

NOTES:  
 1. EXPANSION JOINTS REQUIRED AT ALL LOCATIONS WHERE CHANNEL MEETS CURB.  
 2. WEAKENED PLANE JOINTS REQUIRED AT 10' MAX. SPACING.

2 2' OR 3' CONCRETE CHANNEL DETAIL N.T.S.

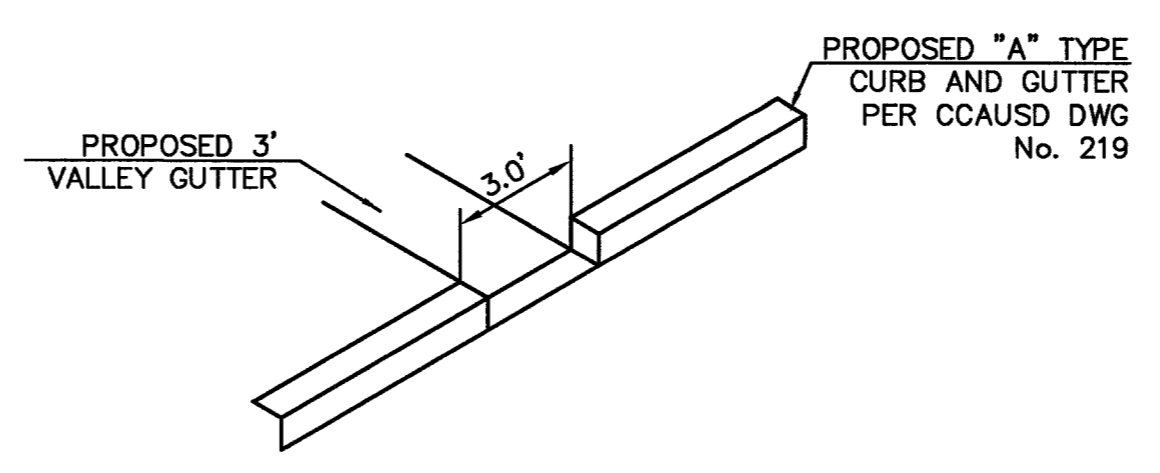

3 3' CURB OPENING N.T.S.

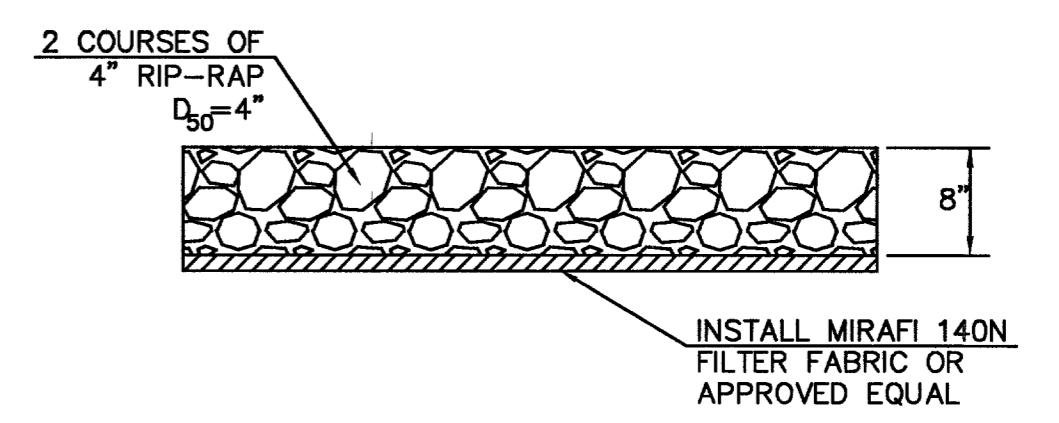

4 RIP-RAP SECTION N.T.S.

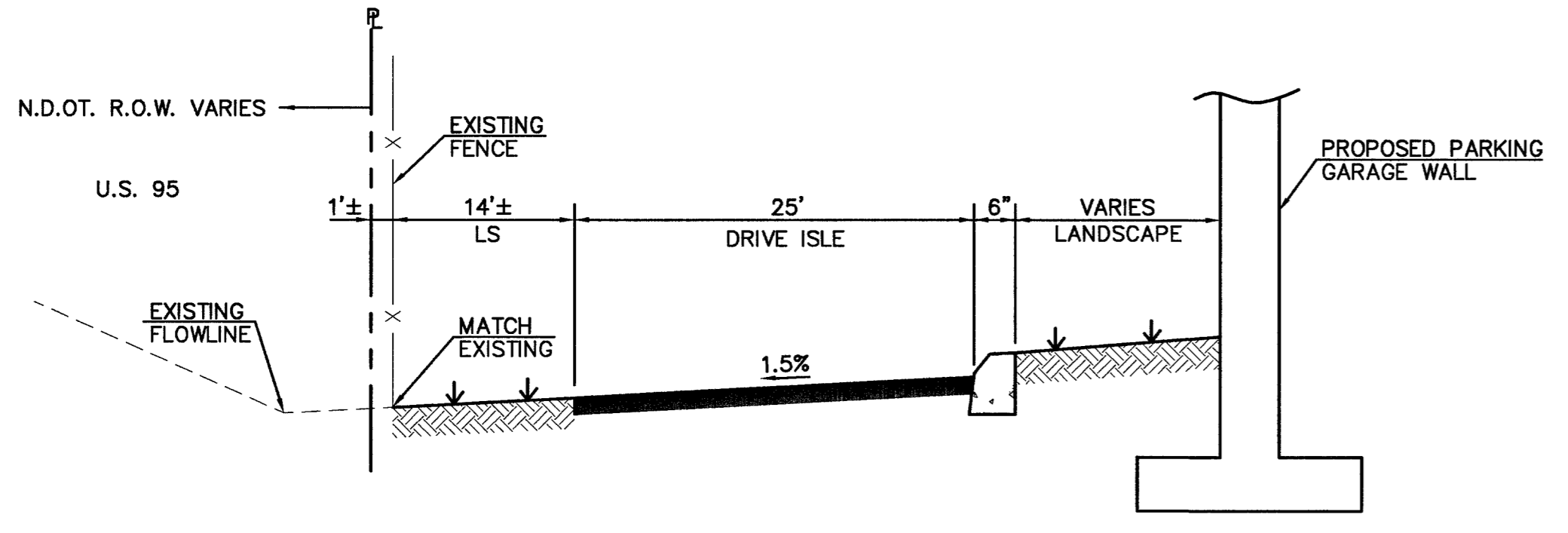

A SECTION A - WEST PROPERTY LINE N.T.S.

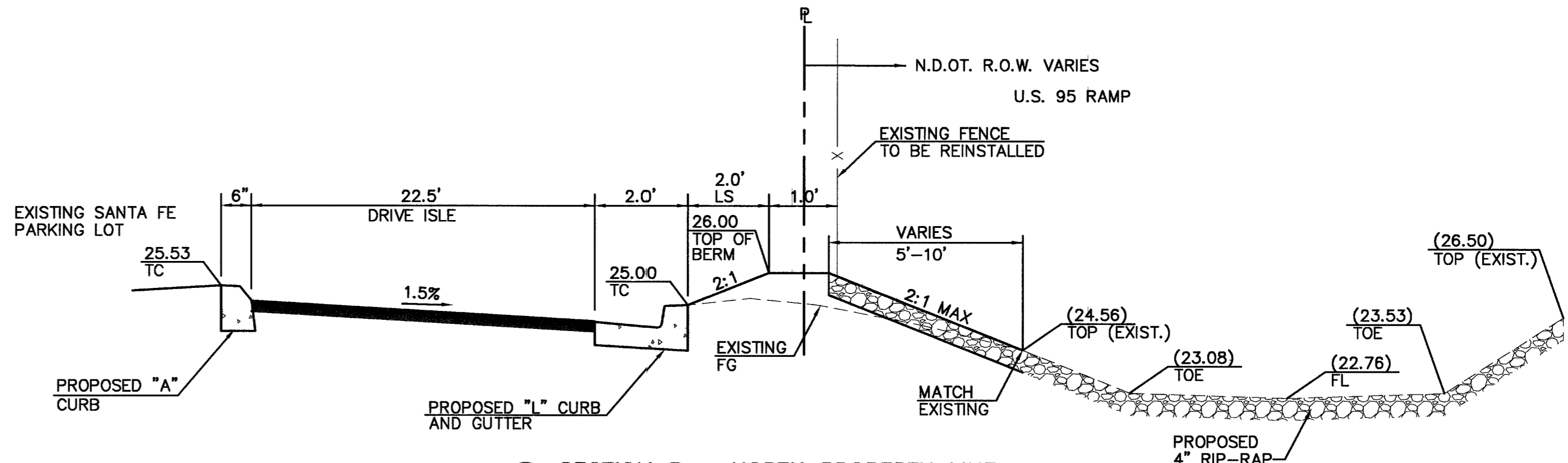

B SECTION B - NORTH PROPERTY LINE N.T.S.

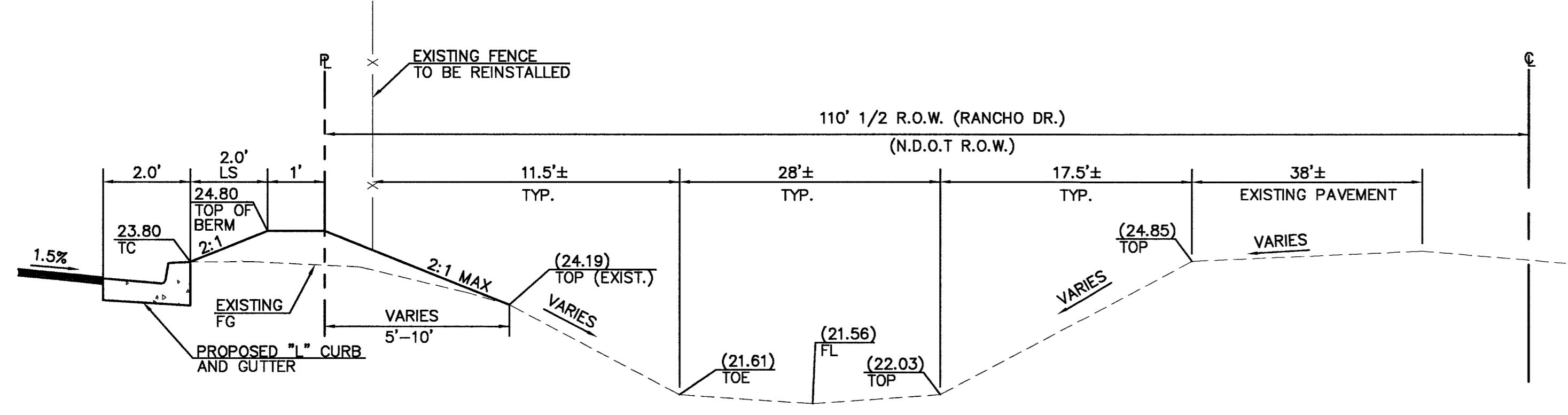

C SECTION C - EAST PROPERTY LINE N.T.S.

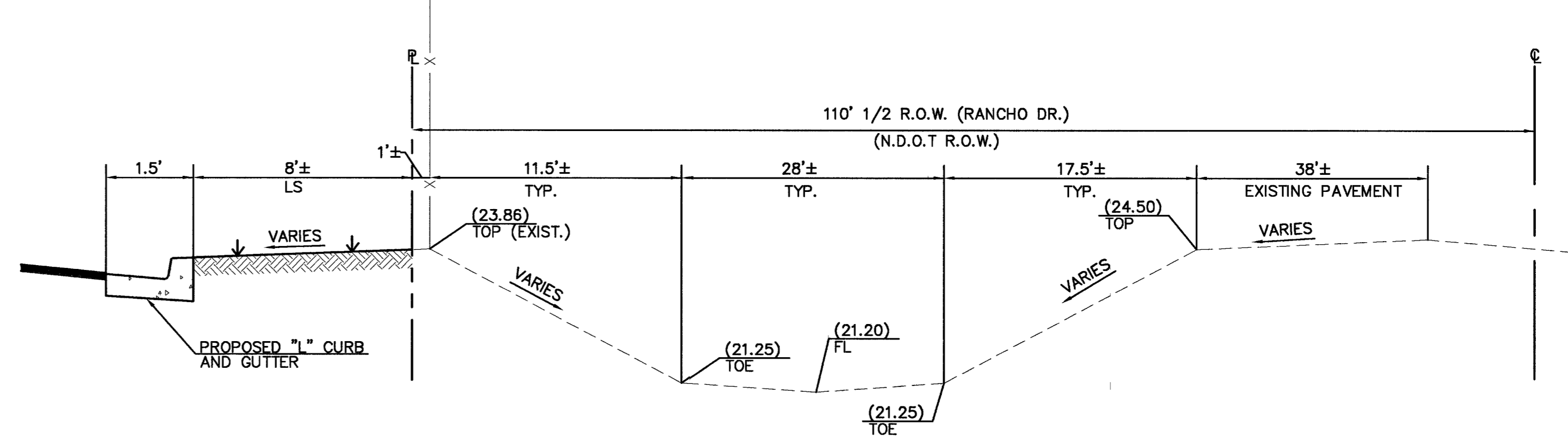

D SECTION D - EAST PROPERTY LINE N.T.S.

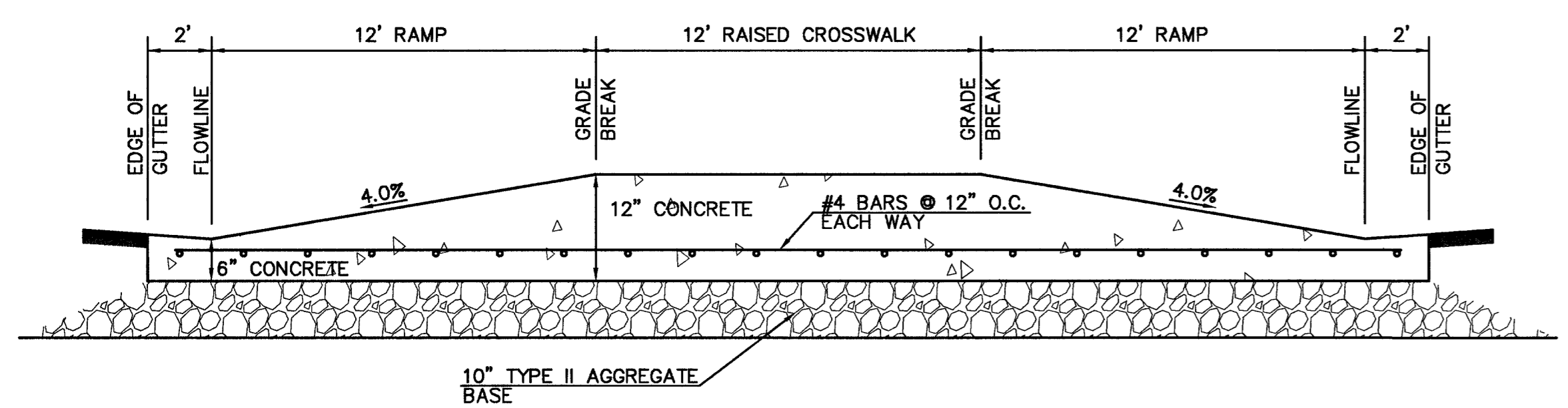

E SECTION E - RAISED CROSSWALK/SPEED HUMP N.T.S.

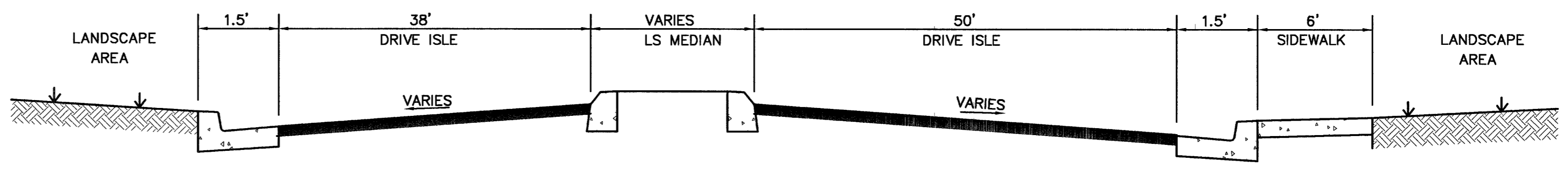

F SECTION D - ENTRANCE DRIVE N.T.S.

**SAFETY ALERT**  
 Call Before You Overhead  
 1-800-509-8111

Avoid cutting underground utility lines. It's costly.  
**Call before you Dig**  
 1-800-997-9800

REV	DATE	BY	REVISION

**STATION CASINOS, INC.**  
 3311 MEADE AVENUE  
 LAS VEGAS, NEVADA 89102-7803

**Kimley-Horn and Associates, Inc.**  
 1085 East Flamingo Road  
 Suite 5-210  
 Las Vegas, Nevada 89119  
 Tel. No. (702) 734-5666  
 Fax No. (702) 734-5949

**DETAIL SHEET**  
**SANTA FE STATION CASINO EXPANSION & GARAGE PHASE II**

DRAWN BY: AJO 06/15/06  
 DESIGNED BY: JURW 06/15/06  
 CHECKED BY: JURW 06/15/06  
 PROJECT NO: 13720 WYOMING  
 SCALE: N/A

**JON R. WAKENHUT**  
 6-30-06  
 CIVIL  
 State of Nevada  
 License No. 13720 WYOMING

SHEET 13 OF 14 SHEETS  
 CLV No. 13720 WYOMING

95093  
 15-0006-11-17-07 / User: k\k\02245 ISA 000 Santa Fe North Expansion\CADD\4500001.dwg / Plot: X5450001B  
 document, together with the concepts and designs presented herein, is intended only for the specific purpose and client for which it was prepared. Release of and improper reliance on this document without written authorization and approval by Kimley-Horn and Associates, Inc. shall be without liability to Kimley-Horn and Associates, Inc.