

BENCH MARK
 B M 06231D6 Sunrise &
 Kathy Jo, NW Cor.
 Elevation: 1764.049

APPROXIMATE QUANTITIES - THIS SHEET			
ITEM	DESCRIPTION	UNIT	QUANTITY
121251C	51" R.C.P.	L.F.	1812
121513B	51" R.C.P. 30° BEND 4X4	EA.	2
121514B	51" R.C.P. 45° BEND 4X4	EA.	2
340114R	REMOVE & REPLACE CONCRETE VALLEY GUTTERS & SIDEWALK	LS	
	MANHOLE NO. 7	LS	
	MANHOLE NO. 8	LS	
	MANHOLE NO. 9	LS	

1770										1770		
1760										1760		
1750	MATCH LINE	253.53 L.F. 51" R.C.P. @ 0.18%		369.24 L.F. 51" R.C.P. 0.18% (M.H. TO M.H.)		360.45 L.F. 51" R.C.P. @ 0.18%		MATCH LINE		1750		
		93+20.57 C67+41.75		68+84.71 C68+84.71		72+97.91 C71+97.91						
		92	93	68	69	70	71	72	73	74	75	76

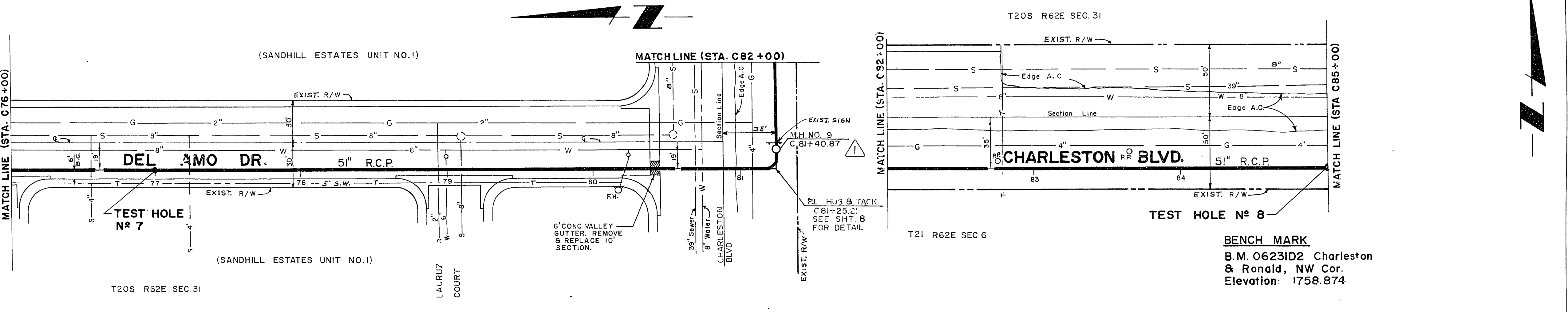

BENCH MARK
 B.M. 06231D2 Charleston
 & Ronald, NW Cor.
 Elevation: 1758.874

EXISTING UTILITIES ARE LOCATED ON THE PLANS FOR THE CONVICTIONS OF THE CORPORATION ONLY. THE CITY ENGINEER SHALL BE RESPONSIBLE FOR THE LOCATION OF UTILITIES AND THE CITY ENGINEER SHALL BE RESPONSIBLE FOR THE LOCATION OF UTILITIES NOT SHOWN ON THE PLANS OR NOT IN THE LOCATION SHOWN ON THE PLANS.

CONTRACT DRAWING
 DATE 23 AUG 2012

BID NO 72-13-72.63 CONTRACT NO 963-13

1770											1770
1760											1760
1750	MATCH LINE	515.55 L.F. 51" R.C.P. @ 0.18%		353.13 L.F. 51" R.C.P. @ 0.18%				MATCH LINE			1750
		76	77	78	79	80	81	82	83	84	85

NO.	DESCRIPTION	BY	DATE	APPROVAL
	CHANGE M.H. #7 & 9 STATIONING. CHANGE QUANTITY OF 51" R.C.P.	M.G.	8-2-72	

REVISIONS

CITY OF LAS VEGAS NEVADA
 DEPARTMENT OF PUBLIC WORKS
 SERVICES DIVISION

SANDHILL INTERCEPTOR
 WASHINGTON (ON SANDHILL) TO
 CHARLESTON (1/5 MILE WEST OF LAMB)

W.O. NO. 317	DATE	DRAWING NO.
SC. (H) 1" = 40'	3-7-72	307-V445
DES. Dave McGonegle	APPROVED BY DIRECTOR OF PUBLIC WORKS	SHEET 5 OF 9

3-24-72

20-1-94