

REVISIONS	
DATE	
BY	
DESCRIPTION	

CONSULTANT	
OWNER	
PROJECT	

SANDHILL OWENS PARK & TRAILHEAD  
LAS VEGAS, NEVADA

STAMP	
DATE	
BY	
DESCRIPTION	

OWNER: CITY OF LAS VEGAS  
DEPARTMENT OF PUBLIC WORKS  
CAPITAL PROJECT MANAGEMENT SECTION

400 EAST STEWART AVENUE  
LAS VEGAS, NEVADA 89101  
PHONE: (702) 229-5535  
FAX: (702) 384-8846  
TDD: (702) 386-9108

DATE: 12/7/2009  
SCALE: 1"=20'  
BID NO: 08168411  
CLV CDE NO:

ES1

DEPARTMENT OF PUBLIC WORKS

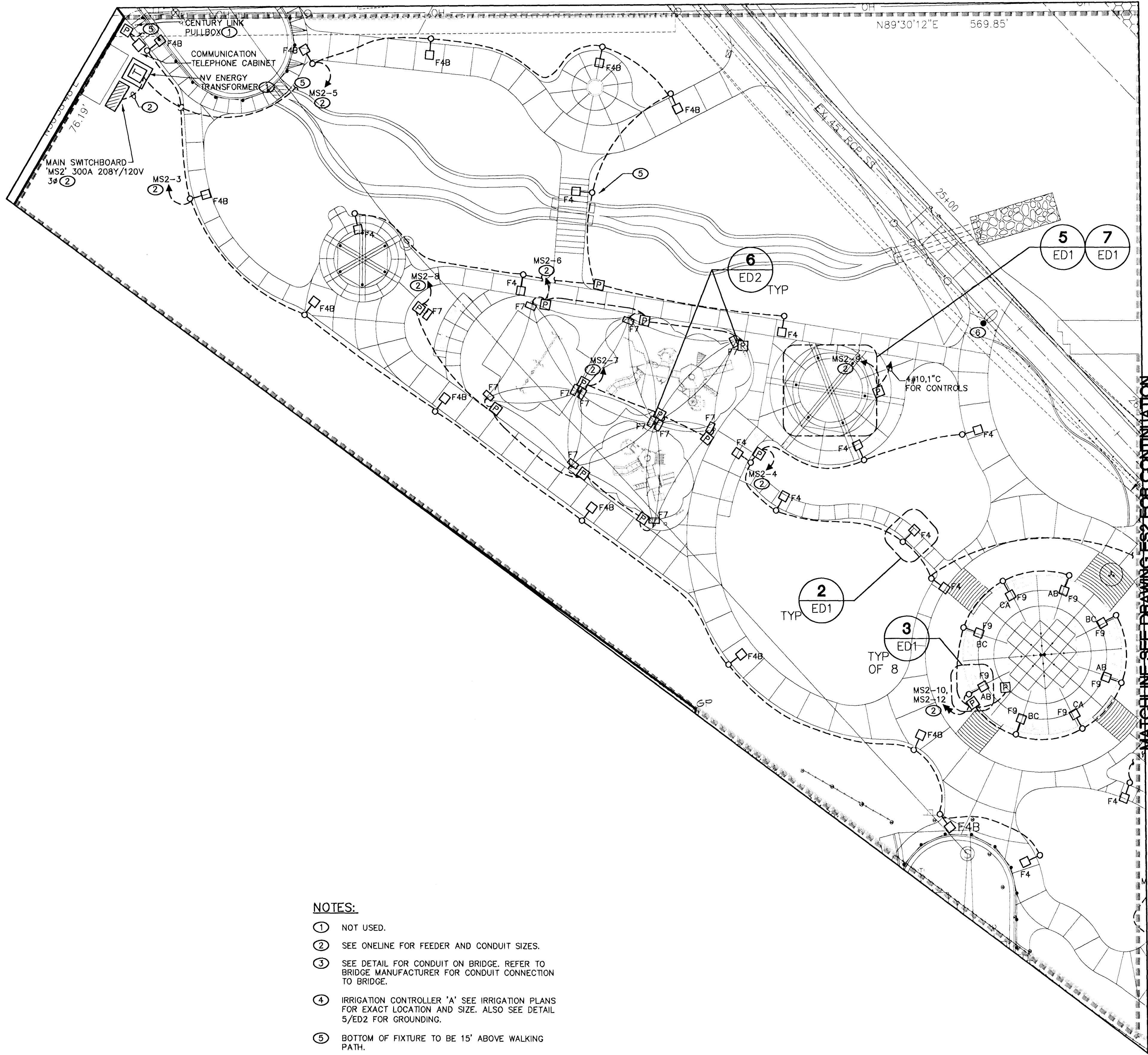

MATCHLINE SEE DRAWING ES2 FOR CONTINUATION

**GENERAL NOTES:**

1. ALL PULLBOXES WILL BE NO. 3 1/2 UNLESS NOTED OTHERWISE. GROUNDING PER NEC 250 SEE DETAIL 8/ED1 FOR FURTHER INFORMATION.
2. REFER TO CIVIL PLANS FOR EXACT LOCATIONS OF POLES.

**NOTES:**

1. NOT USED.
2. SEE ONELINE FOR FEEDER AND CONDUIT SIZES.
3. SEE DETAIL FOR CONDUIT ON BRIDGE, REFER TO BRIDGE MANUFACTURER FOR CONDUIT CONNECTION TO BRIDGE.
4. IRRIGATION CONTROLLER 'A' SEE IRRIGATION PLANS FOR EXACT LOCATION AND SIZE. ALSO SEE DETAIL 5/ED2 FOR GROUNDING.
5. BOTTOM OF FIXTURE TO BE 15' ABOVE WALKING PATH.
6. REMOVE THE EXISTING FIXTURES, CONDUIT, AND CONDUCTORS BACK TO THE NEAREST SOURCE AND COORDINATE WITH DRAWING C.3 FOR FIXTURE LOCATIONS. REPLACE WITH THE SAME SIZE CONDUIT AND CONDUCTORS WITH NEW CONDUIT AND CONDUCTORS CONNECT TO SAME EXISTING CIRCUIT. AVOID ALL NEW EQUIPMENT AS SHOWN ON DRAWINGS.

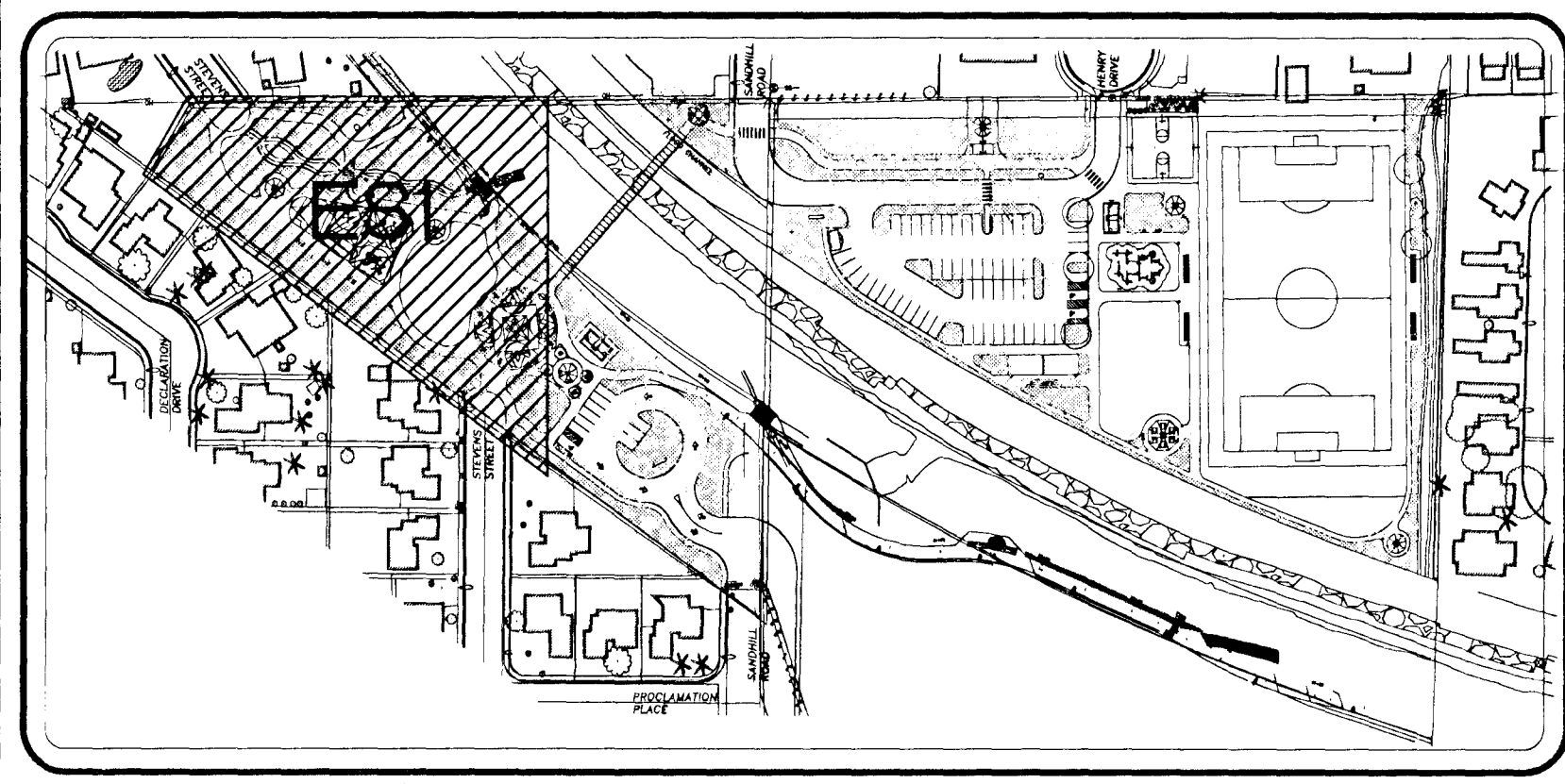

**KEY MAP**  
NOT TO SCALE

THESE RECORD DOCUMENTS HAVE BEEN PREPARED BASED ON INFORMATION PROVIDED BY OTHERS. THE DESIGN PROFESSIONAL HAS NOT VERIFIED THE ACCURACY AND/OR COMPLETENESS OF THIS INFORMATION AND SHALL NOT BE RESPONSIBLE FOR ANY ERRORS OR OMISSIONS WHICH MAY BE INCORPORATED HEREIN AS A RESULT.

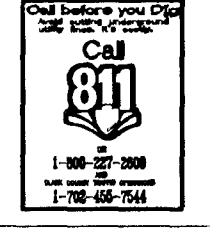

12-0-250