

**2 SYNTHETIC TURF (BOTH SIDES OF CONC. HEADER)** SCALE: 1/4" = 1'-0"

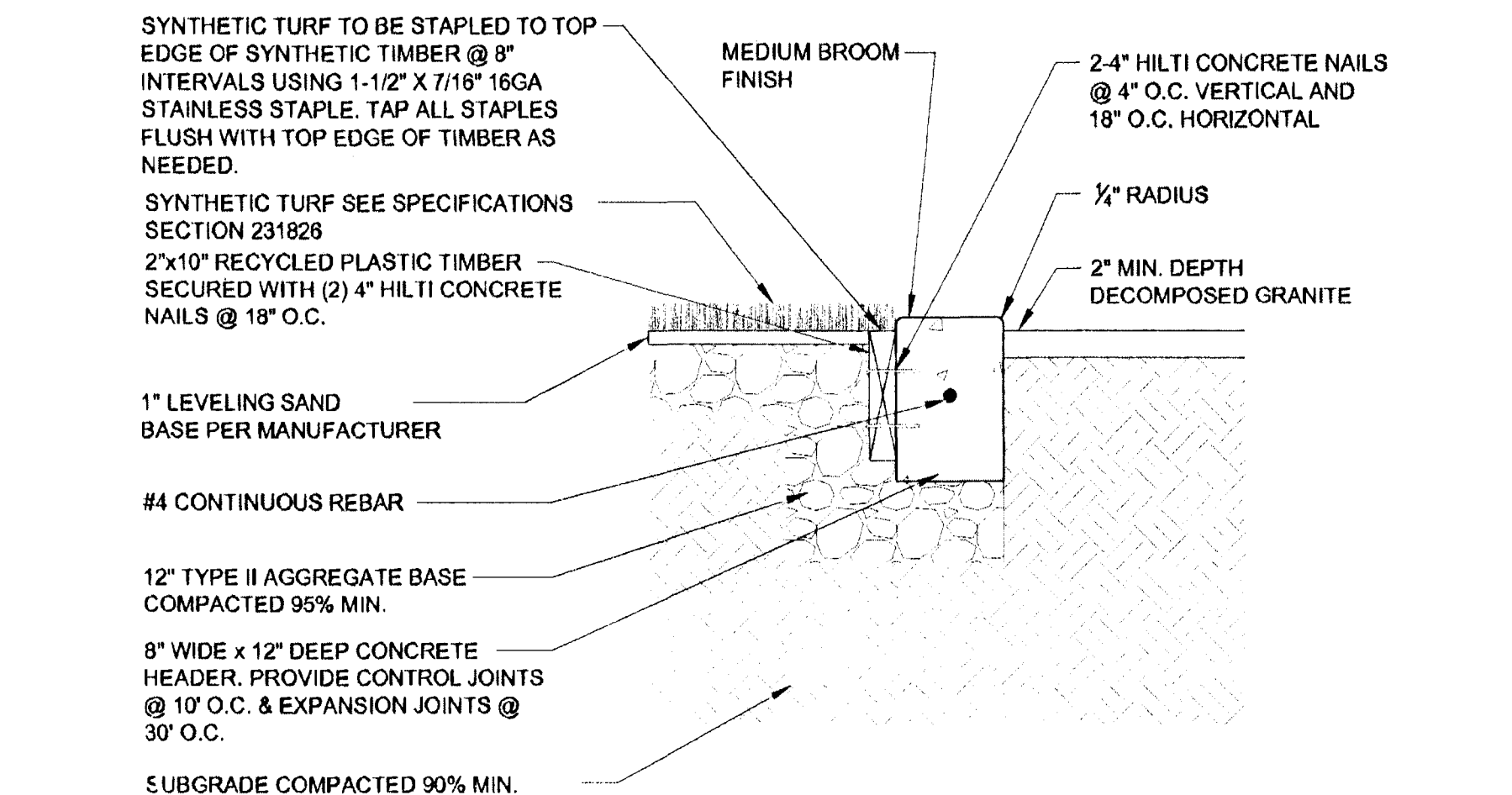

**3 SYNTHETIC TURF (ONE SIDE OF CONC. HEADER)** SCALE: 1/4" = 1'-0"

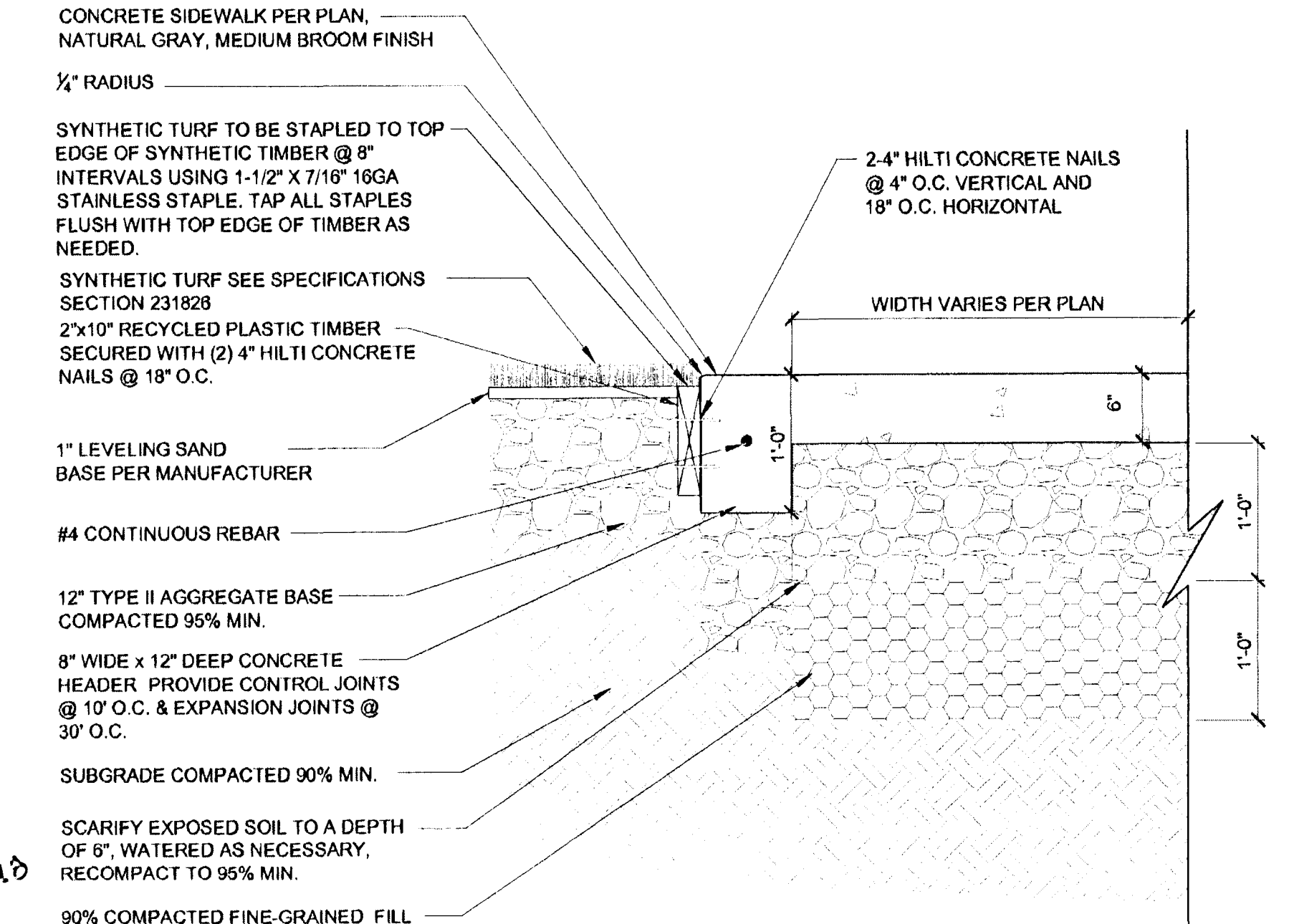

**4 SYNTHETIC TURF (@ CONC. WALKWAY)** SCALE: 1" = 1'-0"

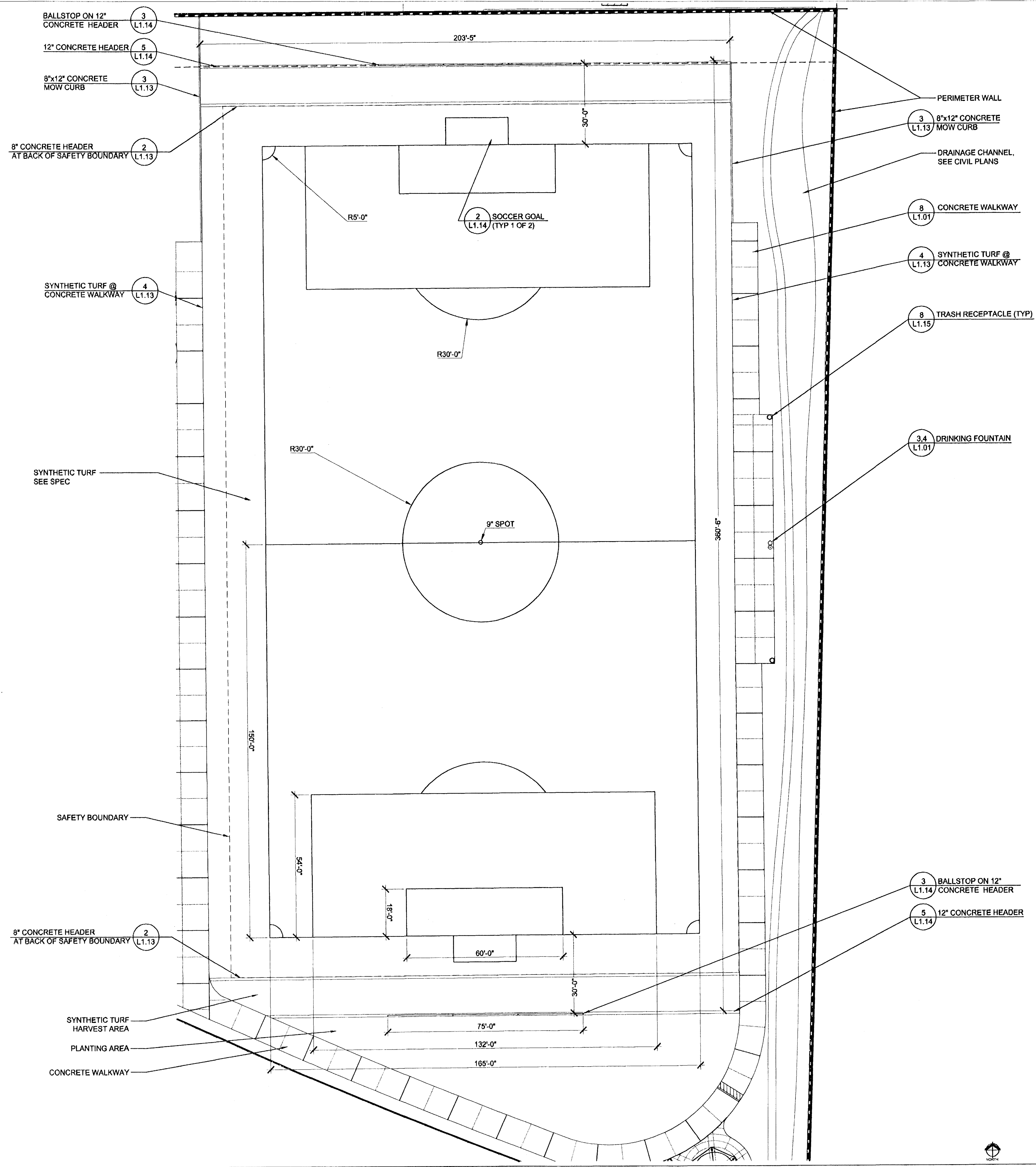

**1 SOCCER FIELD LAYOUT** SCALE: 1" = 20'-0"



**100% SUBMITTAL**  
**DEPARTMENT OF PUBLIC WORKS**  
**CONSULTANT**  
**Gardno WRG**  
 LAS VEGAS  
 10649 JEFFREYS ST., HENDERSON, NV 89052  
 TEL: (702) 860-8300 FAX: (702) 860-8305  
 www.gardnowrg.com  
 PLANNERS • ENGINEERS • LANDSCAPE ARCHITECTS • SURVEYORS

**SANDHILL OWENS PARK & TRAILHEAD**  
 LAS VEGAS, NEVADA  
**SITE DETAILS**

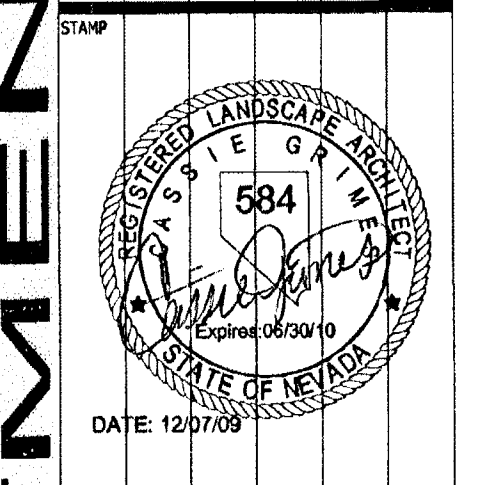

DATE: 12/07/09

OWNER: CITY OF LAS VEGAS  
 DEPARTMENT OF PUBLIC WORKS  
 CAPITAL PROJECT MANAGEMENT SECTION

400 EAST STEWART AVENUE  
 LAS VEGAS, NEVADA 89101  
 PHONE: (702) 229-8535  
 FAX: (702) 384-4846  
 TDD: (702) 386-9109

|            |               |
|------------|---------------|
| DRAWN      | CGP/UTL       |
| FILE       | CLV3087937.01 |
| DATE       | 12-07-2009    |
| SCALE      | AS NOTED      |
| BID NO     | 09.15341.11   |
| CLV DWG NO | 658.104       |
| SIT NO     |               |

L1.13