

3 FITNESS EQUIPMENT COMPONENT LAYOUT PLAN

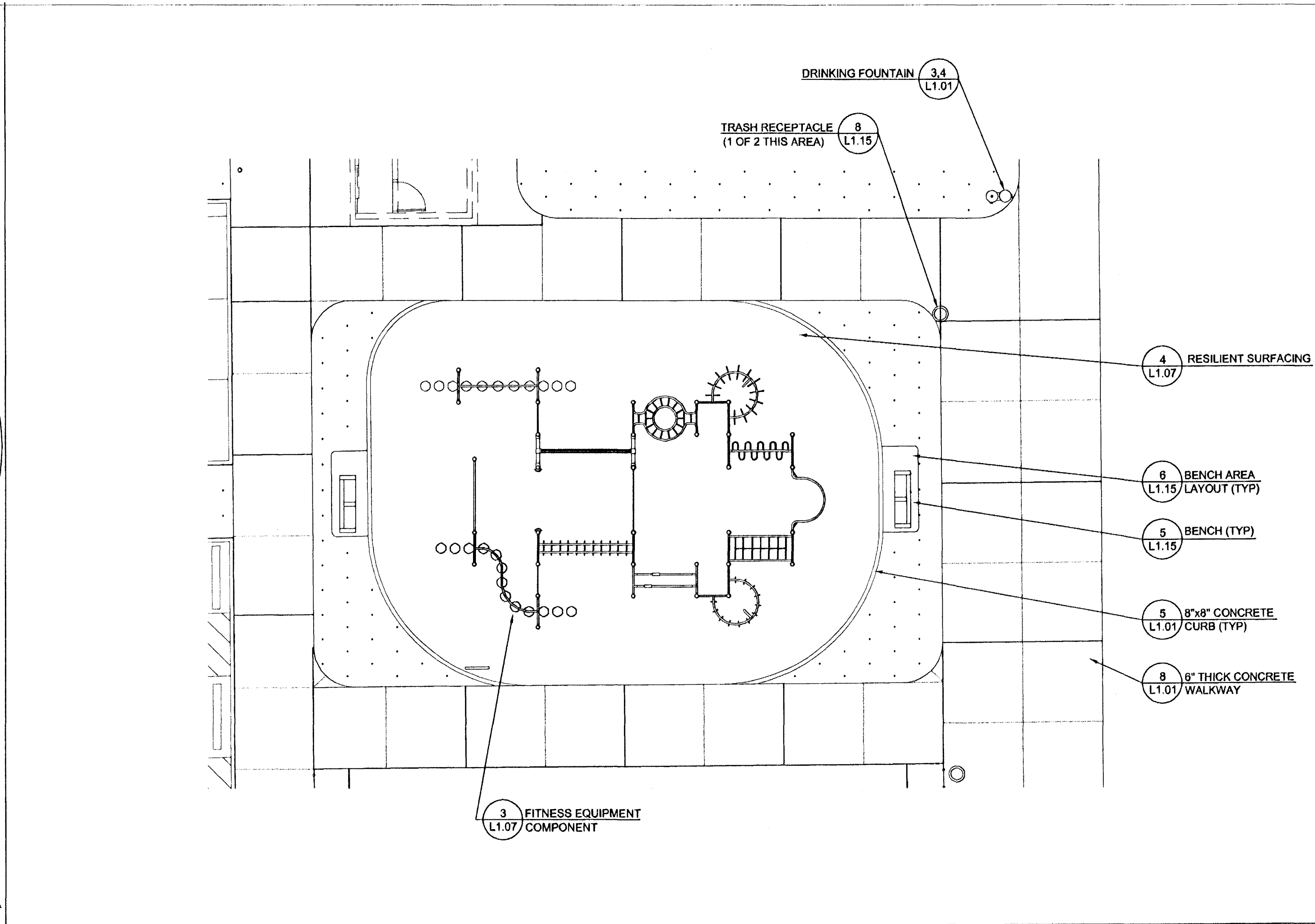

1 FITNESS AREA LAYOUT

123212

FITNESS EQUIPMENT COLOR LEGEND

714-773-2	GREEN
714-552	GREEN
714-843-5	YELLOW
714-858-1	YELLOW
714-732-2R2	GREEN & YELLOW
714-734	GREEN & YELLOW
714-815-5	GREEN
714-782	GREEN
714-754-12	YELLOW
714-722-125	YELLOW
714-911	GREEN
714-944-5	YELLOW
714-918-24	YELLOW
714-884-C5	YELLOW
714-709-C5	YELLOW
714-791-5	YELLOW
787	YELLOW
714-764-5	YELLOW

5 FITNESS EQUIPMENT COLOR LEGEND

NOTES:

- OWNERS REPRESENTATIVE SHALL APPROVE FORMWORK PRIOR TO PLACING CONCRETE.
- CONCRETE UNDERNEATH FITNESS EQUIPMENT IS TO BE TYPE V. 2500 PSI AT 28 DAYS MINIMUM.
- ALL SPILL OF EXCESS CONCRETE SHALL BE CLEANED UP AND REMOVED FROM SITE BY THE CONTRACTOR.
- GRADING AT CURB SHALL BE BY THE CONTRACTOR.
- CONTRACTOR SHALL INSTALL SAFETY SURFACE AS PER MANUFACTURER'S SPECIFICATIONS AND RECOMMENDATIONS.
- SBR CUSHION PAD DEPTH SHALL BE DETERMINED BY SAFETY SURFACE MANUFACTURER BASED ON THE FITNESS EQUIPMENT FALL HEIGHT.
- RESILIENT FITNESS AREA SURFACE TO BE 1/3, 1/3, 1/3 MIX OF BLACK, BEIGE AND GREEN IN EQUAL PROPORTIONS.
- MANUFACTURER: TOT TURF, 7665 COMMERCIAL WAY, SUITE H HENDERSON, NV 89015. 702-303-8701 OR APPROVED EQUAL.

4 RESILIENT SURFACE INSTALLATION NOTES

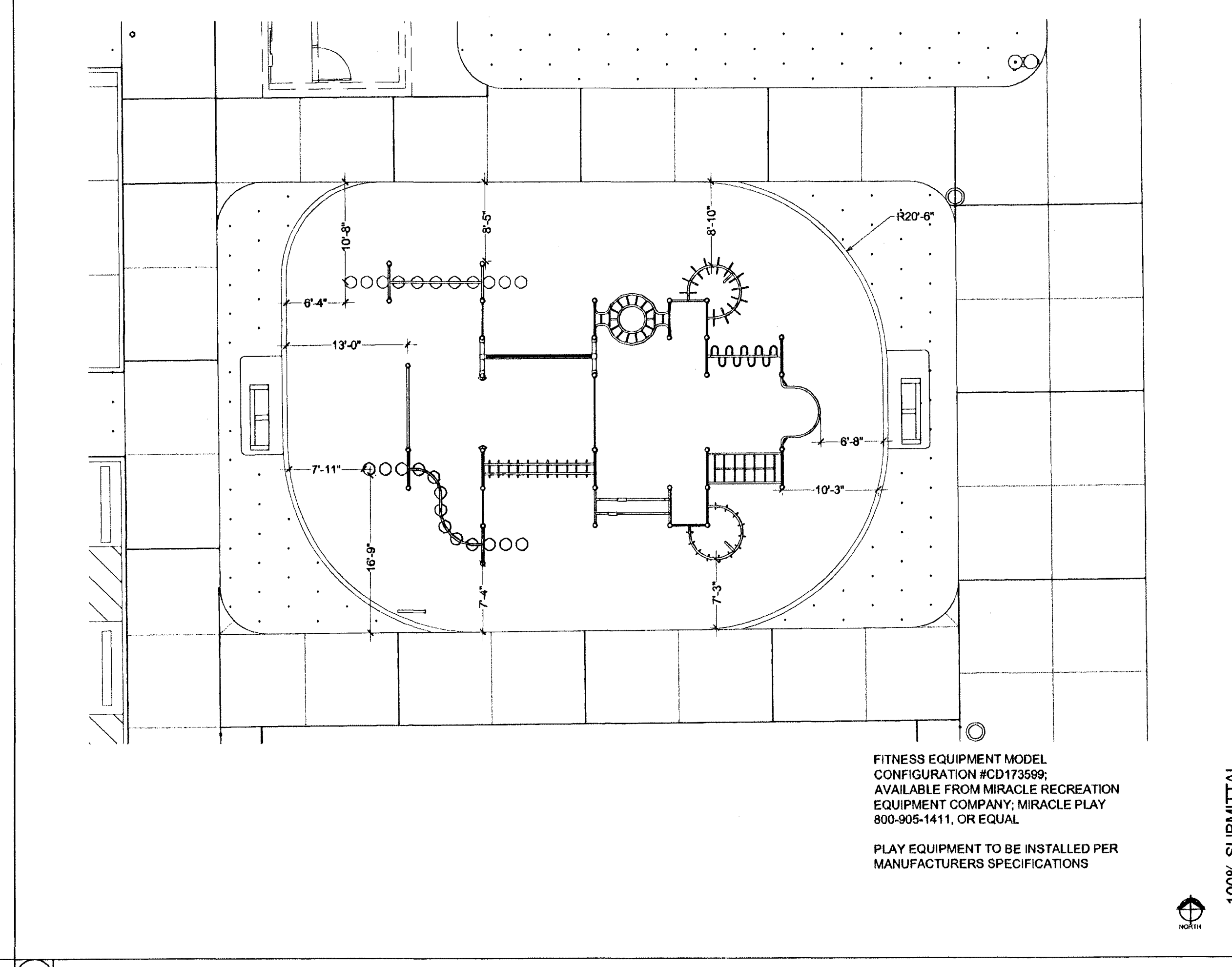

2 FITNESS EQUIPMENT LAYOUT DIMENSION PLAN

CITY OF LAS VEGAS
NEVADA

REVISIONS

CONSULTANT
Cardno WRG
LAS VEGAS
1089 LEFFERTS ST., HENDERSON, NV 89002
TEL: (702) 580-8000 FAX: (702) 580-8005
www.cardnowrg.com
OWNERS - ENGINEERS - LANDSCAPE ARCHITECTS - SURVEYORS

SANDHILL OWENS PARK & TRAILHEAD
LAS VEGAS, NEVADA

DEPARTMENT OF PUBLIC WORKS

REGISTERED LANDSCAPE ARCHITECT
584
STATE OF NEVADA
DATE: 12/07/09

OWNER: CITY OF LAS VEGAS
DEPARTMENT OF PUBLIC WORKS
CAPITAL PROJECT MANAGEMENT SECTION

400 EAST STEWART AVENUE
LAS VEGAS, NEVADA 89101
PHONE: (702) 222-6535
FAX: (702) 384-8846
(702) 386-9108

DRAWN: CG/DFL
FILE: CLV308937.01
DATE: 12-07-2009
SCALE: AS NOTED
SHEET NO: 09.1534.11
CLV DWG NO: 650.104

100% SUBMITTAL

SHEET NO: L1.07

SCALE: 1" = 10'-0"