

KEY MAP
NORTH NOT TO SCALE

CONSTRUCTION NOTES

- 1 "L" TYPE CURB AND GUTTER PER CCAUSD #216, SEE SHEET C.13
- 2 6" CURB PER DETAIL "3" SHEET C.12
- 3 TRANSITION 0" CURB FACE TO 6" CURB FACE
- 4 4" CONCRETE OVER 6" TYPE II AGGREGATE BASE COMPACTED TO 95% MODIFIED PROCTOR
- 5 EXISTING "L" TYPE CURB AND GUTTER PER CCAUSD No. 216, SEE SHEET C.13
- 6 LANDSCAPE AREA - REFER TO LANDSCAPE PLANS (TYP)
- 7 INSTALL LIGHT PAVEMENT SECTION 2.5" AC ON 6" TYPE II A.B. COMPACTED TO 95% MODIFIED PROCTOR
- 8 INSTALL HEAVY PAVEMENT SECTION 3.5" AC ON 6" TYPE II A.B. COMPACTED TO 95% MODIFIED PROCTOR
- 9 INSTALL 8" CROSS GUTTER PER CCAUSD #228, SEE SHEET C.13
- 10 CONSTRUCT ADA ACCESSIBLE HANDICAP RAMP CASE 1 PER CCAUSD #235 A=B UNLESS OTHERWISE NOTED, SEE SHEET C.13
- 11 INSTALL PAVEMENT SECTION 3.5" AC ON 6.5" TYPE II A.B. COMPACTED TO 95% MODIFIED PROCTOR
- 12 INSTALL BOLLARDS WITH CHAIN SPACED @ 12" MAX PER DETAIL "8" SHEET C.12 REMOVABLE CHAIN LOCK FOR MAINTENANCE ACCESS
- 13 CONSTRUCT SIDEWALK TO MATCH GRADE OF EXISTING WALK
- 14 INSTALL HEAVY CONCRETE PAVEMENT SECTION 6" CONCRETE ON 6" TYPE II A.B. COMPACTED TO 95% MODIFIED PROCTOR
- 15 CONSTRUCT DECORATIVE BLOCK WALL (SEE STRUCTURAL PLANS FOR DETAILS)
- 16 MOW CURB, SEE LANDSCAPE DRAWINGS (TYP)
- 17 INSTALL CURB STOP PER CCAUSD #238 (TYP)

GRADING NOTES:

1. CONTRACTOR SHALL VERIFY AND CORRECT PRIOR TO CONSTRUCTION.
2. CONSTRUCTION MANAGER SHALL BE NOTIFIED IMMEDIATELY OF ANY DISCREPANCY IN THE PLANS OR CONDITIONS IN THE FIELD.
3. ALL SLOPE AREAS SHALL HAVE A MINIMUM ONE FOOT BENCH PRIOR TO STARTING SLOPE.
4. ALL WORK TO BE PERFORMED OUTSIDE OF THE PROJECT BOUNDARY AND ON PRIVATE PROPERTY SHALL NOT BE PERFORMED WITHOUT COORDINATION WITH PROPERTY OWNERS. PROPERTY OWNERS MUST HAVE AT LEAST 72 HOURS NOTICE PRIOR TO WORK ON THEIR PROPERTY.

FLOOD ZONE DESCRIPTION:

THIS SITE IS LOCATED IN ZONE "AE", SHADED ZONE "X", AND ZONE "X". ZONE "AE" IS DESCRIBED AS AREAS DETERMINED TO BE WITHIN THE 100-YEAR FLOOD PLAIN, WITH KNOWN BASE FLOOD ELEVATIONS. SHADED ZONE "X" ARE AREAS OF 0.2% ANNUAL CHANCE FLOOD; AREAS OF 1% ANNUAL CHANCE FLOOD WITH AVERAGE DEPTHS OF LESS THAN 1 FOOT OR WITH DRAINAGE AREAS OF LESS THAN 1 SQUARE MILE; AND AREAS PROTECTED BY LEVEES FROM 1% ANNUAL CHANCE FLOOD. ZONE "X" ARE AREAS DETERMINED TO BE OUTSIDE THE 0.2% ANNUAL CHANCE FLOOD PLAIN, PER THE FLOOD INSURANCE RATE MAP COMMUNITY PANEL 32003C2187 E. CLARK COUNTY, NEVADA DATED SEPTEMBER 27, 2002.

FLOOD DESIGNATION PROVIDED BY FEDERAL EMERGENCY MANAGEMENT AGENCY (FEMA).

CERTIFICATION:

I CERTIFY THAT THIS GRADING PLAN CONFORMS TO THE APPROVED DRAINAGE STUDY FOR THIS SITE ON FILE AT THE CITY OF LAS VEGAS, DS4367
 ROBERT F. HARMISMA P.E. #12855
 DATE: NOVEMBER 17, 2009

BASIS OF BEARINGS:

NORTH 88°51'23" EAST, BEING THE NORTH LINE OF THE NORTHEAST QUARTER (NE 1/4) OF SECTION 30, TOWNSHIP 20 SOUTH, RANGE 62 EAST, M.D.M., CLARK COUNTY, NEVADA AS SHOWN BY MAP IN THE OFFICE OF THE CLARK COUNTY, NEVADA RECORDER IN FILE 88, OF SURVEYS, PAGE 44.

BENCHMARK:

CITY OF LAS VEGAS STATION 2LV02 30N6.
 RIVET AND PLATE IN TOP OF CURB ON WEST SIDE OF SANDHILL +/- 100 FT. NORTH OF PROCLAMATION.

ELEVATION:
 FEET = 1796.53' (NAVD08)
 METERS = 547.583 m (NAVD08)

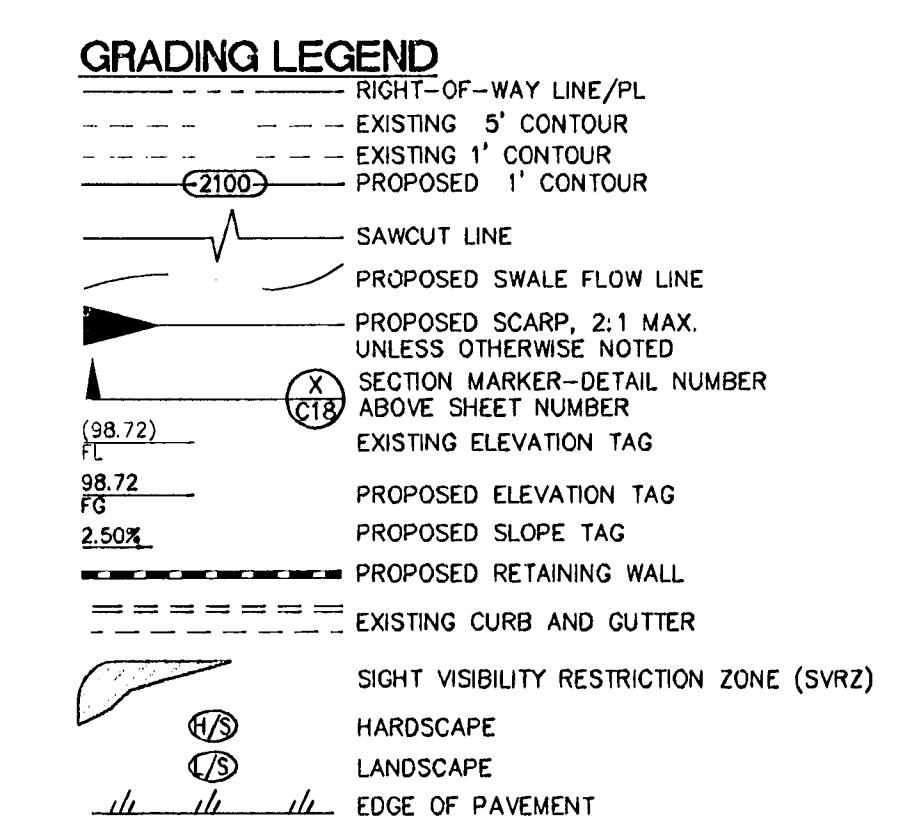
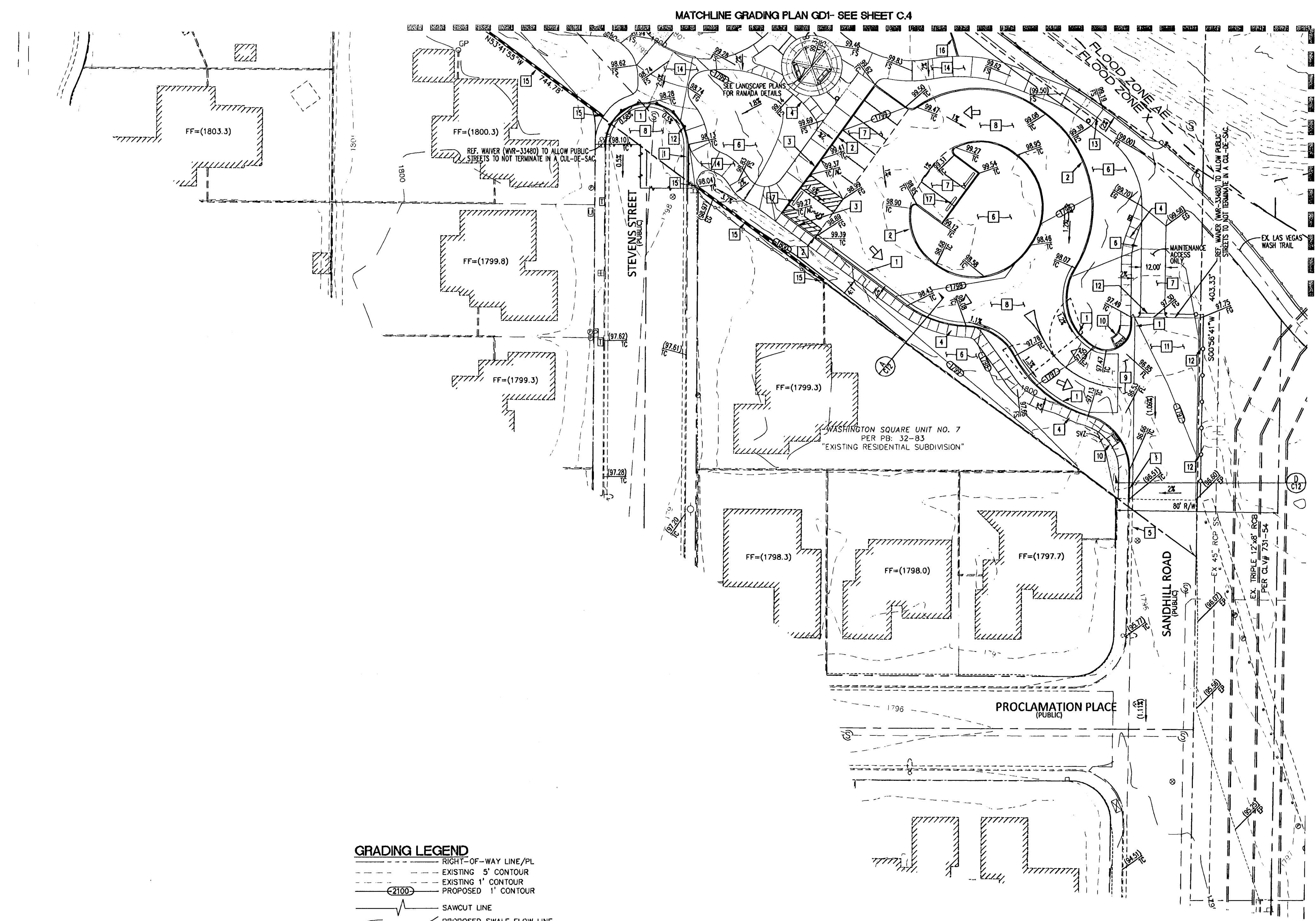

DISCLAIMER NOTE:
 UTILITY LOCATIONS SHOWN HEREON ARE APPROXIMATE ONLY. IT SHALL BE THE CONTRACTOR'S RESPONSIBILITY TO DETERMINE THE EXACT HORIZONTAL AND VERTICAL LOCATION OF ALL EXISTING UNDERGROUND UTILITIES PRIOR TO COMMENCING CONSTRUCTION. NO REPRESENTATION IS MADE THAT ALL EXISTING UTILITIES ARE SHOWN HEREON. THE ENGINEER ASSUMES NO RESPONSIBILITY FOR UTILITIES NOT SHOWN OR UTILITIES NOT SHOWN IN THEIR PROPER LOCATION.

CALL BEFORE YOU DIG
 1-800-227-2690
 1-702-455-7544

DEPARTMENT OF PUBLIC WORKS

CONTRACT NO. 2009-001

CONSULTANT: **Cardno WRG**
 LAS VEGAS
 10860 JEFFERSON ST. HENDERSON, NV 89002
 TEL: (702) 580-6800 FAX: (702) 580-6806
 PLANNERS • ENGINEERS • LANDSCAPE ARCHITECTS • SURVEYORS

SANDHILL OWENS PARK & TRAILHEAD
 LAS VEGAS, NEVADA
 GRADING PLAN GD2

PROFESSIONAL ENGINEER - STATE OF NEVADA
 ROBERT F. HARMISMA
 CIVIL
 No. 12855

OWNER: CITY OF LAS VEGAS
 DEPARTMENT OF PUBLIC WORKS
 CAPITAL PROJECT MANAGEMENT SECTION

DRAWN	BIL
FILE	7937_SRAID
DATE	11/20/09
SCALE	1"=30'
DWG NO	09.15.541.11
CLV DWG NO	650.104
HANSEN #	29225 267885, & 26729
SHT NO	C.5