

CASHDAN
 3101 S. MARYLAND PARKWAY SUITE 210
 LAS VEGAS, NEVADA 89109
 (702) 735-7895 FAX (702) 735-3190

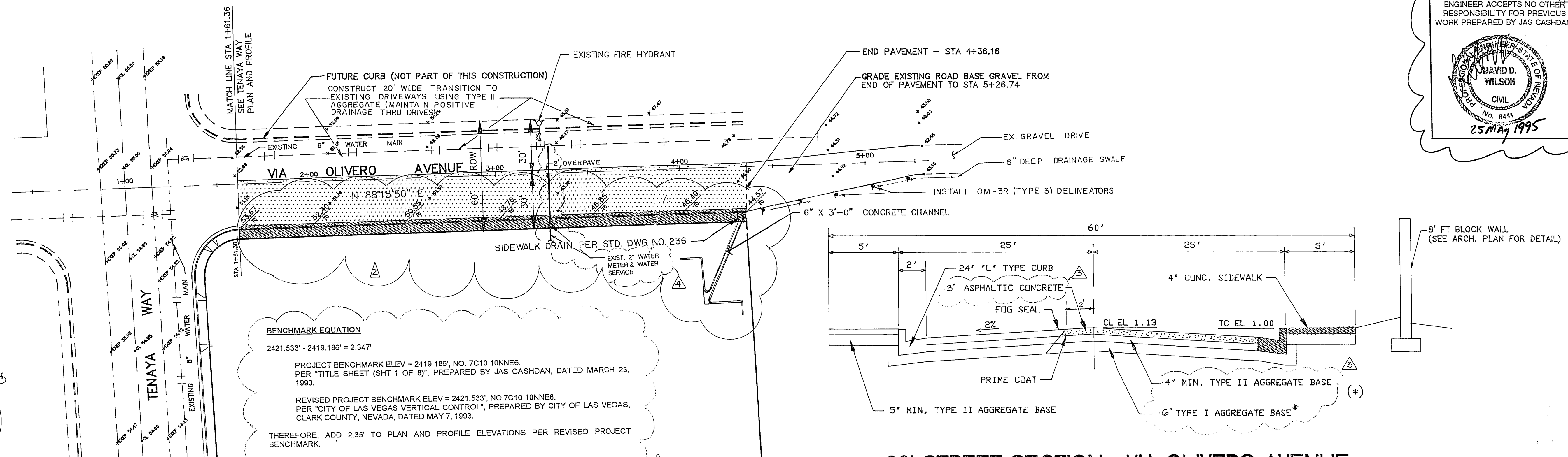

BENCHMARK EQUATION
 $2421.533' - 2419.186' = 2.347'$

PROJECT BENCHMARK ELEV = 2419.186', NO. 7C10 10NNE6.
 PER "TITLE SHEET (SHT 1 OF 8)", PREPARED BY JAS CASHDAN, DATED MARCH 23, 1990.

REVISED PROJECT BENCHMARK ELEV = 2421.533', NO. 7C10 10NNE6.
 PER "CITY OF LAS VEGAS VERTICAL CONTROL", PREPARED BY CITY OF LAS VEGAS, CLARK COUNTY, NEVADA, DATED MAY 7, 1993.

THEREFORE, ADD 2.35' TO PLAN AND PROFILE ELEVATIONS PER REVISED PROJECT BENCHMARK.

60' STREET SECTION - VIA OLIVERO AVENUE
 (SEE STANDARD DWG. NO. 205)

* NATIVE MATERIAL MAY BE USED IN LIEU OF STANDARD TYPE I GRAVEL WITH REF. SOILS REPORT FOR SPECIFIC CONDITIONS WHERE THIS MAY APPLY.
 PRIOR APPROVAL OF THE CITY ENGINEER, CONTACT C.L.V. QUALITY CENTRE FOR COORDINATION (386-6227)

NOTE: REFERENCE SOILS REPORT PREPARED BY WESTERN TECHNOLOGIES, INC. FOR ASPHALT PAVEMENT THICKNESS AND BASECOURSE TYPE/THICKNESS.

GENERAL NOTE: ALL CONSTRUCTION SHALL CONFORM TO CITY OF LAS VEGAS STANDARDS AND SPECIFICATIONS AND TO THE UNIFORM STANDARD DRAWINGS AND SPECIFICATIONS FOR PUBLIC WORKS' CONSTRUCTION OFF-SITE IMPROVEMENTS, CLARK COUNTY AREA, NEVADA, 1986.

SCALE 1" = 30'

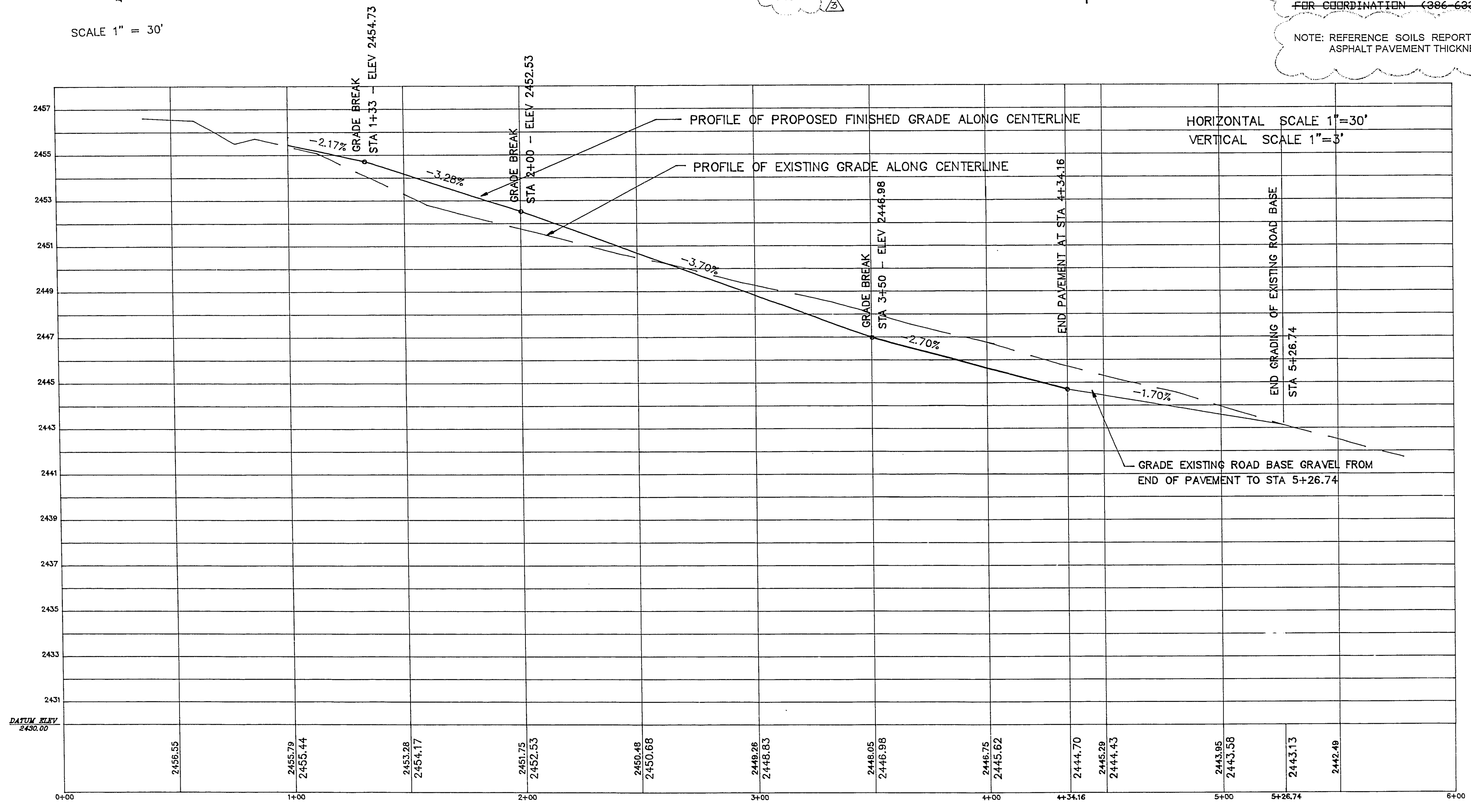

LEGEND

- PROPOSED CURB, GUTTER, & SIDEWALK
- PROPOSED ASPHALTIC CONCRETE PAVEMENT
- EXISTING A. C. PAVEMENT TO BE REMOVED

- CITY OF LAS VEGAS SANITARY SEWER NOTES:**
- ALL SANITARY SEWER INSTALLATIONS SHALL CONFORM TO THE STANDARD DETAILS AND SPECIFICATIONS OF THE CITY OF LAS VEGAS, AND SHALL ALSO CONFORM TO THE UNIFORM STANDARD SPECIFICATIONS FOR PUBLIC WORKS CONSTRUCTION OF OFF-SITE IMPROVEMENTS, CLARK COUNTY AREA, LATEST EDITION, UNLESS OTHERWISE NOTED.
 - CHISEL "S" OR "G" IN CURBS WHERE SEWER OR GAS LATERALS PASS UNDER CURB.
 - POLYVINYL (PVC) SEWER PIPE SHALL MEET ASTM D-3034 SDR 35 SPECIFICATIONS, AND BE INSTALLED WITH SAND BEDDING AND BACKFILL OR TYPE II GRAVEL.
 - ALL MANHOLES IN PAVED STREETS WITH 80 FT. R/W AND LARGER, SHALL HAVE CONCRETE COLLARS.
 - TEE SADDLES SHALL BE USED TO CONNECT SEWER LATERALS TO EXISTING MAIN LINES UP TO 12 IN. DIA. SIZE. CONNECTIONS TO 15 IN. OR LARGER MAINS SHALL REQUIRE SPECIAL PROCEDURES.
 - A SEWER MAIN CROSSING OVER A WATER MAIN OR LESS THAN 18 IN. UNDER A WATER MAIN, MUST BE REINFORCED CONCRETE ENCASED PIPE FOR A DISTANCE OF NOT LESS THAN TEN FEET (10') ON EACH SIDE OF THE CENTERLINE OF THE WATER MAIN.
 - ALL NEW (OR EXISTING) MANHOLE COVERS WHICH ARE IN AREAS WHERE NEW PAVING IS PLACED SHALL BE SET (OR ADJUSTED) TO MATCH FINISH GRADE.

REVISIONS:
 1 4-24-90 PER CLV & LVVMD-
 2 6-4-91 DRAINAGE CHANNEL & WALL
 3 5-18-93 REVISED NOTES & UPGRADE ELEVATIONS
 4 6-15-95 REVISED PER LVVMD.

SANT JOSEPH, HUSBAND OF MARY CATHOLIC CHURCH LAS VEGAS, NEVADA
 VIA OLIVERO AVE. PLAN AND PROFILE

DATE: MARCH 23, 1990
 JOB NO: 88-604
 DESIGNED: B.H.
 DRAWN: L.G.A.
 CHKD BY: E.J.F.
 SCALE: 1" = 30'
 sheet: