

SEE SHEETS T1 AND T2
FOR TRAFFIC NOTES

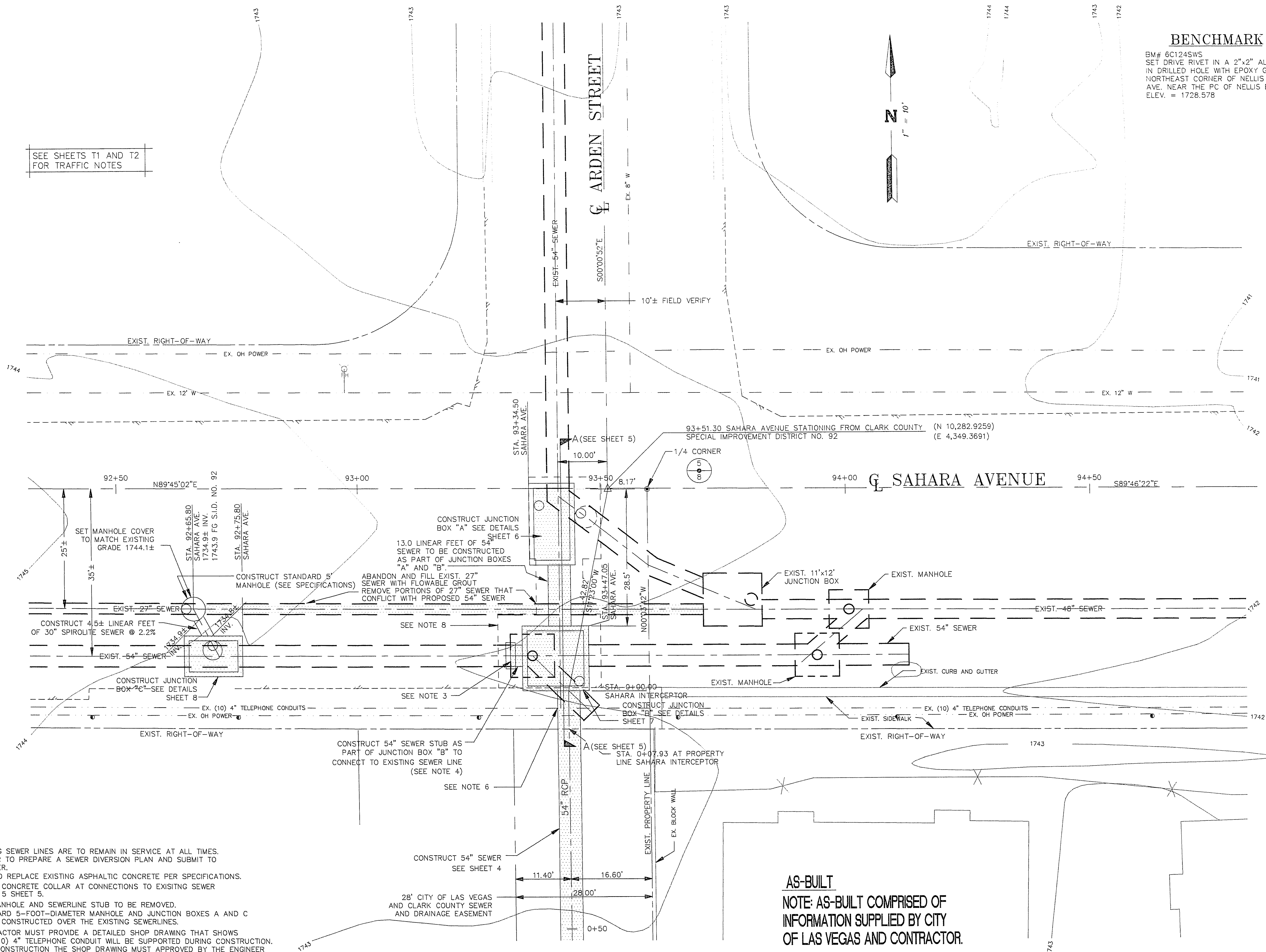

BENCHMARK

BM# 6C124SWS
SET DRIVE RIVET IN A 2"x2" ALUMINUM PLATE,
IN DRILLED HOLE WITH EPOXY GLUE, IN TOP CURB,
NORTHEAST CORNER OF NELLIS BLVD. AND SAHARA
AVE. NEAR THE PC OF NELLIS BLVD.
ELEV. = 1728.578

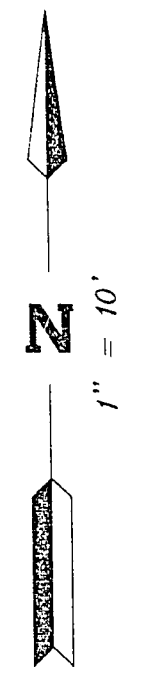

NOTES:

1. ALL EXISTING SEWER LINES ARE TO REMAIN IN SERVICE AT ALL TIMES. CONTRACTOR TO PREPARE A SEWER DIVERSION PLAN AND SUBMIT TO THE ENGINEER.
2. REMOVE AND REPLACE EXISTING ASPHALTIC CONCRETE PER SPECIFICATIONS.
3. CONSTRUCT CONCRETE COLLAR AT CONNECTIONS TO EXISTING SEWER PER DETAIL 5 SHEET 5.
4. EXISTING MANHOLE AND SEWERLINE STUB TO BE REMOVED.
5. THE STANDARD 5-FOOT-DIAMETER MANHOLE AND JUNCTION BOXES A AND C ARE TO BE CONSTRUCTED OVER THE EXISTING SEWERLINES.
6. THE CONTRACTOR MUST PROVIDE A DETAILED SHOP DRAWING THAT SHOWS HOW THE (10) 4" TELEPHONE CONDUIT WILL BE SUPPORTED DURING CONSTRUCTION. PRIOR TO CONSTRUCTION THE SHOP DRAWING MUST BE APPROVED BY THE ENGINEER AND SPRINT - CENTRAL TELEPHONE COMPANY.
7. CONTRACTOR TO POT HOLE AND VERIFY EXISTING SEWER INVERTS PRIOR TO CONSTRUCTION.
8. ASPHALTIC CONCRETE TO BE REMOVED FOR CONSTRUCTION OF MANHOLES, JUNCTION BOXES AND PIPING. A 5-INCH SECTION OF A.C. TO BE REPLACED AT COMPLETION OF CONSTRUCTION.

AS-BUILT
NOTE: AS-BUILT COMPRISED OF
INFORMATION SUPPLIED BY CITY
OF LAS VEGAS AND CONTRACTOR.

CALL
before you
DIG
1-800-227-2600
UNDERGROUND SERVICE (USA)
AVOID CUTTING UNDERGROUND
UTILITY LINES. IT'S COSTLY.

REV.	DATE	BY	REVISION
1	6/22/94	K.E.	"AS-BUILTS"

DRAWN BY: W.J.R. / R.D.S.
DESIGNED BY: K.J.E.
APPROVED BY: D.H.M.

2975 SO. RAINBOW BLVD., SUITE G
LAS VEGAS, NEVADA 89102
PHONE (702) 364-1066



TITLE
**PLAN AT ARDEN ST.
AND SAHARA AV. INT.**

PROJECT
**SAHARA INTERCEPTOR
ARDEN TO W.P.C.F., PHASE I**

PROJECT NO. 91-2464
DATE: 8/05/93
SCALE: HORIZ 1" = 10'
VERT NONE
DWG. FILE: R_A_PLAN.DWG

SHEET
3
OF 10 SHEETS
307-V710-1