

CONTRACTOR IS RESPONSIBLE FOR CLEARING AND GRUBBING A CONSTRUCTION ZONE 30 FEET EACH SIDE OF THE PROPOSED PIPE CENTERLINE ALIGNMENT FROM STATION 88+80 TO 97+40.

SECOND SECTION OF PHASE II STATION 89+15.46 TO 98+39.60 AND JUNCTION BOX TO BE CONSTRUCTED PRIOR TO THE COMMENCEMENT ON THE OTHER SECTIONS.

**CALL before you DIG**  
1-800-227-2600  
UNDERGROUND SERVICE (UGS) AVOID CUTTING UNDERGROUND UTILITY LINES. IT'S COSTLY.

- 1 SEE SHEET 8 FOR PLAN OF STA. 97+40.00 TO STA. 98+39.60 AND JUNCTION BOX. SEE PROFILE AS SHOWN BELOW.
- 2 CONCRETE ENCASE 60" AND 72" SEWER AS PER DETAIL 4 SHEET 10 FROM STA. 89+15.46 TO STA. 98+39.60
- 3 REMOVE AND REPLACE EXISTING BLOCK WALL AS REQUIRED TO CONSTRUCT JUNCTION BOX.
- 4 CONTRACTOR TO COORDINATE WITH NEVADA POWER FOR THE RELOCATION OF 6" NON-POTABLE WATER. A MINIMUM VERTICAL CLEARANCE OF 18" REQUIRED.
- 5 CONTRACTOR TO COORDINATE WITH DESERT ROSE GOLF COURSE FOR THE RELOCATION OF 12" NON-POTABLE WATER. A MINIMUM VERTICAL CLEARANCE OF 18" REQUIRED.
- 6 EXISTING ASPHALTIC CONCRETE TO BE REPLACED.
- 7 CONTRACTOR TO REMOVE AND REPLACE EXISTING IRRIGATION LINES AND LANDSCAPING AS PART OF JUNCTION BOX WORK.

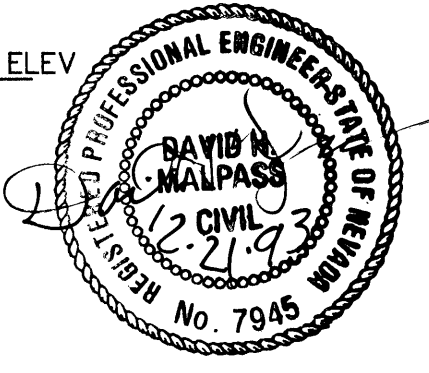
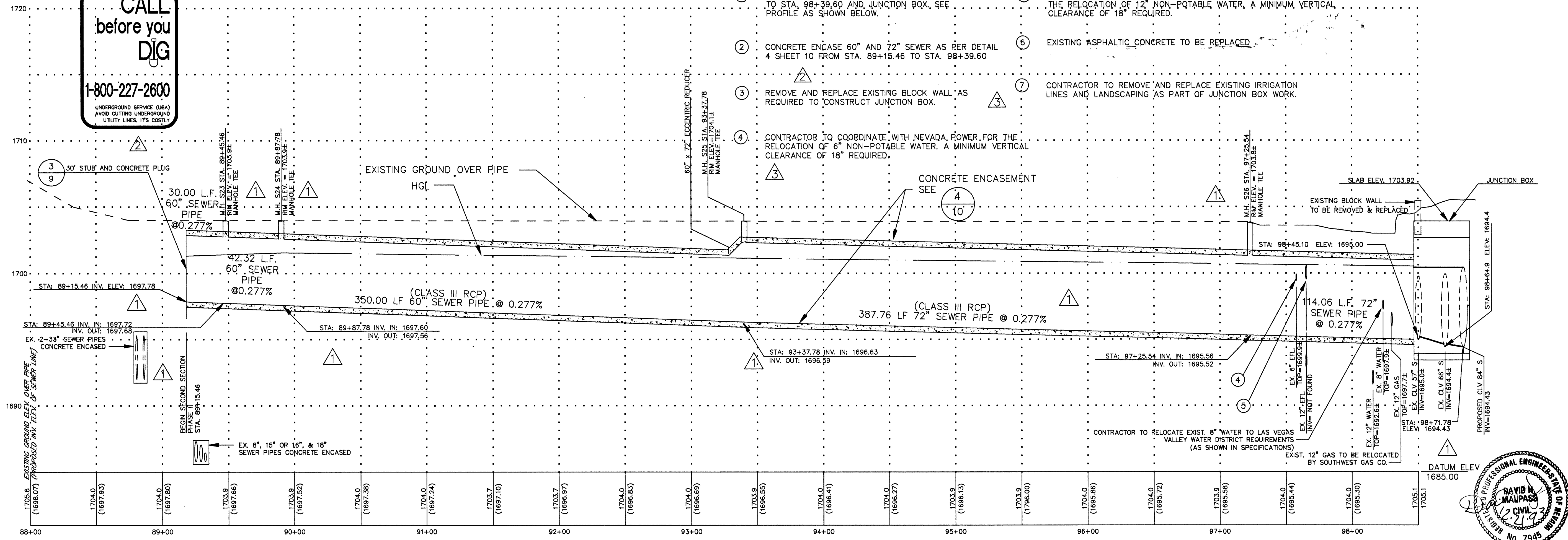

REV	DATE	BY	SHIFT STATION AND CHANGE ELEVATION OF PROFILE	REVISION
7/24/94		K.J.E.		REVISE AND ADD NOTES
6/17/94		K.J.E.		REVISE NOTES, PUG, AND LINE THICKNESS
4/29/94		K.J.E.		REVISE AND ADD NOTES

DRAWN BY: R.D.S./W.J.R.  
DESIGNED BY: K.J.E.  
APPROVED BY: D.H.M.

TITLE: PLAN AND PROFILE  
STA. 89+15.46 TO STA. 97+40

PROJECT: SAHARA INTERCEPTOR ARDEN TO W.P.C.F., PHASE II

PROJECT NO. 91-12464.1  
DATE: 10/13/94  
SCALE: HORIZ 1" = 40'  
VERT. 1" = 4'  
DWG. FILE: R\1464S9.DWG

SHEET 7 OF 11 SHEETS

2975 SO. RAINBOW BLVD., SUITE G  
LAS VEGAS, NEVADA 89102  
PHONE (702) 364-1066

CITY OF LAS VEGAS NEVADA

SAHARA INTERCEPTOR ARDEN TO W.P.C.F., PHASE II