

CIPP INVERSION NO. 11

CIPP INVERSION NO. 12

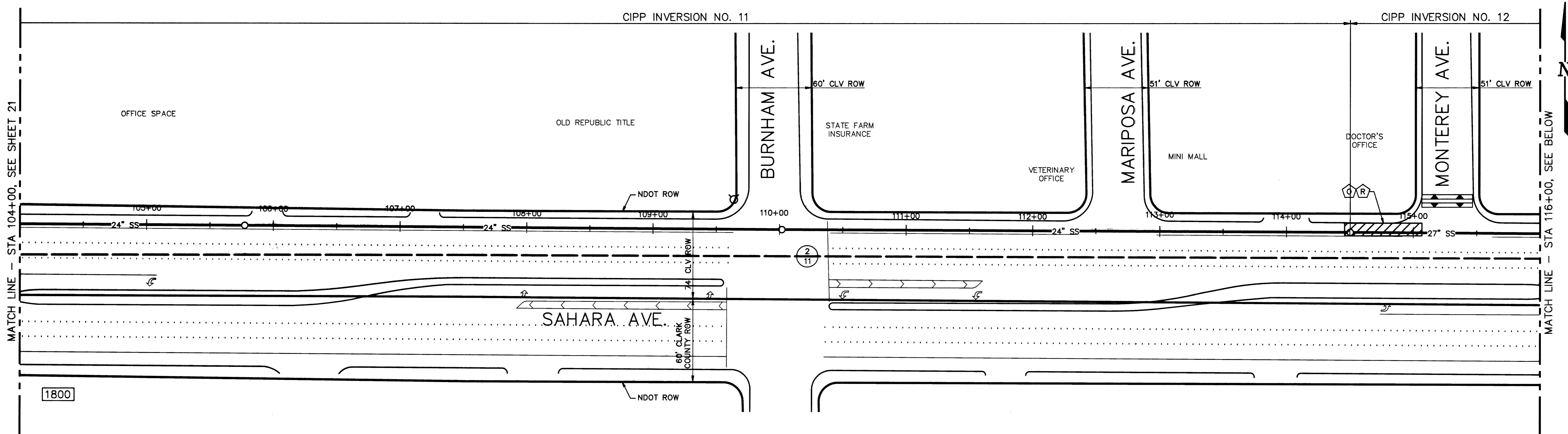

CIPP LINER INSTALLATION NOTES:

NOTE	INVERSION NO.	ESTIMATED DURATION (DAYS)	ACTIVITY
⬡	11	4	TEMPORARY FLOW BYPASSING
⬢	12	4	TEMPORARY FLOW BYPASSING
⬤	12	4	INSTALL CIPP LINER FROM THIS LOCATION
⬥	13	4	INSTALL CIPP LINER FROM THIS LOCATION
⬦	--	27	TEMPORARY FLOW BYPASSING FOR INVERSIONS NO. 14, 15, 16, 17, 18, 19, & 20

LEGEND:

- VEHICLE RAMP, PER DETAIL SHEET 17
- LANE CLOSURE
- LANE CLOSURE, FOR INVERSION AREA/EQUIPMENT (APPROX 10'x40')

CIPP INVERSION NO. 12

CIPP INVERSION NO. 13

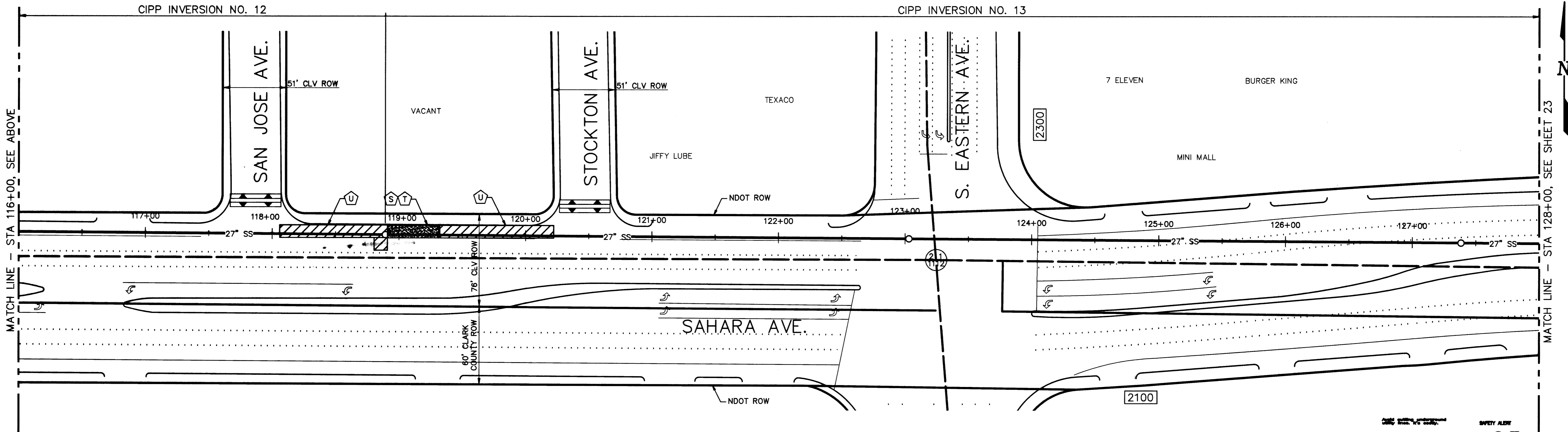

Call before you Dig
1-800-227-2600

Call before you Overhead
593-6111

NO.	DATE	DESCRIPTION	APP'D

DEPARTMENT OF PUBLIC WORKS
ENGINEERING DESIGN SECTION
 CITY ENGINEER: CHARLES KAJKOWSKI JR., P.E.
 PROJECT MANAGER: THERESA M. HANRAHAN, P.E.
 DESIGNED BY: CMG
 DRAWN BY: RJS
 CHECKED BY: CMG
 HORIZONTAL SCALE: 1" = 40'
 VERTICAL SCALE: NONE
 DATE: 01/21/04

SAHARA AVENUE SANITARY SEWER REHABILITATION - PHASE III
CIPP LINER LANE CLOSURES PLAN
 STA 104+00 TO STA 128+00

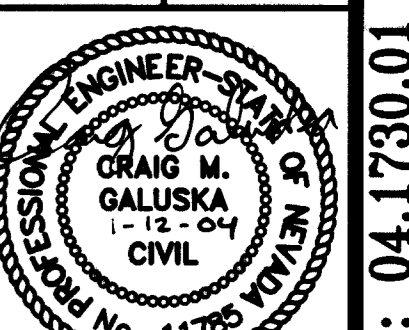

EXPIRES 6/30/05
 Sheet
 22 of 28
 DRAWING NO. 307-V826

66741

BID NUMBER: 04.1730.01