

**PLAN AND PROFILE**

**PLAN AND PROFILE**

BACK OF CURB CURVE TABLE

CURVE	DELTA	RADIUS	LENGTH	TANGENT
C5	5277.29'	365.50'	34.82'	17.42'
C6	2811.38'	34.50'	15.87'	7.87'
C7	8745.71'	5.00'	7.66'	4.81'
C8	9214.39'	5.00'	8.05'	5.20'
C9	2611.38'	89.50'	31.57'	16.06'
C12	2611.38'	330.50'	150.13'	76.38'
C14	6711.12'	20.00'	23.45'	13.28'
C16	10025.25'	20.00'	35.35'	24.01'
C17	6101.46'	369.50'	52.75'	26.42'
C24	4927.30'	19.50'	16.83'	8.98'
C25	4927.30'	19.50'	16.83'	8.98'
C26	27855.00'	40.50'	197.15'	34.84'
C27	8730.31'	20.00'	30.55'	19.15'
C28	9229.29'	20.00'	32.29'	20.88'
C35	4927.30'	19.50'	16.83'	8.98'
C36	4927.30'	19.50'	16.83'	8.98'
C37	27855.00'	40.50'	197.15'	34.84'

CENTERLINE CURVE TABLE

CURVE	DELTA	RADIUS	LENGTH	TANGENT
C10	2611.38'	350.00'	158.99'	80.88'
C11	2611.38'	50.00'	22.71'	11.56'

CENTERLINE LINE TABLE

LINE	LENGTH	BEARING
L9	300.03'	N85°23'35"E
L12	62.46'	S00°34'14"W
L14	822.89'	N88°23'35"E
L23	345.06'	S00°38'14"W
L24	383.87'	S00°33'04"W

**BASIS OF BEARING**  
 THE BEARING OF NORTH 88°50'50" EAST, BEING THE SOUTH LINE OF THE NORTHWEST QUARTER (NW 1/4) OF THE NORTHEAST QUARTER (NE 1/4) OF SECTION 32, TOWNSHIP 19 SOUTH, RANGE 60 EAST, M.D.M., AS SHOWN BY SURVEY IN FILE 99, PAGE 93 OF PARCELS MAPS ON FILE IN THE CLARK COUNTY RECORDER'S OFFICE, CLARK COUNTY, NEVADA.

**BENCHMARK**

NO	STATION	DESCRIPTION	NAVD88 DATUM (FEET)	NAVD88 DATUM (METERS)
405	CLV BM 8LV90 33NWS	RIVET & PLATE IN TOP OF CURB SE CORNER OF ANN RD AND DURANGO	2448.85	746.4111

**NOTE:**  
 ALL PRIVATE ST. ARE P.U.E.'S, PUBLIC SEWER EASEMENTS AND PUBLIC DRAINAGE EASEMENTS TO BE PRIVATELY MAINTAINED.

- CONSTRUCTION NOTES**
- (A) CONSTRUCT 6" GROSS GUTTER PER USD DRAWING NO. 228
  - (B) CONSTRUCT 30" ROLL TYPE CURB AND GUTTER PER USD DRAWING NO. 217A
  - (C) CONSTRUCT 12" TYPE CURB AND GUTTER PER USD DRAWING NO. 216
  - (D) CONSTRUCT CONCRETE SIDEWALK PER USD DRAWING NO. 234
  - (E) REMOVE EXISTING 12" TYPE CURB AND GUTTER
  - (F) REMOVE EXISTING GROSS GUTTER
  - (G) REMOVE EXISTING AC PAVEMENT

APPROVED FOR CONSTRUCTION  
 LAS VEGAS VALLEY WATER DISTRICT  
 PROJECT H109420

CLARK COUNTY DEPARTMENT OF DEVELOPMENT SERVICES  
 Acceptance of plans for filing  
 By \_\_\_\_\_  
 Acceptance of these plans for filing shall not be construed to be a permit for or an approval of any violation of any of the provisions of the state or county laws and / or specifications. Clark County shall be held free from damages which may result from the construction of the improvements from the engineering design depicted herein.  
 NOTE: Power poles and / or other existing facilities not in proper location based on proposed improvements shown hereon will be re-located at no expense to Clark County.

**WATER MAIN JOINT DEFLECTION (PVC 4"-24")**  
 PVC PIPE SHALL BE DEFLECTED AT THE JOINT ONLY. THE MAXIMUM ALLOWABLE DEFLECTION SHALL BE ONE (1) DEGREE PER JOINT WITH MINIMUM RADIUS OF CURVATURE OF 1,150 FEET. PER UDAS 2.06.01 AND 2.08.02.  
 FOR CHANGES IN DIRECTION EXCEEDING THE MAXIMUM ALLOWABLE JOINT DEFLECTION, FITTINGS SHALL BE USED.

**NOTE**  
 CONTRACTOR TO VERIFY THE HORIZONTAL AND VERTICAL LOCATION OF EXISTING UTILITIES PRIOR TO CONSTRUCTION. REPORT ANY DISCREPANCIES TO ENGINEER IMMEDIATELY.

NO WATER COMMITMENT IS IMPLIED OR GRANTED TO THIS PAD/BUILDING/PARCEL IN ASSOCIATION WITH THE APPROVAL OF THESE PLANS.

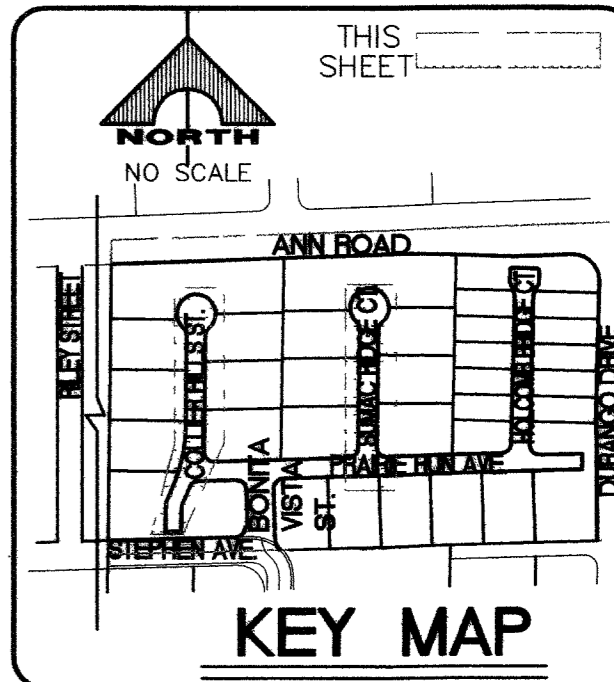

**G.C. WALLACE, INC.**  
 Engineers/Planners/Surveyors  
 1555 SOUTH RAINBOW BLVD., LAS VEGAS, NEVADA 89146  
 TELEPHONE: (702) 804-2000 • FAX: (702) 804-2299  
 PLOT DATE: 12-08-04  
 PLOT TIME: 14:16:06

**PINNACLE HOMES**  
 SABLE OAKS I  
 COLLIER HILLS STREET AND SUMAC RIDGE COURT  
 PLAN AND PROFILE

DRAWING  
**C-10**  
 10 OF 16 SHTS

78867

CLV DWG# 307V917 HTE # 04-51651