

SVZ NOTES
 1 NO STRUCTURE, VEGETATION OR OBJECT OF ANY KIND IS PERMITTED OVER TWENTY-FOUR (24) INCHES IN HEIGHT (MEASURED FROM THE TOP OF THE ADJACENT CURB IF CURB EXISTS) WITHIN THE SIGHT VISIBILITY ZONES

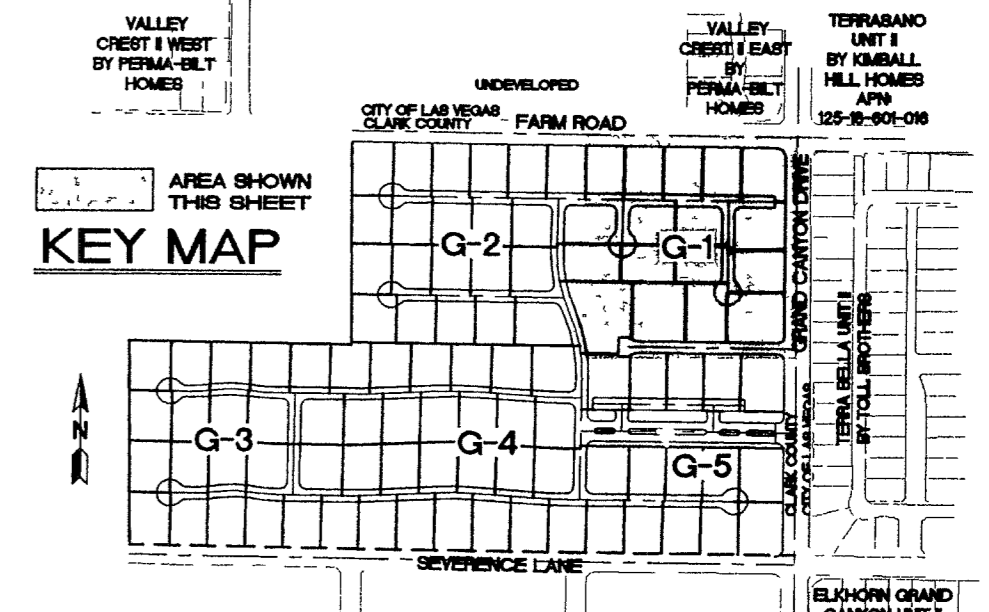
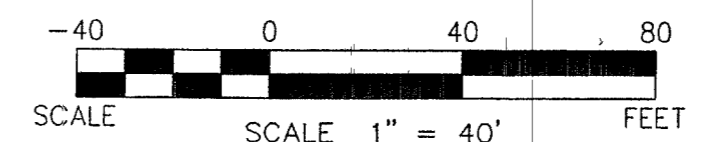

Avoid cutting underground utility lines it's costly
Call before you Dig.
 1-800-227-2600
 UNDERGROUND SERVICE (USA)

NOTES

- SECTION 2 OF THE CLARK COUNTY BUILDING OFFICE OPERATIONS DIVISION DRAINAGE COMPLIANCE REPORT MUST BE COMPLETED BY THE ENGINEER AND SUBMITTED TO DEVELOPMENT SERVICES INSPECTION SCHEDULING FOR ALL WESTERN COLLECTION CHANNELS AND DRAINAGE EASEMENTS, PRIOR TO PAD GRADING INSPECTIONS FOR THE ENTIRE SITE
- ROW FOR JENSEN STREET AND VIA PROVENZA AVENUE SHALL BE VACATED BY VS-0948-04
- CONSTRUCT ALL STREET INTERSECTIONS PER CCAUSD #225
- REF SOLS REPORT BY OWENS, No E-04-296, DATED 10/11/04

LIST OF ABBREVIATIONS

- AC ASPHALTIC CONCRETE
- CL CENTER LINE
- FG FINISH GRADE
- FL FLOW LINE
- GB GRADE BREAK
- HP HIGH POINT
- LE LANDSCAPE EASEMENT
- LF LINEAR FEET
- LP LOW POINT
- PAE PED ACCESS EASEMENT
- PC POINT OF CURVATURE
- PRC POINT OF REVERSE CURVE
- PT POINT OF TANGENCY
- PL PROPERTY LINE
- ROW RIGHT OF WAY
- R/W RIGHT OF WAY
- STA STATION
- TC TOP OF CURB
- TF TOP OF FOOTING
- TDF TOP DECOR WALL FOOTING
- TRW TOP OF RETAINING WALL
- VC VERTICAL CURVE

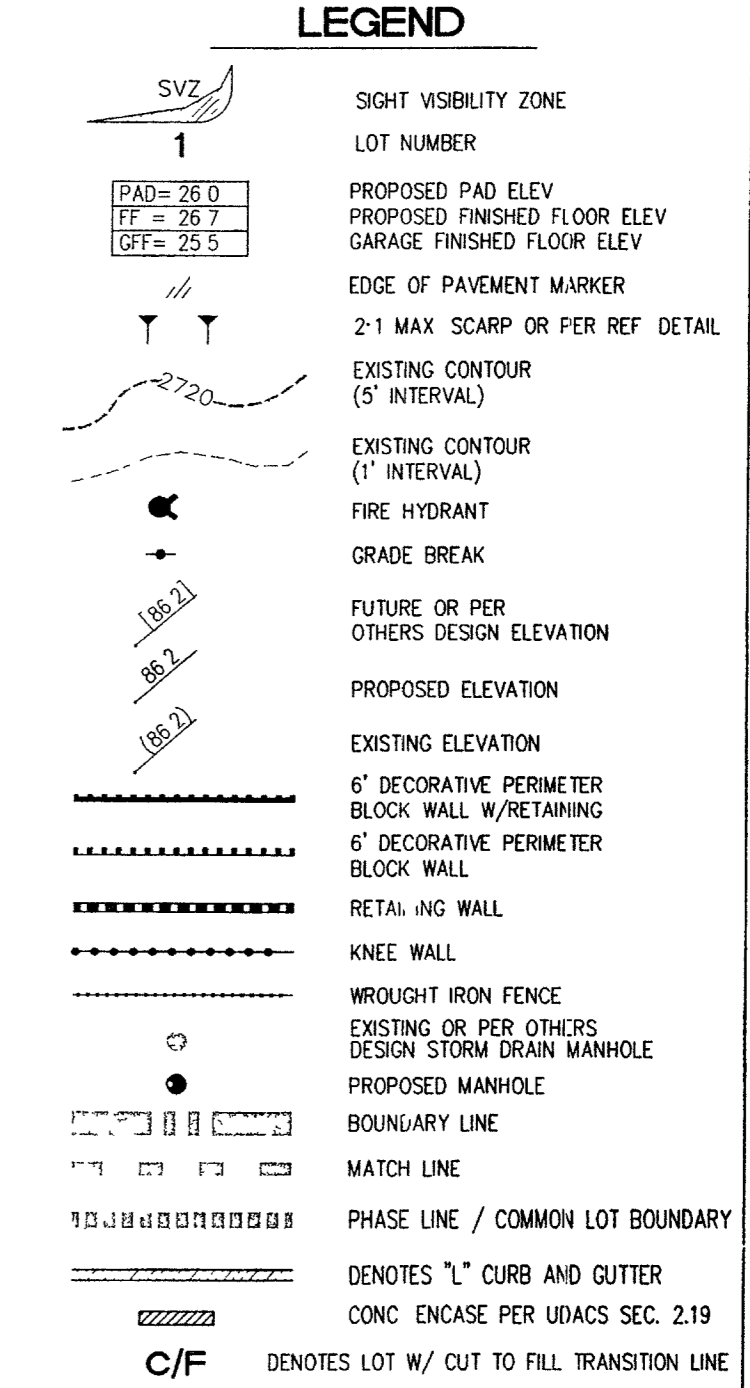

Call before you UnderGround
 1-702-455-7511
 1-702-229-6611

EASEMENT NOTES

- 37" DRAINAGE EASEMENT, LVWD WATER EASEMENT, PUBLIC UTILITY EASEMENT (TO BE MAINTAINED BY H.O.A.) AND CLV PUBLIC SEWER EASEMENT
- 20' DRAINAGE EASEMENT (TO BE MAINTAINED BY H.O.A.) AND CLV PUBLIC SEWER EASEMENT
- DRAINAGE EASEMENT TO BE PRIVATELY MAINTAINED BY H.O.A (SEE DIMENSION ON PLAN FOR EASEMENT WIDTH)

DROP INLET NOTE

- PROVIDE STANDARD MANHOLE STEPS TO ALL TYPE "CM" DROP INLETS PER CCAUSD DWG NO 410

BASIS OF BEARING

THE BASIS OF BEARINGS FOR THIS SURVEY IS BASED ON THE FOUND AND HELD MONUMENTS MARKING THE SOUTHERLY LINE OF THE SOUTHWEST QUARTER (SW 1/4) OF THE SOUTHWEST QUARTER (SW 1/4) OF SECTION 13, T19S, R06E, MN. CLARK COUNTY, NEVADA PER RECORD OF SURVEY BOOK 123, PAGE 32, CLARK COUNTY RECORDER'S OFFICE AS SOUTH 88°46'48" EAST

BENCHMARK

BENCHMARK FOUND CITY OF LAS VEGAS RIVET AND ROUND PLATE IN CONCRETE CYLINDER, SOUTHEAST CORNER OF ELKHORN RD. AND CONQUISTADOR ST
 BM NO 66 STATION 8LV90 19NNW6 ELEVATION = 2803.77 (NAVD 88)

CALL BEFORE YOU DO OVERHEAD
 1-702-227-2929

CLARK COUNTY DEPARTMENT OF DEVELOPMENT SERVICES
 ACCEPTANCE OF PLANS FOR FILING

BY: *Jack D. Simon* 6/27/05

ACCEPTANCE OF THESE PLANS FOR FILING SHALL NOT BE CONSTRUED TO BE A PERMIT FOR OR AN APPROVAL OF ANY VIOLATION OF ANY OF THE PROVISIONS OF THE STATE OR COUNTY LAWS AND/OR SPECIFICATIONS CLARK COUNTY SHALL BE HELD FREE FROM DAMAGES WHICH MAY RESULT FROM THE CONSTRUCTION OF THE IMPROVEMENTS FROM THE ENGINEERING DESIGN DEPICTED HEREIN

NOTE: POWER POLES AND/OR OTHER EXISTING FACILITIES NOT IN PROPER LOCATION BASED ON PROPOSED IMPROVEMENTS SHOWN HEREON WILL BE RELOCATED AT NO EXPENSE TO CLARK COUNTY

FLOOD ZONE NOTE

THE PROJECT AREA IS LOCATED WITHIN A FEMA ZONE X PER FLOOD INSURANCE RATE MAP PANEL 32003C1745E, DATED SEPTEMBER 27, 2002

THIS PLAN COMPLIES WITH THE APPROVED DRAINAGE STUDY HTE #04-48459, ON FILE WITH CLARK COUNTY

DATE: 6/1/05
 TODD J. STEADHAM

SLATER HANIFAN GROUP
 CONSULTING ENGINEERS & PLANNERS
 5740 S. ARVILLE STREET #216, LAS VEGAS, NV 89115
 PHONE (702) 284-5300 FAX (702) 284-5399

G-1

SHEET 32 OF 44
 CLV DWG # 50719330
 CC HTE# 05-3955

SECTION 18
 TOWNSHIP 19 SOUTH
 RANGE 60 EAST, M.D.M.

CLARK COUNTY, NEVADA

DATE: 06/20/05
 DRAFTER: JR/JB/DB
 DESIGNER: TS/JB/DB
 CHECKED: TS
 PROJECT NO.
 PINO402-001

PROFESSIONAL ENGINEER - STATE OF NEVADA
 TODD J. STEADHAM
 CIVIL
 LICENSE NO. 15292

81759